

SECTION TEN—DISASSEMBLY, INSPECTION, ASSEMBLY  
AND INSTALLATION OF REAR SERVO

## A. Disassembly of Rear Servo

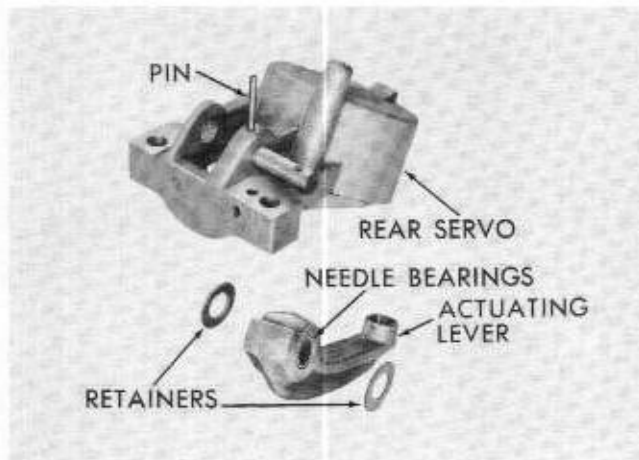

1. With 1/8 inch pin punch, remove the retaining pin.
2. Remove the shaft and rear servo actuating lever.
3. Remove the retainers and needle bearings.

**NOTE**

Early models do not have retainers or bearings.

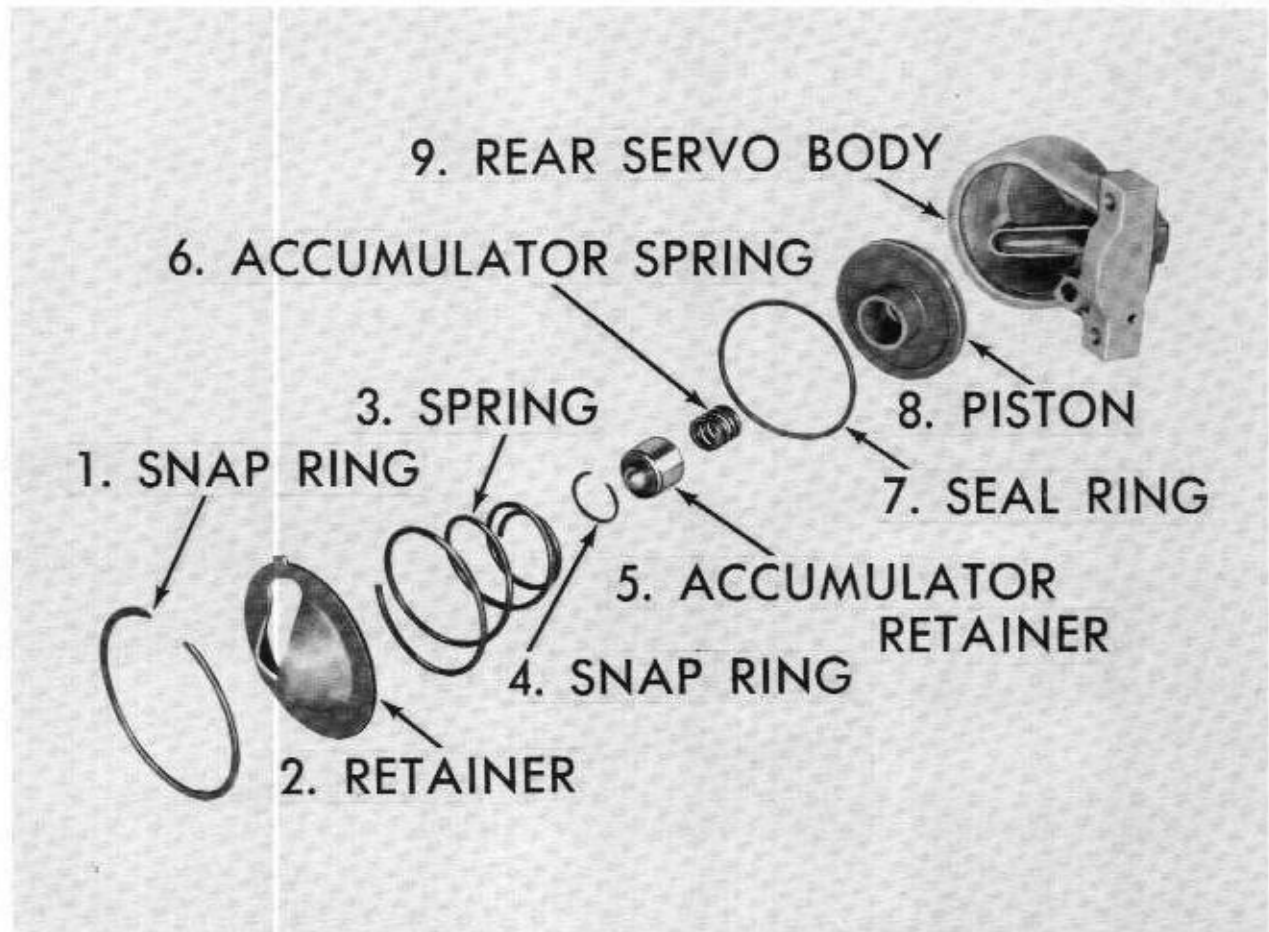

4. Press down on the retainer (2), remove the snap ring (1) with a screw driver, and remove the retainer and servo spring (3).
5. Press down on the accumulator retainer (5), and remove the snap ring (4) with snap ring pliers.

- When the snap ring (4) is removed, carefully release your hand-pressure on the accumulator retainer (5), and remove the retainer (5) and spring (6) from the piston (8), and remove the piston from the body. Then, remove the seal ring (7) from the piston.

**NOTE** On 1951-1954 models, there is no accumulator assembly.

### B. Inspection of Rear Servo

- Inspect the servo body and piston bore for cracks.
- Inspect the body-to-case mating surface for burrs.
- Inspect springs for distortion.
- Inspect piston and accumulator retainer for wear and scores.
- Inspect actuating lever, shaft, and needle bearings (if used) for wear.
- Check fluid passages for obstructions.
- Inspect fluid passage plugs for tightness in the body.

### C. Assembly of Rear Servo

- Install a new seal ring on the piston. Install the accumulator spring, retainer, and snap ring in the piston. Install the piston in the servo body.
- Install the servo spring, retainer, and snap ring.
- Install needle bearings (if used) in the actuating lever -- positioning them with a pencil.
- Lock the needle bearings in place by rotating them clockwise with your thumb.
- Install the actuating lever, shaft, and bearing retainers, and install the retaining pin. Check the lever for free movement.

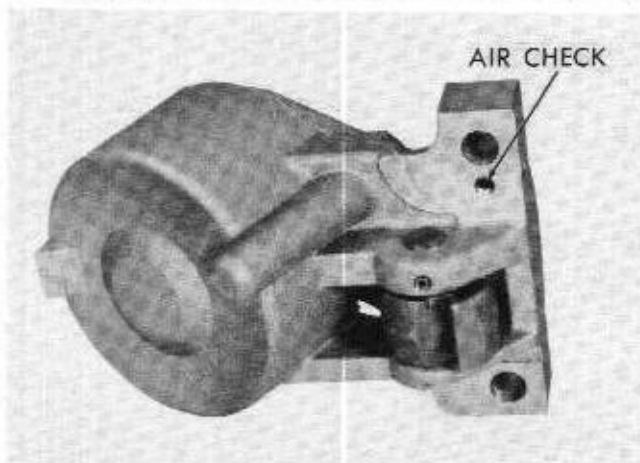

- Air check rear servo operation. The actuating lever should move. If it doesn't, disassemble the unit and repair it.

D. Installation of Rear Servo

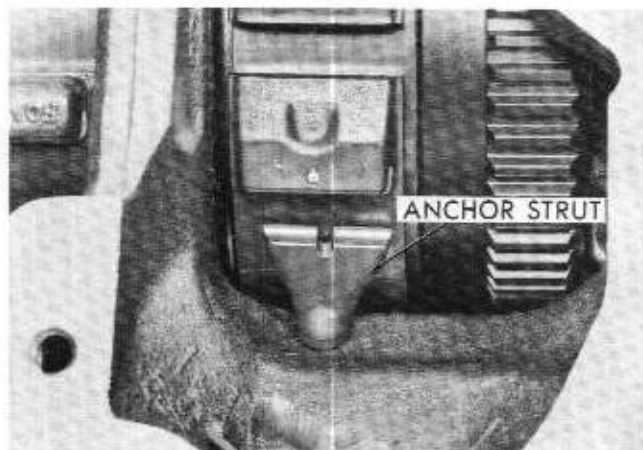

1. Place the servo anchor strut over the rear band adjusting screw head, which protrudes into the case, and rotate the rear band to engage the strut. Hold the strut in position.

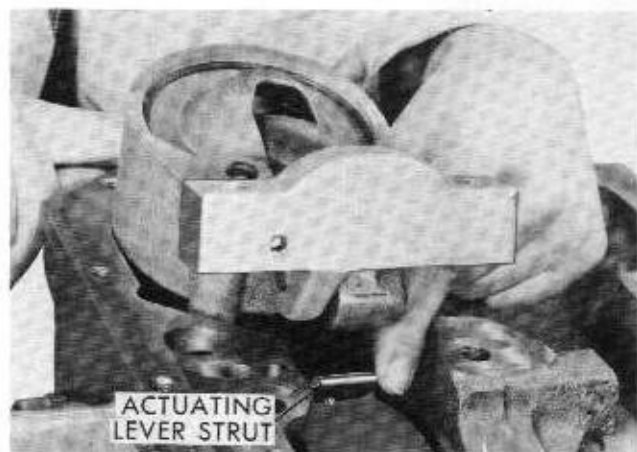

2. Position the servo actuating lever strut, and install the rear servo. Install the rear servo bolts, and torque them 40 to 45 foot-pounds.