

# LUBRICANT CHART AND SPECIFICATIONS

## GROUP 21

### LUBRICANT SPECIFICATIONS

ITEM	FORD PART NO.	PART NAME
Body Hinges	C4AZ-19584-A, R-138-B	Lifetime Body Grease
Brake Master Cylinder	B7AZ-19542-A, R-103-A	Rotunda Heavy Duty Brake Fluid
Front Suspension Ball Joints and Steering Linkage	C1AZ-19590-B	FoMoCo Ball Joint Grease
Front Wheel Bearings	C2AZ-19585-A	FoMoCo Wheel Bearing Grease
Hood Latch & Safety Catch	C4AZ-19584-A, R-138-B	Lifetime Body Grease
Lock Cylinders	B4A-19587-A	Rotunda Lock Lubricant
Rear Axle	C1AZ-19580-E or F	FoMoCo Hypoid Gear Lube
Equa Lock Axles use 1 oz. per pint of C1A-19580-E or F	C1AA-19B546-A	Equa-Lock Additive
Steering—Power (Pump Reservoir)	C1AZ-19582-A, R-106-A	Rotunda Automatic Transmission Fluid
Convertible Top Reservoir	C1AZ-19582-A, R-106-A	Rotunda Automatic Transmission Fluid
Transmission (Automatic)	C1AZ-19582-A, R-106-A	Rotunda Automatic Transmission Fluid
Universal Joints	C1AZ-19586-B	FoMoCo Universal Lube
Engine Crankcase Oil		MS Sequence tested SAE 10W-30 above -10°F. SAE 5W-20 for sustained temperatures below -10°F.
Engine Oil Filter	C1AZ-6731-A, R1-A	Rotunda Oil Filter—6,000 mile type

### ENGINE CRANKCASE OILS

Use of SAE 10W-30 oil will provide the proper viscosity for all normal ranges of outside temperatures. For operation at sustained outside temperatures below -10°F. a 5W-20 oil should be used.

#### Oil Quality

Use only oils which have been tested and certified by the maker as satisfying automobile manufacturers specifications for Engine Operating Sequence Tests for Service M.S. The Ford Motor Company specification covering these tests is M2C27. These

tests are defined by ASTM committee D2 for Section G-IV of technical committee B and are published in the SAE Handbook.

These tests cover oil characteristics as follows:

Sequence I—Low Temperature Wear Prevention—(Cold Starts)

Sequence II—High Speed—High Temperature Wear Prevention

Sequence III—High Temperature Deposit Formation—(Varnish)

Sequence IV—Corrosion and Rust Prevention

Sequence V—Sludge Formation

If engine oils are used which do not meet these requirements, it will

be necessary to change oil more frequently than every 6,000 miles.

If it is necessary to use an "MS" oil which is not certified by the marketer as having passed the Engine Operating Sequence Tests, the addition of Rotunda Oil Conditioner to the oil will satisfy the requirements.

#### Oil Filter

Use of the right oil filter is also essential to good engine life and operation. For 6,000-mile filter change intervals, filters must meet Ford Specification ES-COAE-6714-A.

The genuine Rotunda Oil Filter meets this requirement.

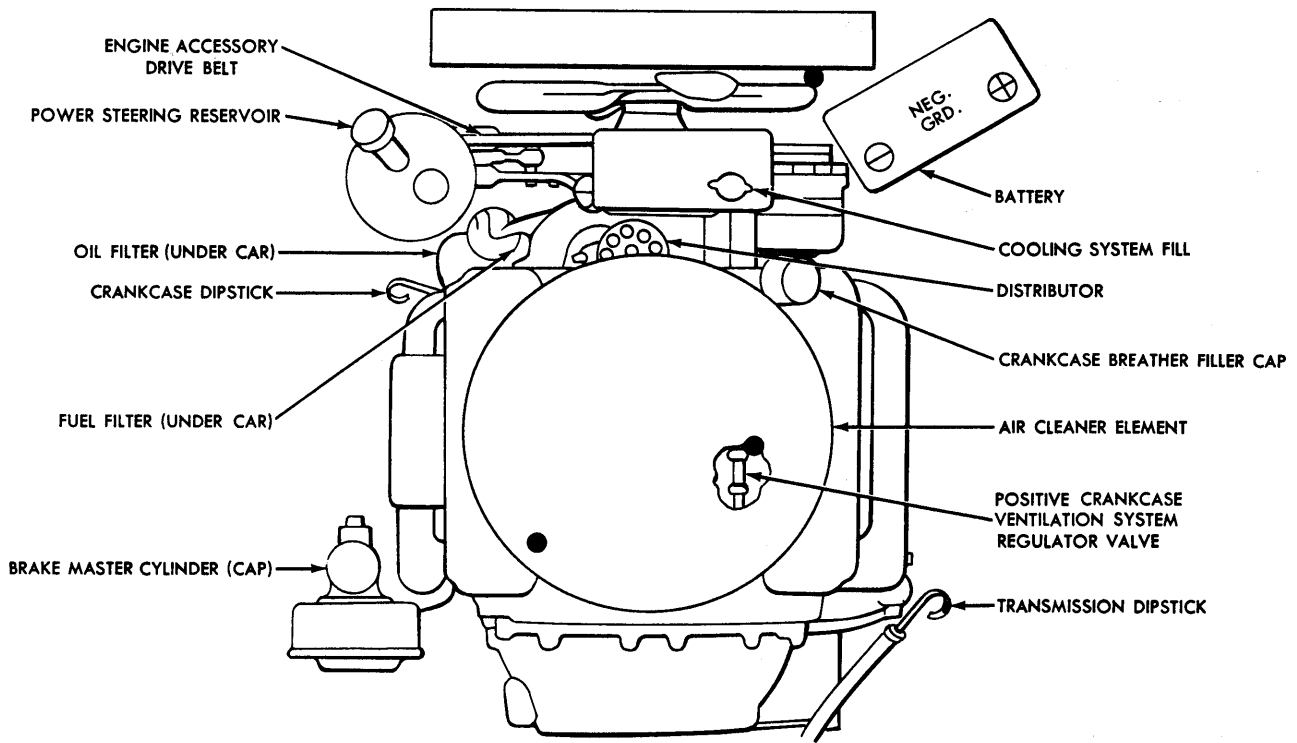

● COOLING SYSTEM DRAIN

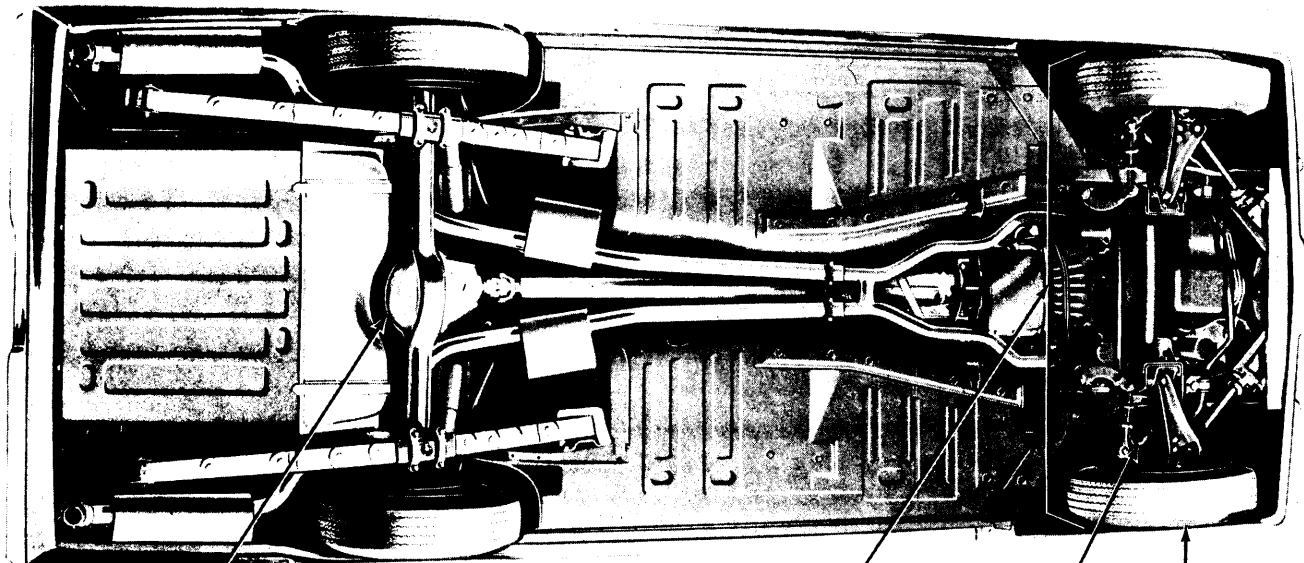

REAR AXLE

FRONT SUSPENSION AND STEERING LINKAGE

FRONT WHEEL BEARINGS

— BRAKE LINES AND LINING

Y1000-A

FIG. 1 - Typical Lubrication Chart