

INDEX

YEAR	TITLE	ILLUS. NO.	SECTION	PAGE
SEAT				
1960	Front seat mechanism and related parts-drivers and passengers single-Ford-body type 59E	P-3059	600	739
1960	Front seat mechanism and related parts-manual 4 way tilt-Ford	P-3196	600	740
1960	Front seat mechanism and related parts-manual full width-Falcon	P-3166	600	750
1960	Front seat mechanism and related parts-manual full width-Ford	P-3057	600	741
1960	Front seat mechanism and related parts-manual bucket-Thunderbird	P-2620	600	743
1960	Front seat mechanism and related parts-power bucket-Thunderbird	P-2621	600	744
1960	Front seat mechanism and related parts-power full width-Ford	P-3058	600	742
1960	Rear seat and related parts-Falcon-body type 59, 71	P-3201	600	760
1960	Rear seat and related parts-Ford-body type 59, 71 (6 passenger)	P-3060	600	756
1960	Rear and auxiliary seats and related parts-Ford-body type 71 (9 passenger)	P-3061	600	757
1960	Rear and auxiliary seats and related parts-folded-Ford-body type 71 (9 passenger)	P-3062	600	758
1960	Seat belt installation-Ford and Falcon (with full width seat)	P-4398	600	753
1960	Seat belt installation-Thunderbird (with bucket seats)	P-4397	600	753
1961	Front seat mechanism and related parts-bucket-Thunderbird and Falcon-body type 64	P-3360	600	745
1961	Front seat mechanism and related parts-manual 4 way tilt-Ford	P-3196	600	740
1961	Front seat mechanism and related parts-manual full width-Falcon	P-3166	600	750
1961	Front seat mechanism and related parts-manual full width-Ford	P-3057	600	741
1961	Front seat mechanism and related parts-power full width-Ford	P-3058	600	742
1961	Rear seat and related parts-Falcon-body type 59, 71	P-3201	600	760
1961	Rear seat and related parts-Ford-body type 59, 71 (6 passenger)	P-3060	600	756
1961	Rear and auxiliary seats and related parts-Ford-body type 71 (9 passenger)	P-3061	600	757
1961	Rear and auxiliary seats and related parts-folded-Ford-body type 71 (9 passenger)	P-3062	600	758
1961	Seat belt installation-Falcon and Thunderbird (with bucket seats)	P-4397	600	753
1961	Seat belt installation-Ford and Falcon (with full width seat)	P-4398	600	753
1962	Front seat mechanism and related parts-bucket-Ford-body type 65B, 76B	P-3857	600	746
1962	Front seat mechanism and related parts-bucket-Thunderbird & Falcon-body type 62, 64, 71	P-3360	600	745
1962	Front seat mechanism and related parts-manual bucket-Fairlane-body type 62	P-3859	600	752
1962	Front seat mechanism and related parts-manual full width-Fairlane	P-3765	600	749
1962	Front seat mechanism and related parts-manual full width-Falcon	P-3166	600	750
1962	Front seat mechanism and related parts-manual full width-Ford	P-3057	600	741
1962	Front seat mechanism and related parts-power full width-Ford	P-3058	600	742
1962	Rear seat and related parts-Falcon-body type 59, 71	P-3201	600	760
1962	Rear seat and related parts-Ford-body type 71 (6 passenger)	P-3780	600	759
1962	Rear and auxiliary seats and related parts-Ford-body type 71 (9 passenger)	P-3061	600	757
1962	Rear and auxiliary seats and related parts-folded-Ford-body type 71 (9 passenger)	P-3062	600	758

INDEX

YEAR	TITLE	ILLUS. NO.	SECTION	PAGE
SEAT - continued				
1962	Seat belt installation-Ford, Fairlane and Falcon (with full width seat)	P-4398	600	753
1962	Seat belt installation-Ford, Fairlane, Falcon and Thunderbird (with bucket seats)	P-4397	600	753
1963	Auxiliary seat, storage compartment and related parts-Fairlane-body type 71	P-4045	600	762
1963	Front seat mechanism and related parts-bostrom bucket-Ford-body type 54, 62	P-4178	600	747
1963	Front seat mechanism & related parts-bucket-Ford-body type 63, 65, 71, 75, 76 and Thunderbird	P-3857	600	746
1963	Front seat mechanism and related parts-manual bucket-Fairlane-body type 65 and Falcon-body type 62, 63, 71	P-4048	600	751
1963	Front seat mechanism and related parts-manual bucket-Fairlane-body type 71 and Falcon body type 76	P-3859	600	752
1963	Front seat mechanism and related parts-manual full width-Fairlane	P-3765	600	749
1963	Front seat mechanism and related parts-manual full width-Falcon	P-3166	600	750
1963	Front seat mechanism and related parts-manual full width-Ford	P-4046	600	748
1963	Front seat mechanism and related parts-power full width-Ford	P-3058	600	742
1963	Rear seat and related parts-Falcon-body type 59, 71	P-3201	600	760
1963	Rear seat and related parts-Ford-body type 71 (6 passenger)	P-3780	600	759
1963	Rear seat, auxiliary floor and related parts-Fairlane-body type 71	P-4044	600	761
1963	Rear and auxiliary seats and related parts-Ford-body type 71 (9 passenger)	P-3061	600	757
1963	Rear and auxiliary seats and related parts-folded-Ford-body type 71 (9 passenger)	P-3062	600	758
1963	Seat belt installation-Ford, Fairlane and Falcon (with full width seat)	P-4398	600	753
1963	Seat belt installation-Ford, Fairlane, Falcon and Thunderbird (with bucket seats)	P-4397	600	753
1964	Auxiliary seat, storage compartment and related parts-Fairlane-body type 71	P-4045	600	762
1964	Front seat mechanism and related parts-bucket-Ford and Thunderbird	P-4322	600	754
1964	Front seat mechanism and related parts-manual bucket-Fairlane-body type 65B and Falcon-body type 62C, 63C, 63D, 66H	P-4048	600	751
1964	Front seat mechanism and related parts-manual bucket-Falcon-body type 76B, 76D	P-3859	600	752
1964	Front seat mechanism and related parts-manual full width-Fairlane	P-3765	600	749
1964	Front seat mechanism and related parts-manual full width-Falcon	P-3166	600	750
1964	Front seat mechanism and related parts-manual full width-Ford	P-4046	600	748
1964	Front seat mechanism and related parts-power full width-Ford	P-3058	600	742
1964	Rear seat and related parts-Falcon-body type 59, 71	P-3201	600	760
1964	Rear seat and related parts-Ford-body type 71 (6 passenger)	P-3780	600	759
1964	Rear seat, auxiliary floor and related parts-Fairlane-body type 71	P-4044	600	761
1964	Rear and auxiliary seats and related parts-Ford-body type 71 (9 passenger)	P-3061	600	757
1964	Rear and auxiliary seats and related parts-folded-Ford-body type 71 (9 passenger)	P-3062	600	758
1964	Reclining seat, head rest and related parts-Thunderbird	P-4323	600	755
1964	Seat belt installation-Ford, Fairlane and Falcon (with bucket seats)	P-4397	600	753
1964	Seat belt installation-Ford, Fairlane and Falcon (with full width seat)	P-4398	600	753
1964	Seat belt installation-Thunderbird	P-4396	600	749

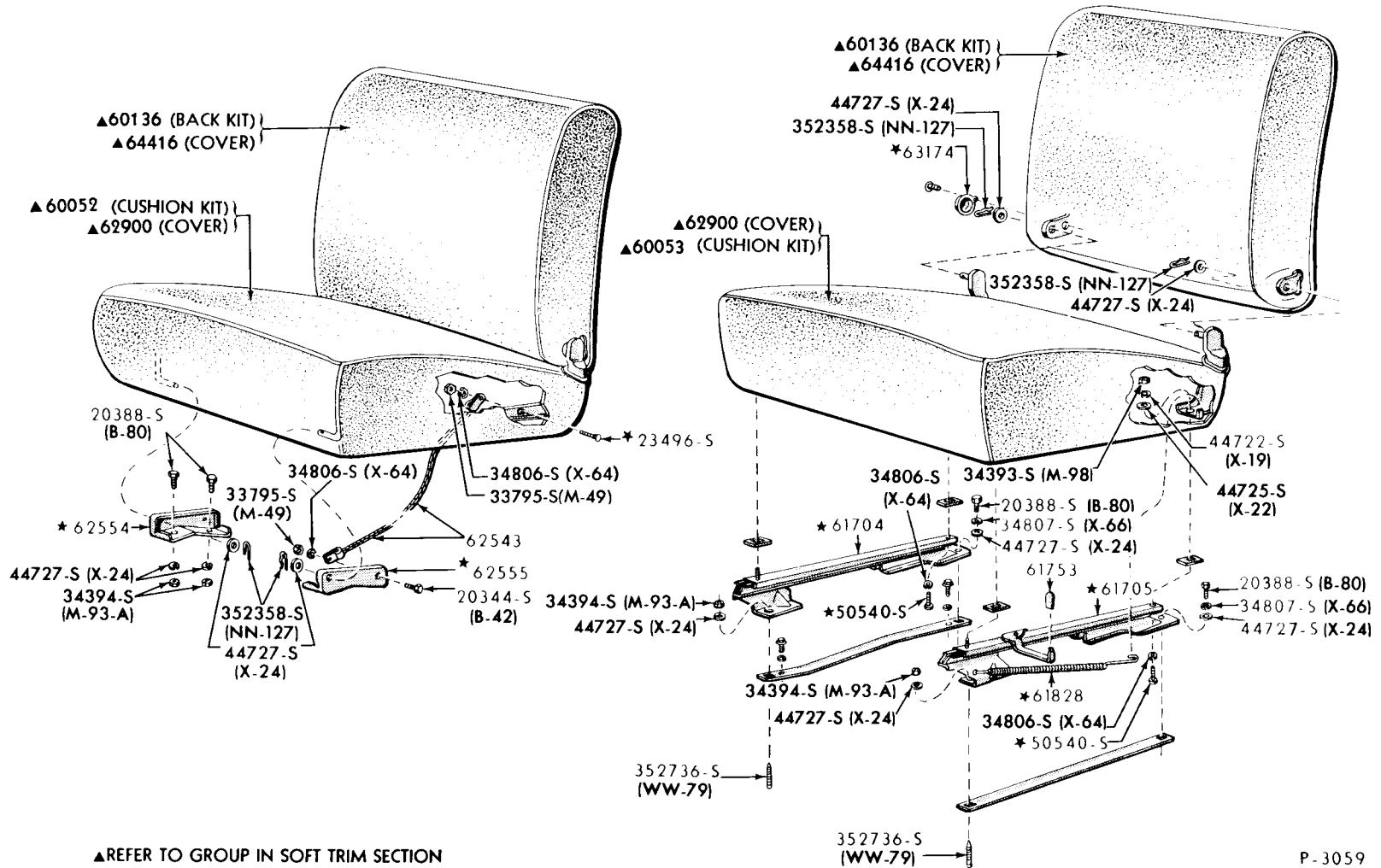

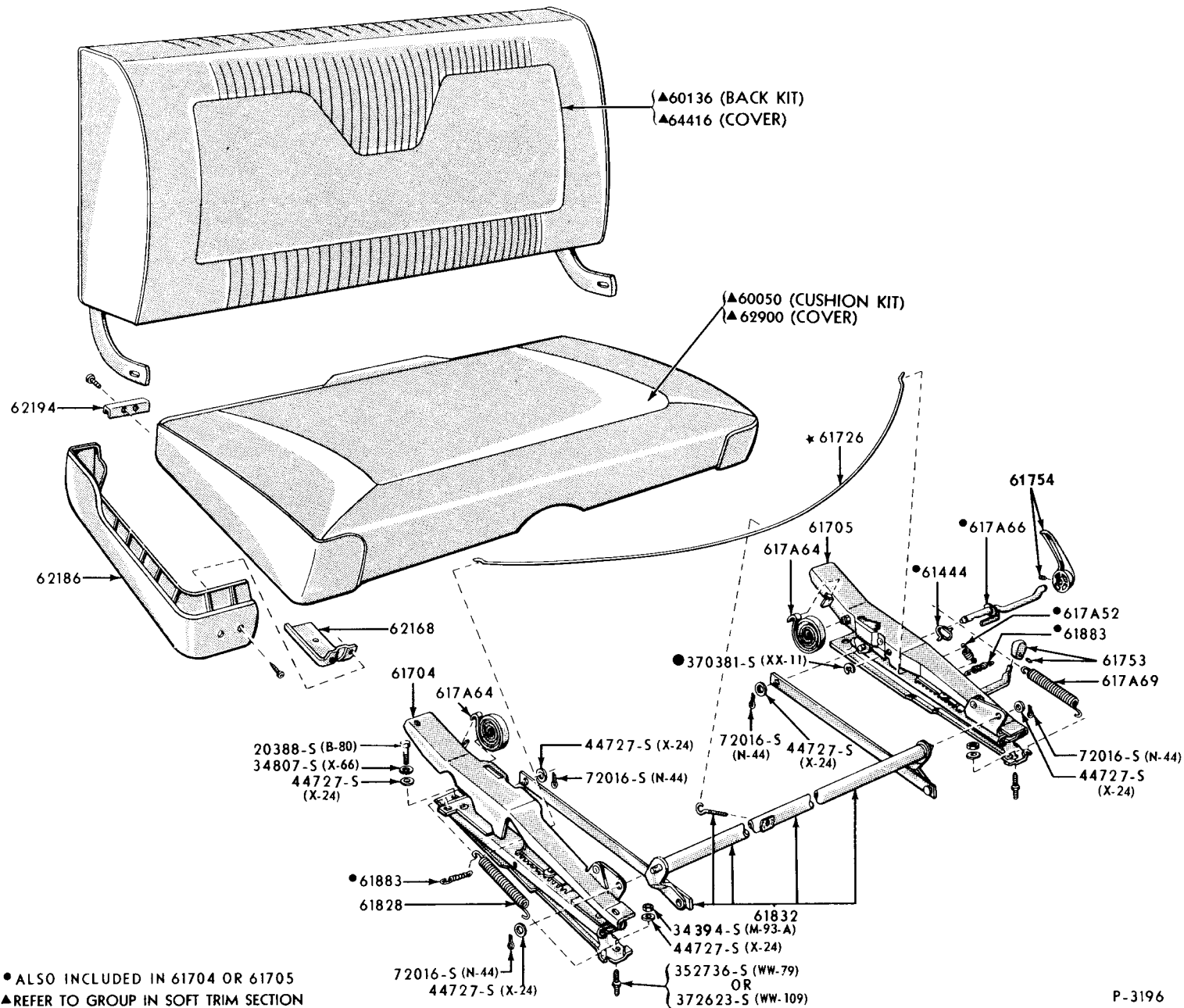

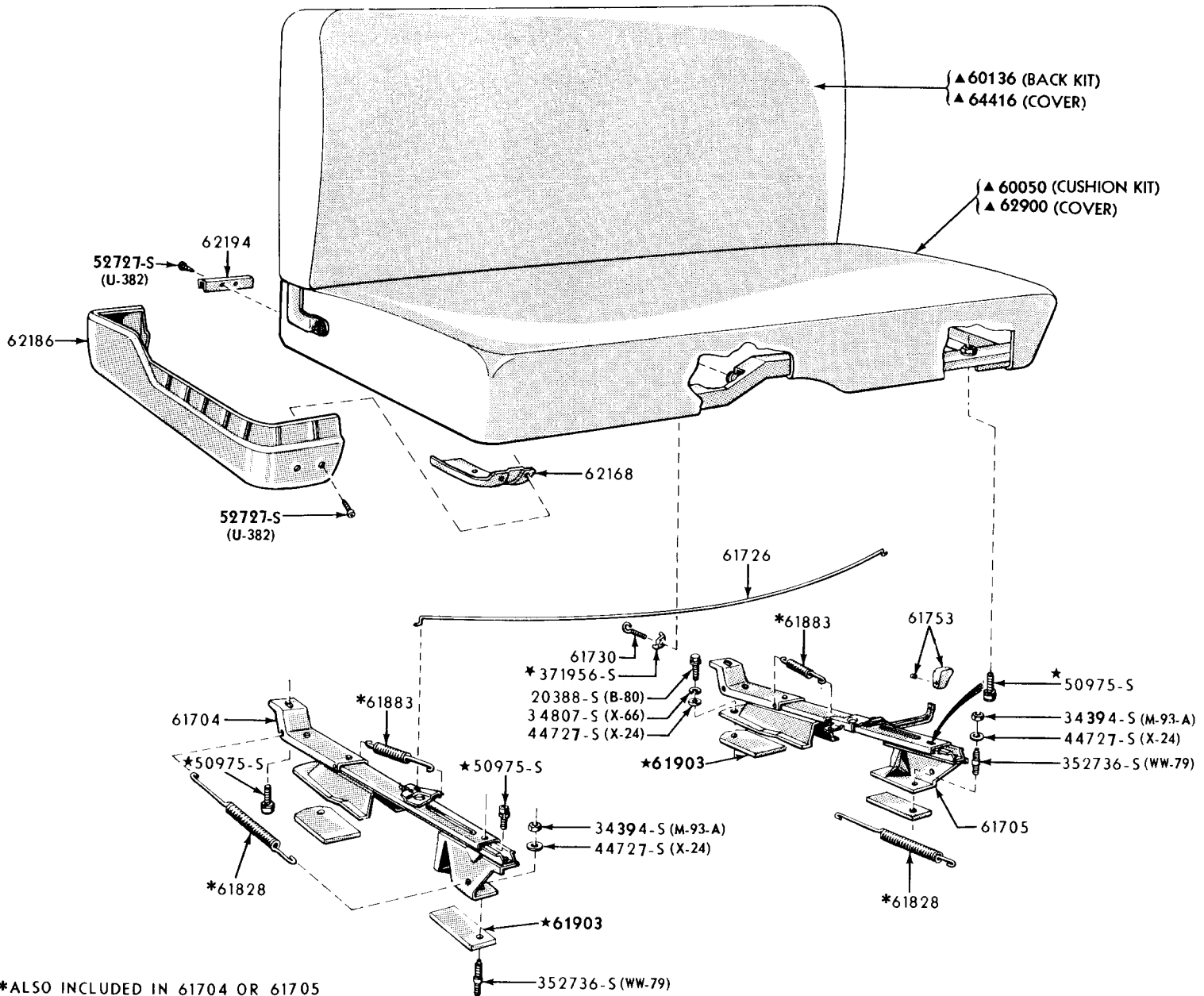

*ALSO INCLUDED IN 61704 OR 61705
▲REFER TO GROUP IN SOFT TRIM SECTION

P-3057

FRONT SEAT MECH ANISM and RELATED PARTS - MANUAL FULL WIDTH
1960/62 FORD

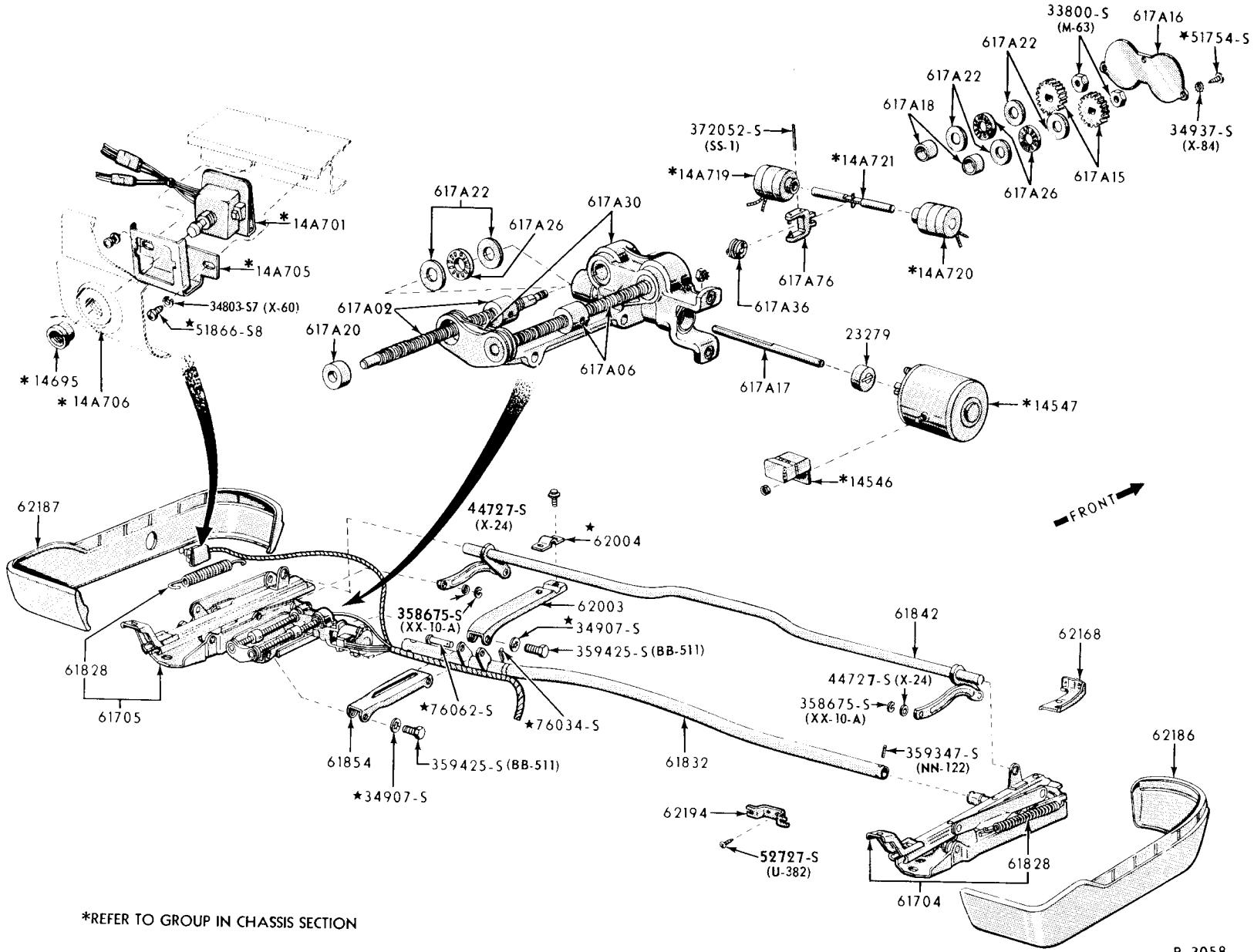

FRONT SEAT MECHANISM and RELATED PARTS - POWER FULL WIDTH
1960/64 FORD

*REFER TO GROUP IN CHASSIS SECTION

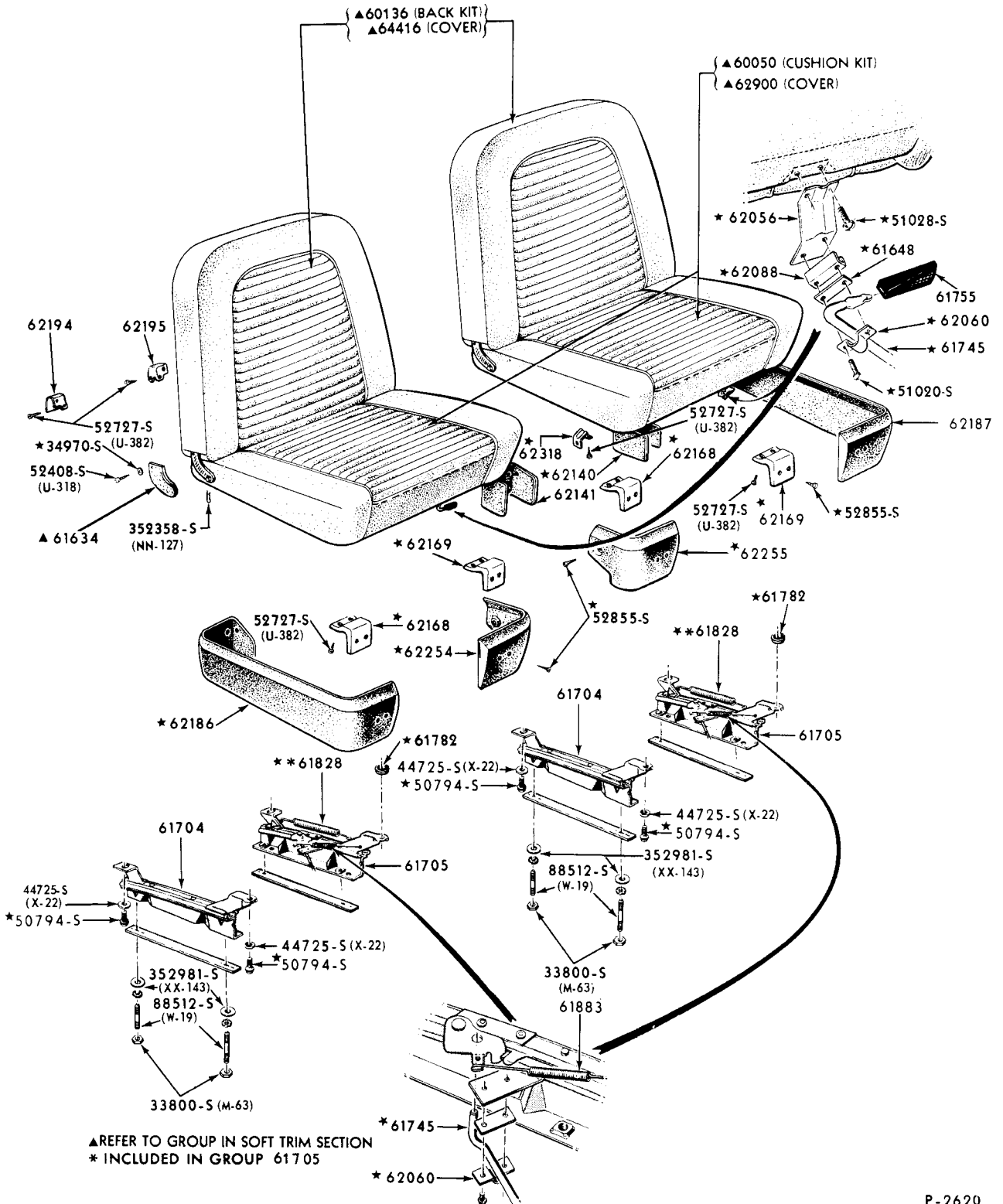

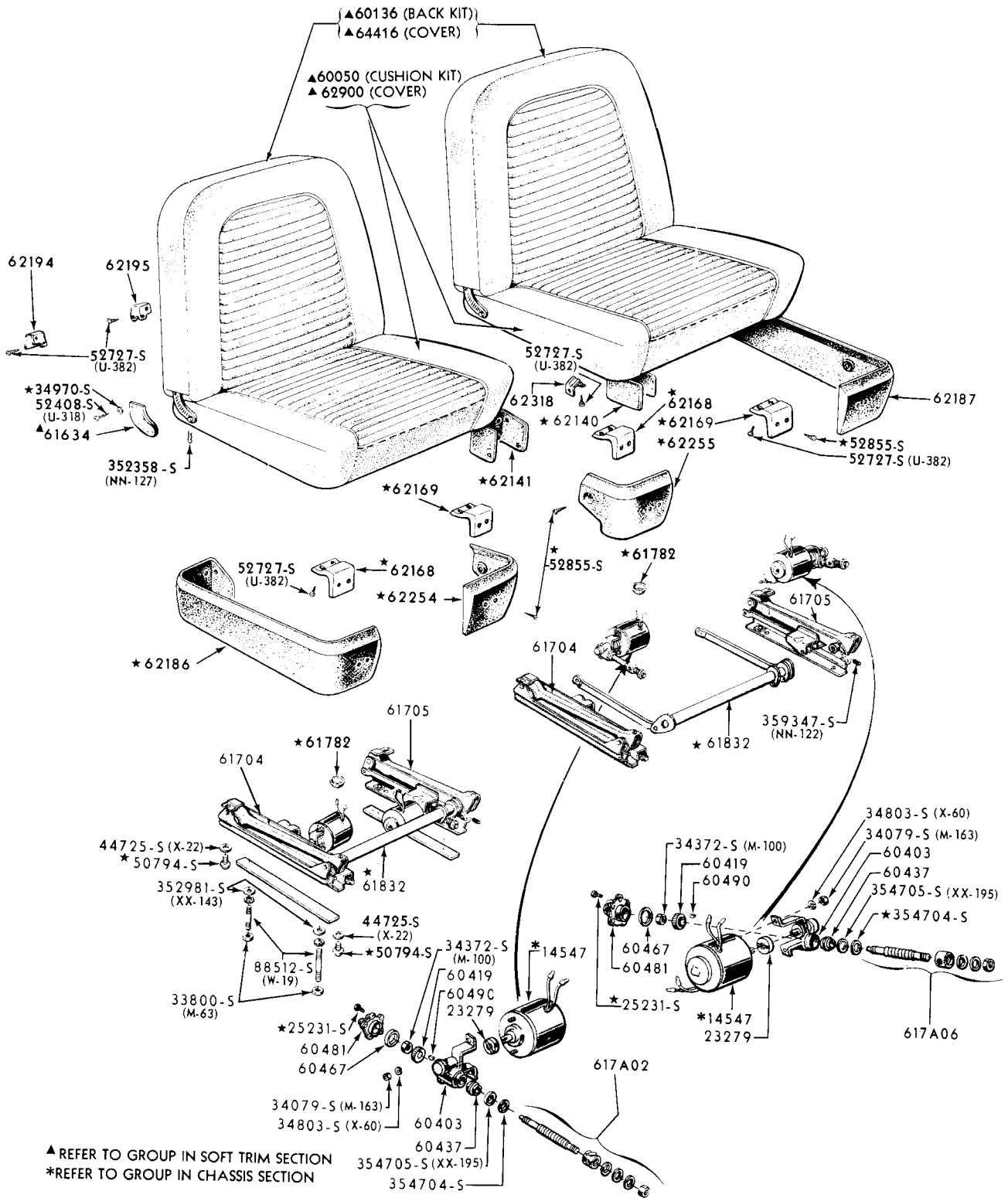

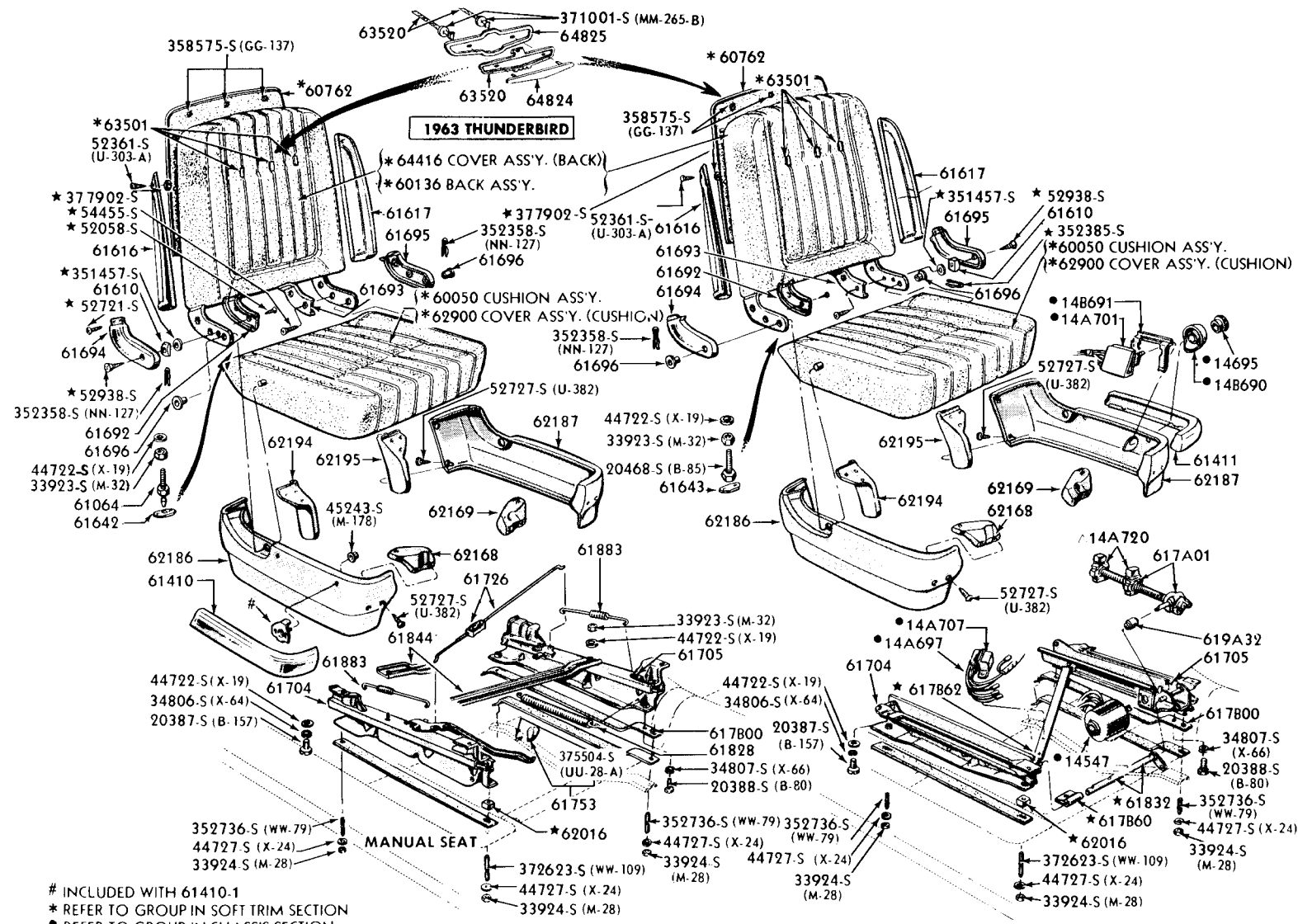

INCLUDED WITH 61410-1
 * REFER TO GROUP IN SOFT TRIM SECTION
 • REFER TO GROUP IN CHASSIS SECTION
 Δ ALSO SERVICED IN GROUP 61925 (SOLENOID REPAIR KIT)

1962/63 FORD - BODY TYPE 63C, 65B, 71G, 71H, 75C, 76B and 1963 THUNDERBIRD

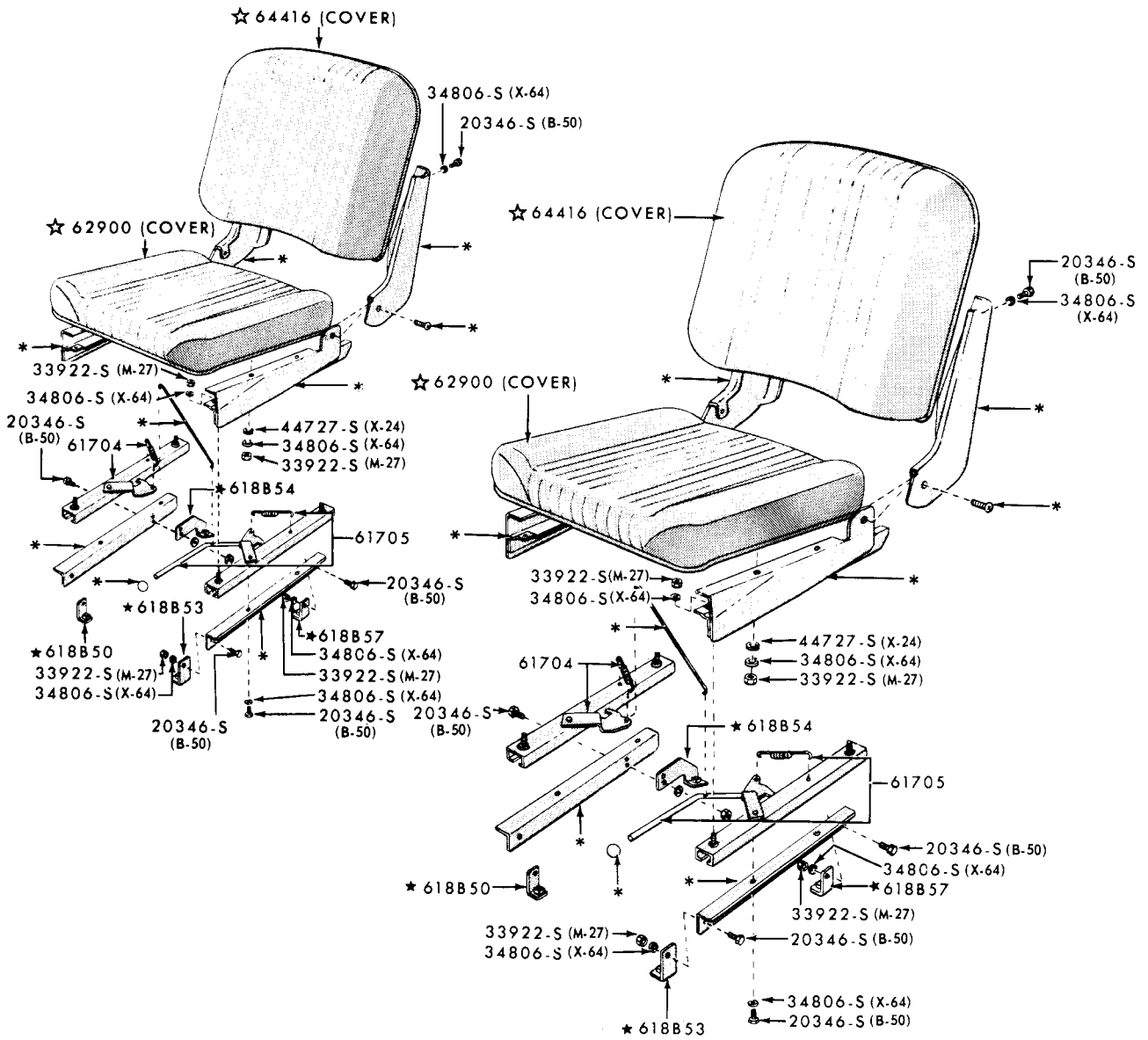

☆ REFER TO SOFT TRIM SECTION

* NOT SERVICED

P-4178

FRONT SEAT MECHANISM and RELATED PARTS - BOSTROM BUCKET

1963 FORD - BODY TYPE 54B, 54E, 62B, 62E

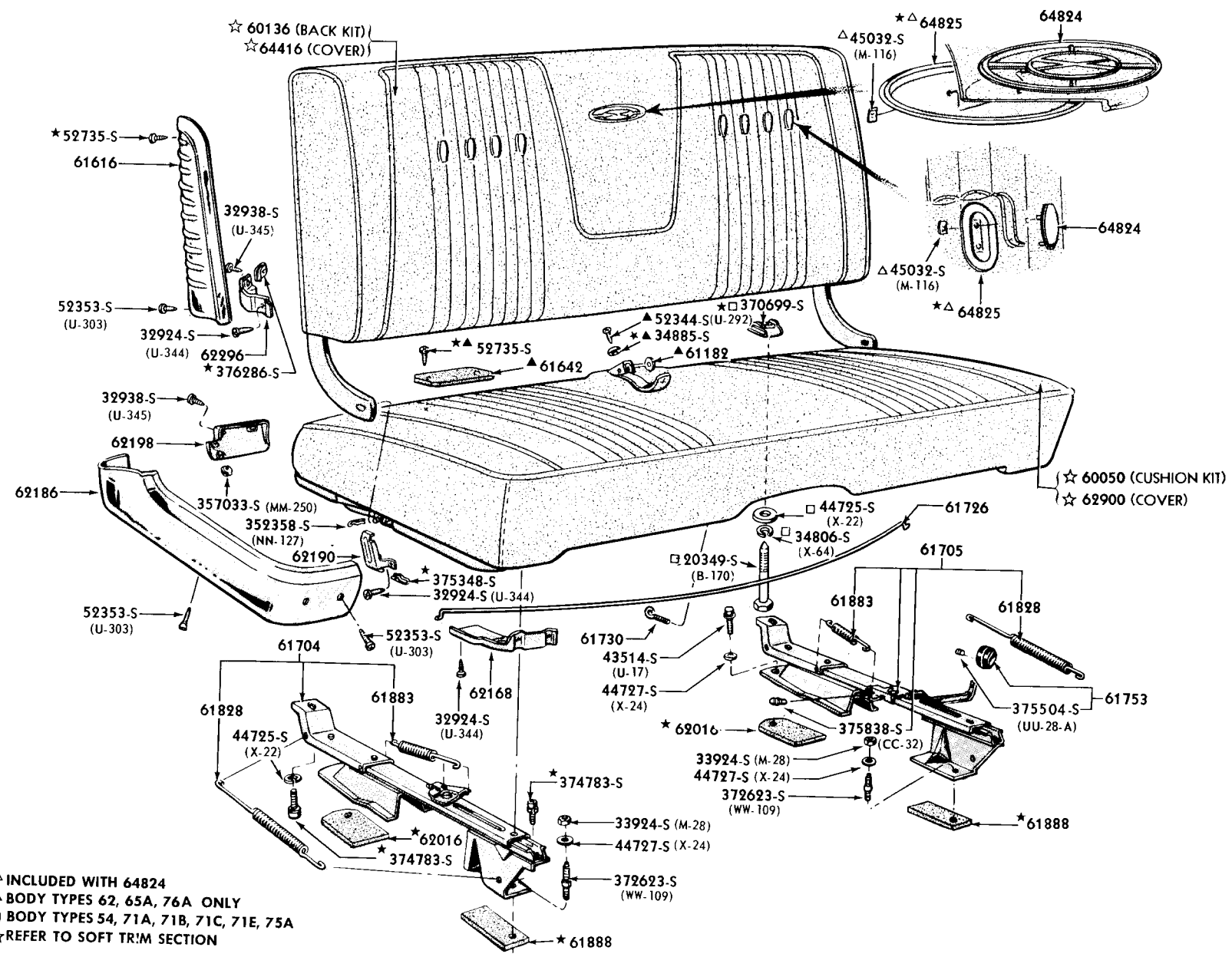

FRONT SEAT MECHANISM and RELATED PARTS - MANUAL FULL WIDTH
 1963/64 FORD

- △ INCLUDED WITH 64824
- ▲ BODY TYPES 62, 65A, 76A ONLY
- BODY TYPES 54, 71A, 71B, 71C, 71E, 75A
- ☆ REFER TO SOFT TRIM SECTION

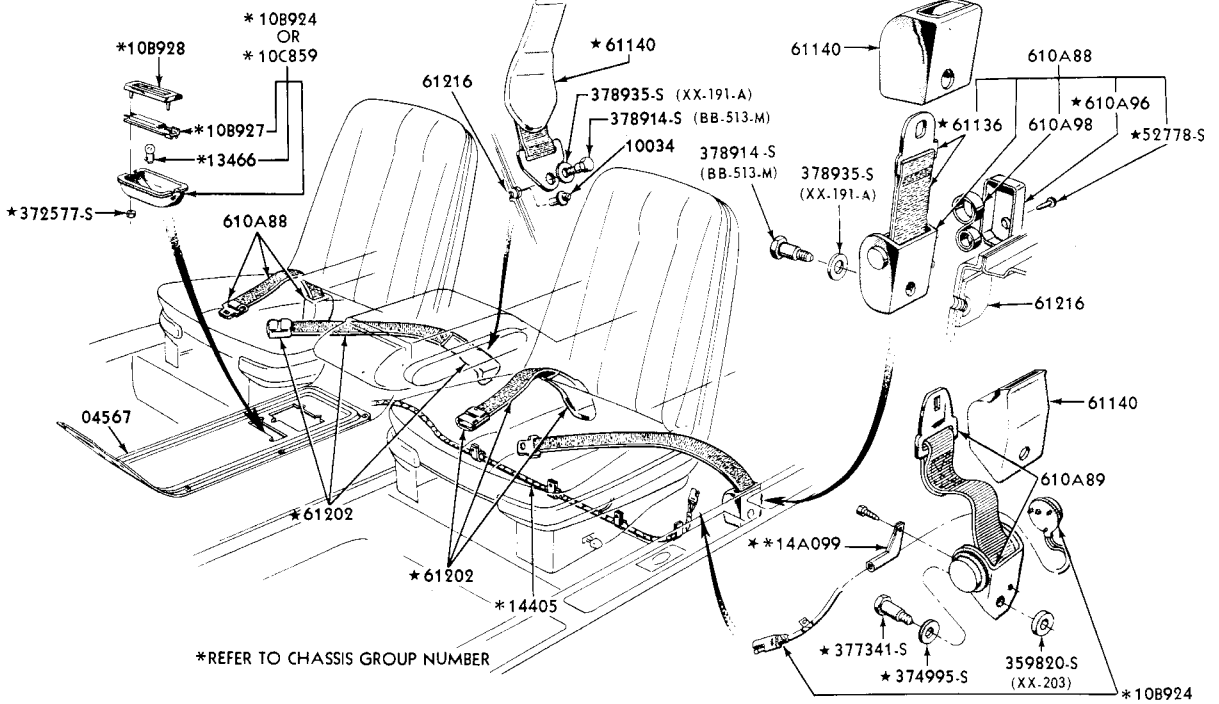

**SEAT BELT INSTALLATION
1964/ THUNDERBIRD**

P-4396

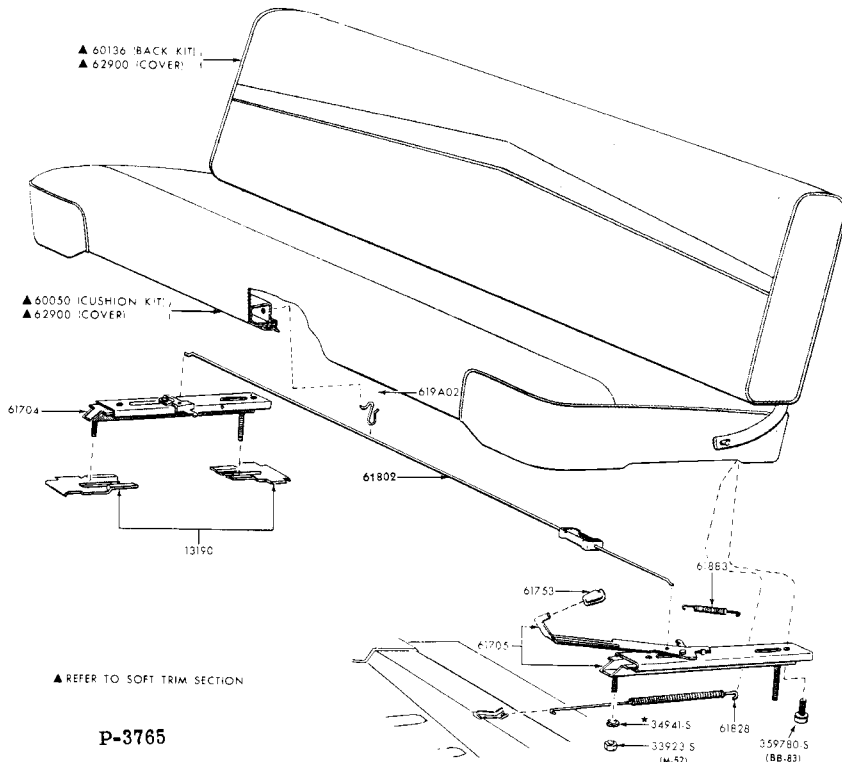

P-3765

**FRONT SEAT MECHANISMS AND RELATED PARTS - MANUAL FULL WIDTH
1962/ FAIRLANE**

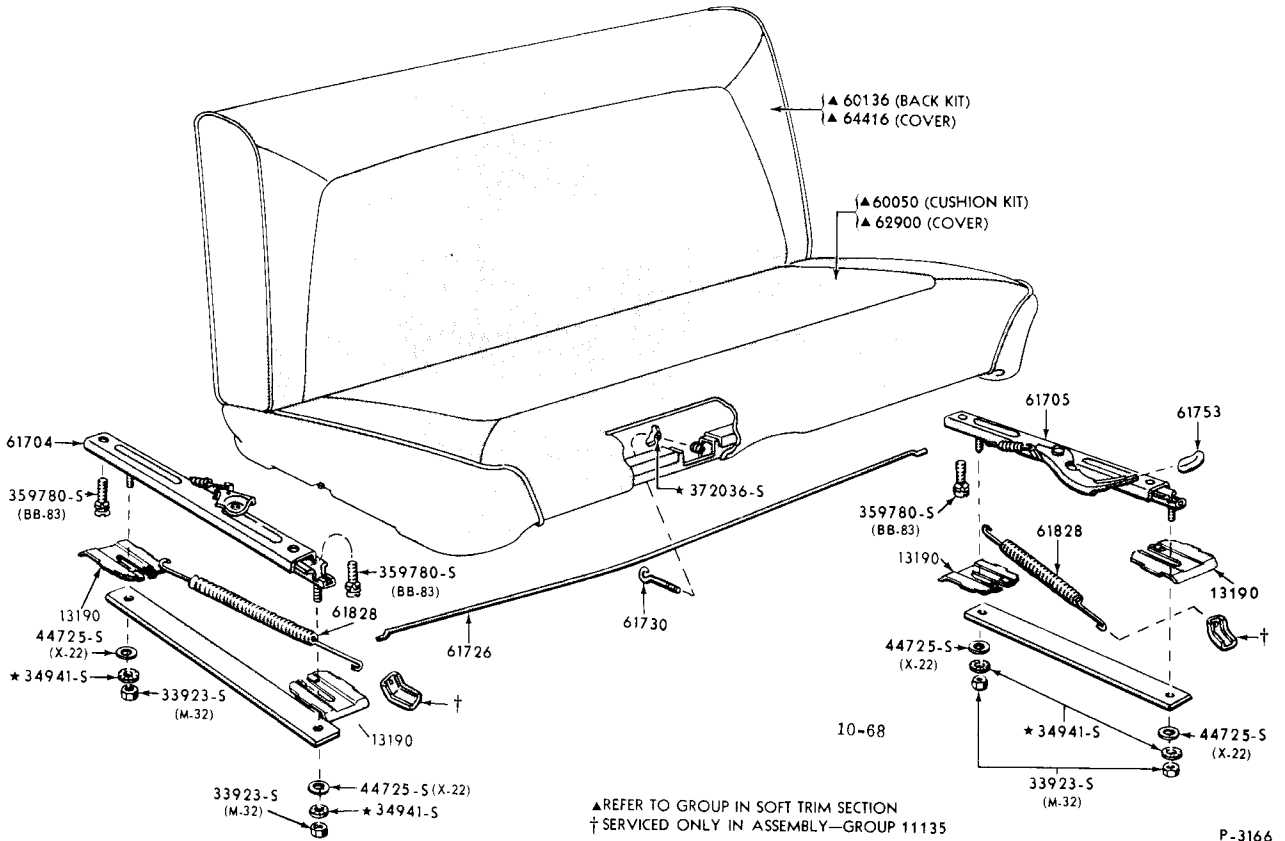

FRONT SEAT MECHANISM and RELATED PARTS - MANUAL FULL WIDTH
1960/ FALCON

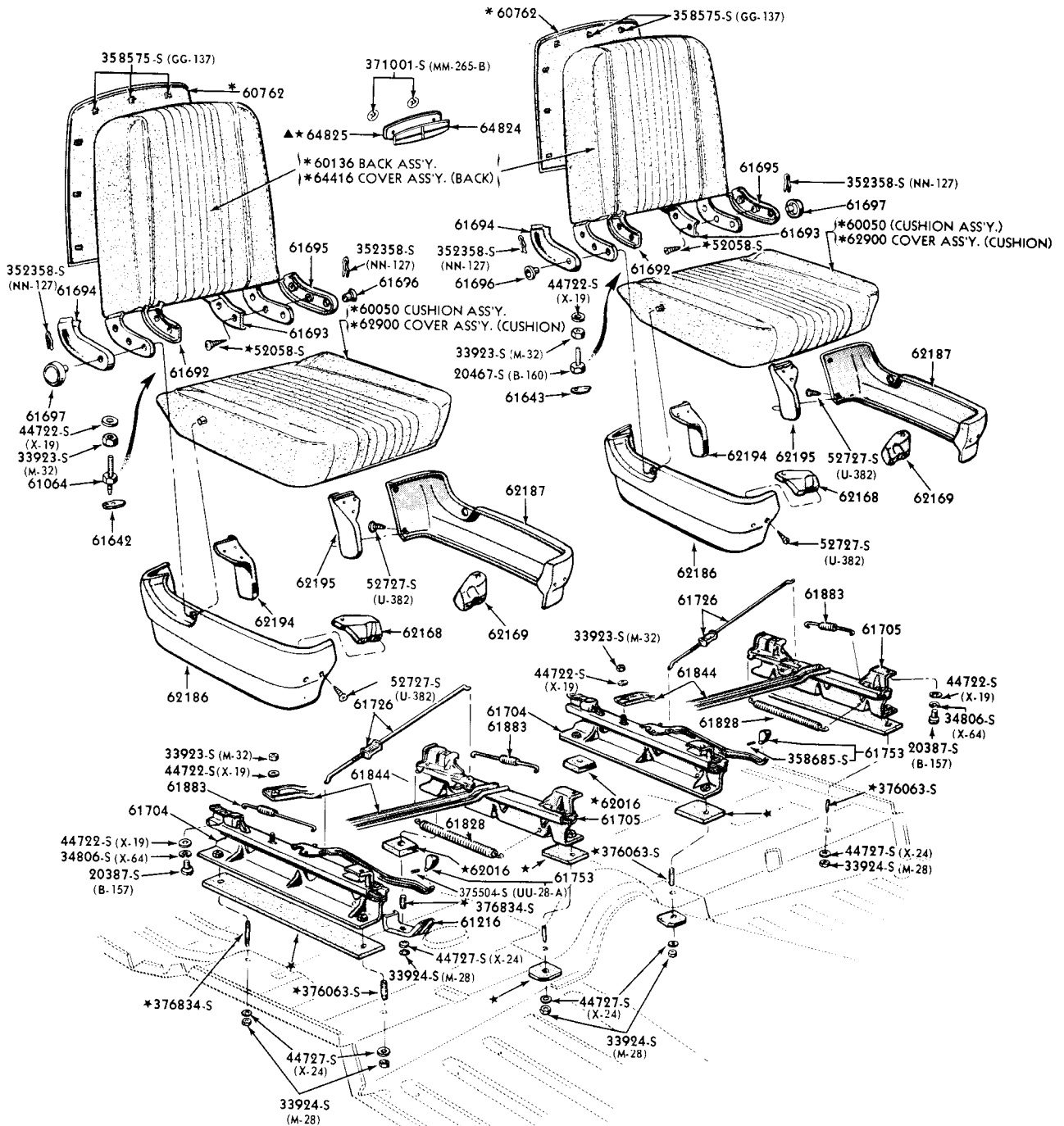

* REFER TO GROUP IN SOFT TRIM SECTION
▲ SUPPLIED WITH GROUP 64824

P-3859

FRONT SEAT MECHANISM and RELATED PARTS - MANUAL BUCKET

1962 FAIRLANE - BODY TYPE 62C, 1963 FAIRLANE - BODY TYPE 71G and 1963/ FALCON - BODY TYPE 76B, 76D

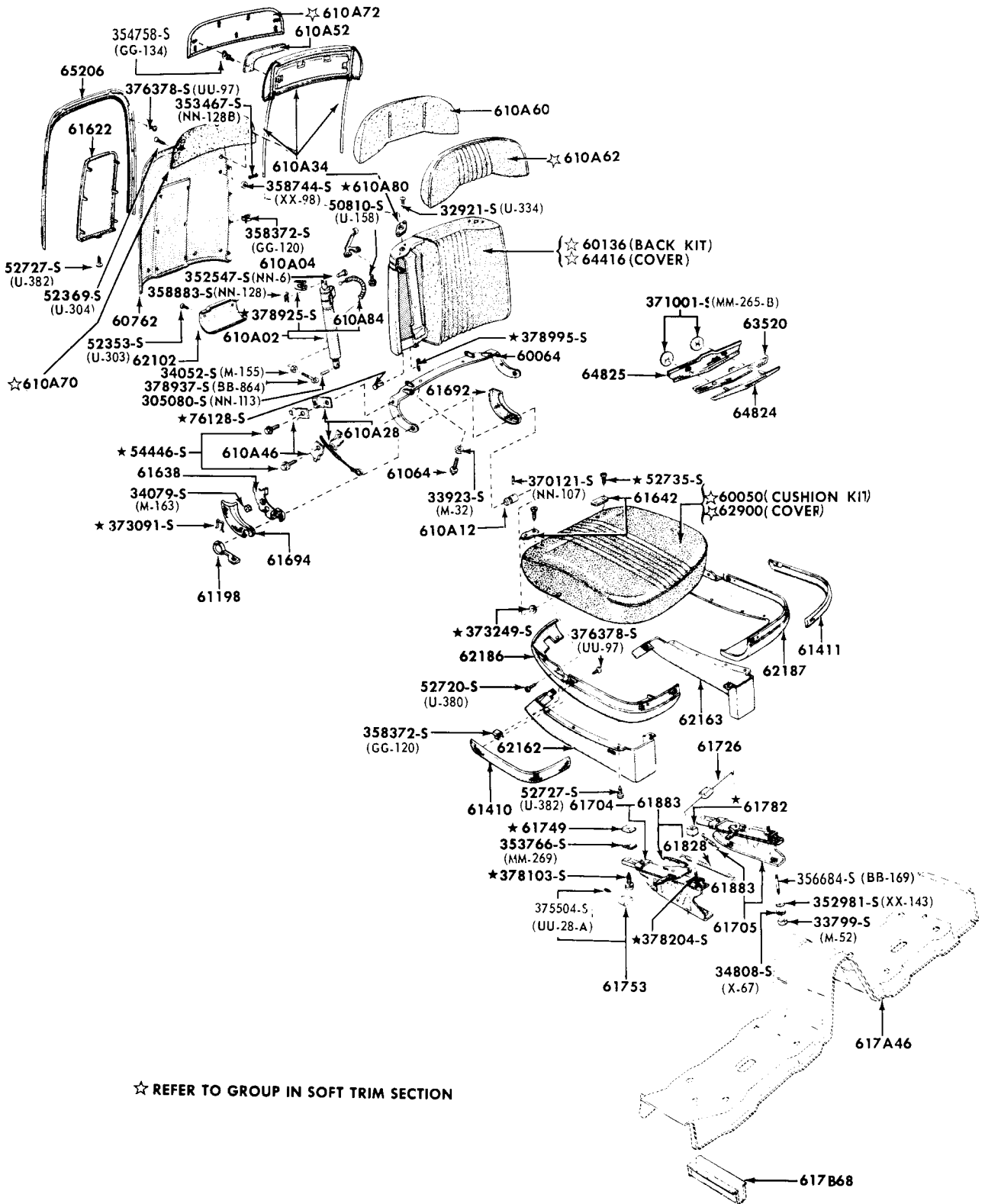

RECLINING SEAT, HEADREST and RELATED PARTS
1964 THUNDERBIRD

1960/61 FORD - BODY TYPE 59, 71 (8 PASSENGER)

REAR SEAT and RELATED PARTS

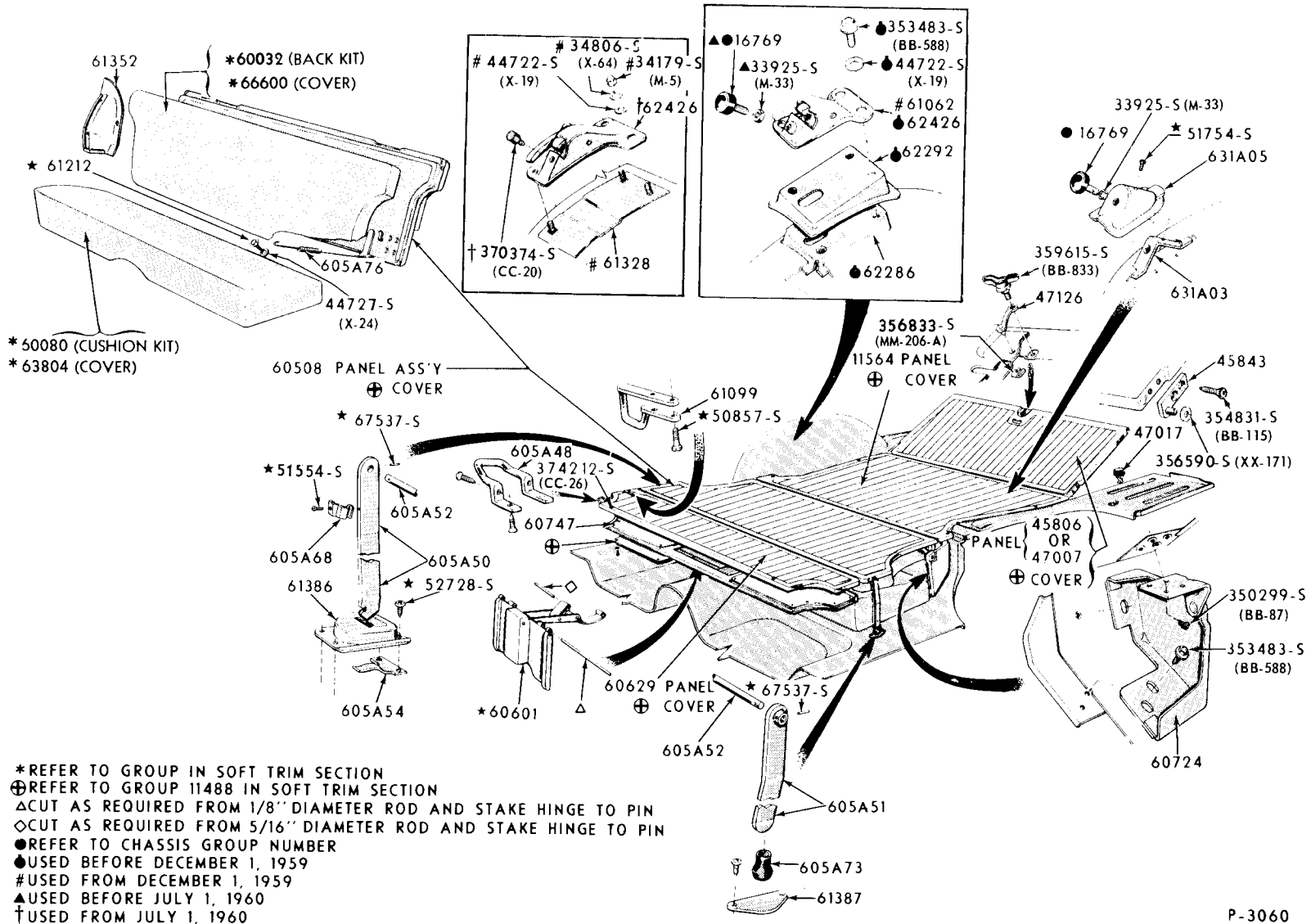

- * REFER TO GROUP IN SOFT TRIM SECTION
- ⊕ REFER TO GROUP 11488 IN SOFT TRIM SECTION
- Δ CUT AS REQUIRED FROM 1/8" DIAMETER ROD AND STAKE HINGE TO PIN
- ◇ CUT AS REQUIRED FROM 5/16" DIAMETER ROD AND STAKE HINGE TO PIN
- REFER TO CHASSIS GROUP NUMBER
- USED BEFORE DECEMBER 1, 1959
- # USED FROM DECEMBER 1, 1959
- ▲ USED BEFORE JULY 1, 1960
- † USED FROM JULY 1, 1960

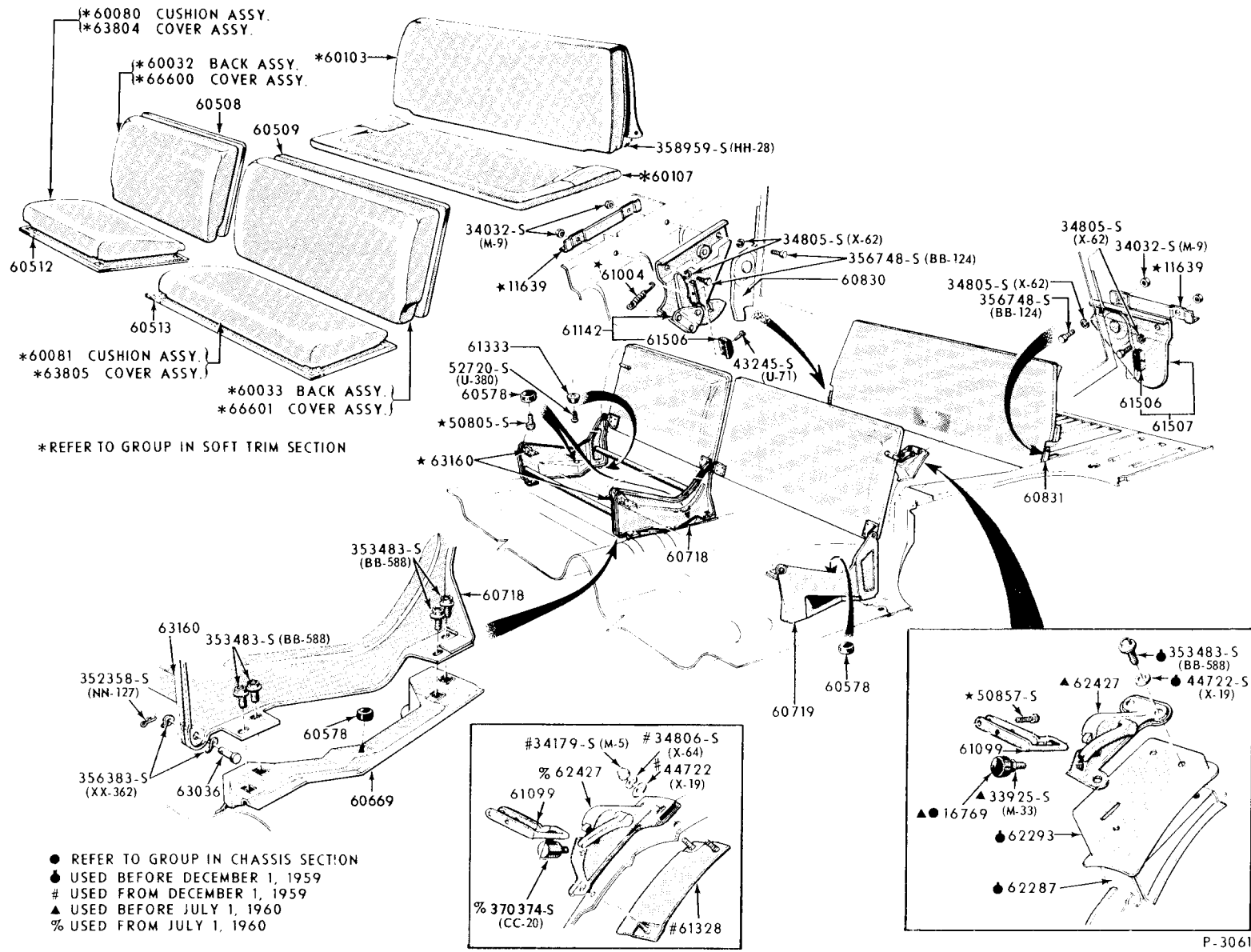

* REFER TO GROUP IN SOFT TRIM SECTION

- REFER TO GROUP IN CHASSIS SECTION
- USED BEFORE DECEMBER 1, 1959
- # USED FROM DECEMBER 1, 1959
- ▲ USED BEFORE JULY 1, 1960
- % USED FROM JULY 1, 1960

REAR and AUXILIARY SEATS and RELATED PARTS
1960/64 FORD - BODY TYPE 71 (9 PASSENGER)

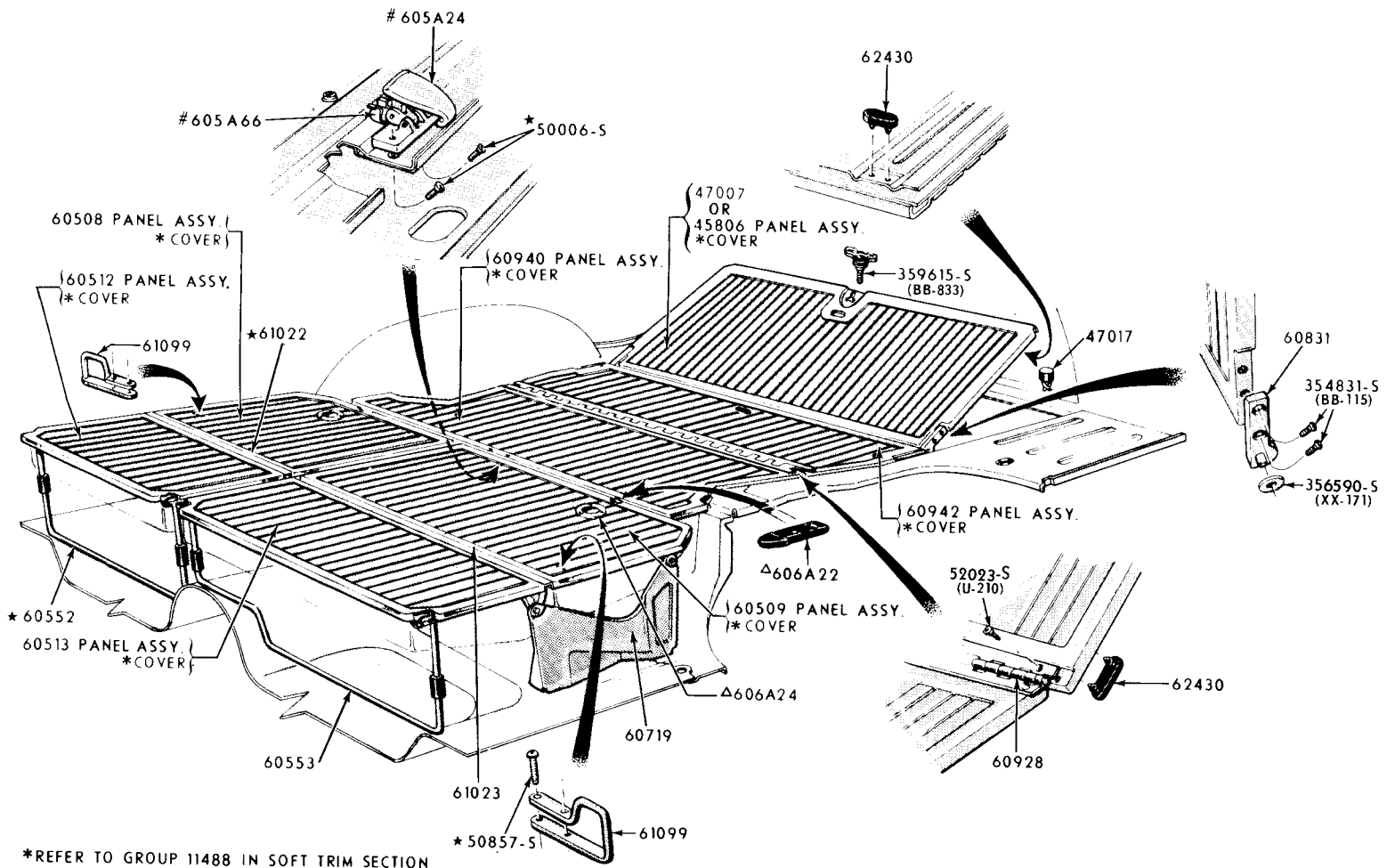

REAR and AUXILIARY SEATS and RELATED PARTS - FOLDED
1960/64 FORD - BODY TYPE 71 (9 PASSENGER)

*REFER TO GROUP 11488 IN SOFT TRIM SECTION
Δ1961/62
#1960

REAR SEAT and RELATED PARTS
1960, FALCON - BODY TYPE 59, 71

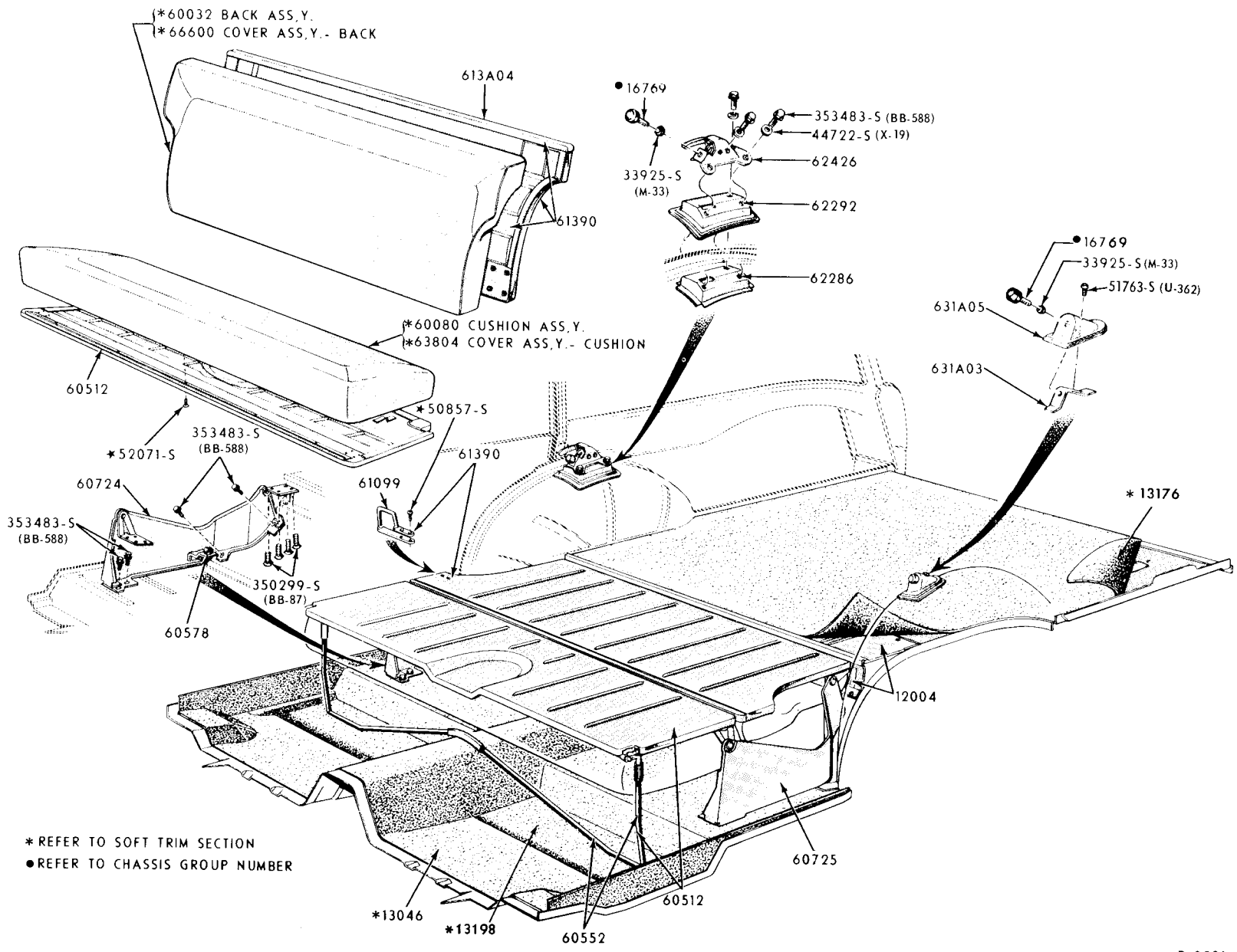

* REFER TO SOFT TRIM SECTION
 ● REFER TO CHASSIS GROUP NUMBER

FORD CAR PARTS BODY ILLUSTRATION SECTION 600

REAR SEAT, AUXILIARY FLOOR and RELATED PARTS
1963/ FAIRLANE - BODY TYPE 71

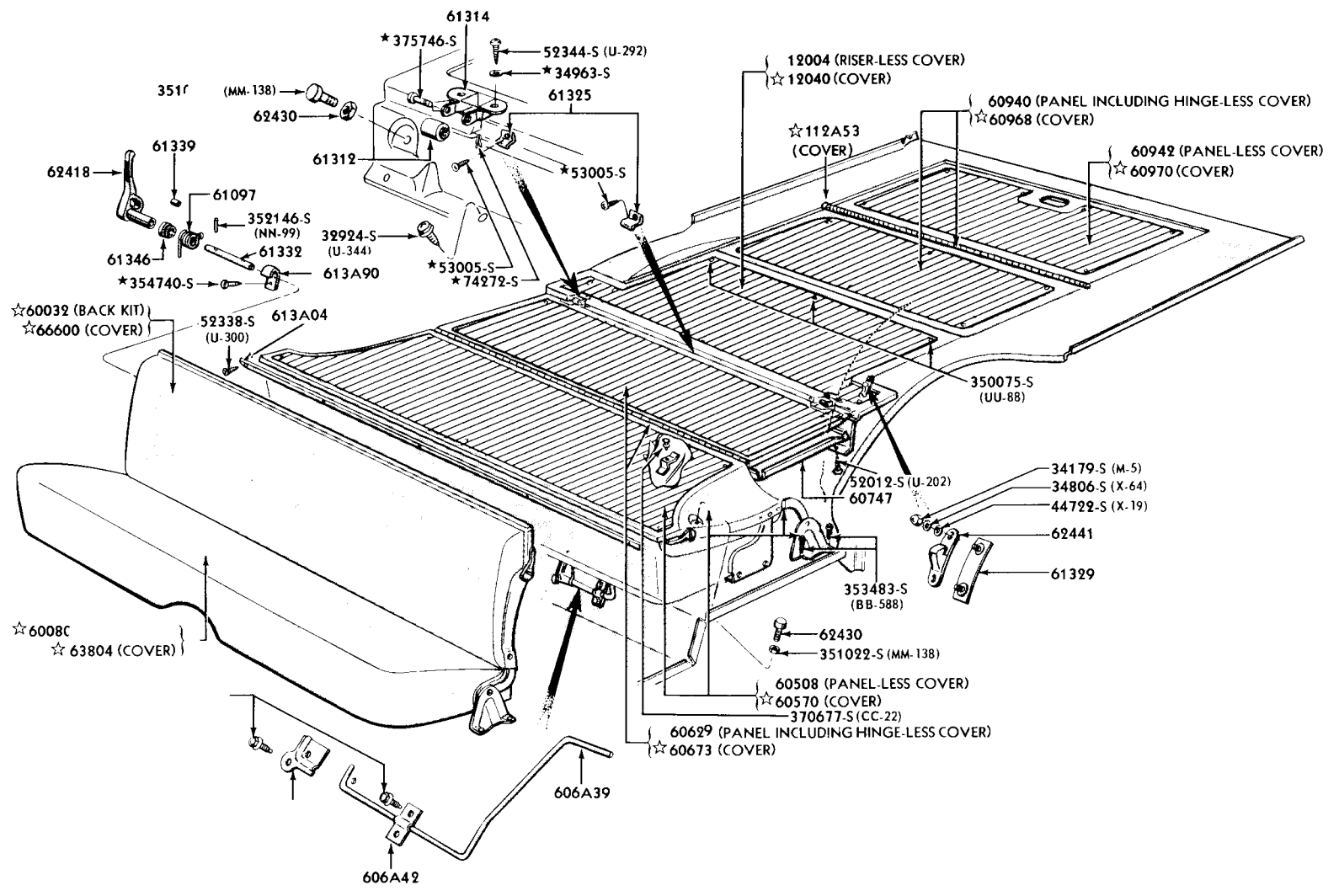

☆ REFER TO GROUP IN SOFT TRIM SECTION

P-4044

AUXILIARY SEAT, STORAGE COMPARTMENT and RELATED PARTS
1963/ FAIRLANE - BODY TYPE 71

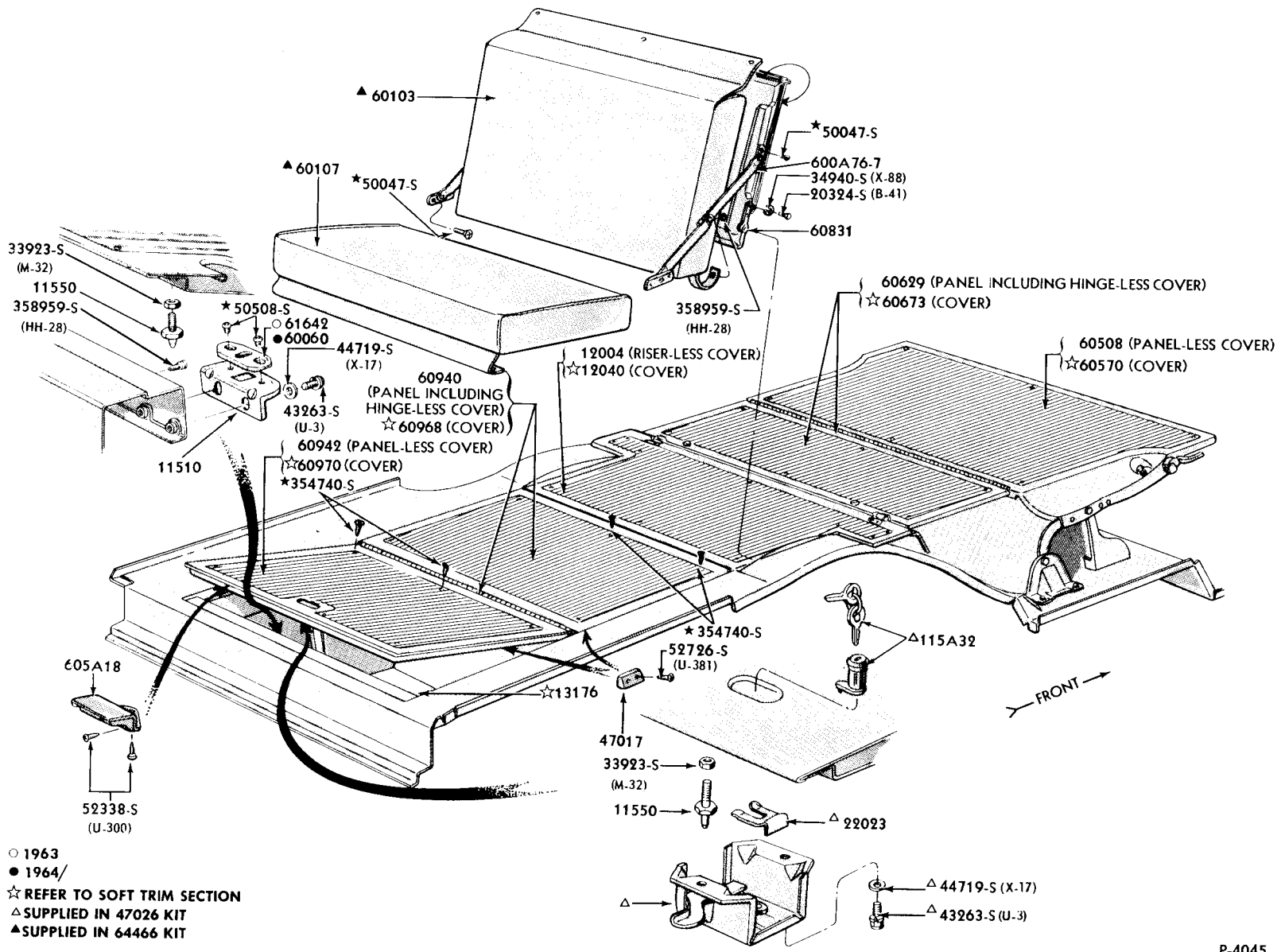

- 1963
- 1964/
- ☆ REFER TO SOFT TRIM SECTION
- ▲ SUPPLIED IN 47026 KIT
- ▲ SUPPLIED IN 64466 KIT