

INDEX

INCLUDED IN THIS INDEX ARE THE FOLLOWING MAJOR GROUPS IN THE ORDER SHOWN BELOW:

FENDERS and RELATED PARTS
FENDER MOULDINGS and NAME PLATES

FRONT END PARTS
HOODS

YEAR	TITLE	ILLUS. NO.	SECTION	PAGE
FENDERS and RELATED PARTS				
1960	Fenders and Related Parts (Thunderbird)	P-2794	160	475
1961/63	Fenders and Related Parts (Thunderbird)	P-3251	160	481
1964/	Fenders and Related Parts (Thunderbird)	P-4246	160	493
1960	Fenders, Radiator Grille and Related Parts (Ford)	P-2952	160	474
1961/62	Fenders, Radiator Grille and Related Parts (Ford)	P-3220	160	478
1963	Fenders, Radiator Grille and Related Parts (Ford)	P-3934	160	485
1964	Fenders, Radiator Grille and Related Parts (Ford)	P-4221	160	489
1962	Fenders, Radiator Grille and Related Parts (Fairlane)	P-3720	160	483
1963/64	Fenders, Radiator Grille and Related Parts (Fairlane)	P-3926	160	487
1960	Fenders, Radiator Grille and Related Parts (Falcon)	P-3105	160	476
1961	Fenders, Radiator Grille and Related Parts (Falcon)	P-3283	160	480
1962/63	Fenders, Radiator Grille and Related Parts (Falcon)	P-3648	160	484
1964/	Fenders, Radiator Grille and Related Parts (Falcon)	P-4206	160	492
FENDER MOULDINGS AND NAME PLATES				
1960	Fender Mouldings and Name plates (Ford)	P-2552	160	474
1961	Fender Mouldings and Name Plates (Ford)	P-3244	160	477
1962	Fender Mouldings and Name Plates (Ford)	P-3633	160	479
1963	Fender Mouldings and Name Plates (Ford)	P-4069	160	486
1964	Fender Mouldings and Name Plates (Ford)	P-4431	160	490
1962	Fender Mouldings and Name Plates (Fairlane)	P-3720	160	483
1963	Fender Mouldings and Name Plates (Fairlane)	P-4077	160	488
1964	Fender Mouldings and Name Plates (Fairlane)	P-4433	160	488
1960	Fender Mouldings and Name Plates (Falcon)	P-3105	160	476
1961	Fender Mouldings and Name Plates (Falcon)	P-3283	160	480
1962/63	Fender Mouldings and Name Plates (Falcon)	P-3648	160	484
1964	Fender Mouldings and Name Plates (Falcon)	P-4434	160	491
FRONT END PARTS				
1961/63	Front End Parts (Thunderbird)	P-3250	160	482
1964/	Front End Parts (Thunderbird)	P-4247	160	494
HOODS				
1960	Hood and Related Parts (Ford)	P-2953	166	496
1961	Hood and Related Parts (Ford)	P-3224	166	497
1962	Hood and Related Parts (Ford)	P-3725	166	498
1963/64	Hood and Related Parts (Ford)	P-3938	166	498
1962	Hood and Related Parts (Fairlane)	P-3722	166	499
1963/64	Hood and Related Parts (Fairlane)	P-3915	166	500
1960/61	Hood and Related Parts (Falcon)	P-3107	166	496
1962/63	Hood and Related Parts (Falcon)	P-3649	166	499
1964/	Hood and Related Parts (Falcon)	P-4255	166	501
1960	Hood and Related Parts (Thunderbird)	P-2652	166	495
1961/63	Hood and Related Parts (Thunderbird)	P-3252	166	497
1964/	Hood and Related Parts (Thunderbird)	P-4222	166	501

1960 FENDERS, MOULDINGS, RADIATOR GRILLE & RELATED PARTS (FORD)

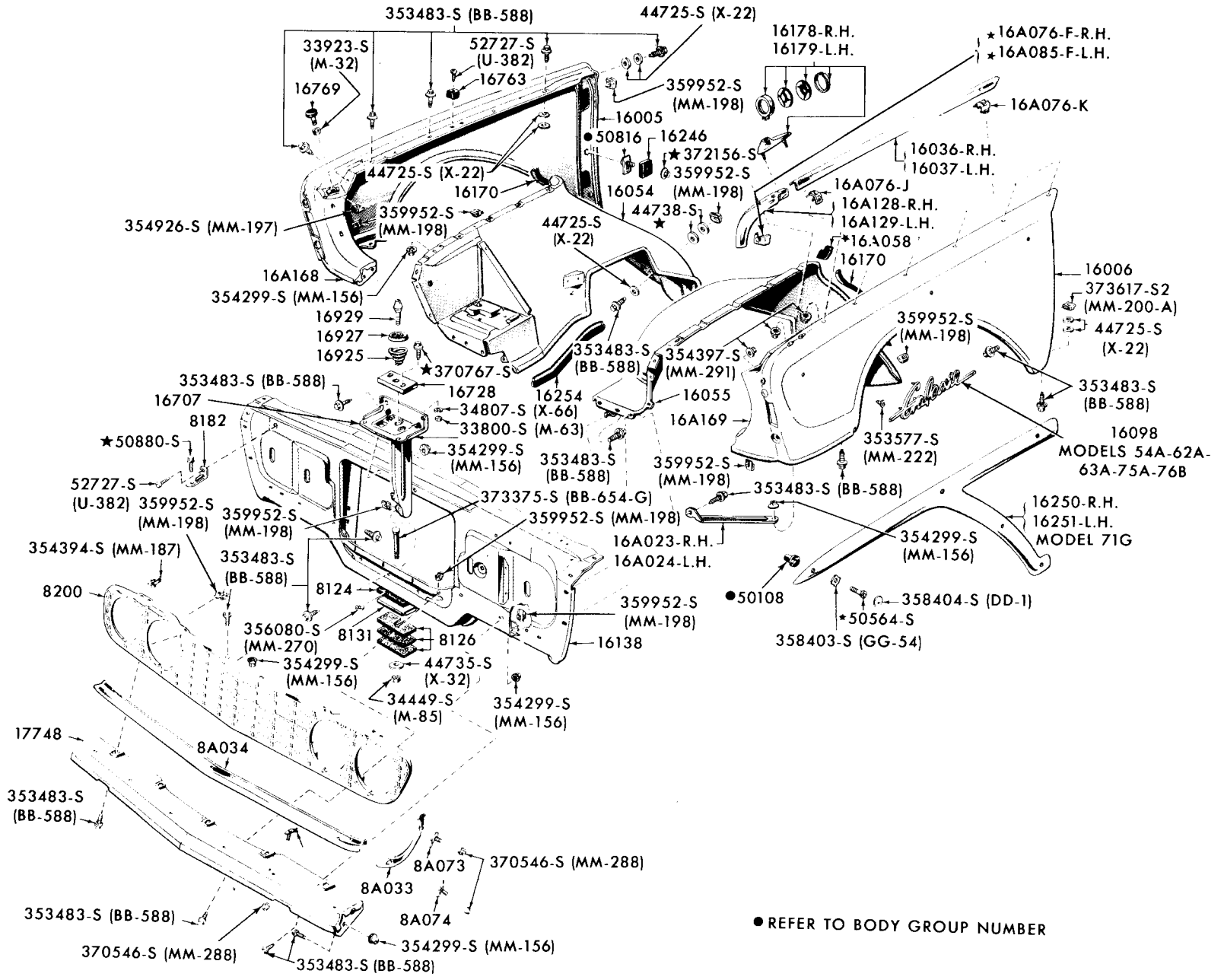

● REFER TO BODY GROUP NUMBER

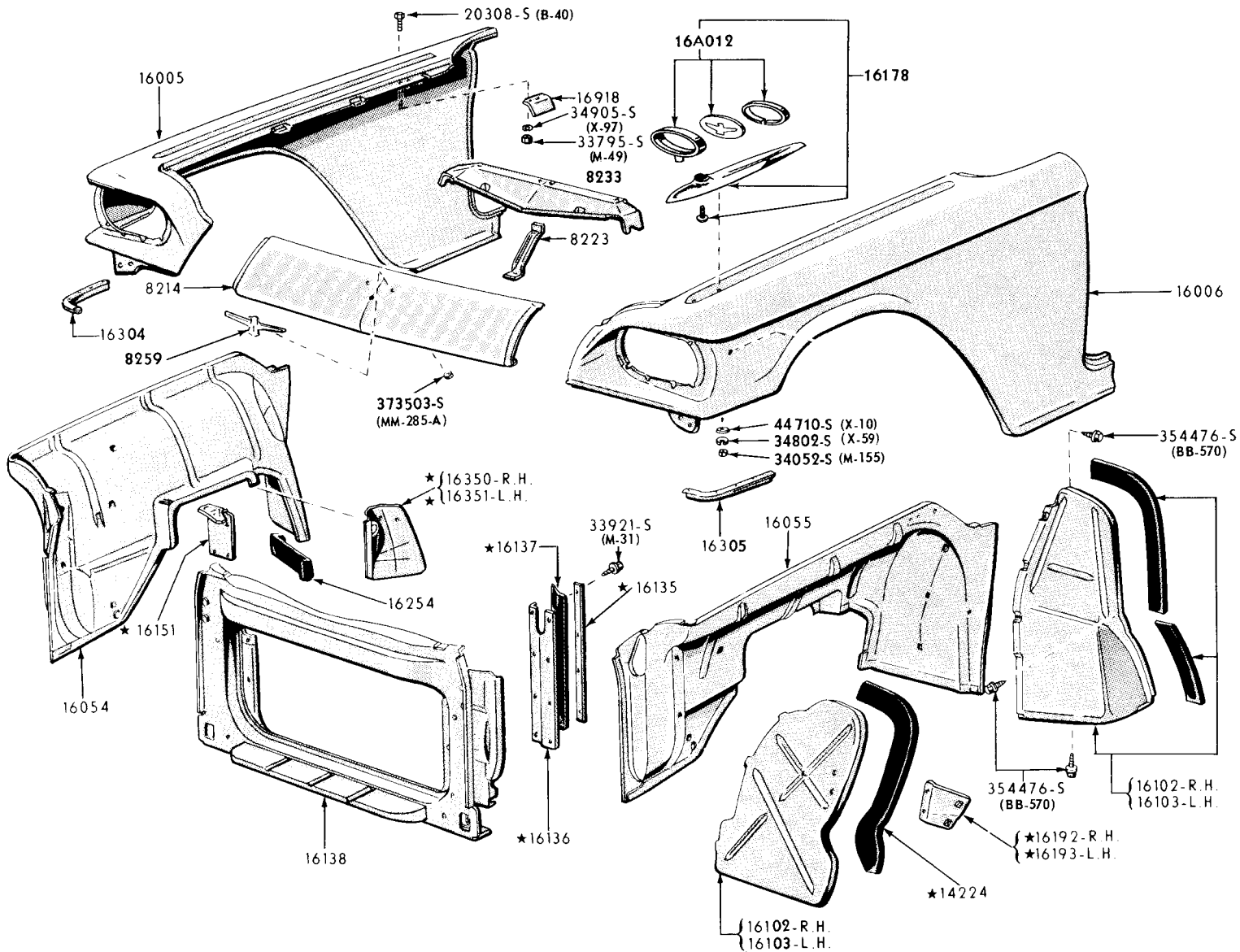

1960 FENDERS, NAME PLATES, RADIATOR GRILLE & RELATED PARTS (FALCON)

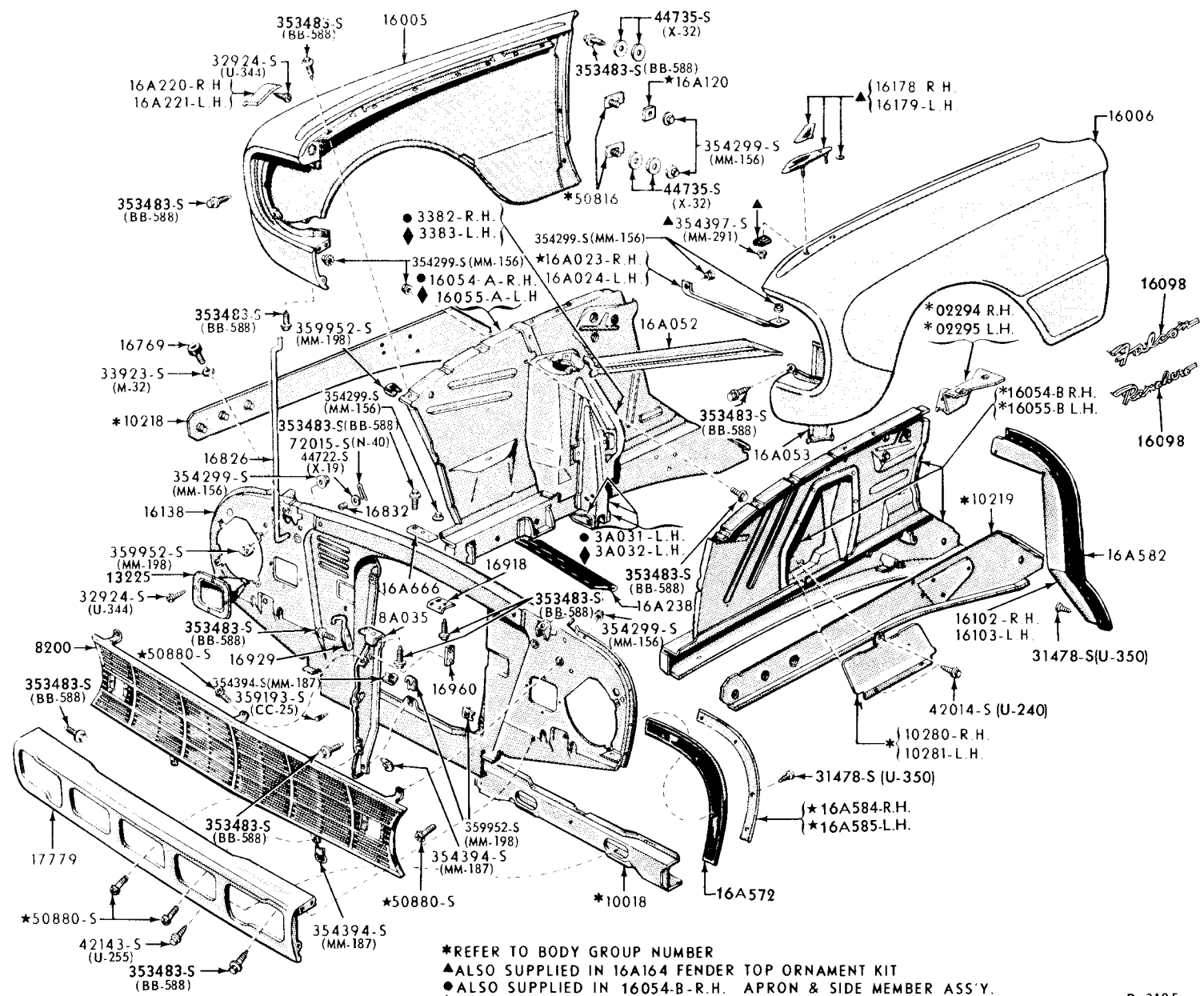

- *REFER TO BODY GROUP NUMBER
- ▲ALSO SUPPLIED IN 16A164 FENDER TOP ORNAMENT KIT
- ◆ALSO SUPPLIED IN 16054-B-R.H. APRON & SIDE MEMBER ASS'Y.
- ◆ALSO SUPPLIED IN 16055-B-L.H. APRON & SIDE MEMBER ASS'Y.

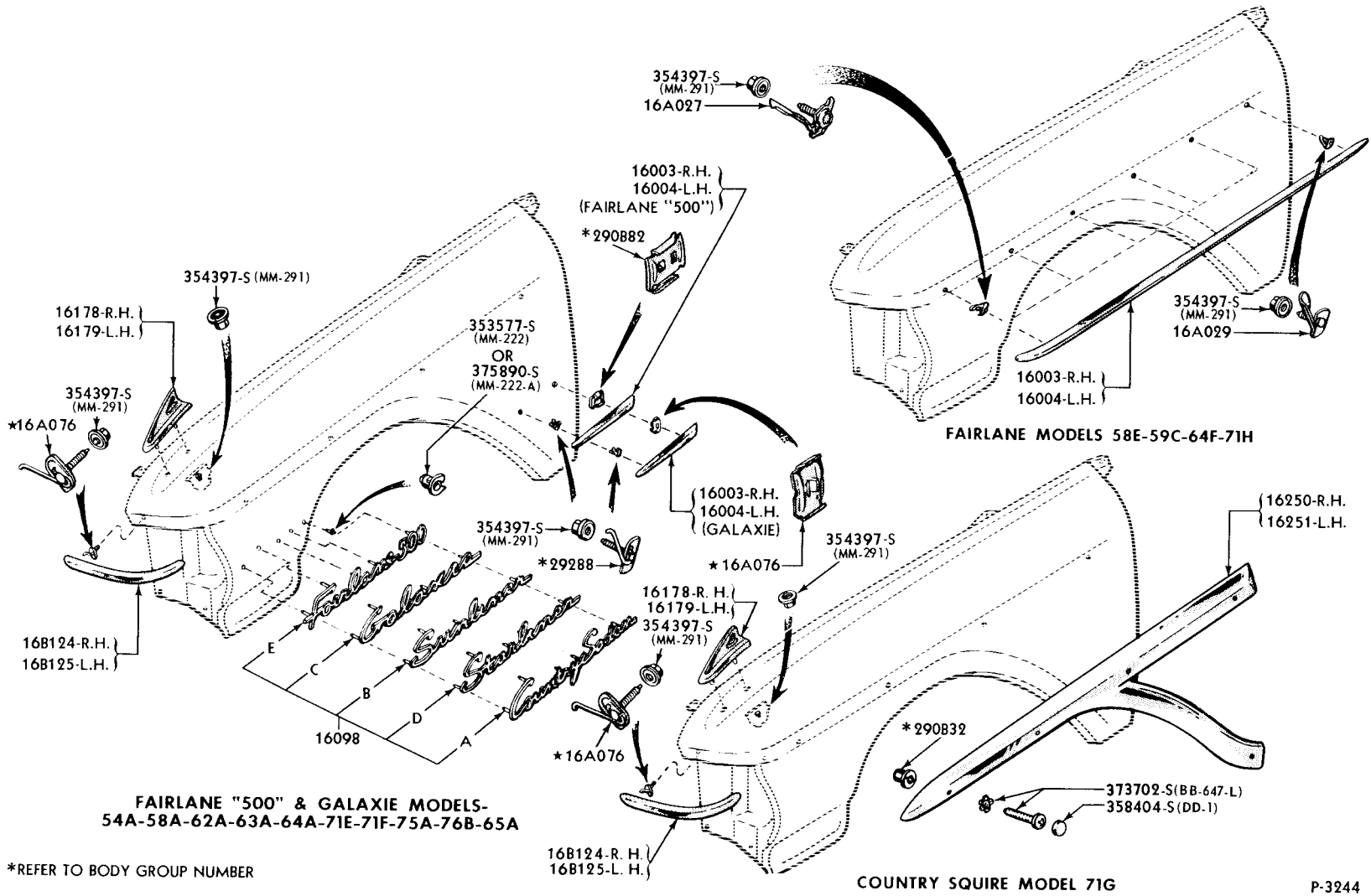

FAIRLANE "500" & GALAXIE MODELS-
54A-58A-62A-63A-64A-71E-71F-75A-76B-65A

FAIRLANE MODELS 58E-59C-64F-71H

COUNTRY SQUIRE MODEL 71G

*REFER TO BODY GROUP NUMBER

1961/62 FENDERS, RADIATOR GRILLE & RELATED PARTS (FORD)

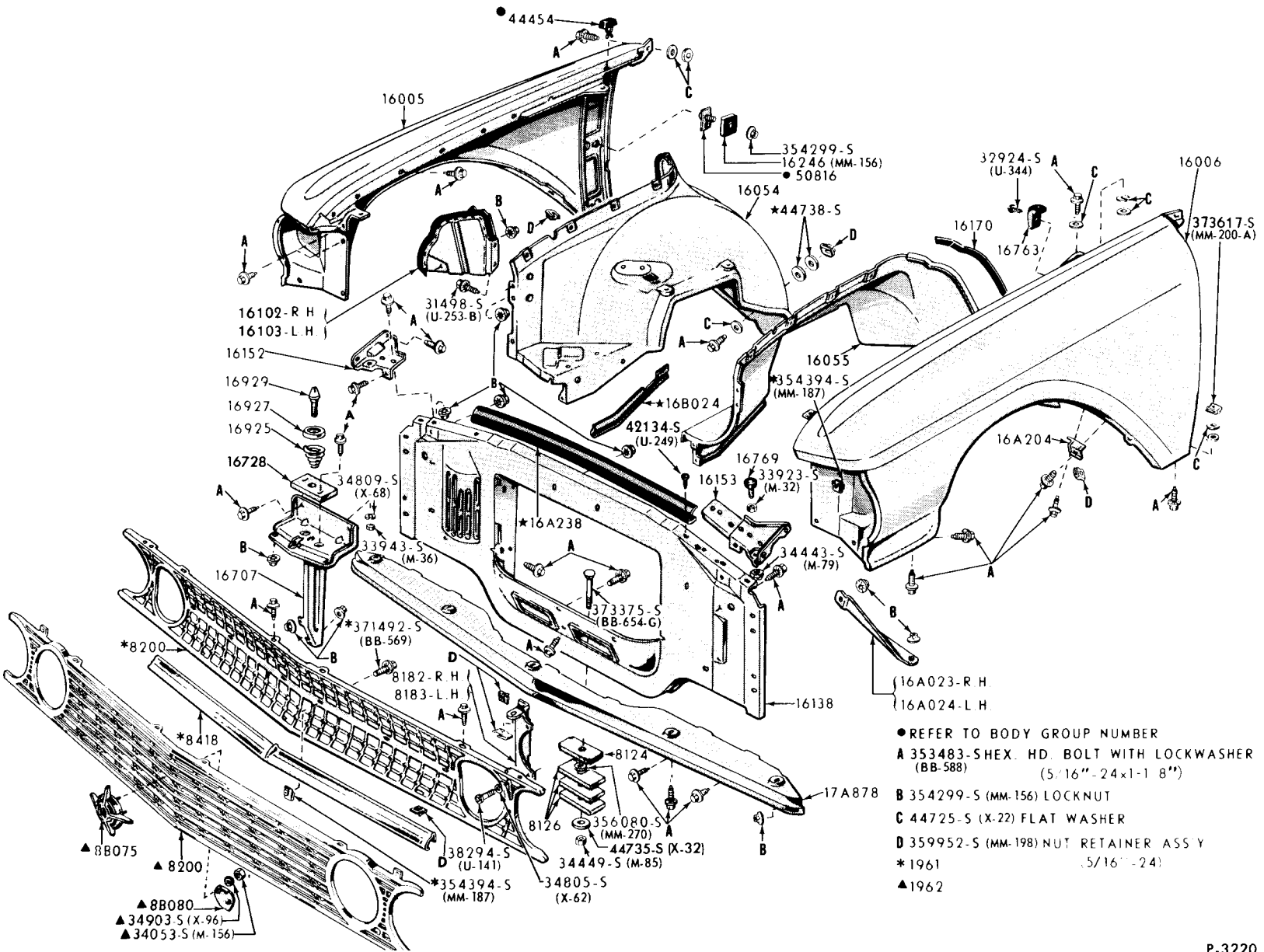

- REFER TO BODY GROUP NUMBER
- A 353483-SHEX. HD. BOLT WITH LOCKWASHER (BB-588) (5/16"-24x1-8")
- B 354299-S (MM-156) LOCKNUT
- C 44725-S (X-22) FLAT WASHER
- D 359952-S (MM-198) NUT RETAINER ASSY (5/16"-24)
- *1961
- ▲1962

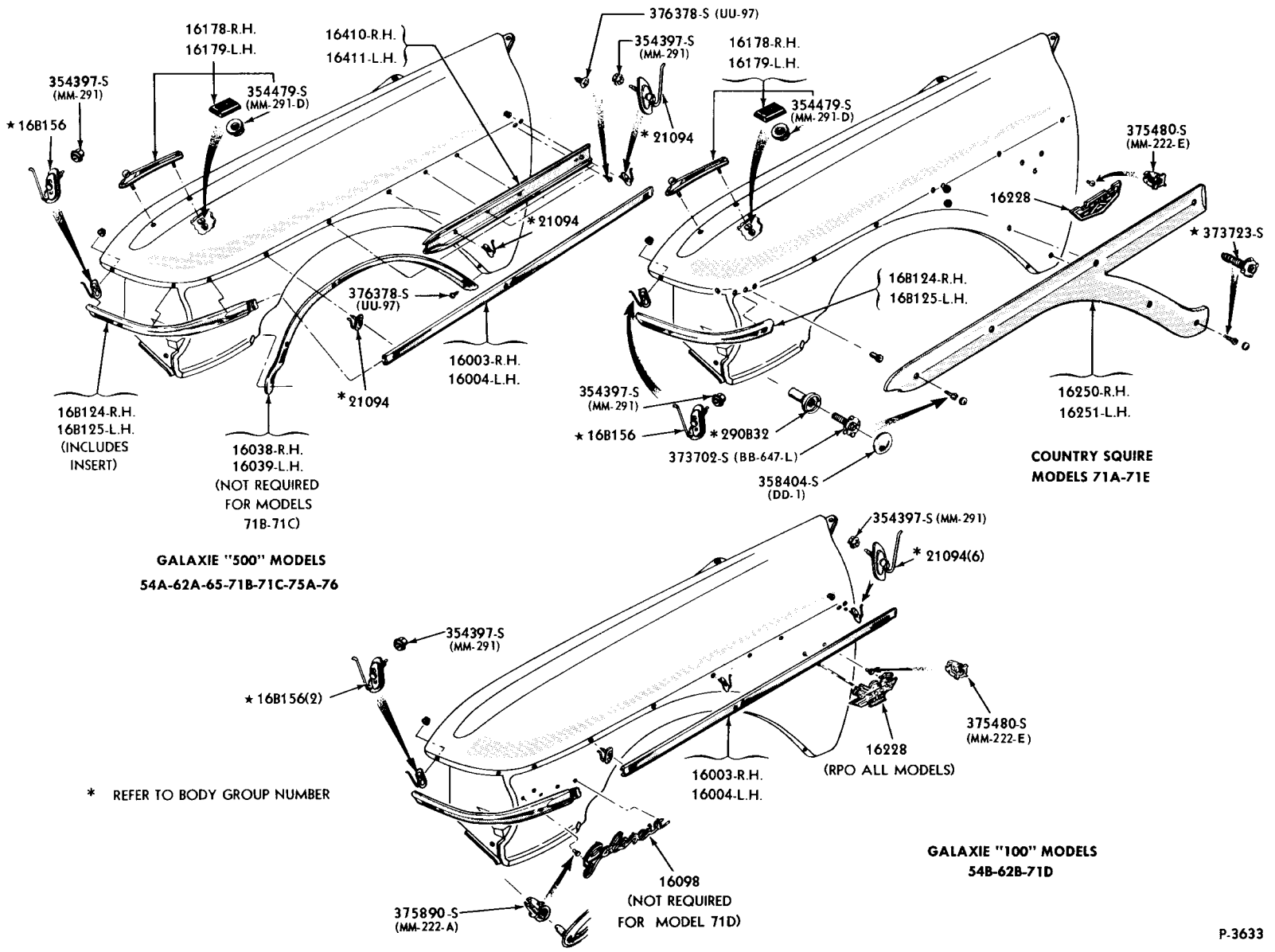

* REFER TO BODY GROUP NUMBER

1961 FENDERS, MOULDINGS, RADIATOR GRILLE & RELATED PARTS (FALCON)

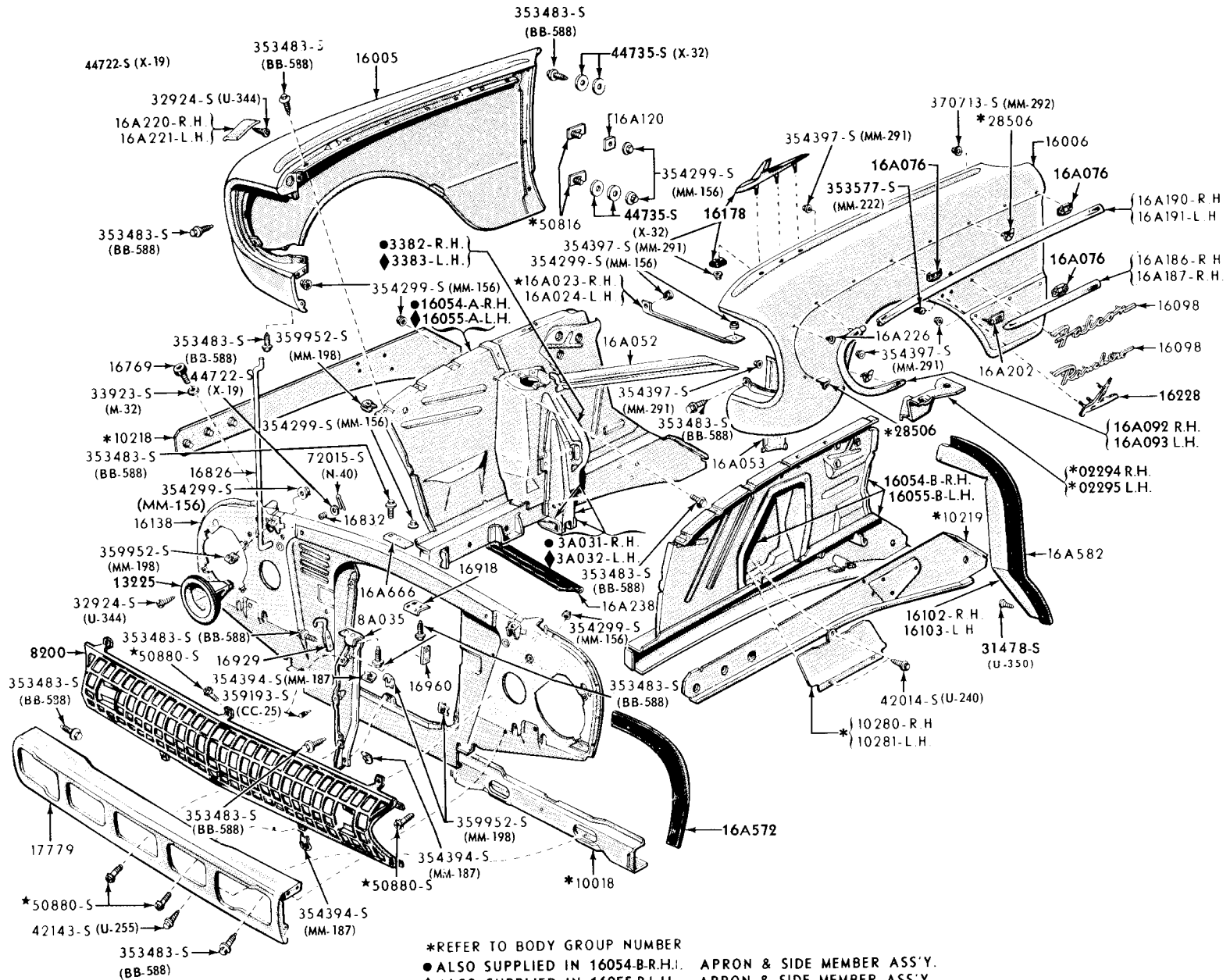

*REFER TO BODY GROUP NUMBER
 ● ALSO SUPPLIED IN 16054-B-R.H.: APRON & SIDE MEMBER ASS'Y.
 ◆ ALSO SUPPLIED IN 16055-B-L.H.: APRON & SIDE MEMBER ASS'Y.

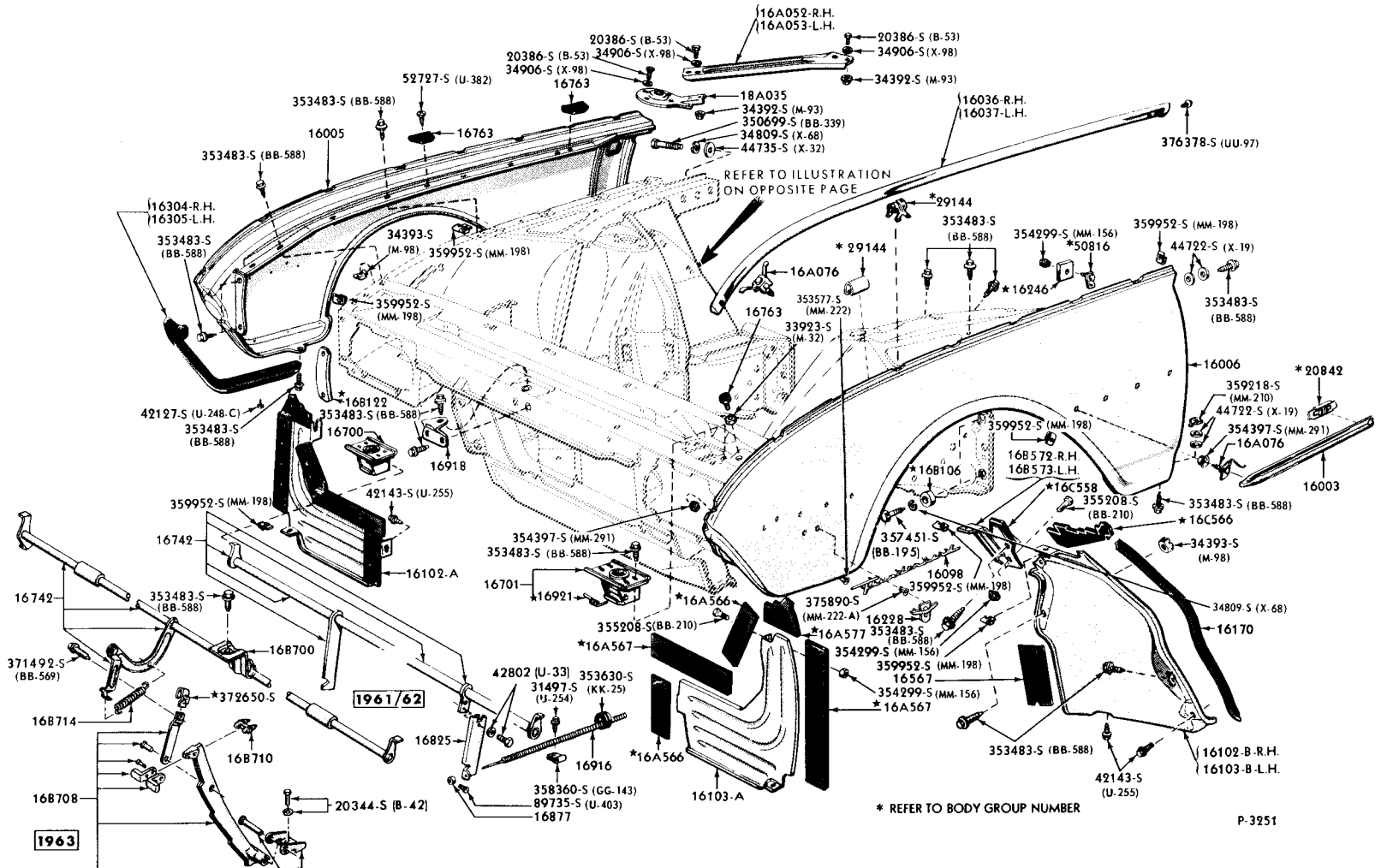

1961/63 FRONT END PARTS (THUNDERBIRD)

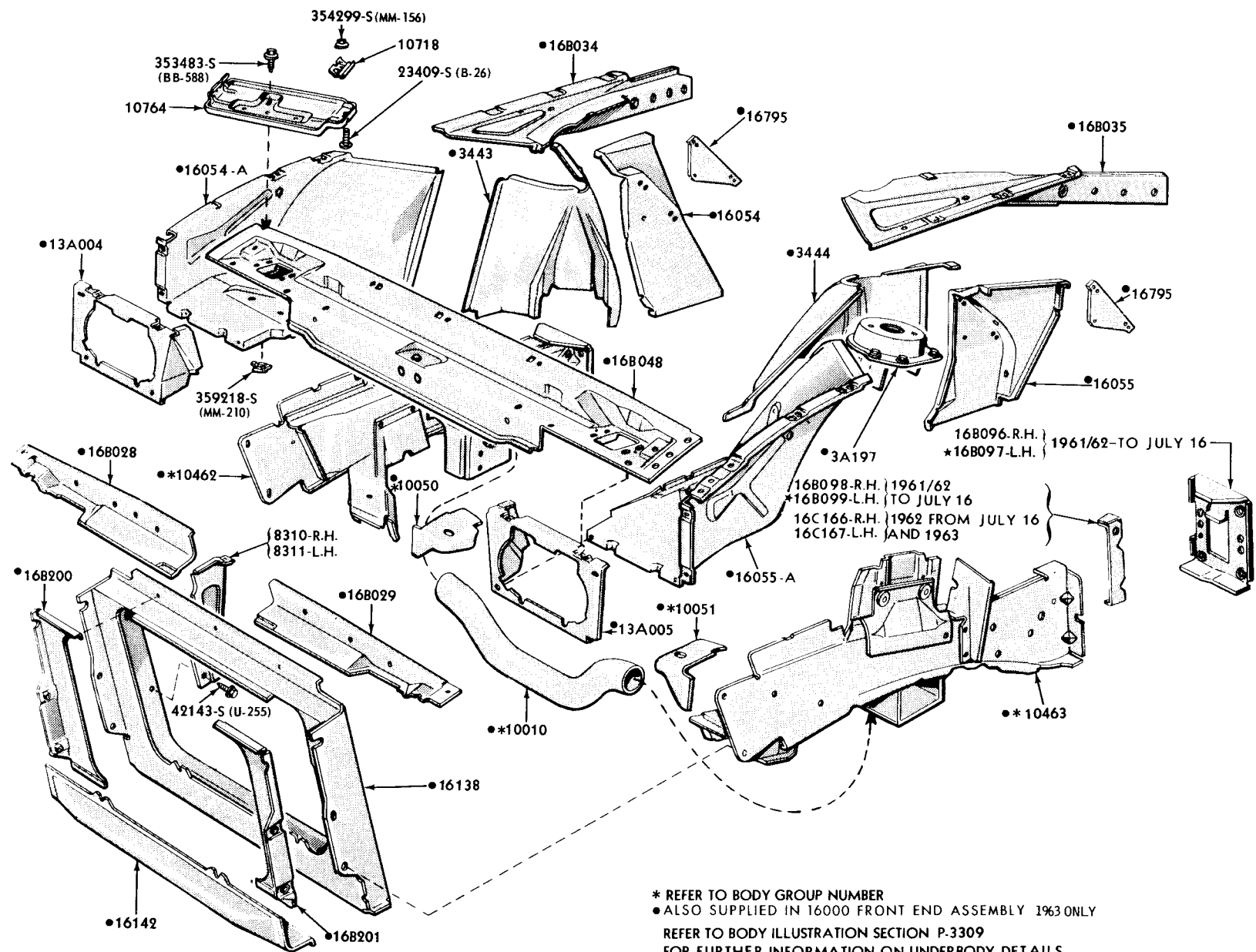

* REFER TO BODY GROUP NUMBER
 ● ALSO SUPPLIED IN 16000 FRONT END ASSEMBLY 1963 ONLY
 REFER TO BODY ILLUSTRATION SECTION P.3309
 FOR FURTHER INFORMATION ON UNDERBODY DETAILS

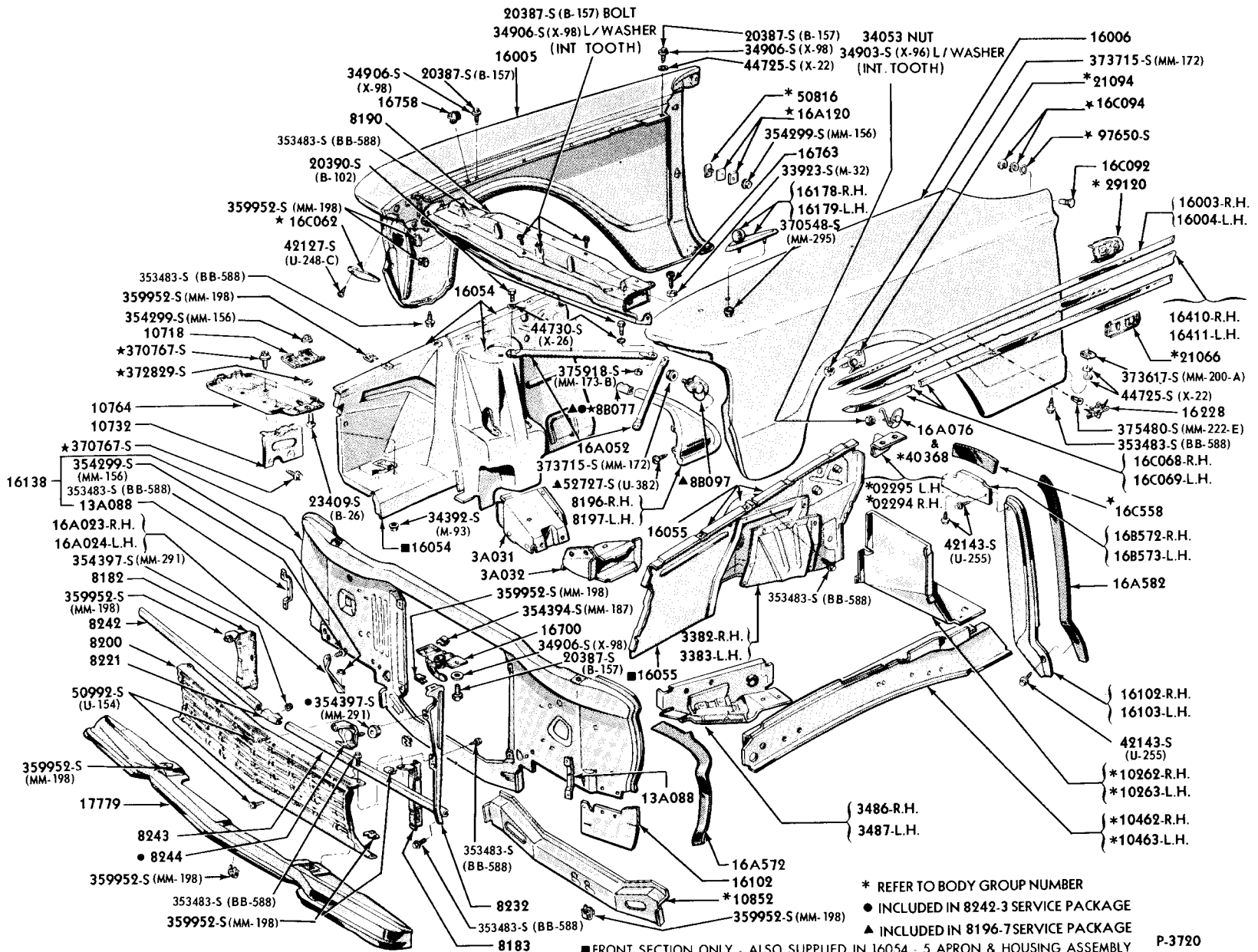

FORD CAR PARTS

ILLUSTRATION SECTION 160

* REFER TO BODY GROUP NUMBER
 ● INCLUDED IN 8242-3 SERVICE PACKAGE
 ▲ INCLUDED IN 8196-7 SERVICE PACKAGE
 ■ FRONT SECTION ONLY - ALSO SUPPLIED IN 16054 - 5 APRON & HOUSING ASSEMBLY

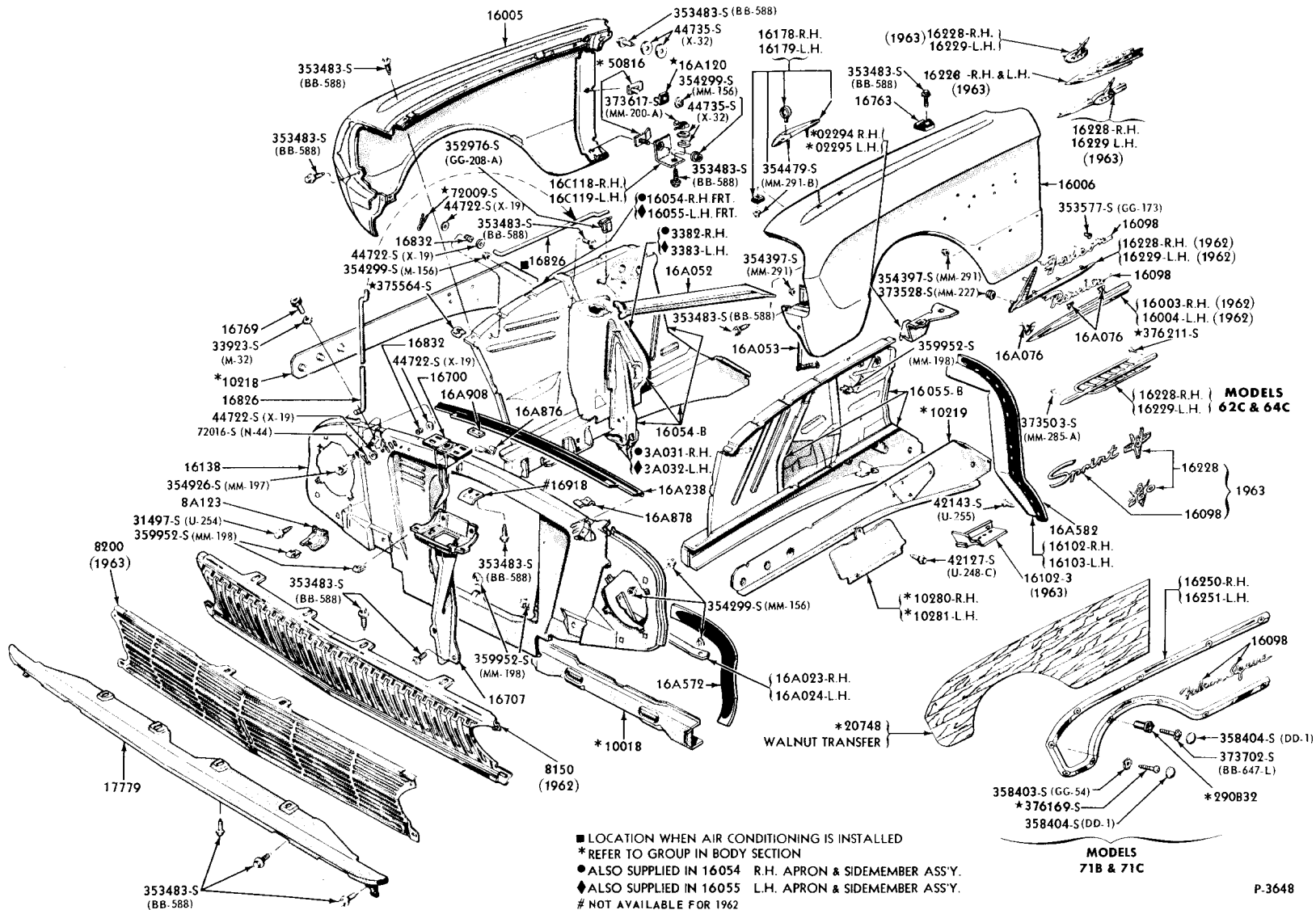

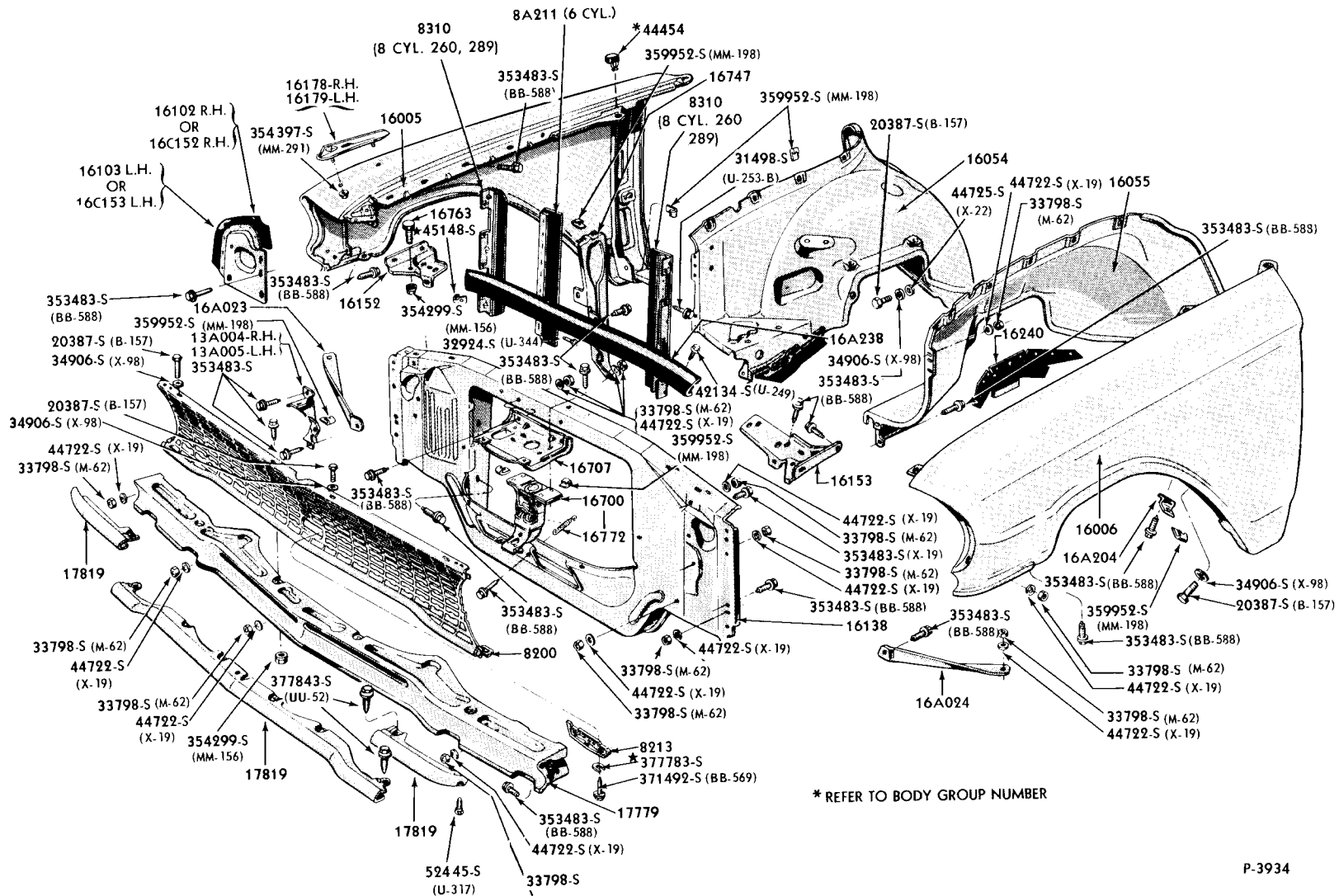

* REFER TO BODY GROUP NUMBER

1968 FENDER MOUNDINGS and NAME PLATES (FORD)

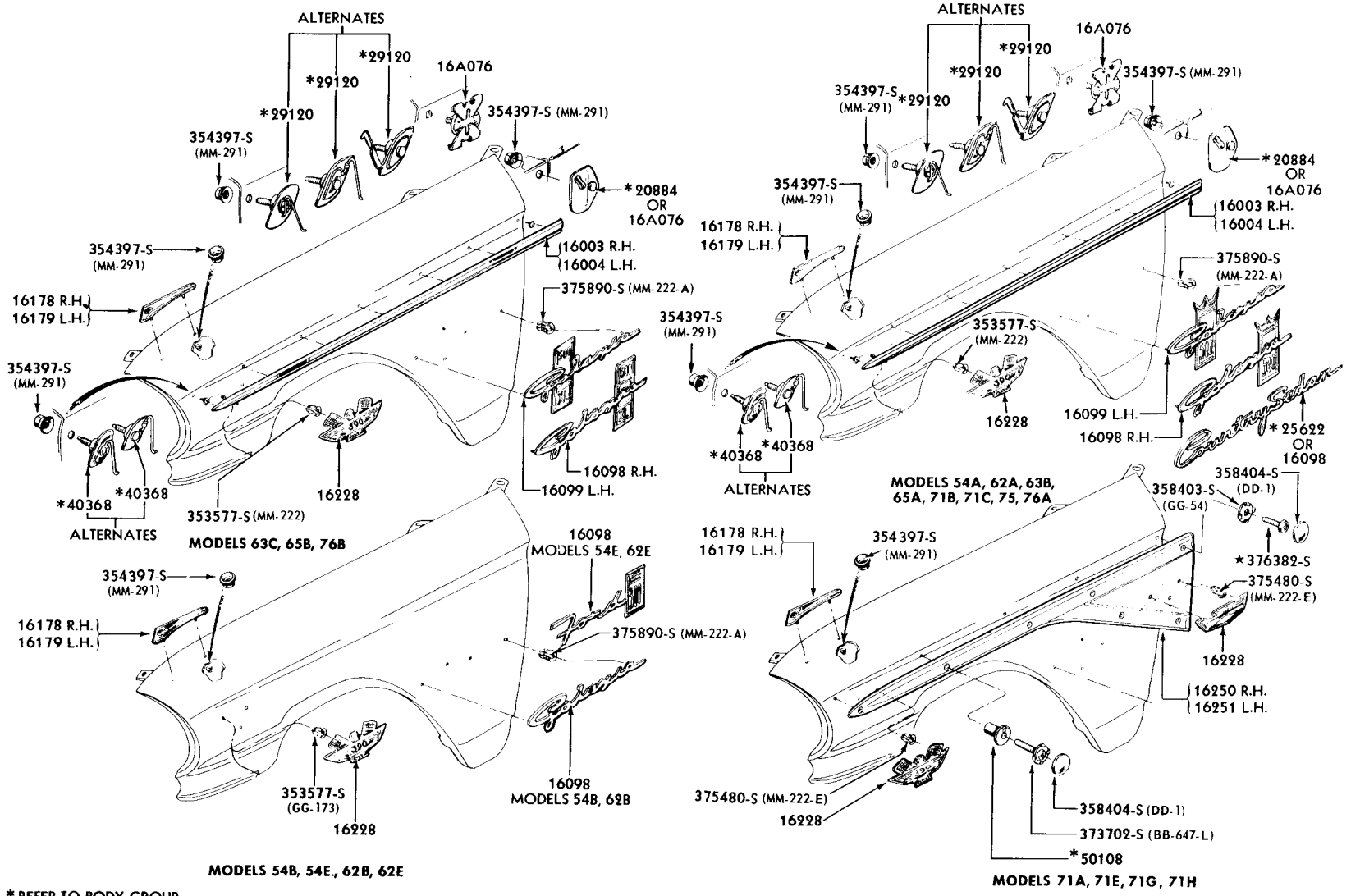

* REFER TO BODY GROUP

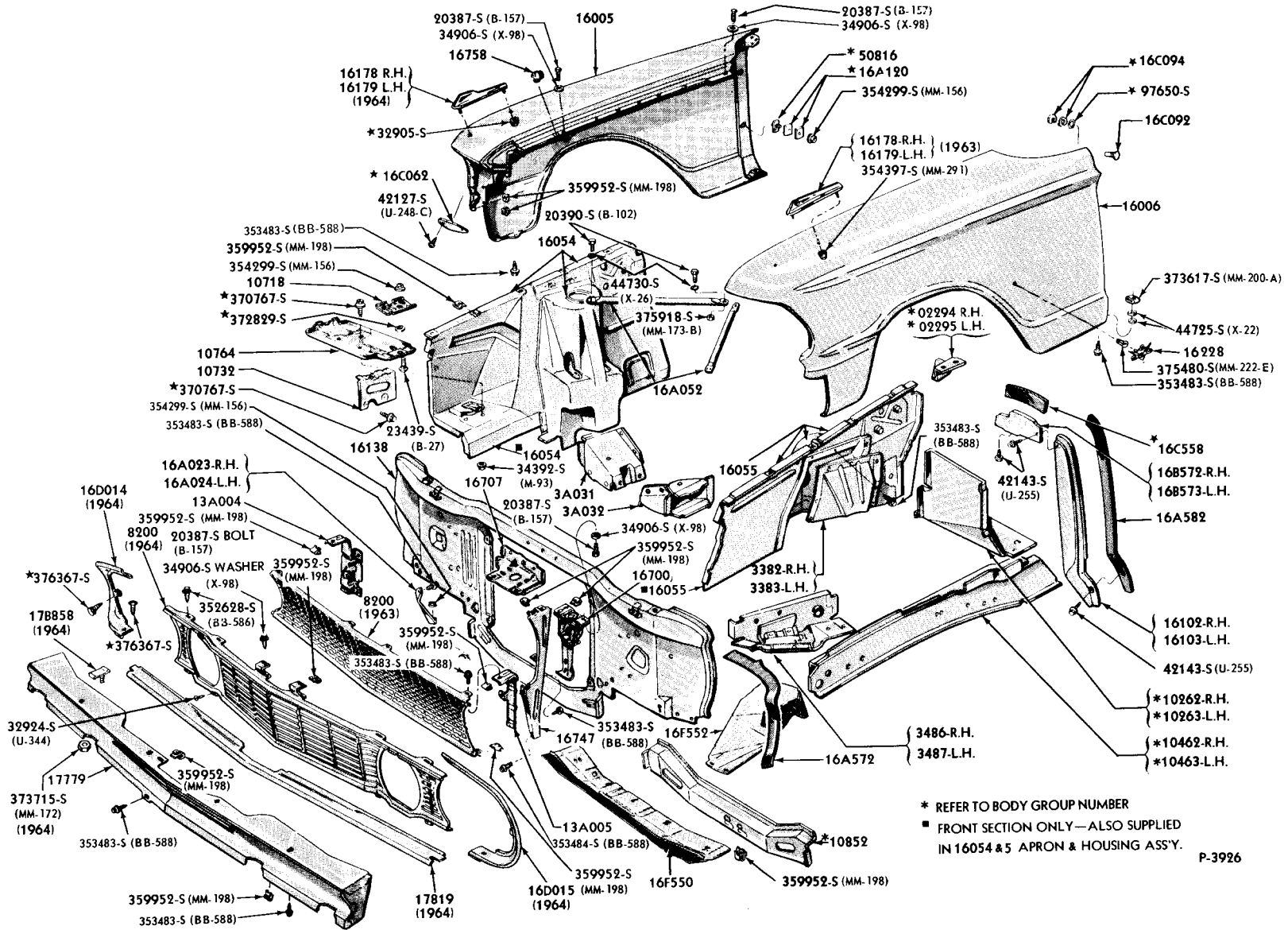

* REFER TO BODY GROUP NUMBER
 ■ FRONT SECTION ONLY—ALSO SUPPLIED
 IN 16054 & 5 APRON & HOUSING ASS'Y.

P-3926

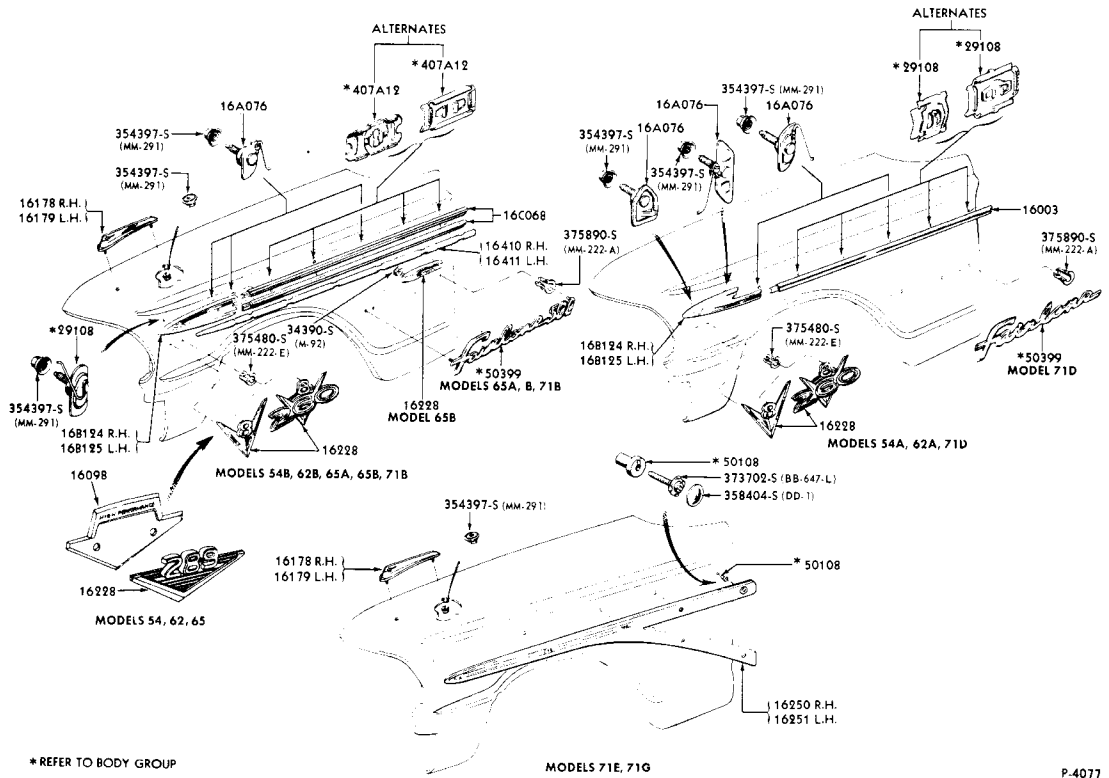

1963 FENDER MOULDINGS & NAME PLATES (FAIRLANE)

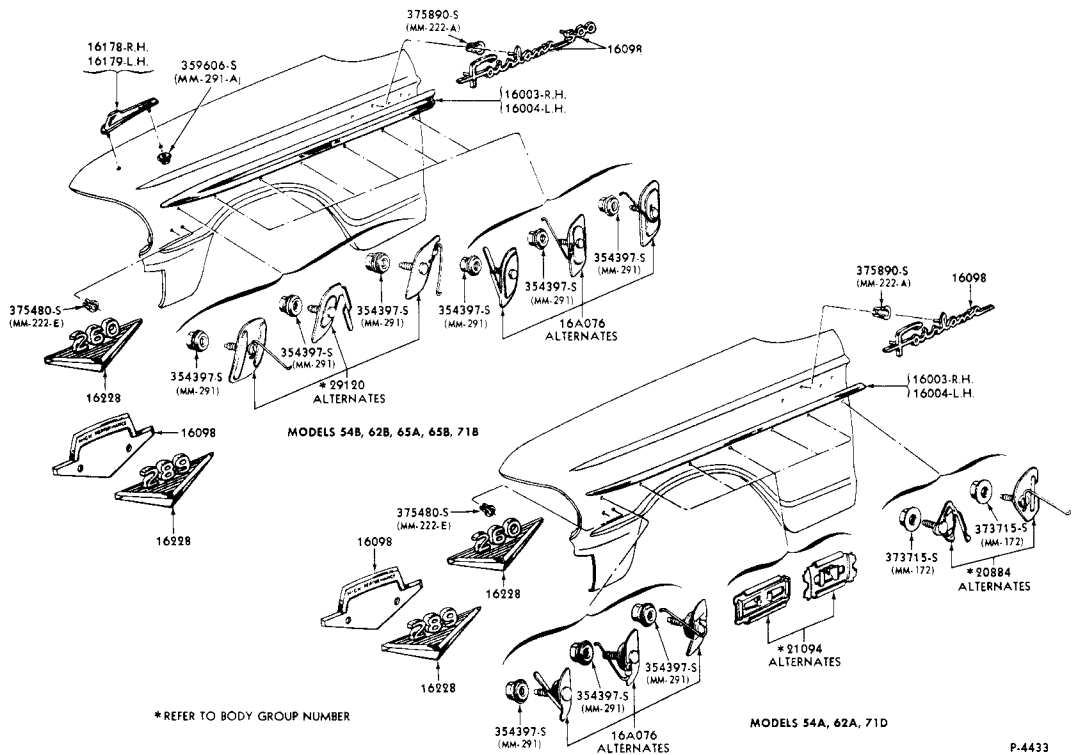

1964 FENDER MOULDINGS & NAME PLATES (FAIRLANE)

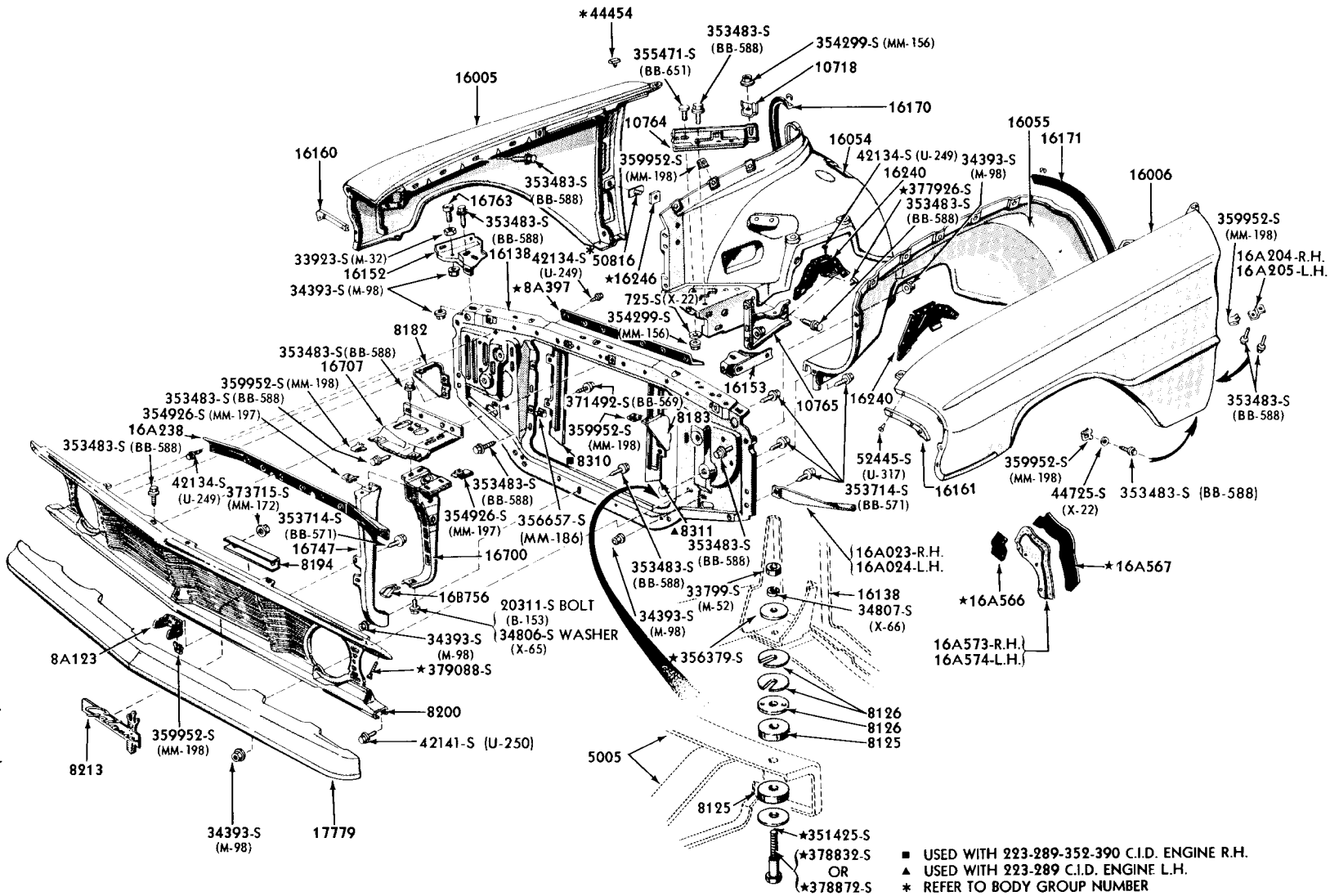

1964 FENDER MOLDINGS and NAME PLATES (FORD)

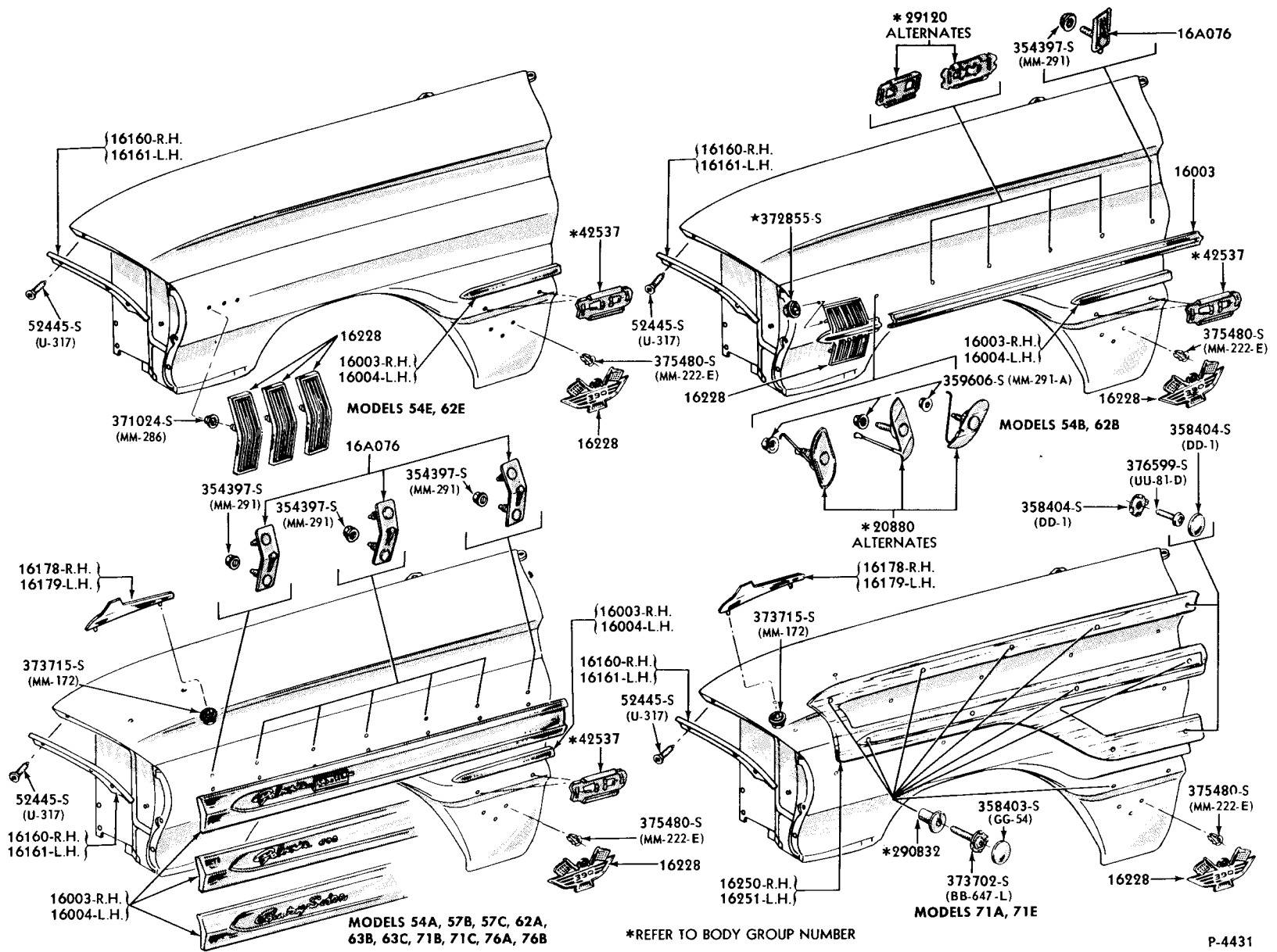

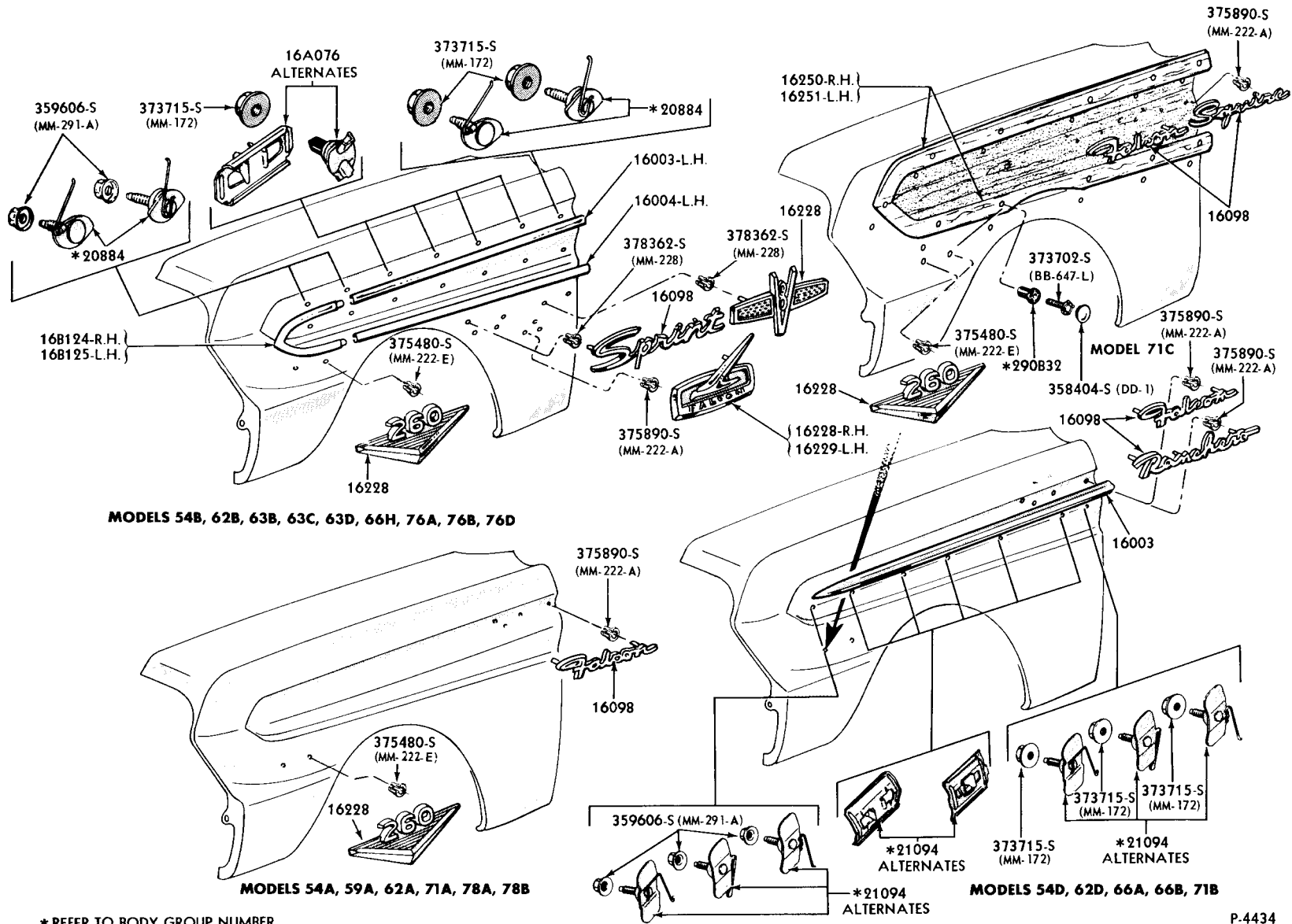

MODELS 54B, 62B, 63B, 63C, 63D, 66H, 76A, 76B, 76D

MODELS 54A, 59A, 62A, 71A, 78A, 78B

MODELS 54D, 62D, 66A, 66B, 71B

* REFER TO BODY GROUP NUMBER

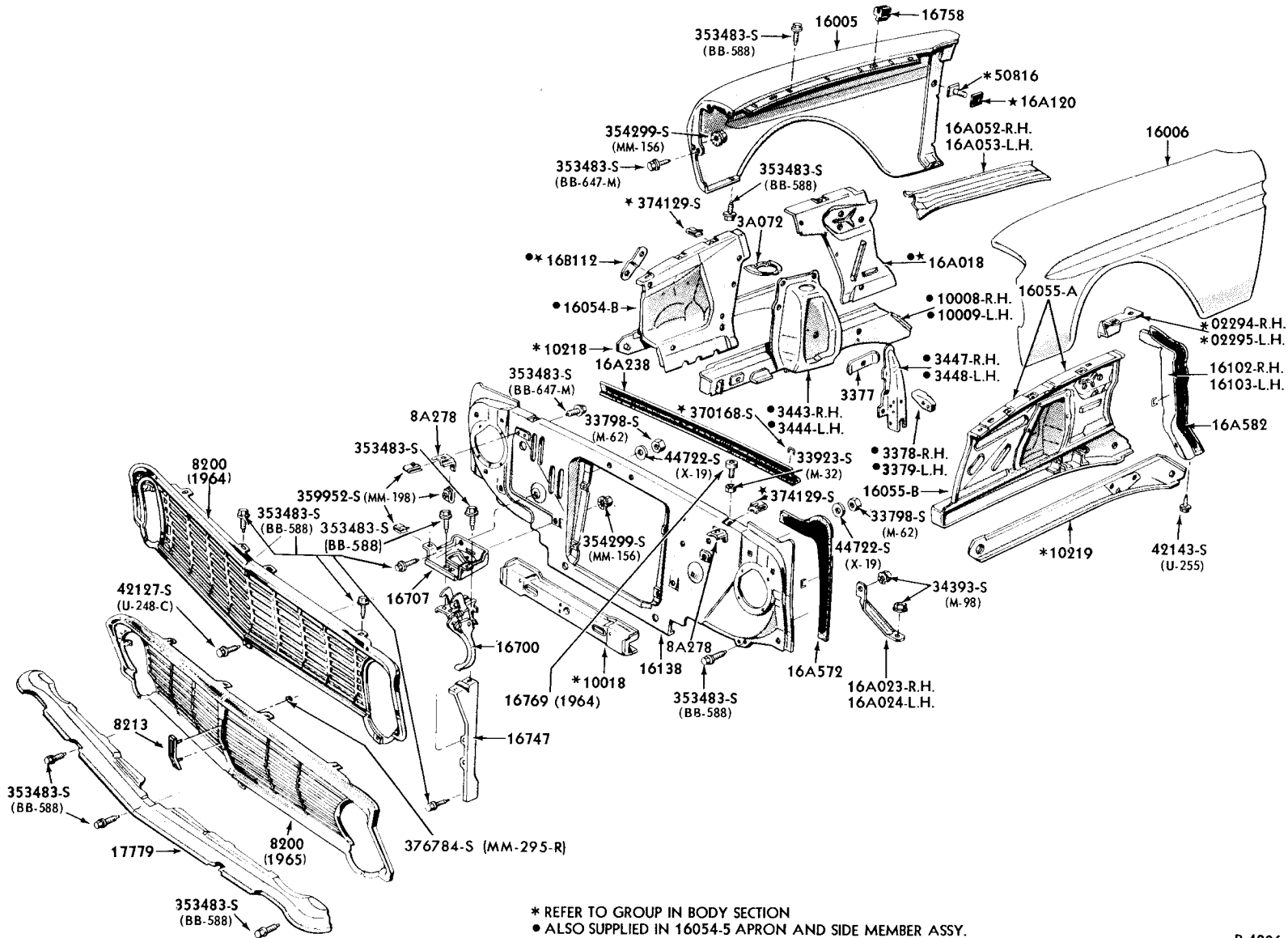

* REFER TO GROUP IN BODY SECTION
 • ALSO SUPPLIED IN 16054-5 APRON AND SIDE MEMBER ASSY.

1954 / FENDERS, RADIATOR GRILLE & RELATED PARTS (FALCON)

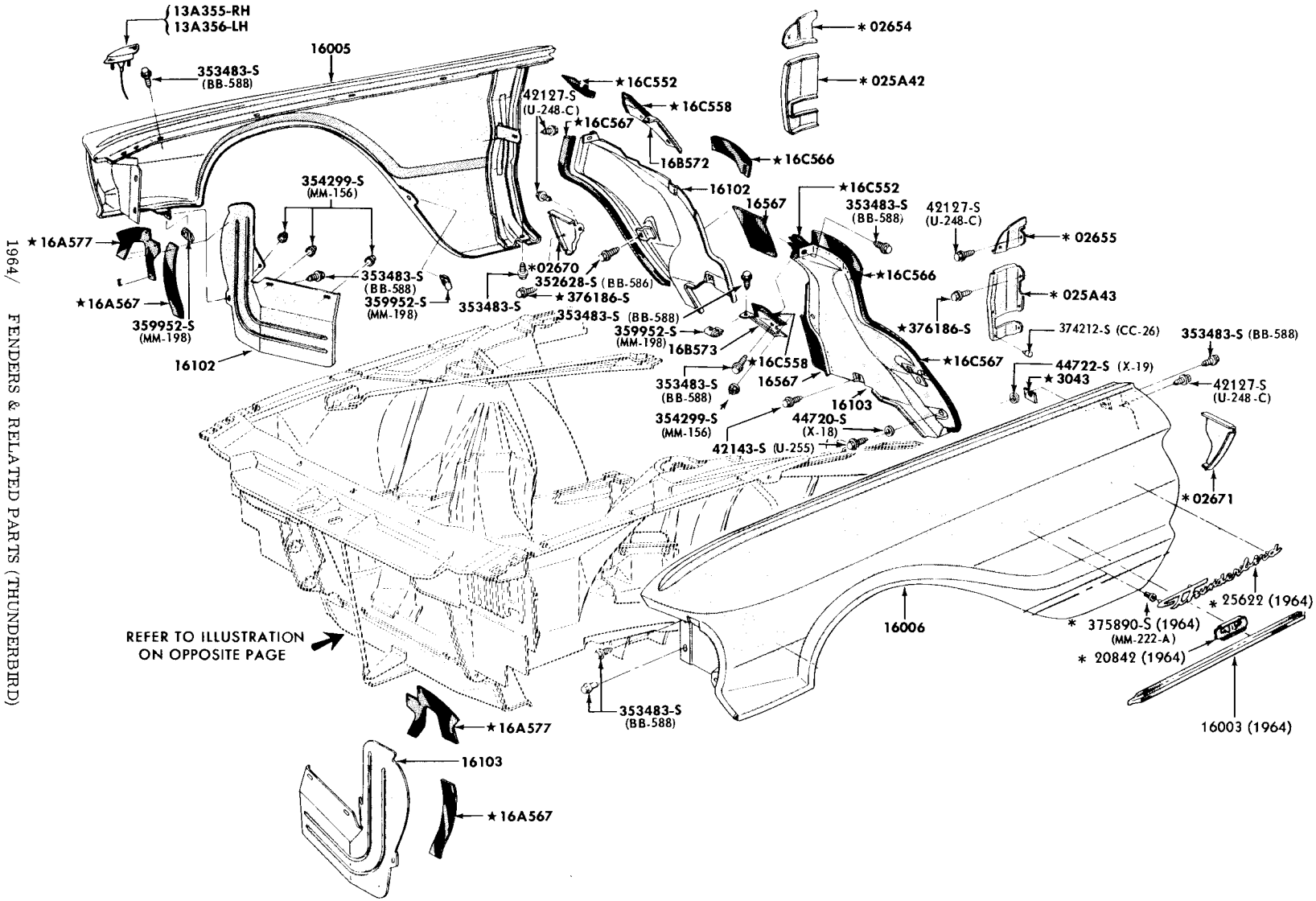

1964 / FENDERS & RELATED PARTS (THUNDERBIRD)

1964 / FRONT END PARTS (THUNDERBIRD)

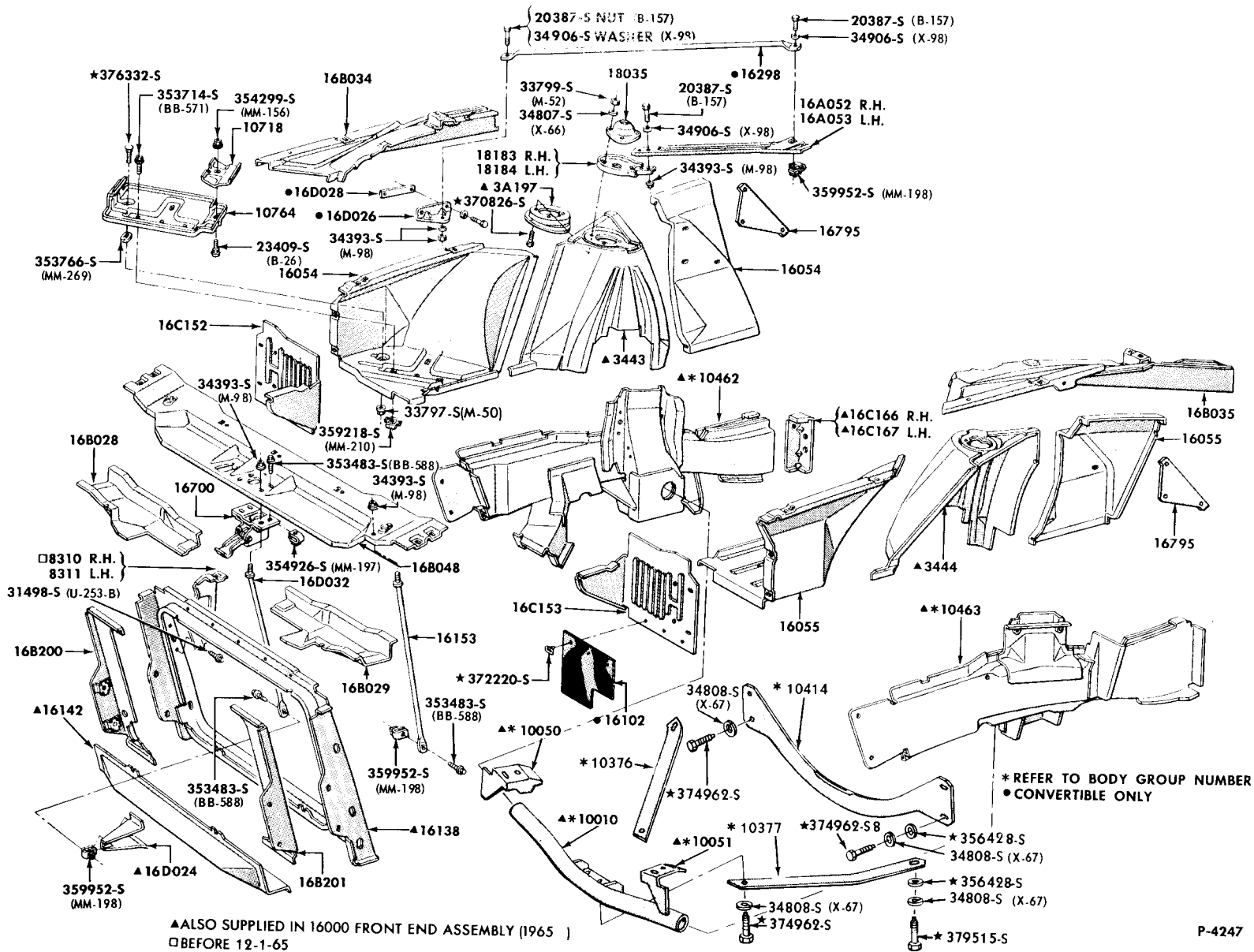

▲ ALSO SUPPLIED IN 16000 FRONT END ASSEMBLY (1965)
 □ BEFORE 12-1-65

* REFER TO BODY GROUP NUMBER
 * CONVERTIBLE ONLY

ILLUSTRATION SECTION 166

FORD CAR PARTS

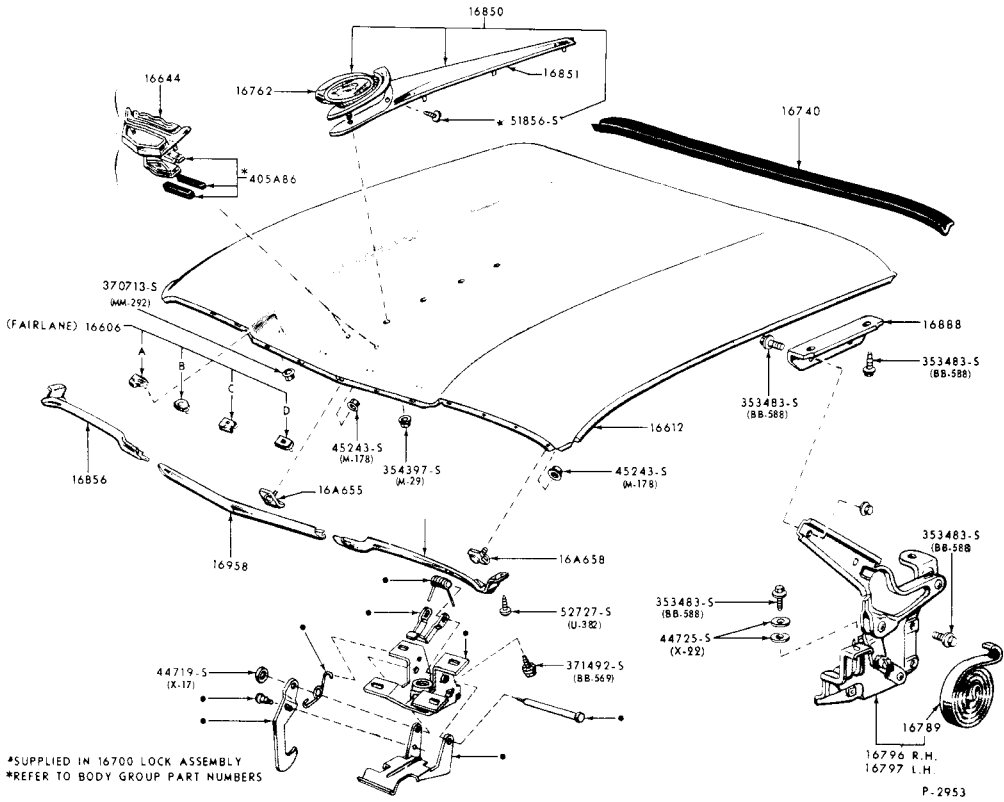

1960 HOOD and RELATED PARTS (FORD)

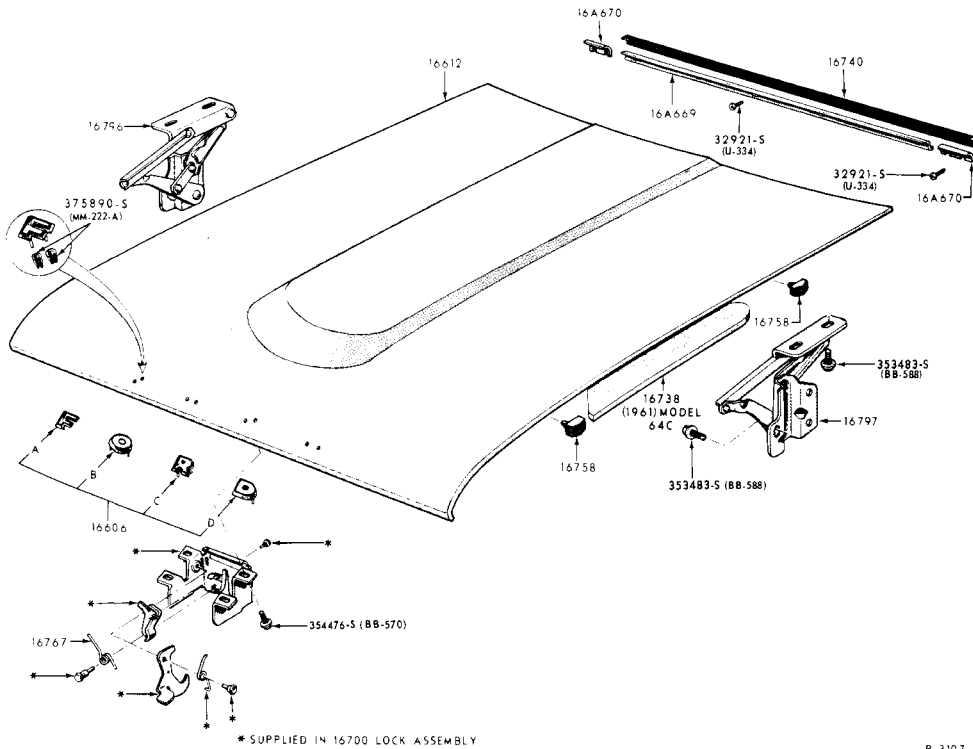

1960/61 HOOD and RELATED PARTS (FALCON)

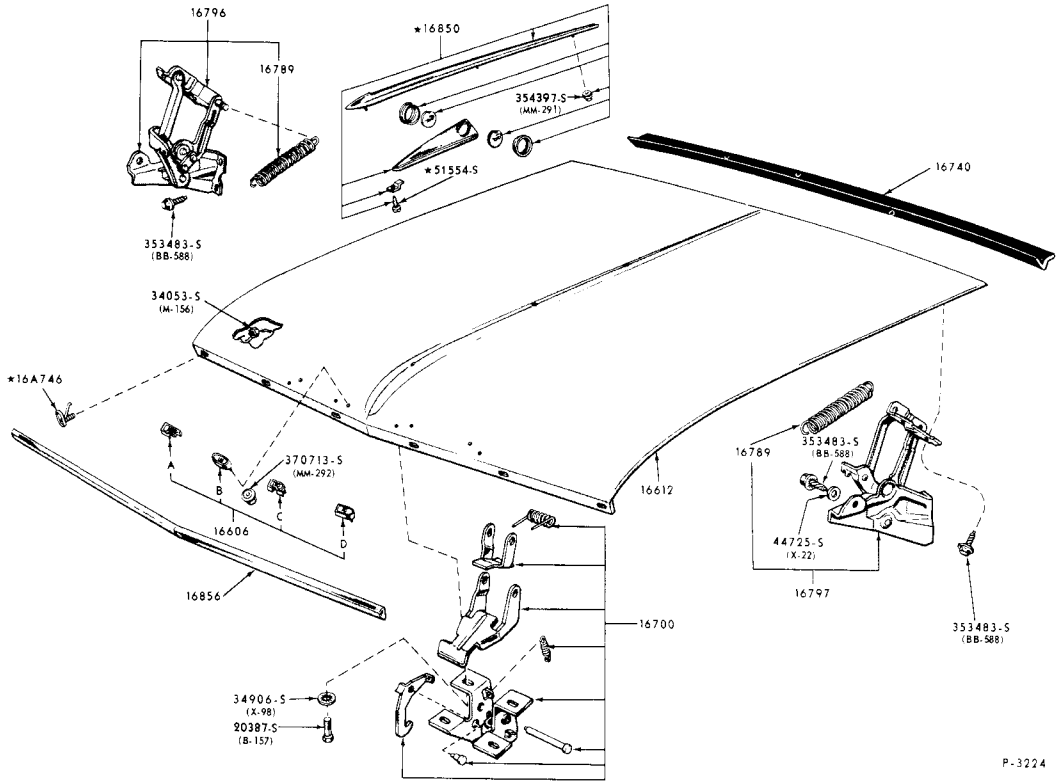

P-3224

1961 HOOD and RELATED PARTS (FORD)

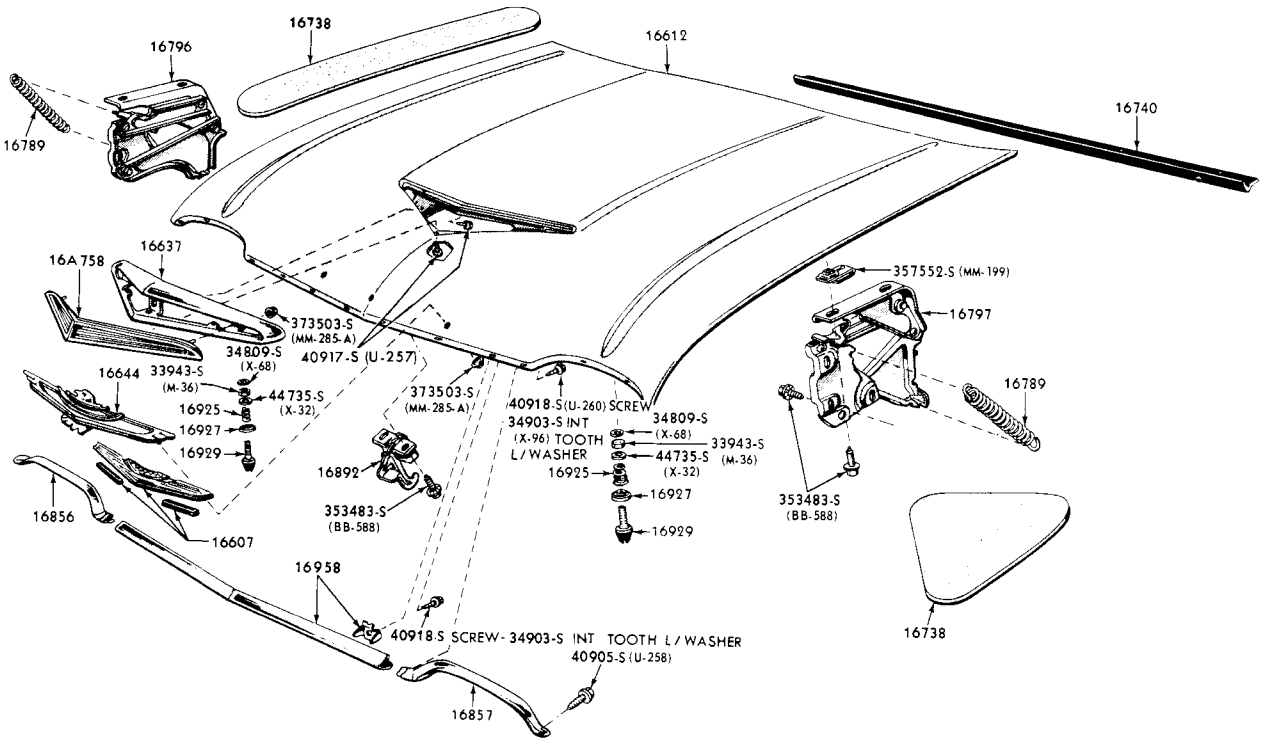

P-3252

1961/63 HOOD and RELATED PARTS (THUNDERBIRD)

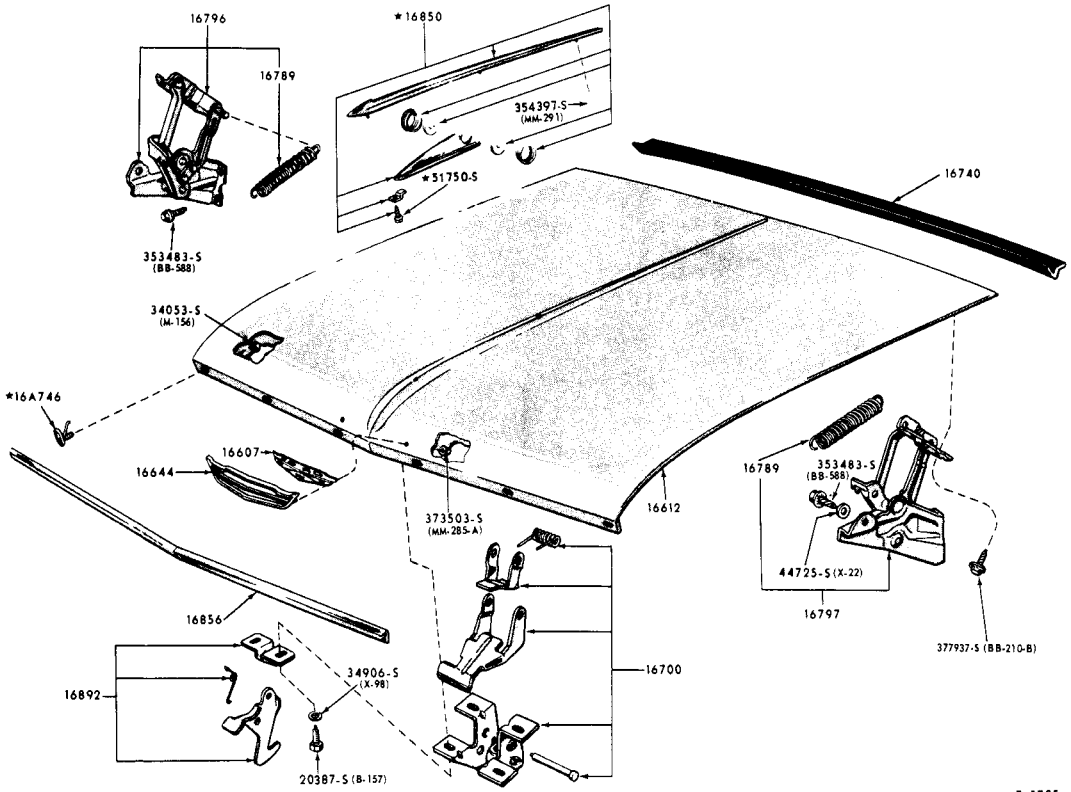

P-3725

1962 HOOD and RELATED PARTS (FORD)

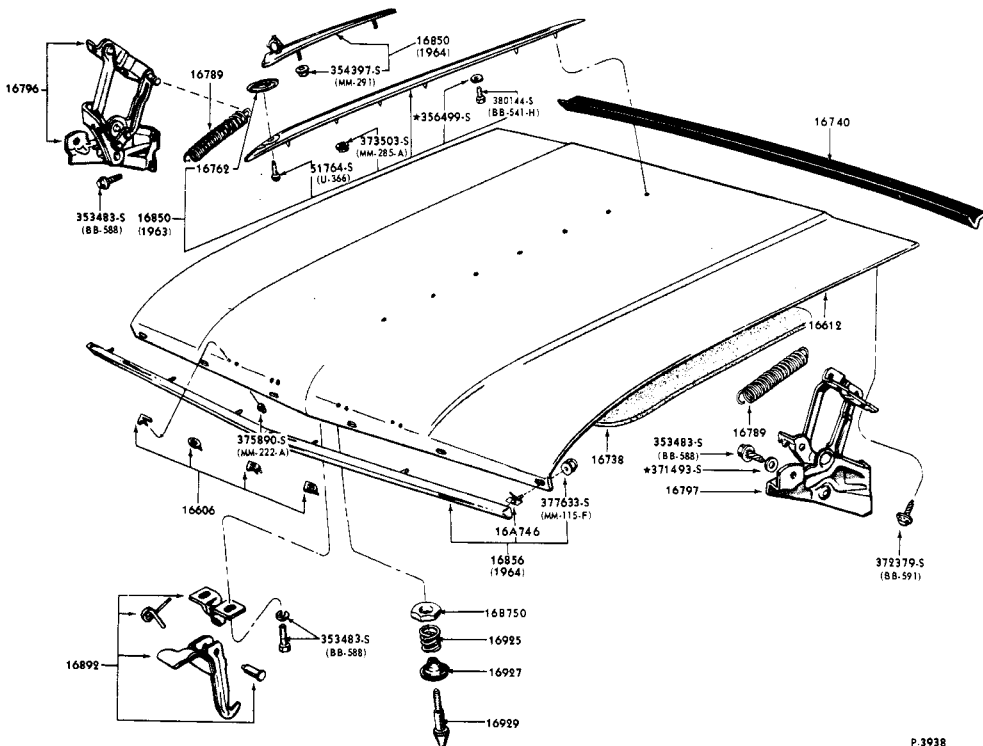

P.3938

1963/64 HOOD and RELATED PARTS (FORD)

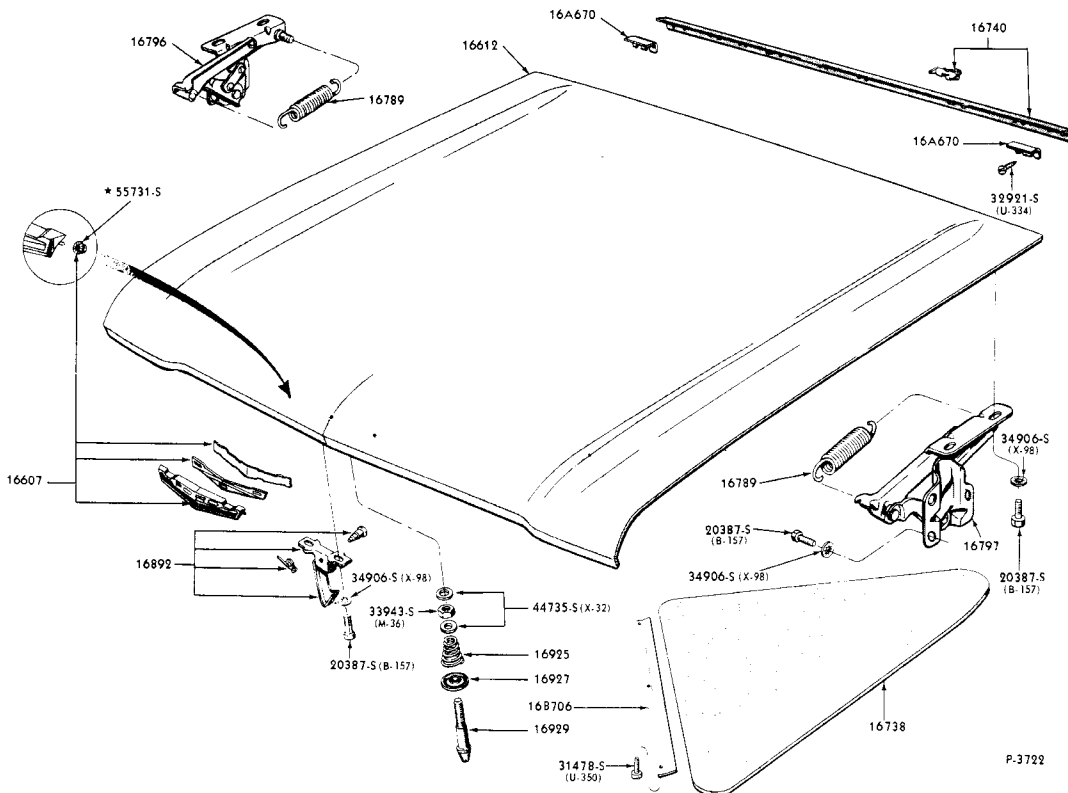

1962 HOOD and RELATED PARTS (FAIRLANE)

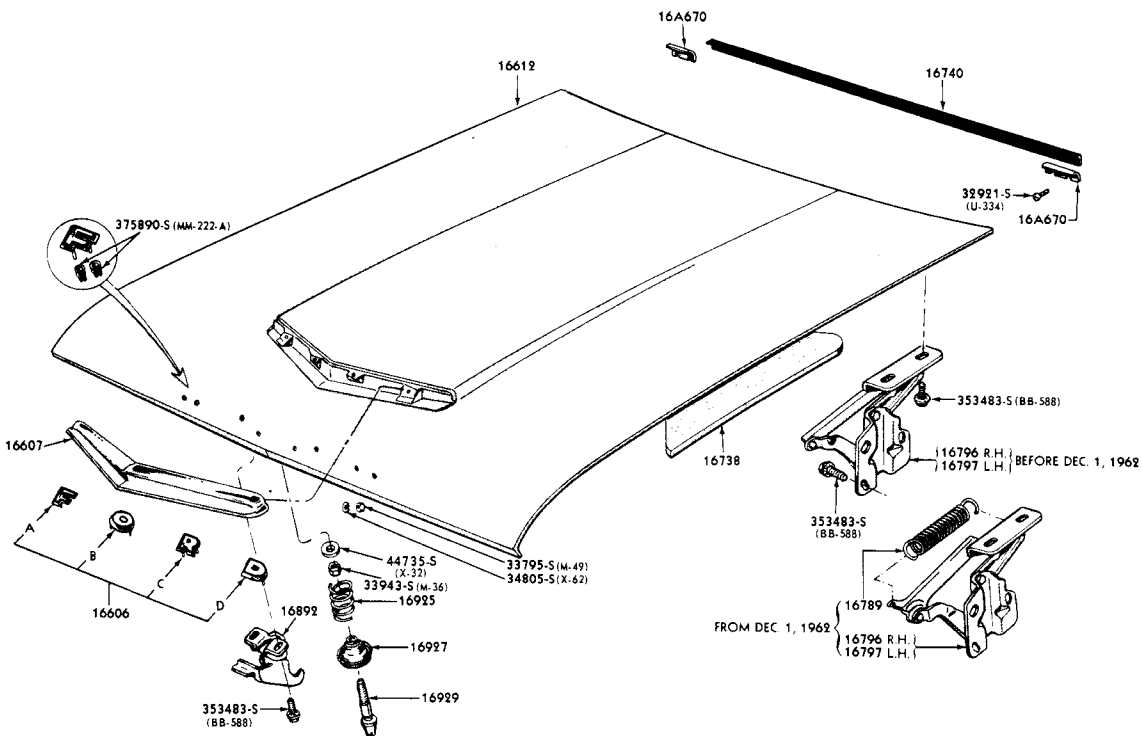

1962/63 HOOD and RELATED PARTS (FALCON)

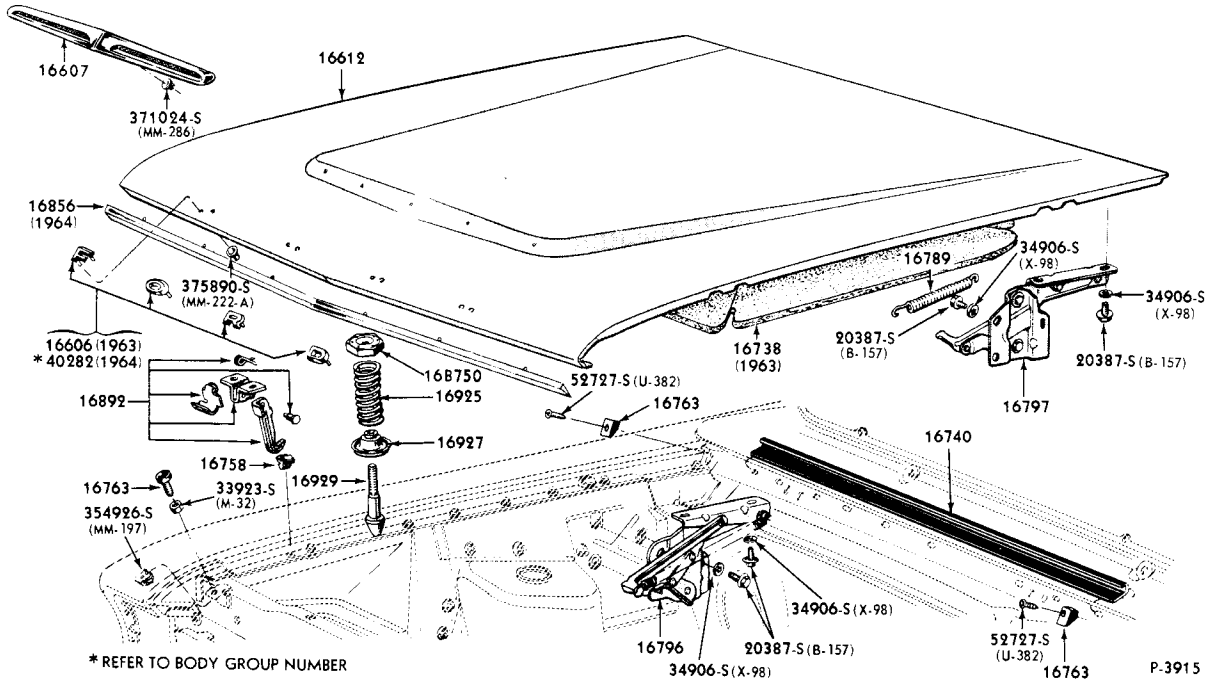

1963/64 HOOD and RELATED PARTS (FAIRLANE)

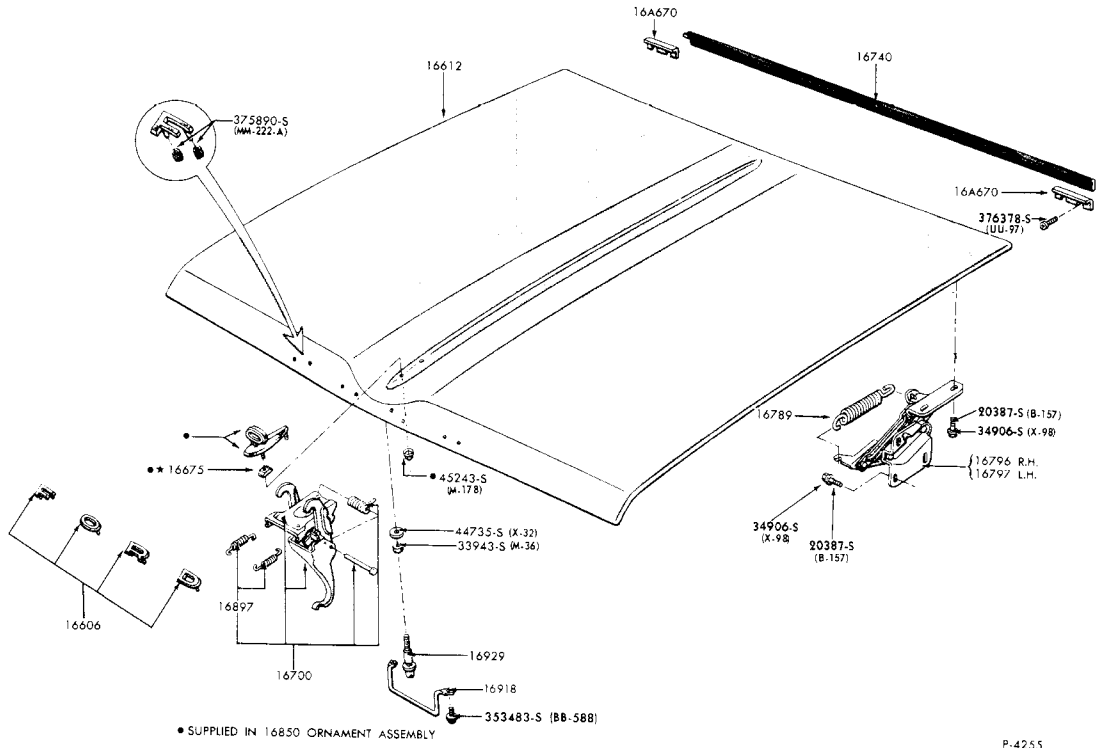

P-4255

1964/ HOOD and RELATED PARTS (FALCON)

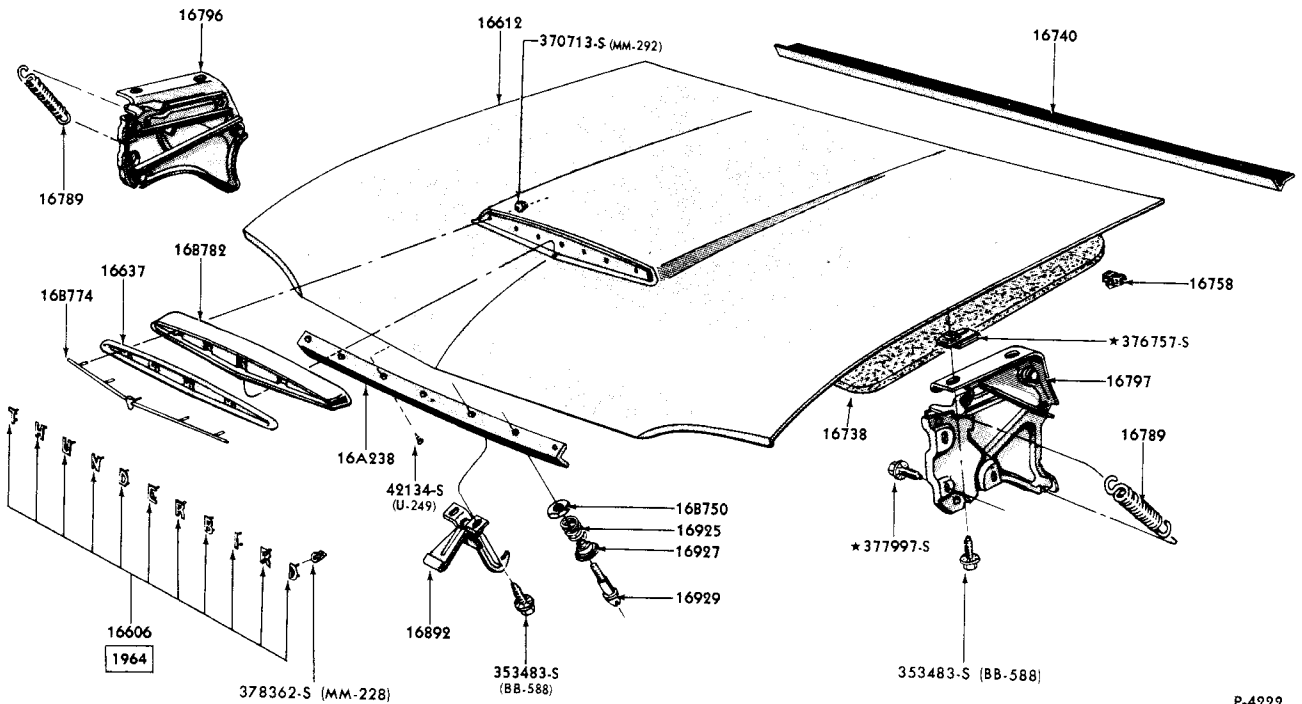

P-4222

1964/ HOOD and RELATED PARTS (THUNDERBIRD)

MEMO

Horizontal lines for memo content