

INDEX

YEAR	TITLE	ILLUS. NO.	SECTION	PAGE
ALTERNATOR, GENERATOR, REGULATOR				
1960	Alternator (Leece Neville 15 volt 30, 50 amp.)	P-2677	100	372
1960	Alternator (Leece Neville 15 volt-50 amp. Heavy Duty)	P-2719	100	373
1961	Alternator (Leece Neville 15 volt-50 amp.)	P-3485	100	374
1962	Alternator (Leece Neville 15 volt-60, 65 amp)	P-3843	100	375
1962	Alternator (Leece Neville 15 volt-40, 53 amp.)	P-3849	100	376
1964	Alternator (Leece Neville 15 volt 53, 60, 65 amp.)	P-5741	100	377
1963/64	Alternator (Ford 15 volt-30, 40, 42, 52 amp.)	P-4060	100	378
1963/64	Alternator (Ford 15 volt-38, 42, 45, 55 amp.)-Printed Circuit Type	P-4508	100	379
1960/62	Generator and Related Parts (Delco Remy 15 volt-35, 40 amp.)	P-3240	100	371
1960/64	Generator and Related Parts (Autolite 15 volt-40 amp.)	P-3905	100	370
1960/64	Generator and Related Parts (Ford 15 volt-30, 35, 40 amp.)-typical	P-1829	100	368
1960/	Generator and Related Parts (Ford 15 volt-25, 30 amp.)-Falcon	P-3192	100	369
1960/	Voltage Regulator-Typical (Generator)	P-1535	100	380
1963	Voltage Regulator (Ford 15 volt, Negative Ground)(Alternator)	P-4482	100	381
1964/	Voltage Regulator (Ford 15 volt, Negative Ground)(Alternator)	P-5525	100	382
BATTERY CARRIER				
1960	Battery Carrier and Related Parts (Ford)	P-2954	106	383
1960	Battery Carrier and Related Parts (Thunderbird)	P-2795	106	383
1961/64	Battery Carrier and Related Parts (Ford)	P-3257	106	384
1960/	Battery Carrier and Related Parts (Falcon)	P-3106	106	384
CONSOLE PANEL and INSTRUMENT PANEL				
1960	Head Lamp Switch and Related Parts	P-3186	110	389
1964	Seat Belt Warning Lamp Installation (Thunderbird)	P-4405	106	385
STARTER				
1960/	Starter and Drive Assy.-Positive Engagement	P-3191	110	387
1960/64	Starter and Drive Assy.-Inertia-typical	P-1965	110	386
1960/	Starter Drive (Ford 12 Volt-Positive Engagement)	P-5526	110	388
DISTRIBUTOR				
1960/	Distributor (8 cylinder 221,260,289,292,352,390 & 430 engines)(Pivot Plate Type - except with Stamped Weights)	P-2926	120	392
1960/	Distributor (8 cyl. 221, 260, 289, 292, 352, 390, 406, 427, 430 engines)(with Stamped Weights)	P-4924	120	393
1960/	Distributor (6 cylinder 144, 170, 200 engines)	P-2961	120	390
1960/	Distributor (6 cyl. 223 engine)	P-3475	120	391
IGNITION WIRING				
1960/62	Ignition Wiring (8 cylinder 292 engine)	P-2155	120	395
1960/64	Ignition Wiring (8 cylinder 352, 390 & 430 engines)-typical	P-2498	120	396
1960/64	Ignition Wiring (6 cylinder 223 engine)-Typical	P-1800	120	394
1963/	Transistorized Ignition System. Oil Temperature Warning System and Related Parts (8 cylinder 427 engine)(Ford)	P-4190	120	397
1964/	Transistorized Ignition System and Related Parts (8 cylinder 390 engine)(Thunderbird)	P-4868	120	398

1960/64 GENERATOR and RELATED PARTS (FORD 15 VOLT-30, 35, 40 AMP.) - TYPICAL

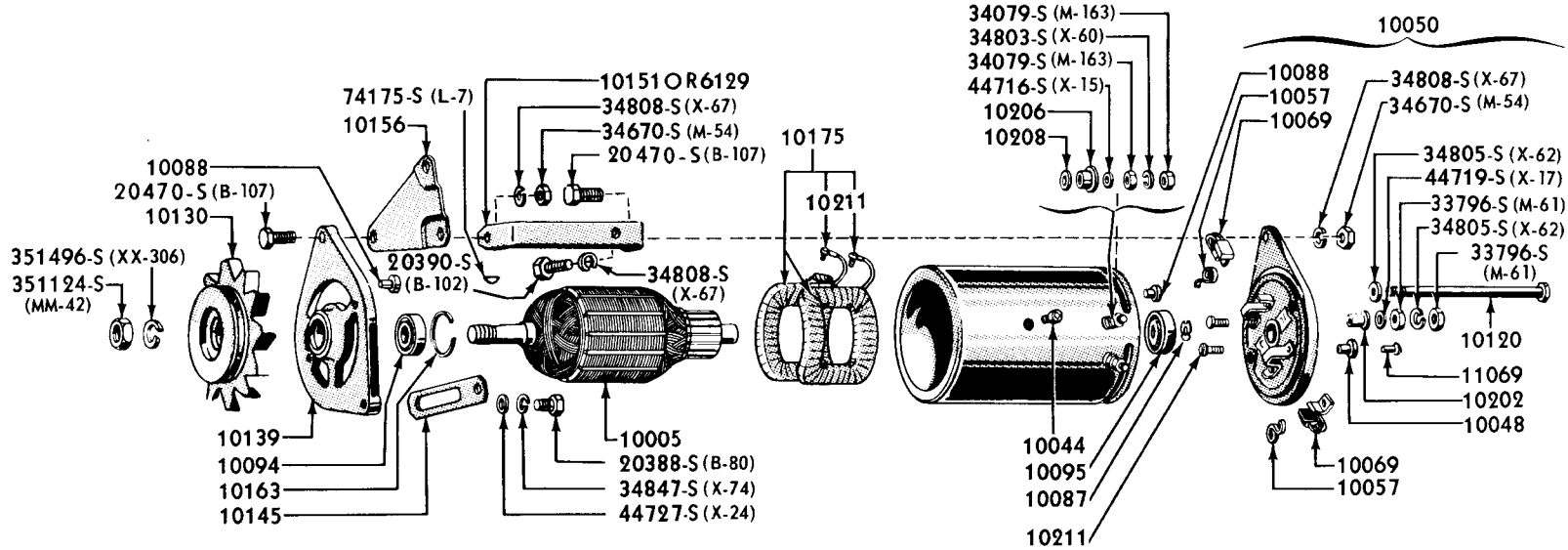

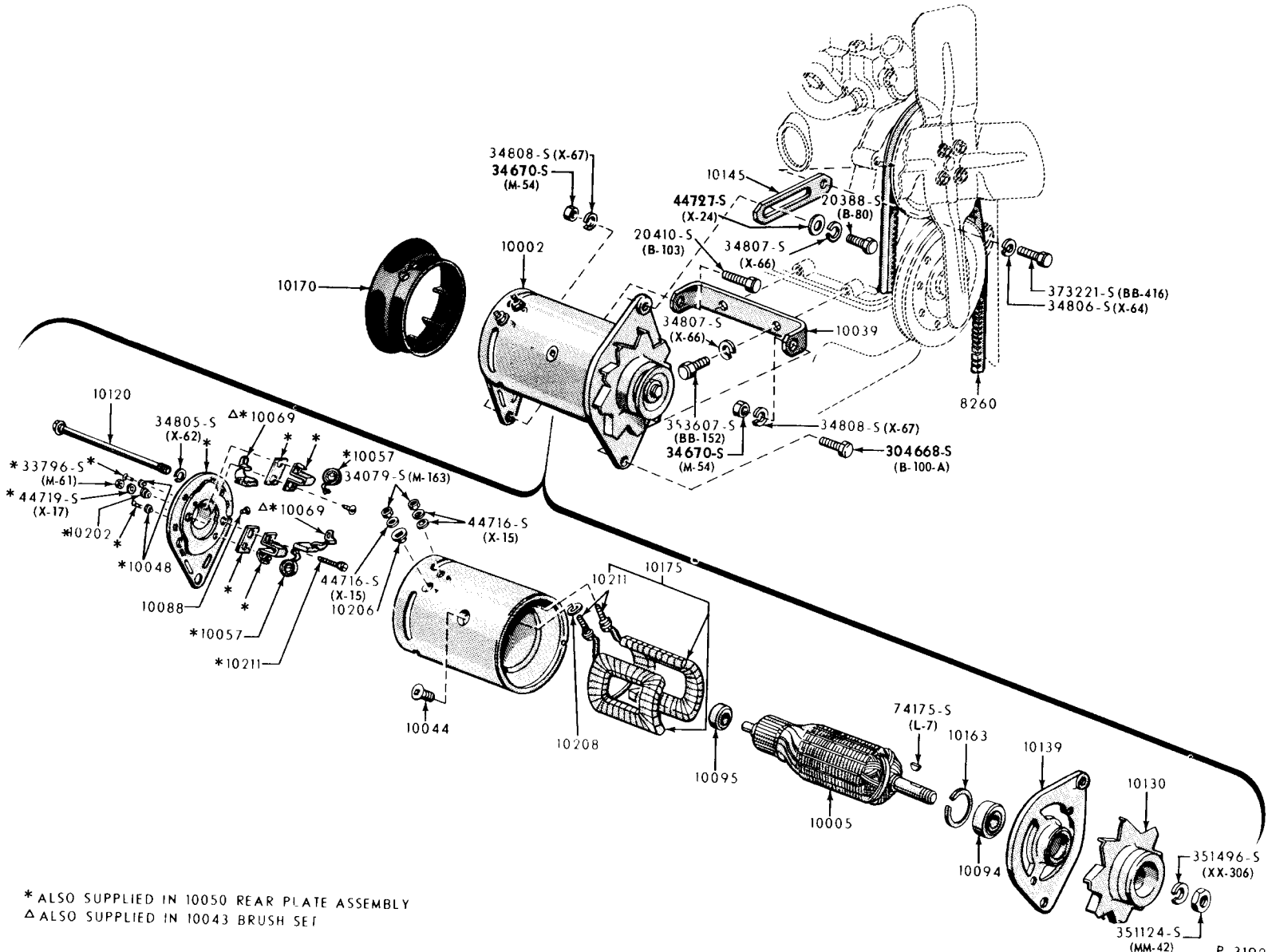

* ALSO SUPPLIED IN 10050 REAR PLATE ASSEMBLY
 Δ ALSO SUPPLIED IN 10043 BRUSH SET

FORD CAR PARTS

ILLUSTRATION SECTION 100

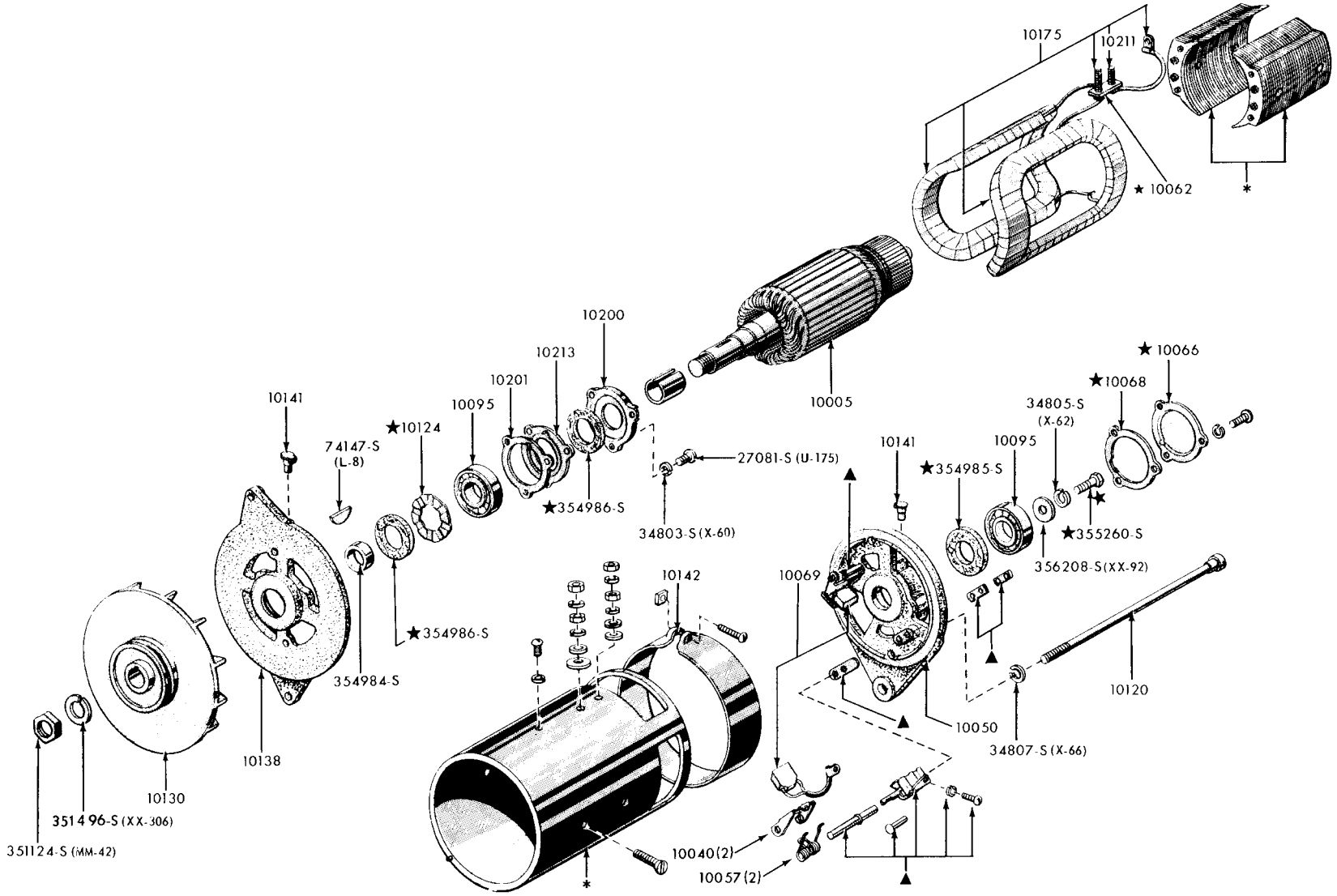

* SUPPLIED ONLY IN 10002 GENERATOR ASSEMBLY
 ▲ ALSO SUPPLIED IN 10050 BRUSH AND END PLATE ASSEMBLY

1960/64 GENERATOR and RELATED PARTS (AUTOLITE 15 VOLT-40 AMP.)

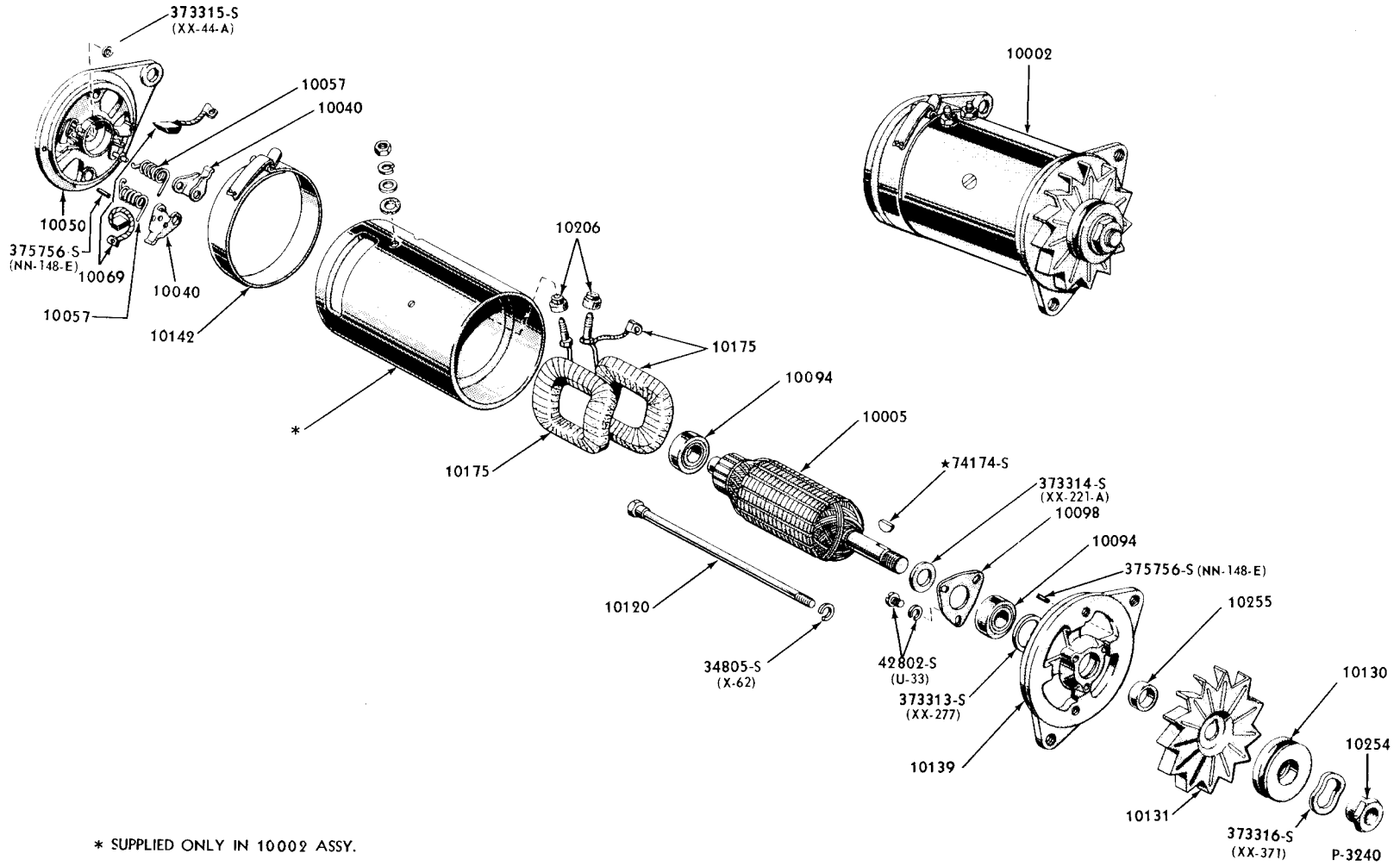

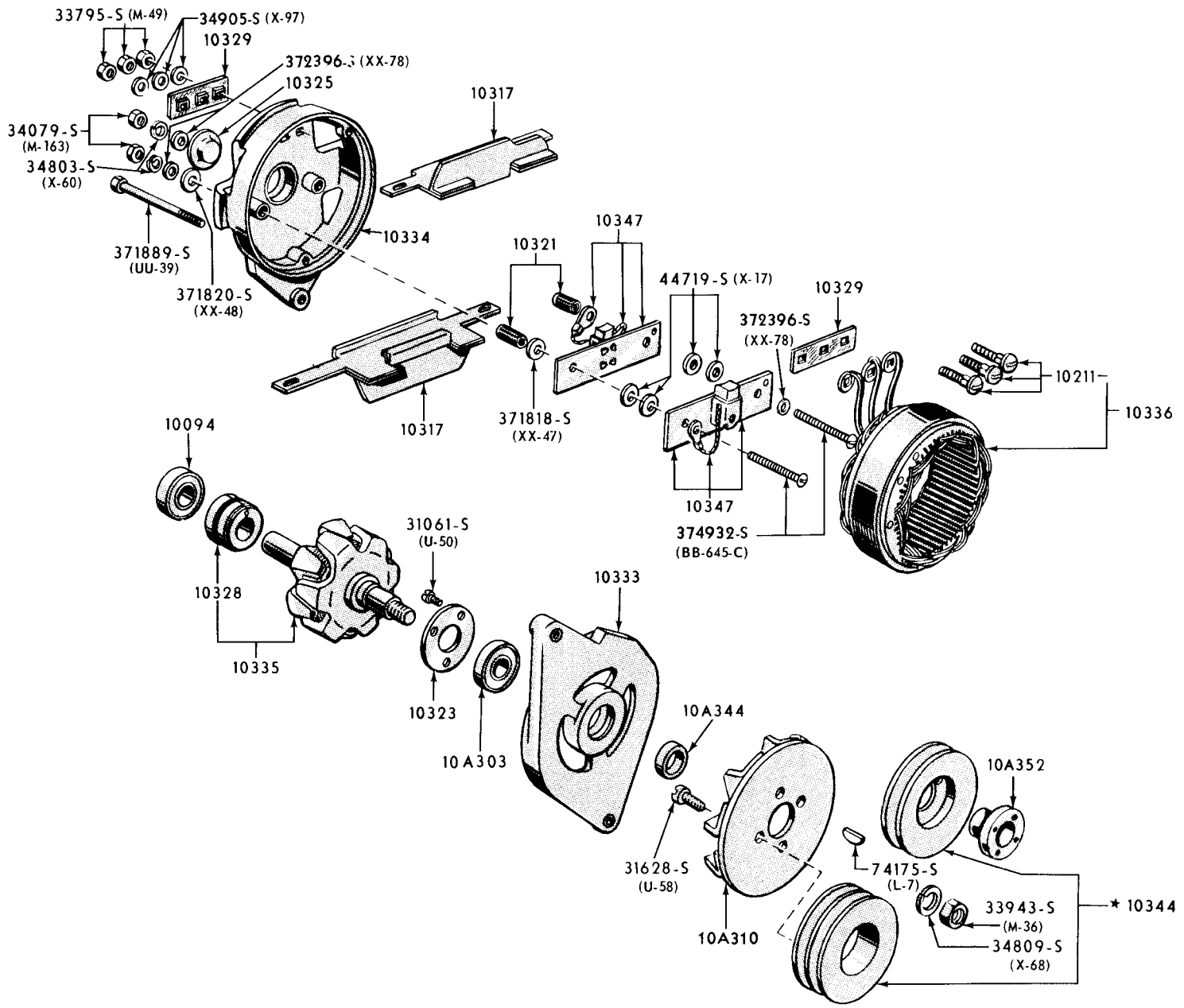

1960 ALTERNATOR (LEECH NEVILLE 15 VOLT 30, 50 AMP.)

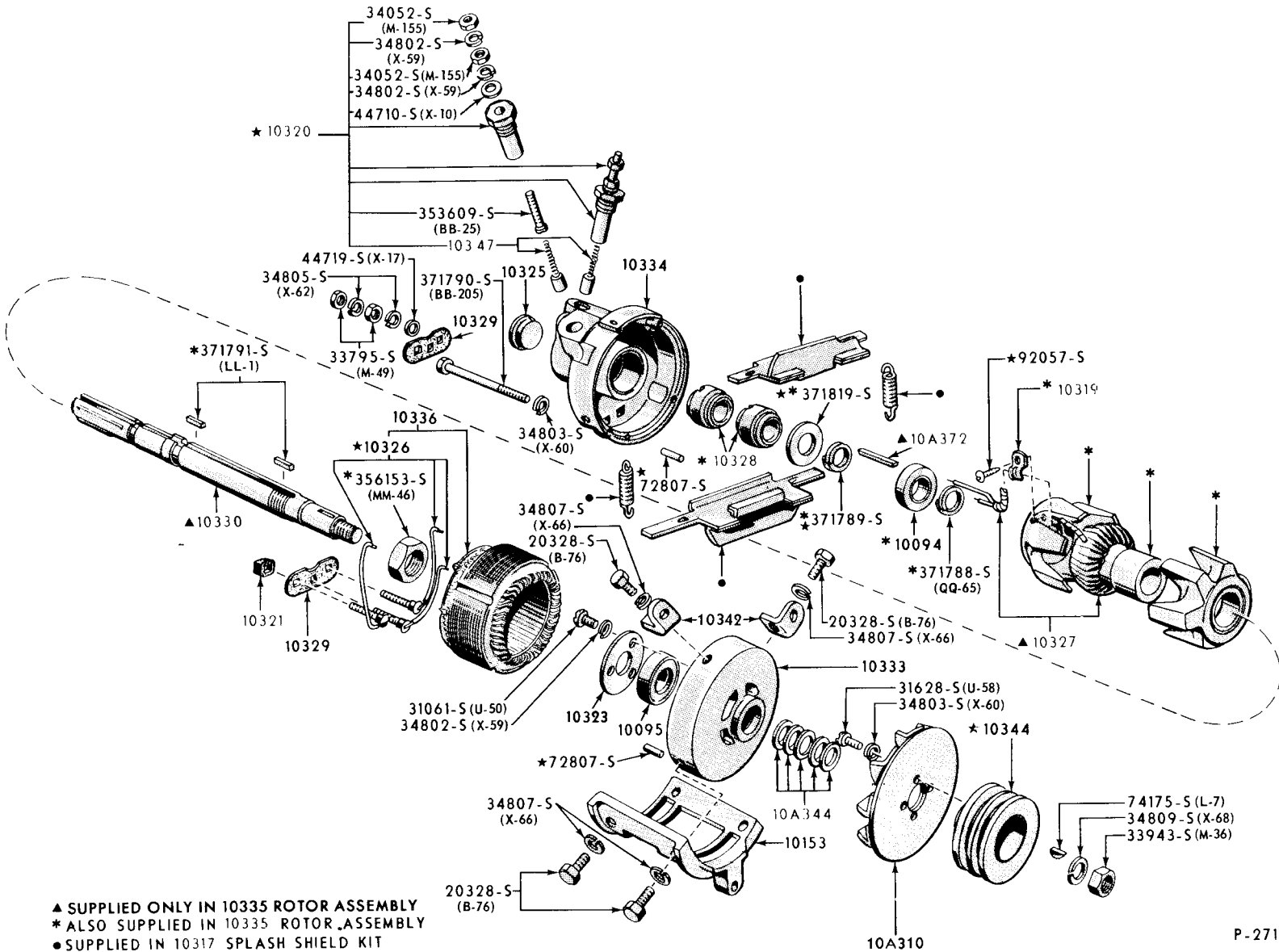

- ▲ SUPPLIED ONLY IN 10335 ROTOR ASSEMBLY
- * ALSO SUPPLIED IN 10335 ROTOR ASSEMBLY
- SUPPLIED IN 10317 SPLASH SHIELD KIT

1961 ALTERNATOR (LEECE NEVILLE 15 VOLT-50 AMP.)

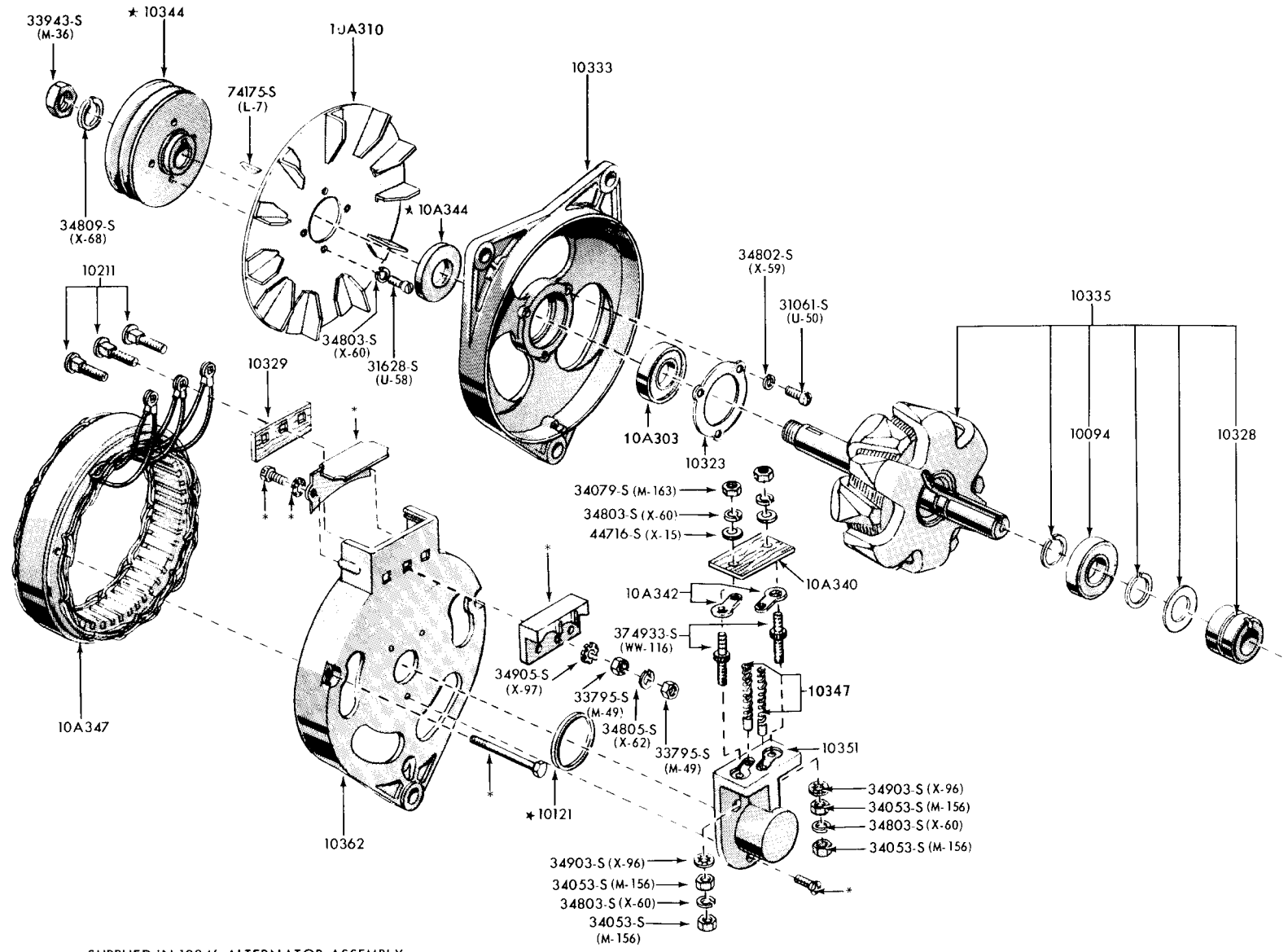

* SUPPLIED IN 10346 ALTERNATOR ASSEMBLY

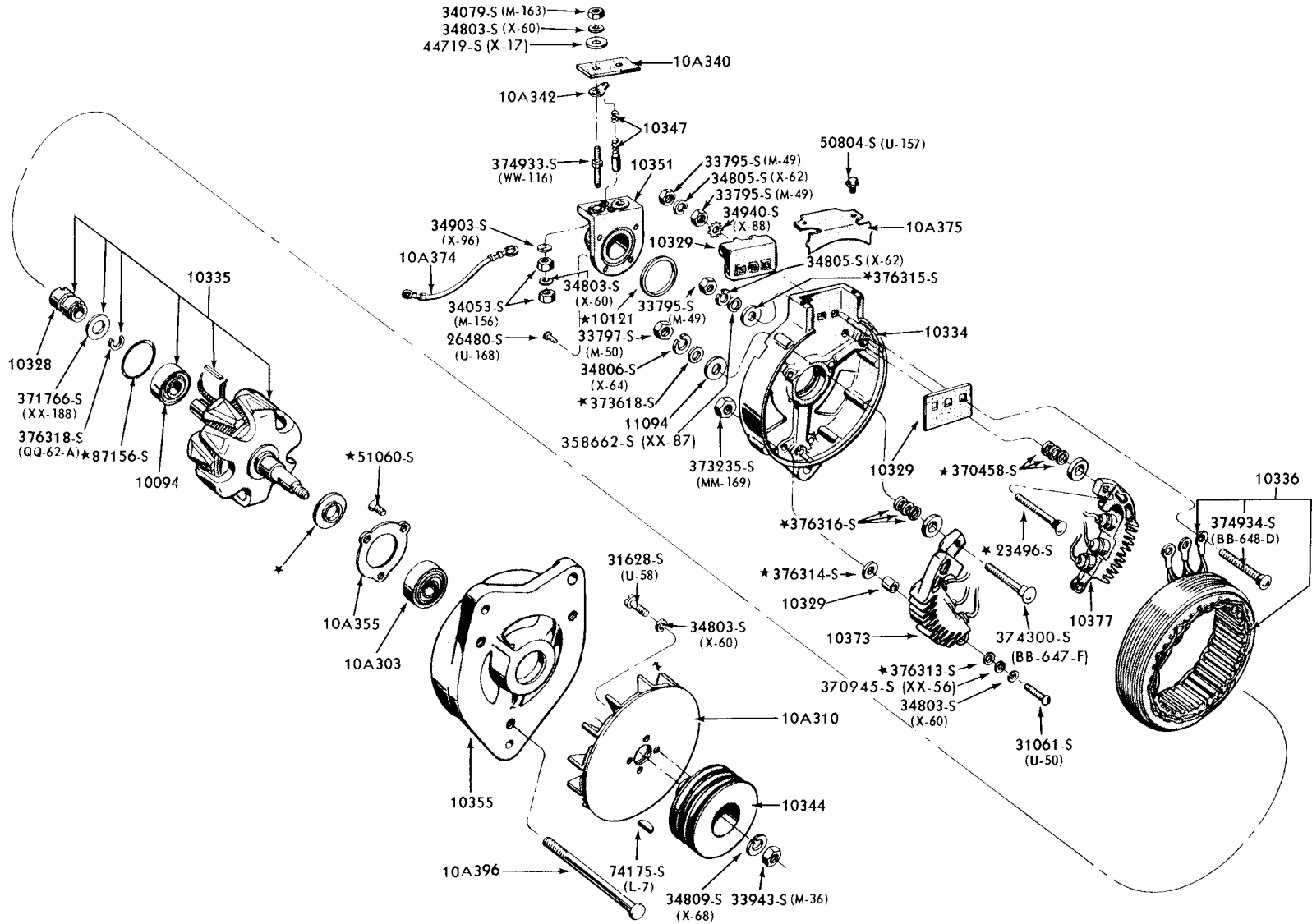

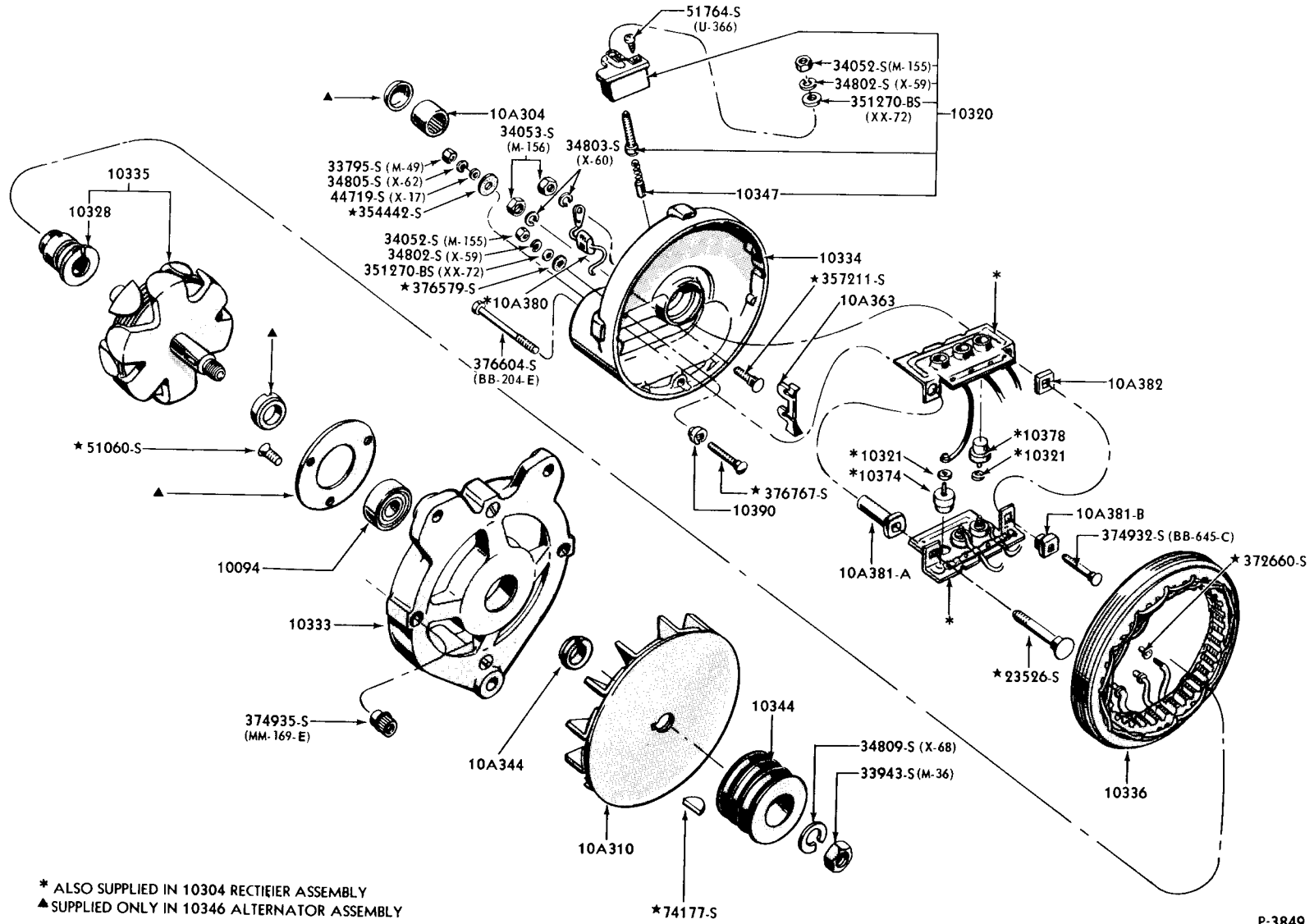

* ALSO SUPPLIED IN 10304 RECTIFIER ASSEMBLY
 ▲ SUPPLIED ONLY IN 10346 ALTERNATOR ASSEMBLY

1962 / ALTERNATOR (LEECHE NEVILLE 15 VOLT-40, 53 AMP.)

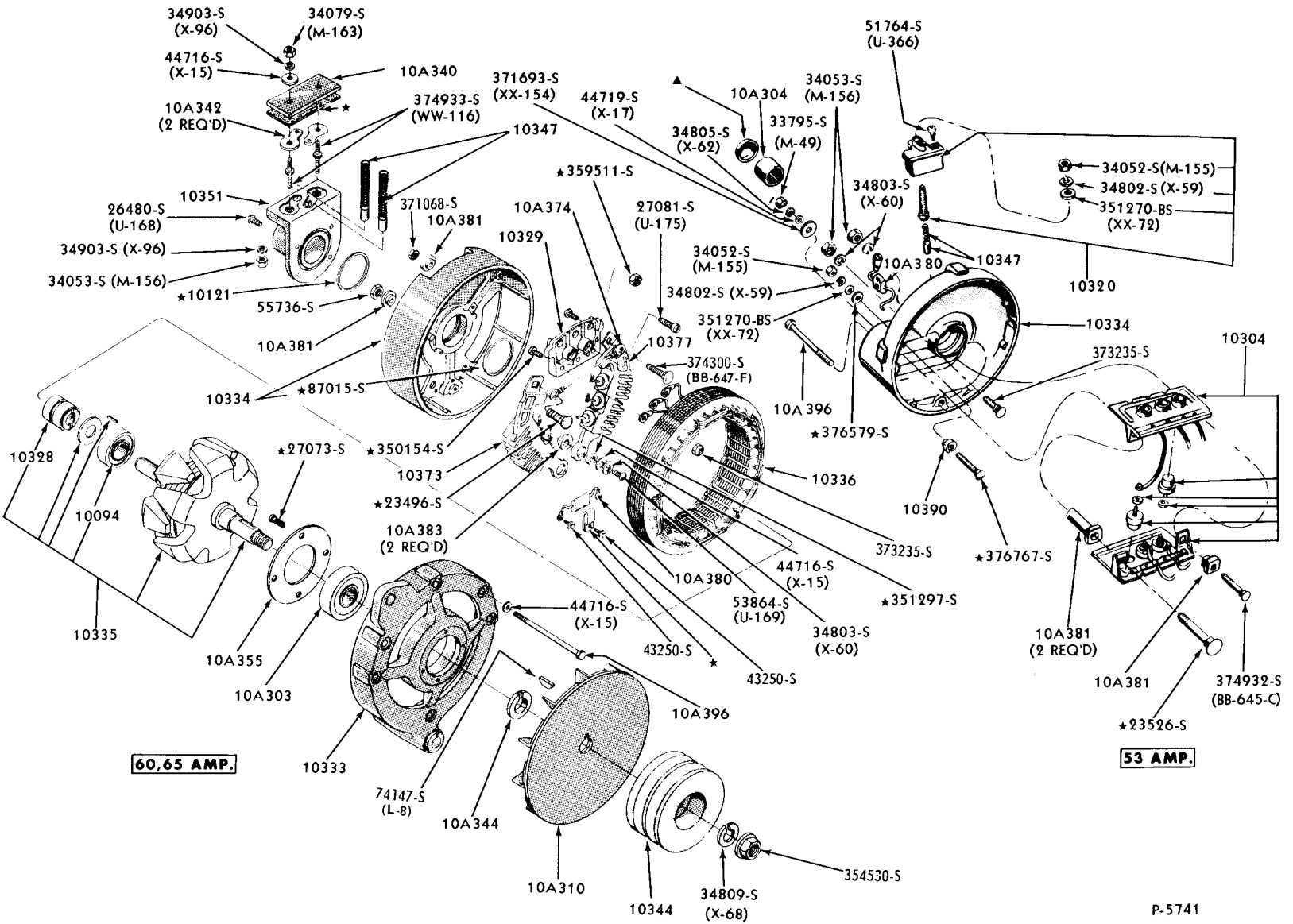

1864/ ALTERNATOR (LIEBCE NEVILLE 15 VOLT-53, 60, 65 AMP.) - TYPICAL

P-5741

1963/64 ALTERNATOR (FORD 15 VOLT-30, 40, 42, 52 AMP.)

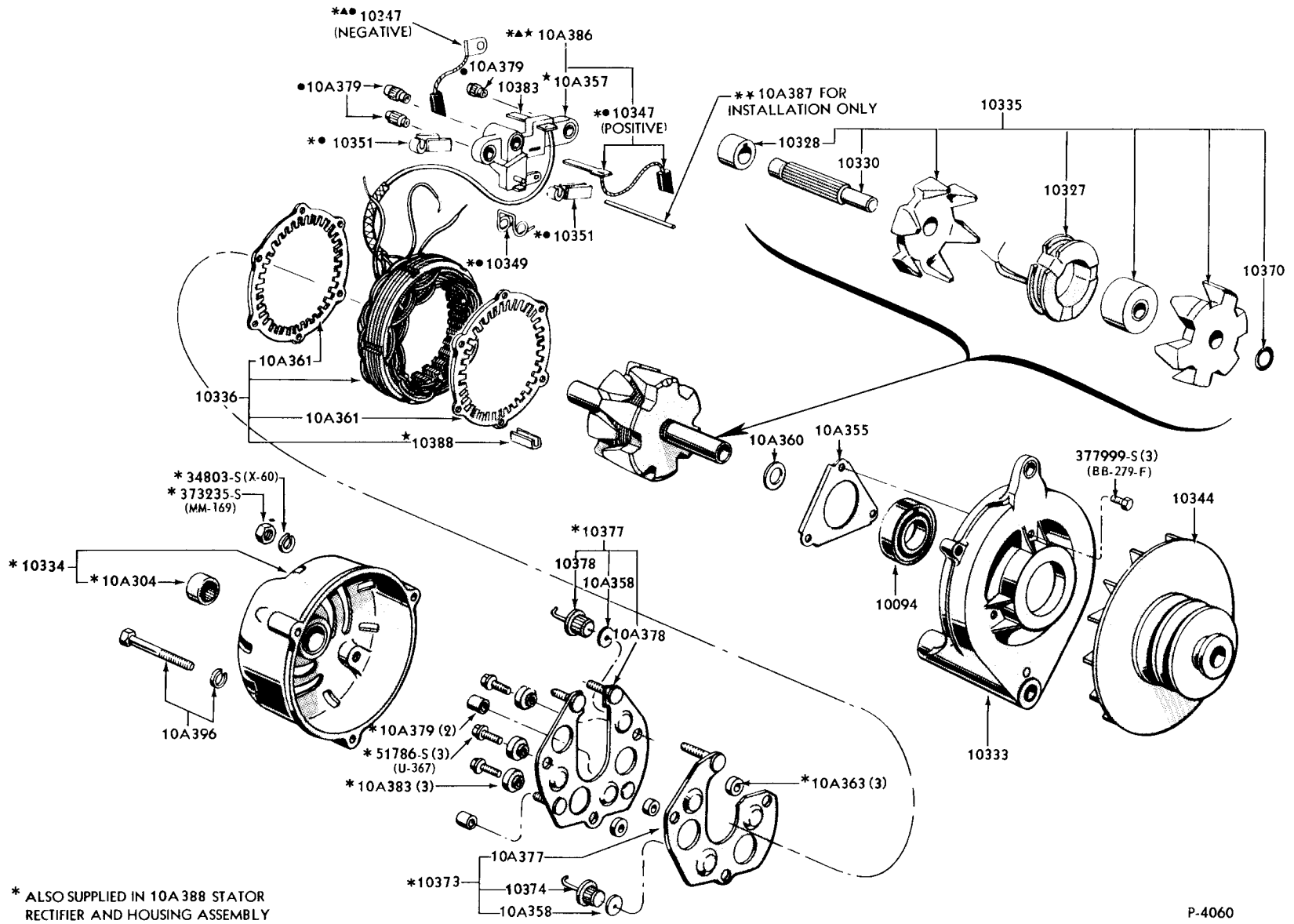

- * ALSO SUPPLIED IN 10A 388 STATOR RECTIFIER AND HOUSING ASSEMBLY
- ALSO SUPPLIED IN 10347 TERMINAL AND BRUSH KIT
- ▲ ALSO SUPPLIED IN 10347 SPACER AND BRUSH KIT

1963/64 ALTERNATOR (FORD 16 VOLT-38, 42, 45, 55 AMP.) - PRINTED CIRCUIT TYPE

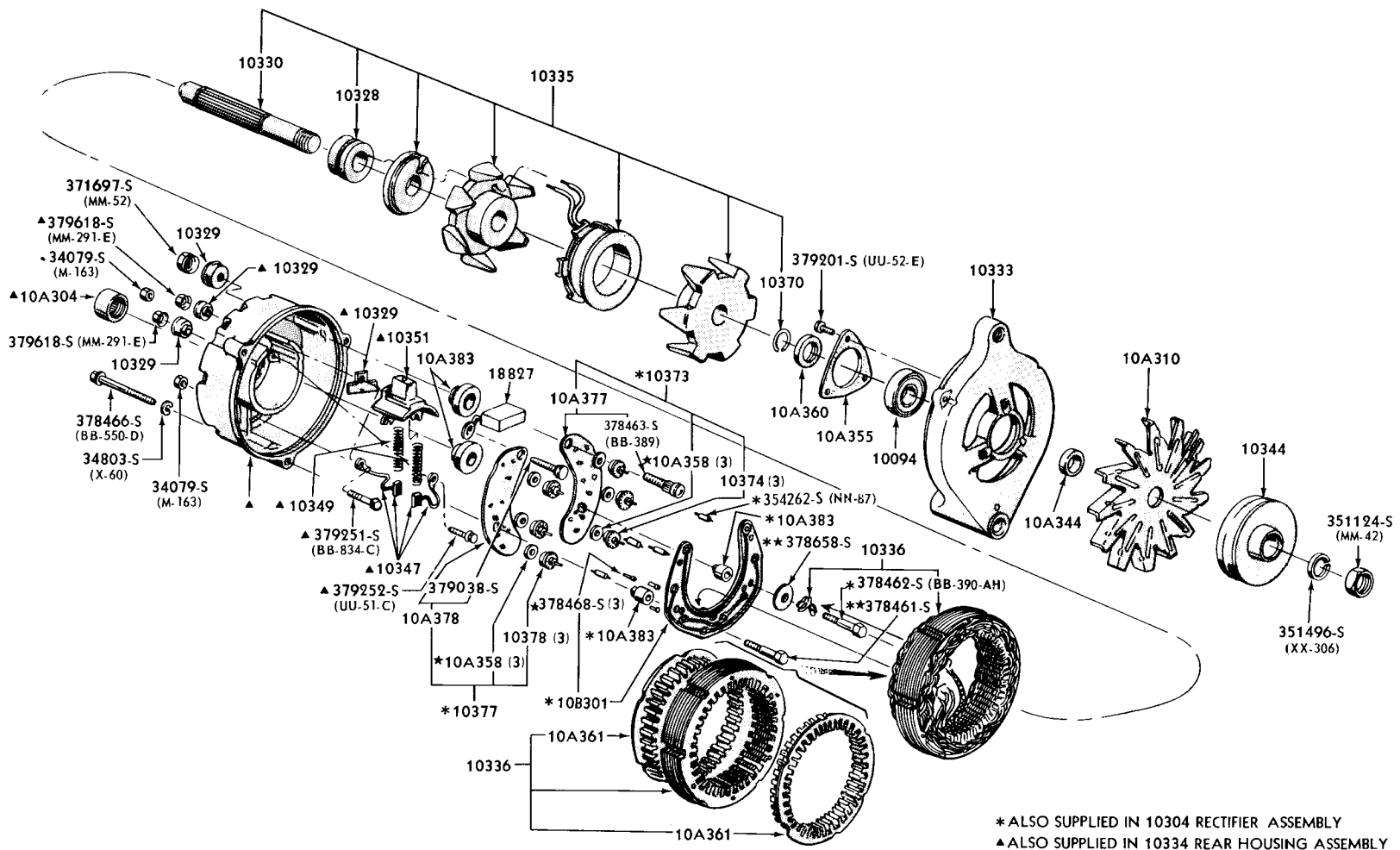

* ALSO SUPPLIED IN 10304 RECTIFIER ASSEMBLY
 ▲ ALSO SUPPLIED IN 10334 REAR HOUSING ASSEMBLY

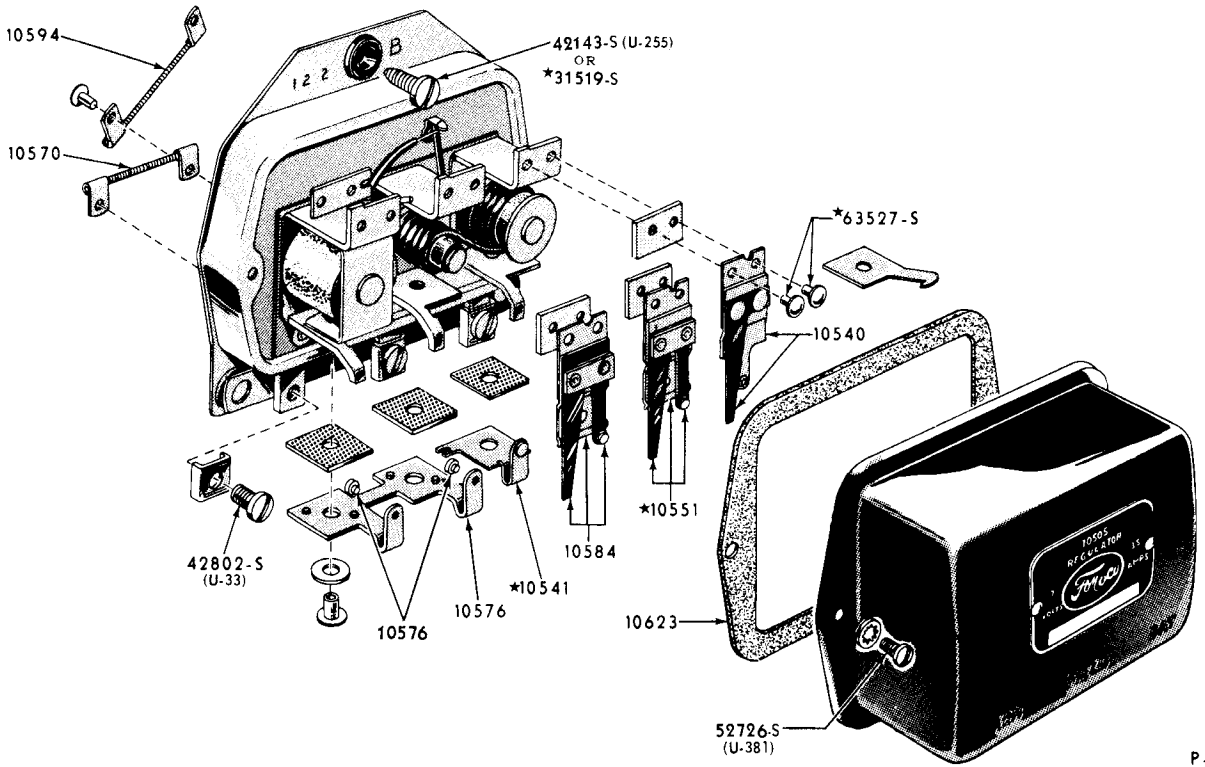

P-1535

1960/ VOLTAGE REGULATOR - TYPICAL (GENERATOR)

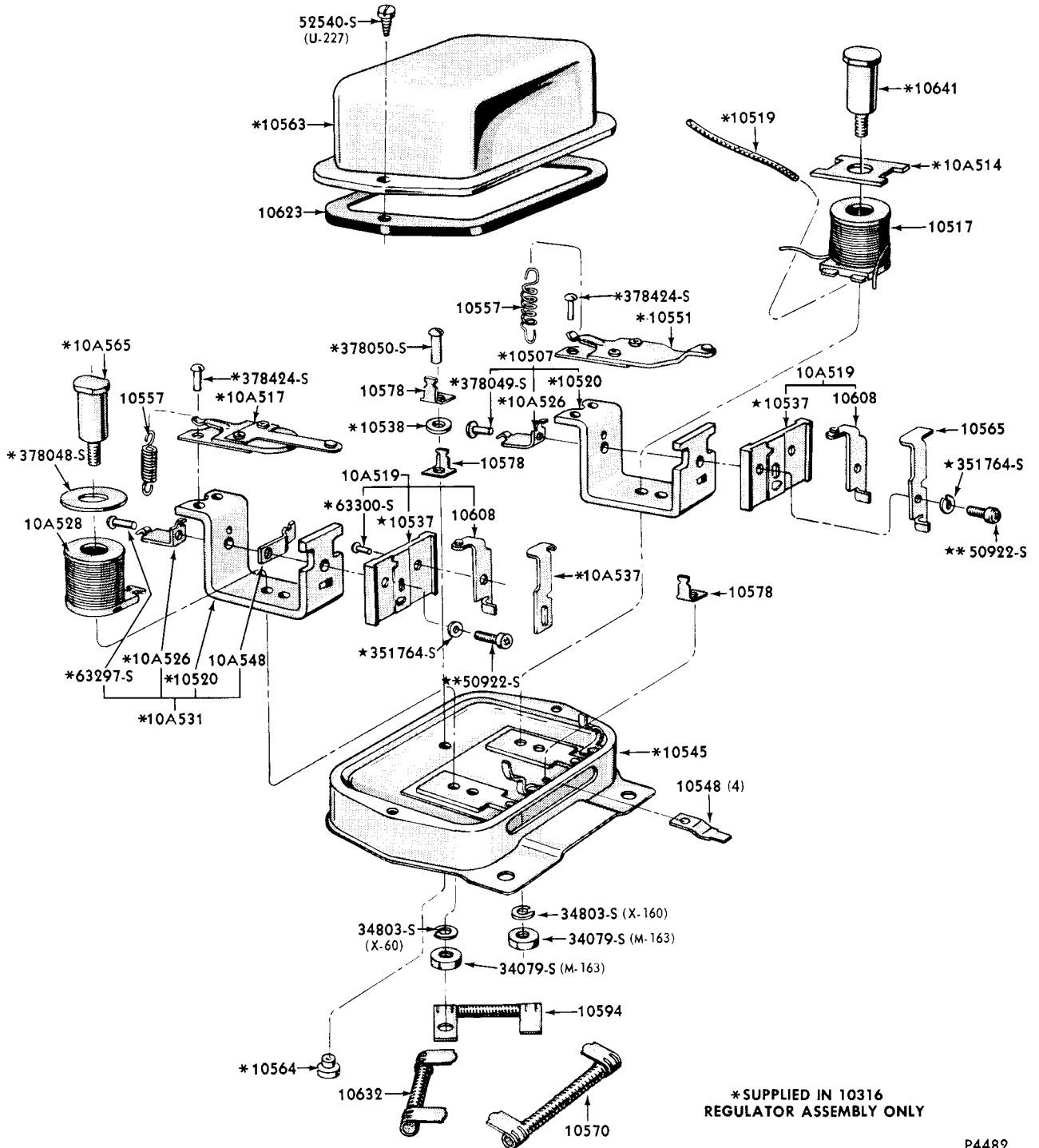

1963 VOLTAGE REGULATOR (FORD 15 VOLT NEGATIVE GROUND)- ALTERNATOR

P4482

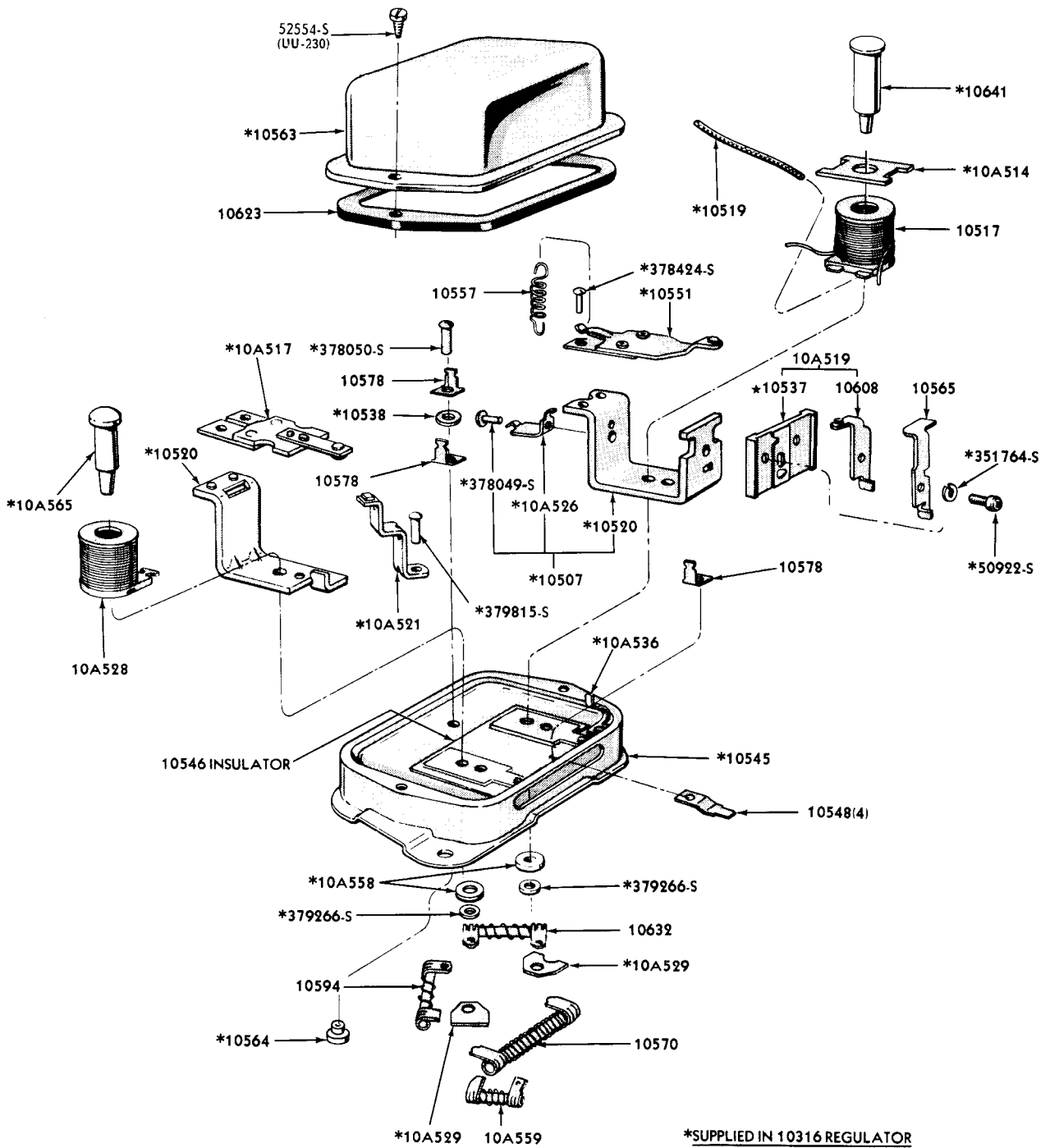

***SUPPLIED IN 10316 REGULATOR
ASSY. ONLY**

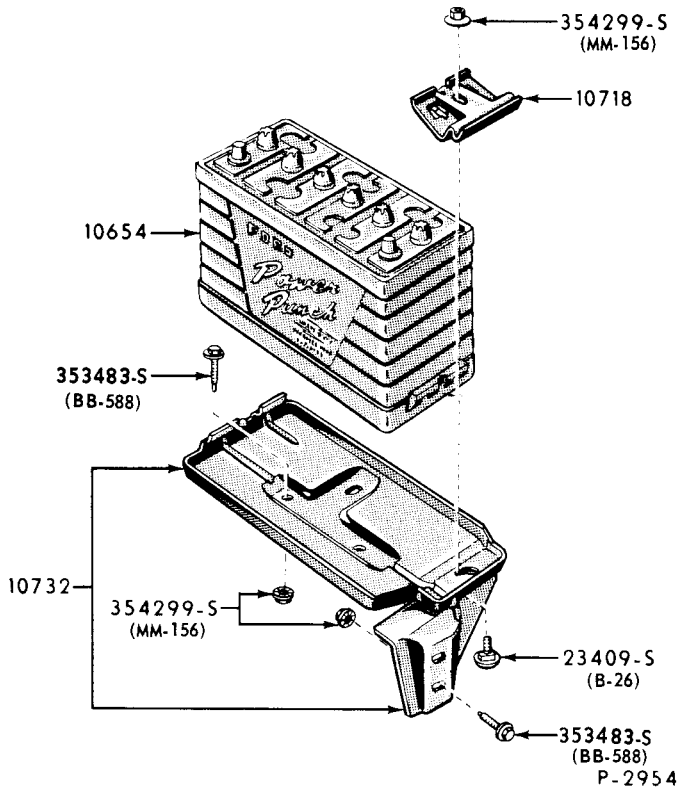

BATTERY CARRIER and RELATED PARTS
1960 FORD

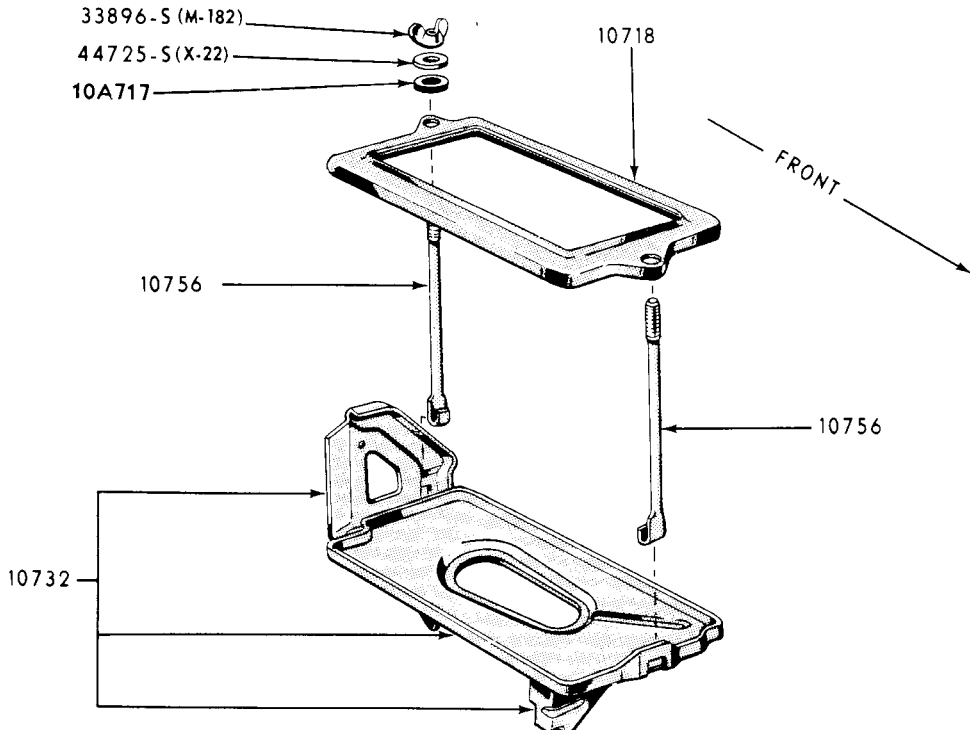

P-2795

BATTERY CARRIER and RELATED PARTS
1960 THUNDERBIRD

FORD CAR PARTS

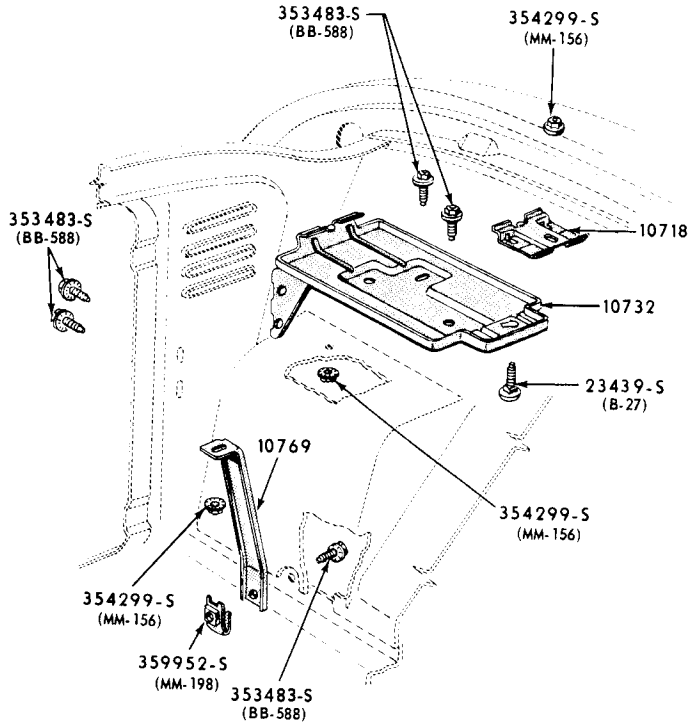

BATTERY CARRIER and RELATED PARTS
1960/ FALCON

P-3106

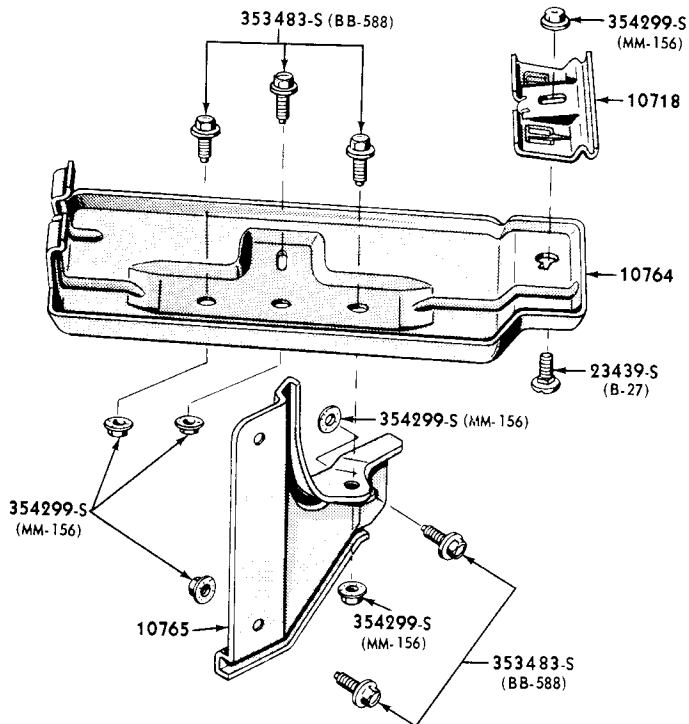

BATTERY CARRIER and RELATED PARTS
1961/64 FORD

P-3257

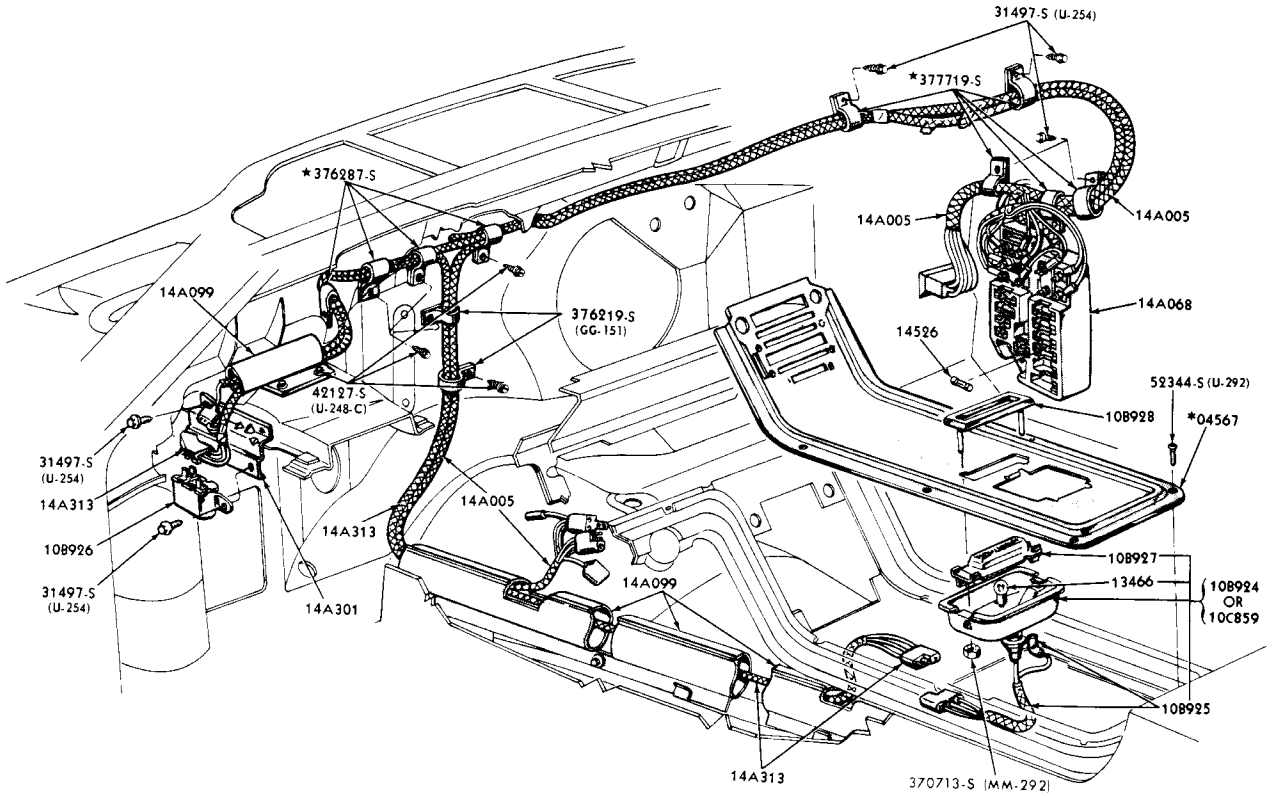

* REFER TO BODY GROUP NUMBER

P-4405

SEAT BELT WARNING LAMP INSTALLATION
1964/ THUNDERBIRD

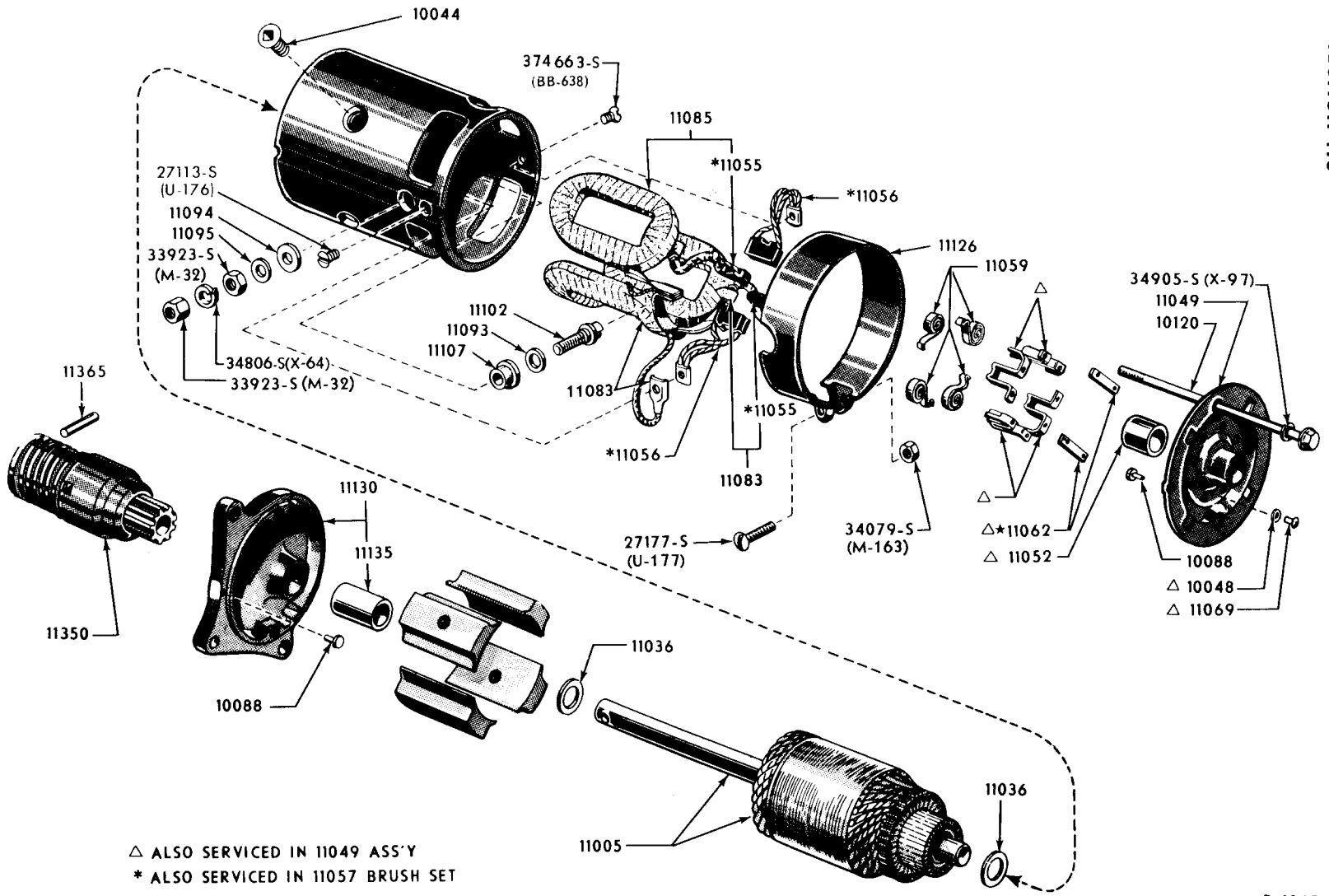

△ ALSO SERVICED IN 11049 ASS'Y
 * ALSO SERVICED IN 11057 BRUSH SET

1960/64 STARTER AND DRIVE ASSY - INERTIA-TYPICAL

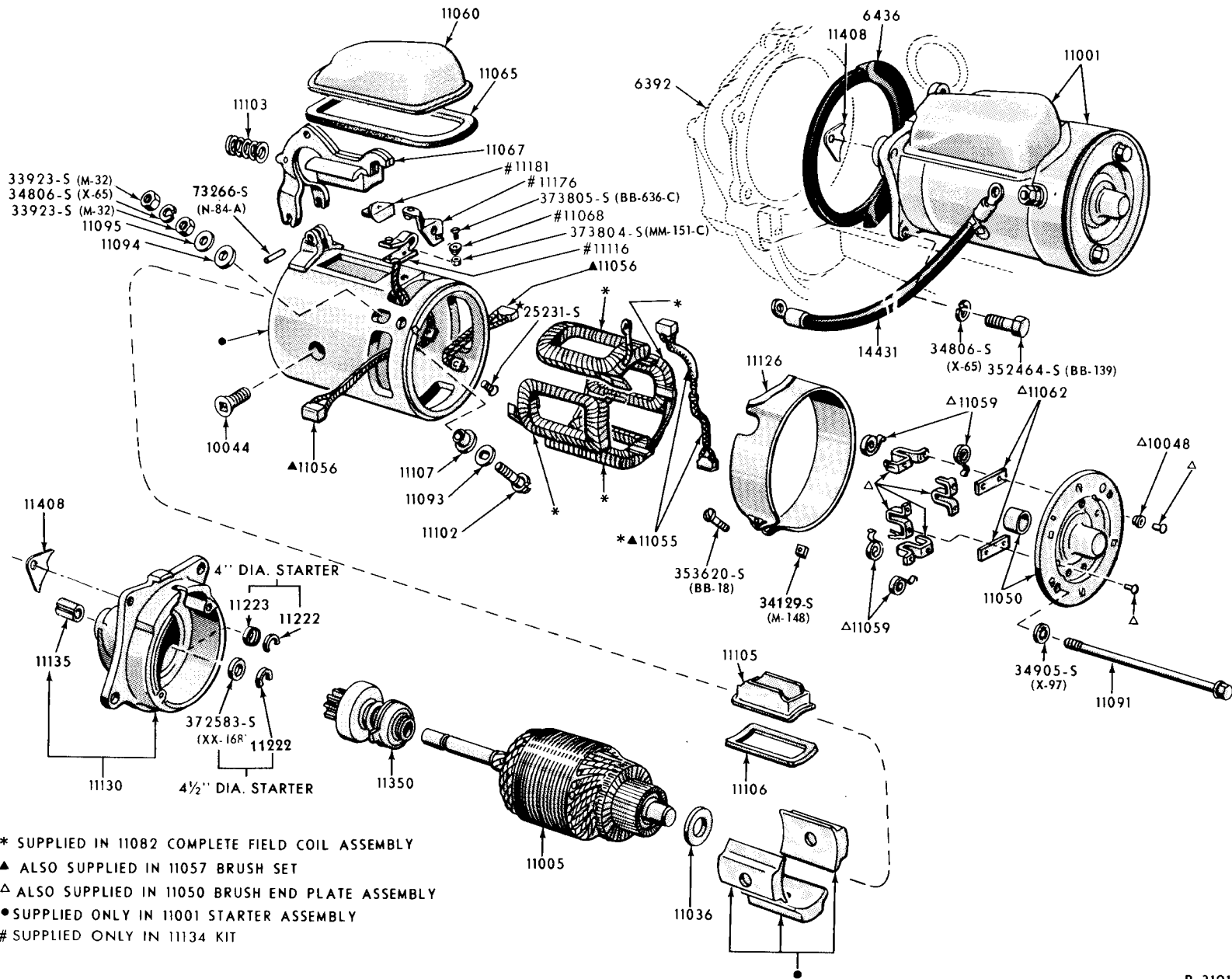

- * SUPPLIED IN 11082 COMPLETE FIELD COIL ASSEMBLY
- ▲ ALSO SUPPLIED IN 11057 BRUSH SET
- △ ALSO SUPPLIED IN 11050 BRUSH END PLATE ASSEMBLY
- SUPPLIED ONLY IN 11001 STARTER ASSEMBLY
- # SUPPLIED ONLY IN 11134 KIT

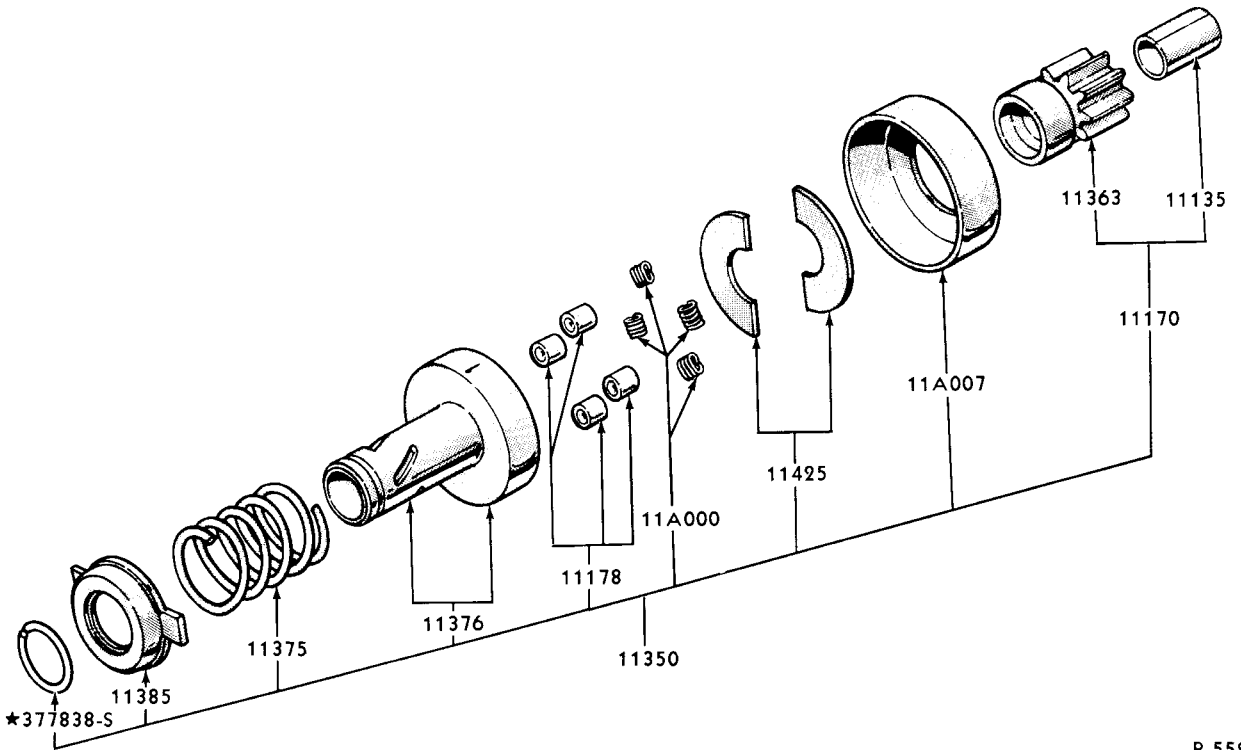

P-5526

1960/ STARTER DRIVE (FORD 12 VOLT-POSITIVE ENGAGEMENT)

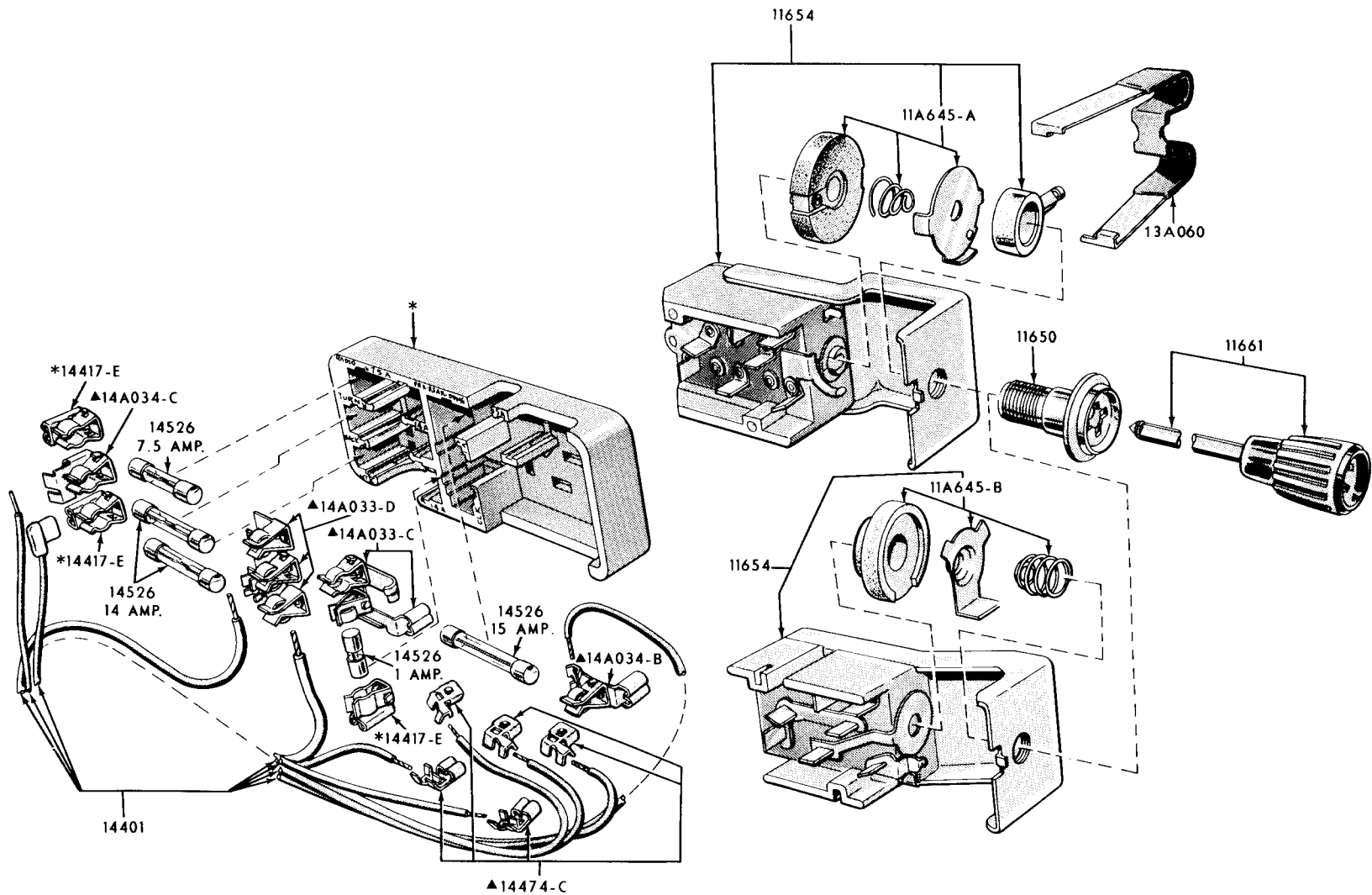

*ALSO SUPPLIED IN 11A647 JUNCTION BLOCK ASSEMBLY
 ▲ALSO SUPPLIED IN 14401 WIRING ASSEMBLY

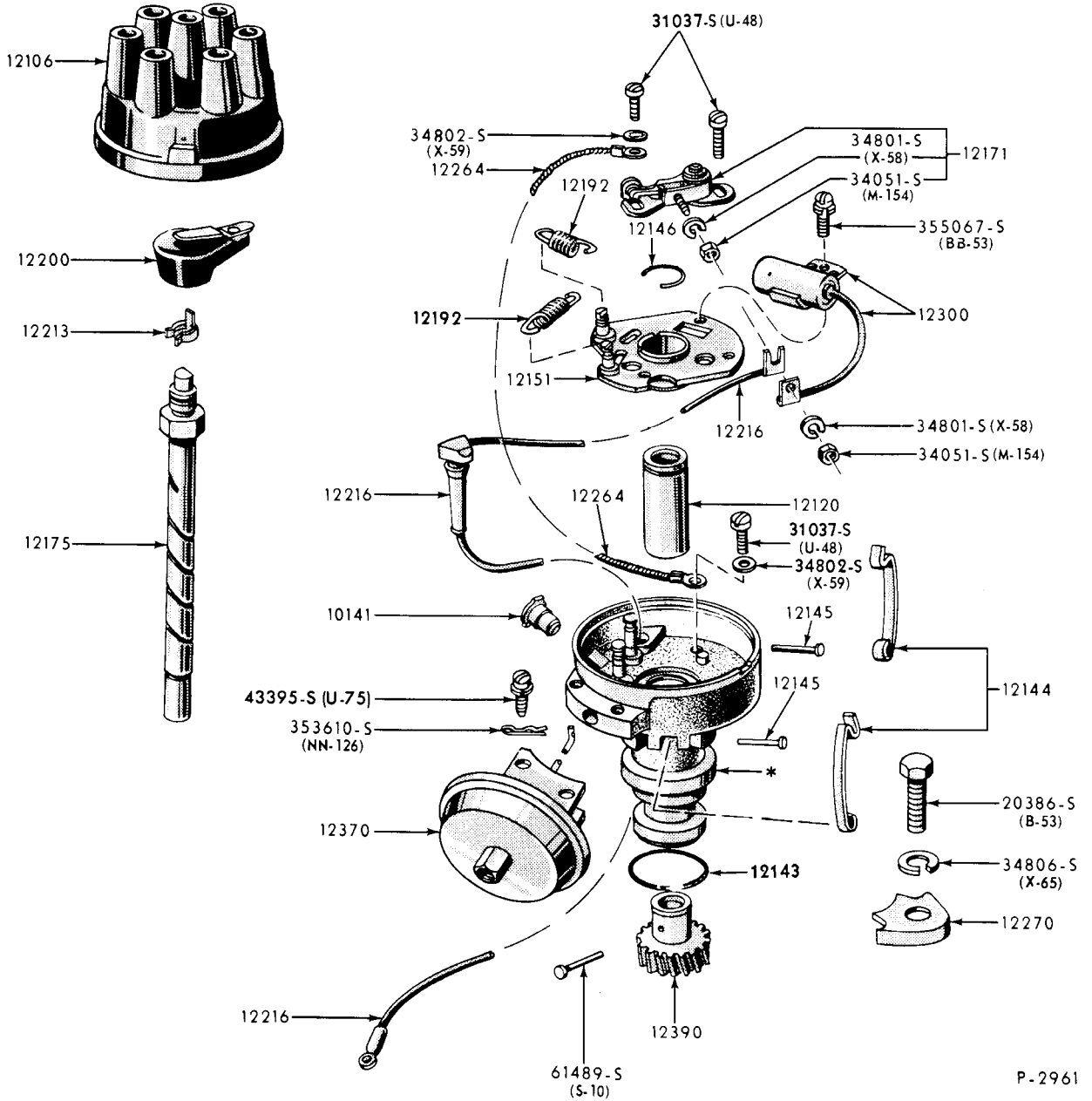

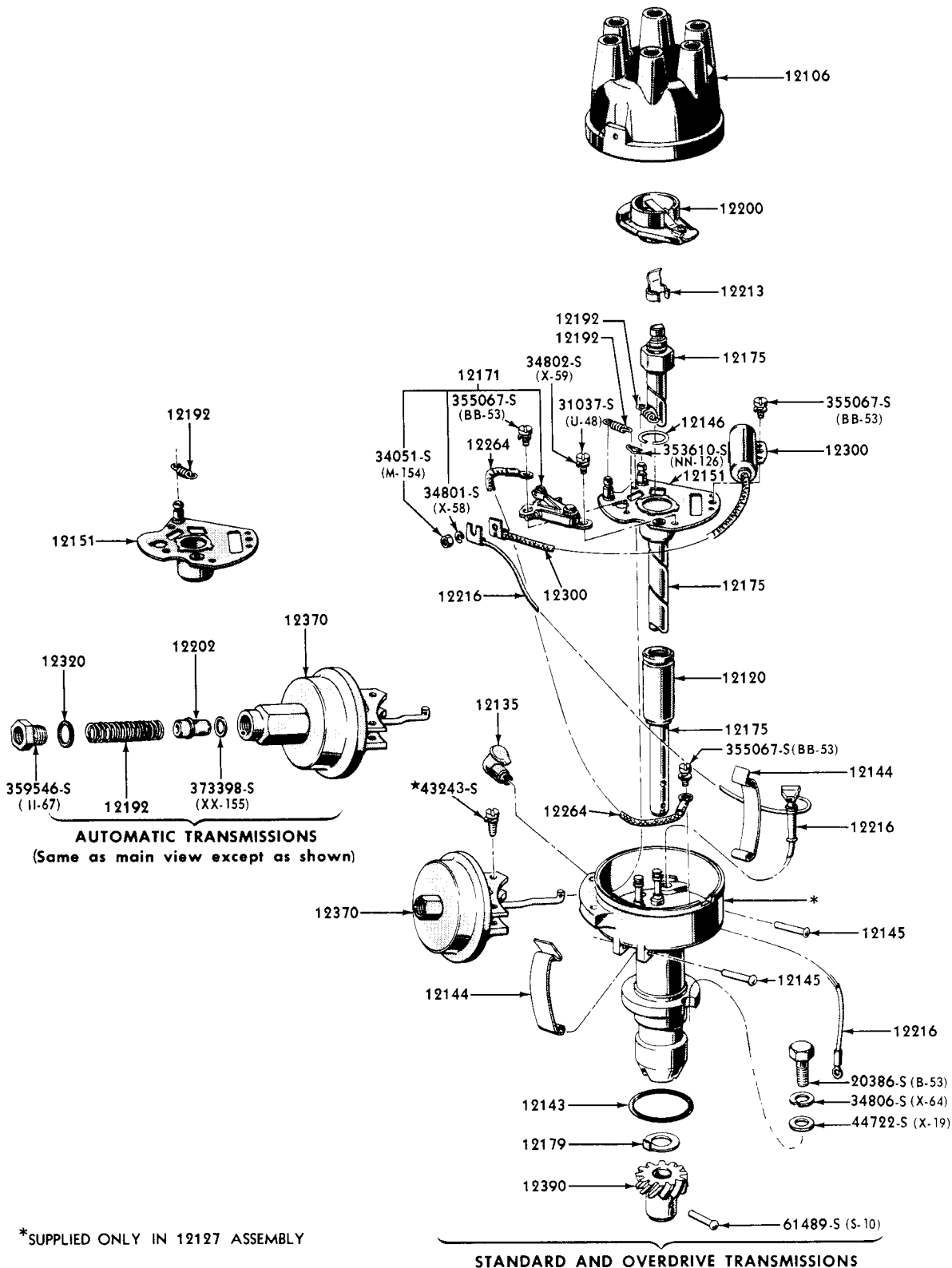

*SUPPLIED ONLY IN 12127 ASSEMBLY

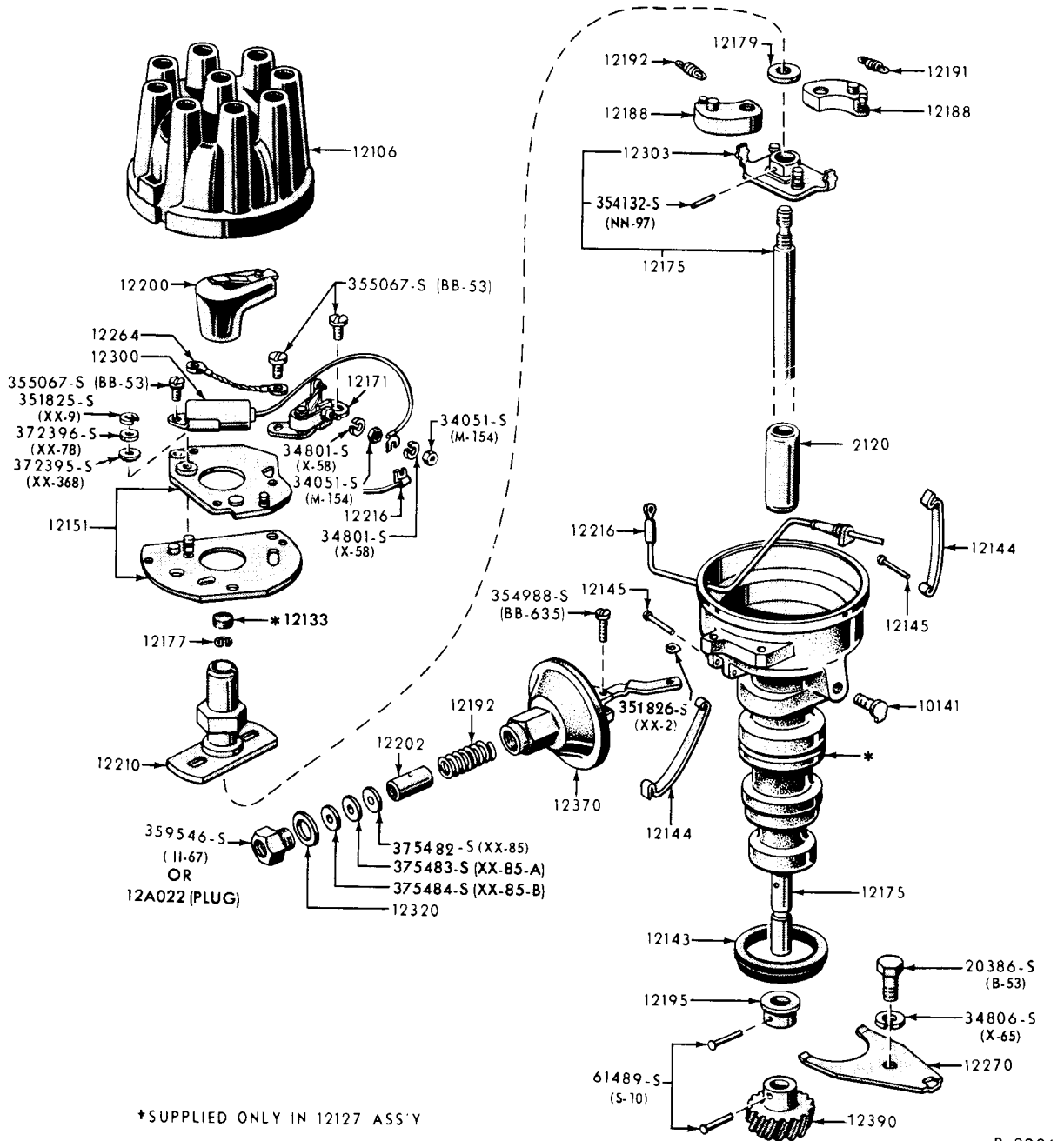

1960/ DISTRIBUTOR (8 CYLINDER 221, 260, 289, 292, 352, 390 & 430 ENGINES)
 (PIVOT PLATE TYPE-EXCEPT WITH STAMPED WEIGHTS)

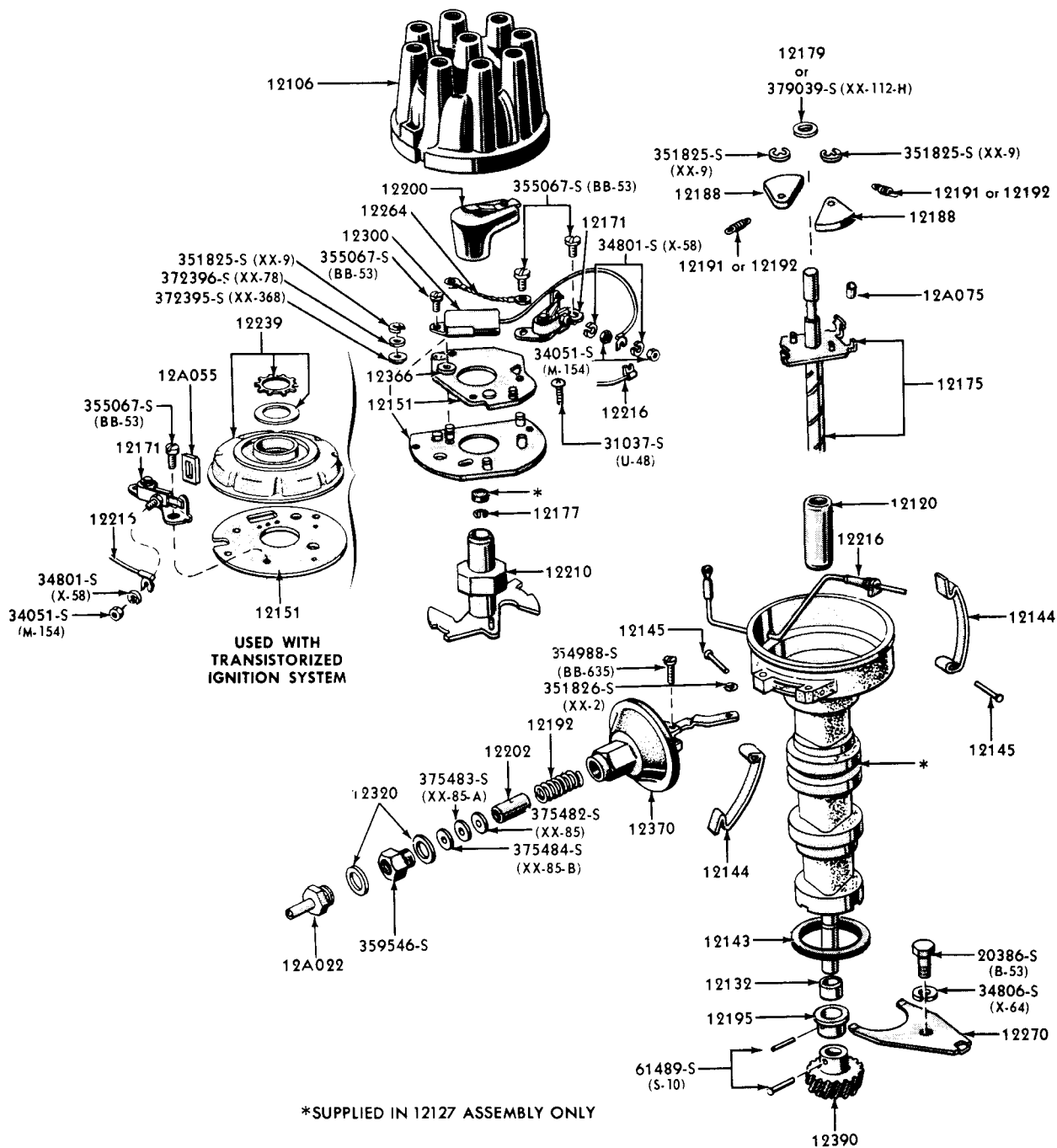

1960/ DISTRIBUTOR (8 CYLINDER 221, 260, 289, 292, 352, 390, 406, 427, 430 ENGINES)
(WITH STAMPED WEIGHTS)

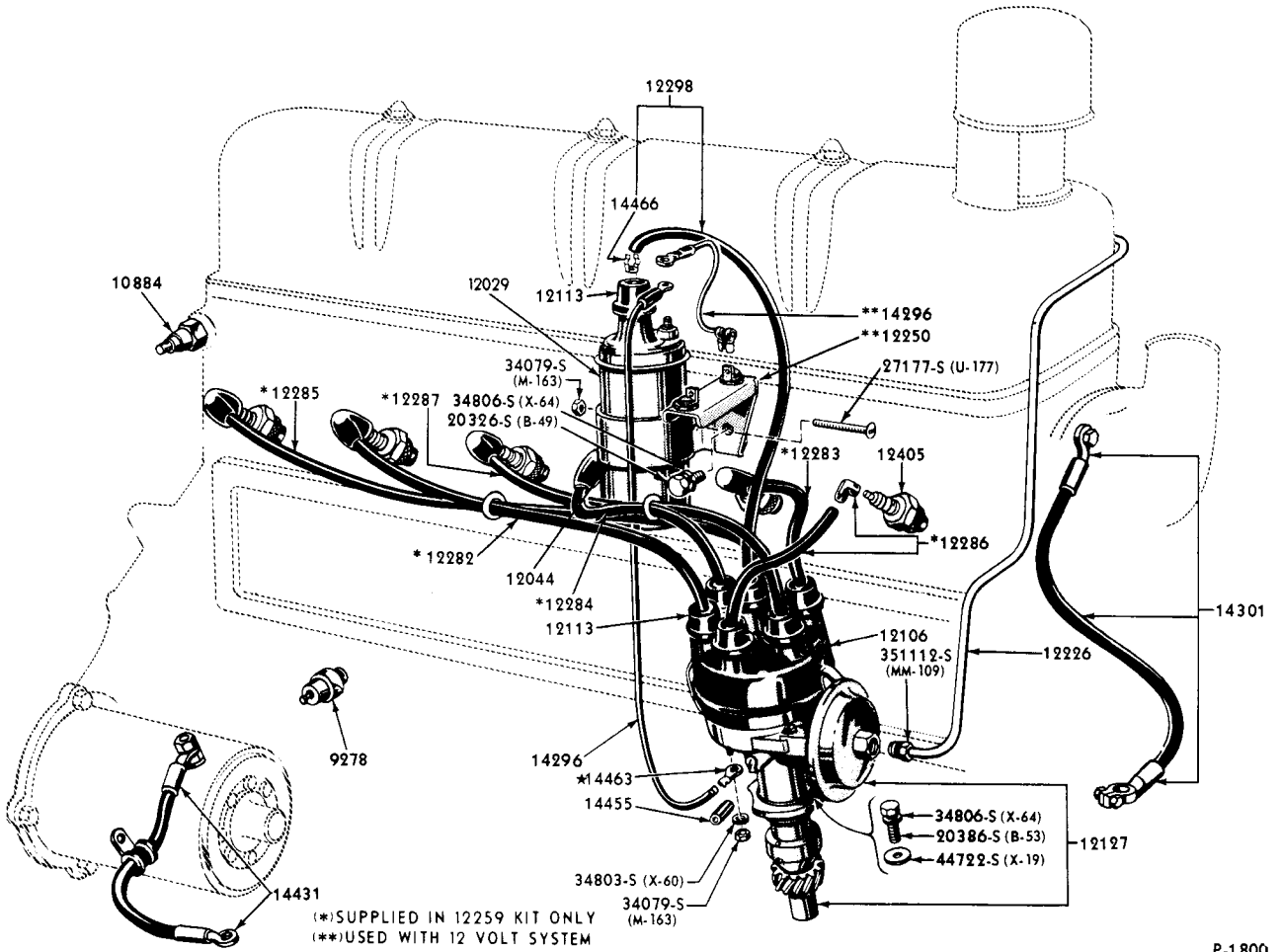

1960/64 IGNITION WIRING (6 CYLINDER 223 ENGINE)-TYPICAL

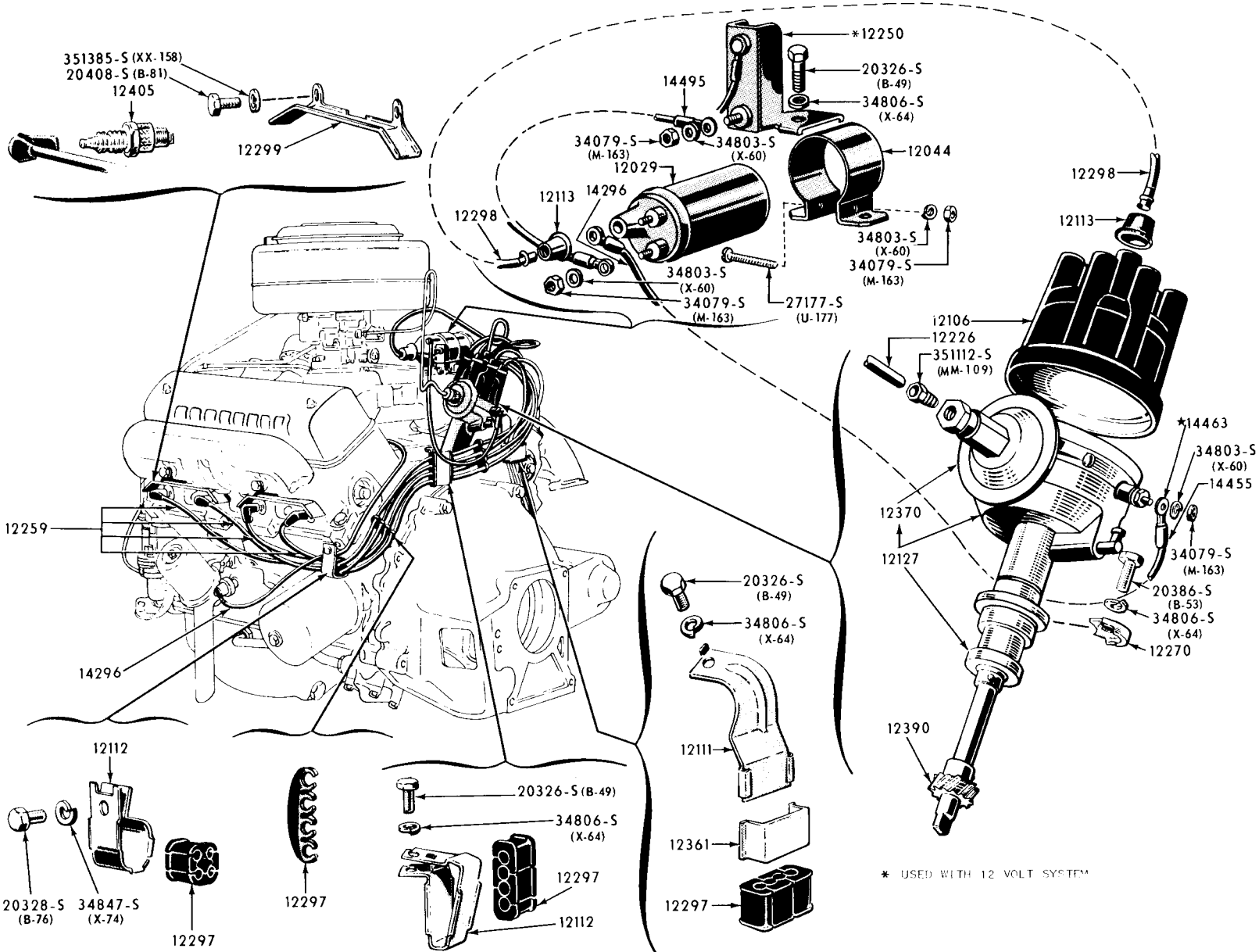

* USED WITH 12 VOLT SYSTEM

1960/64 IGNITION WIRING (8 CYLINDER 352, 390 & 430 ENGINES)-TYPICAL

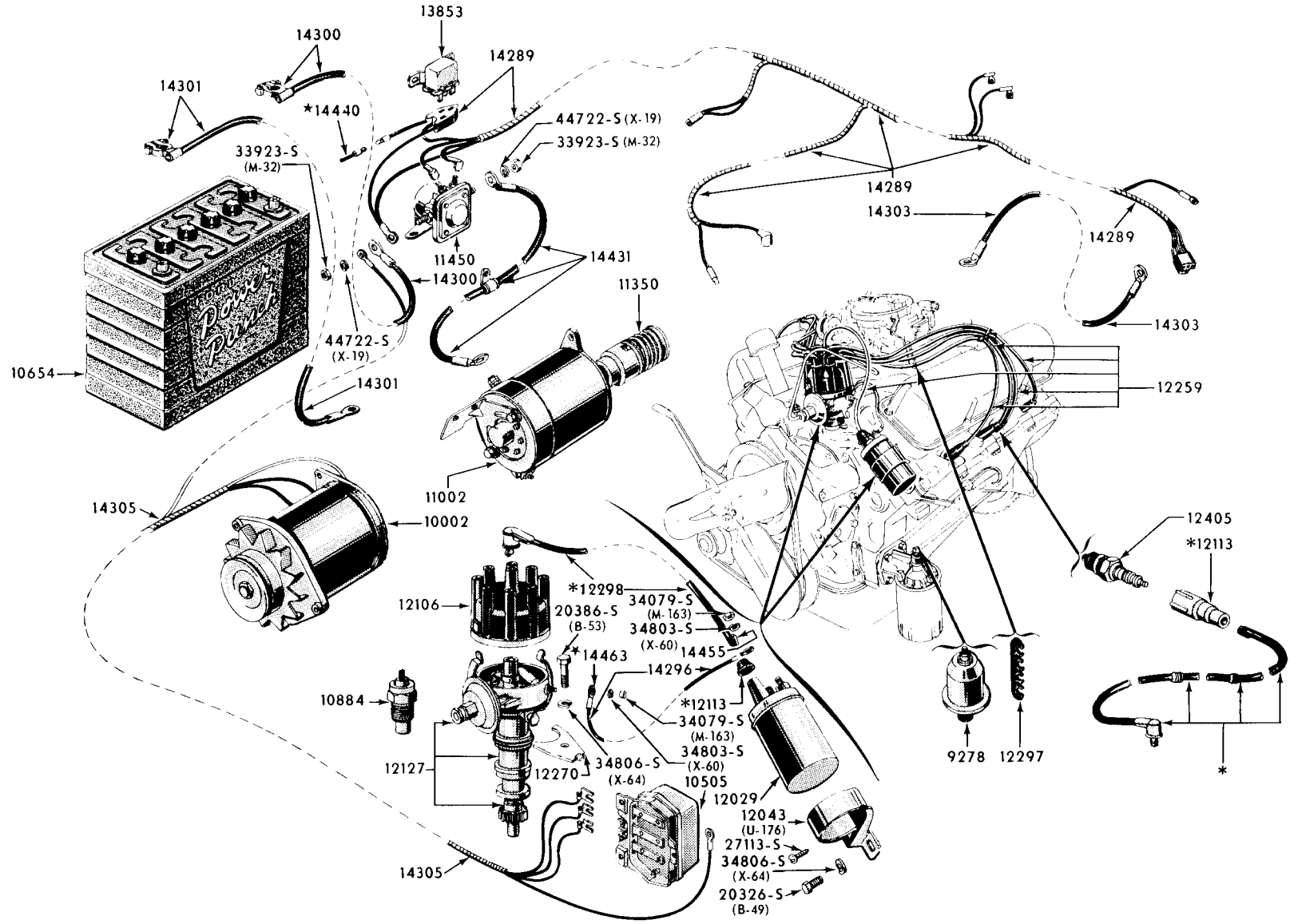

*ALSO SUPPLIED IN 12259 SPARK PLUG WIRE SET

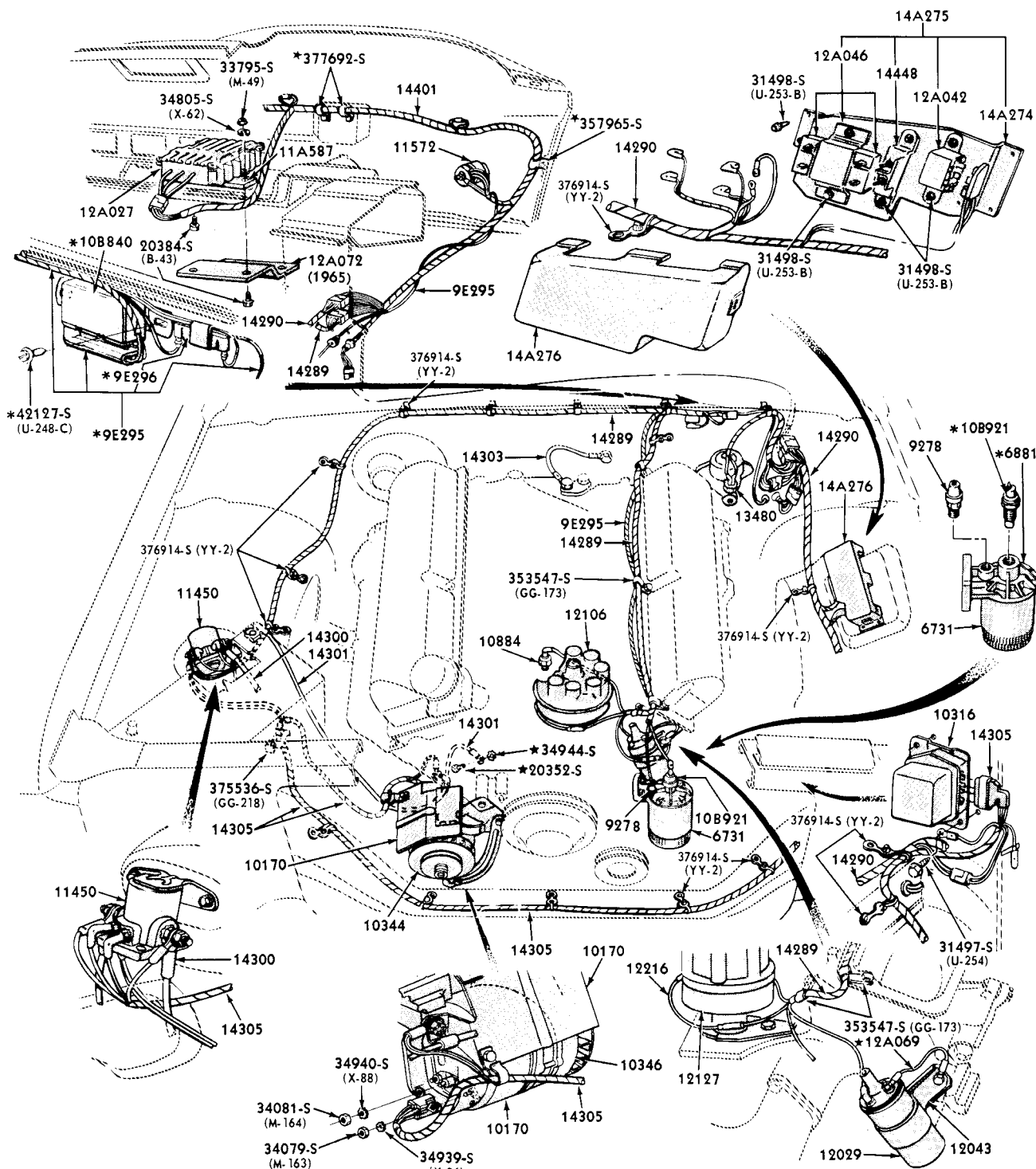

* USED WITH ENGINE OIL TEMPERATURE WARNING SYSTEM

1963/ TRANSISTORIZED IGNITION SYSTEM, OIL TEMPERATURE WARNING SYSTEM & RELATED PARTS (8 CYLINDER 427 ENGINE)(FORD)

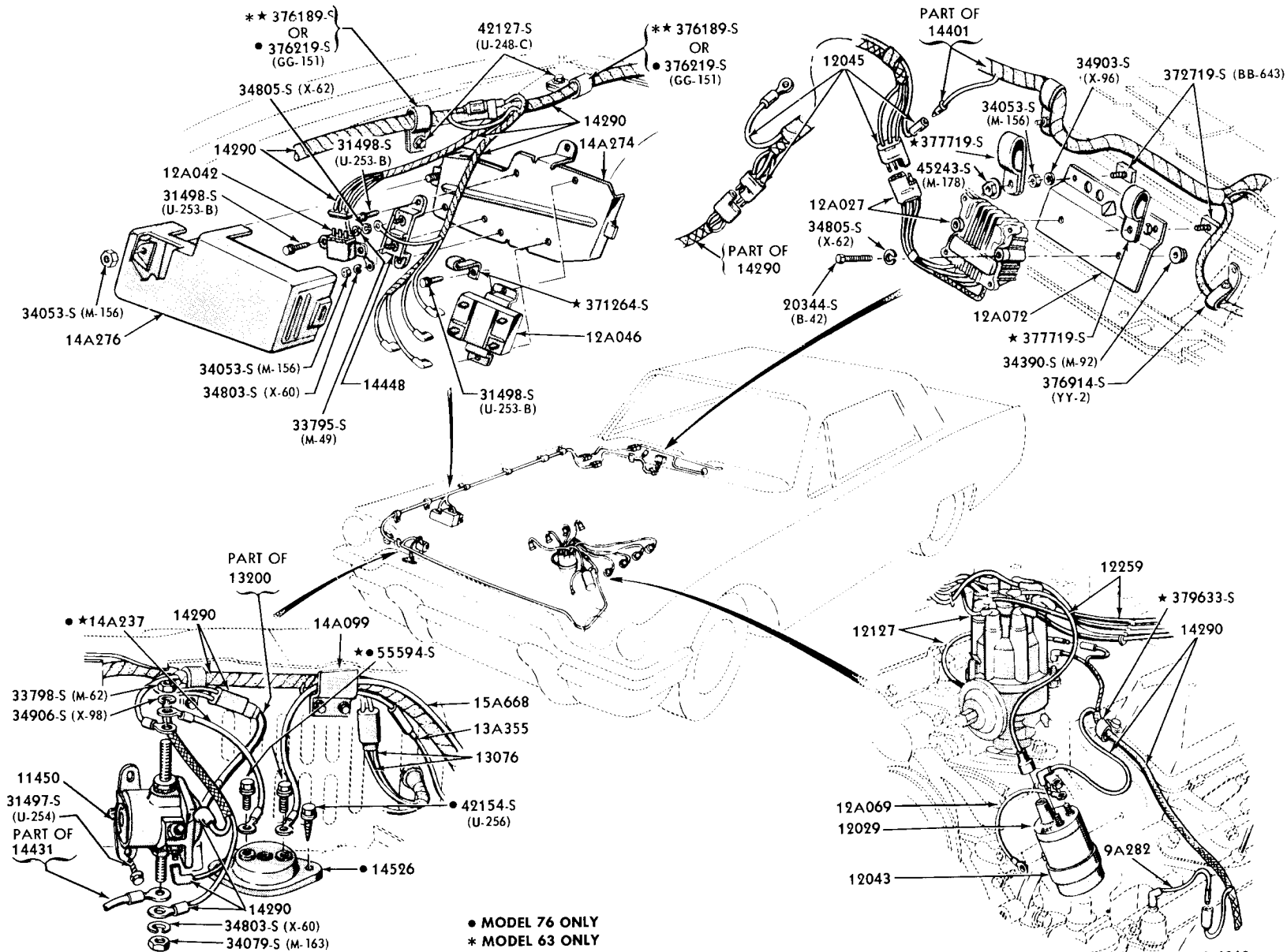

● MODEL 76 ONLY
* MODEL 63 ONLY