

INDEX

INCLUDED IN THIS INDEX ARE THE FOLLOWING MAJOR GROUPS IN THE ORDER SHOWN BELOW:

AUTOMATIC TRANSMISSION ASSEMBLIES

	Illustration Section
F/M/2 Type	A70. 1
C/M Type - FM, FX, MX Models	A70. 2
C4 Type	A70. 4
Transmission Oil Cooling System & Vacuum Advance System	A71

SHIFT CONTROL MECHANISMS

Column Mounted	A72
Floor & Console Mounted	A72. 1

ILLUSTRATIONS RELATED TO TRANSMISSION FUNCTIONS ARE SHOWN BELOW FOR REFERENCE

Steering Column w/o Shift Mechanism	35
Transmission Kickdown & Acceleration Linkage Mechanism	97
Console Mounted Parts Related to Shift Control Mechanisms	042 (Body)

AUTOMATIC TRANSMISSION ASSEMBLIES

TITLE	YEAR	MODEL	SECTION	PAGE	ILLUS. NO.
F/M/2 TYPE					
Case, converter assy., extension, pumps and related parts-Typical	60/64	A	A70. 1	233	P-2810
Case, converter assy., extension, pumps and related parts-Typical	60/64	B, X	A70. 1	234	P-3149
Clutch, gears, shafts and related parts-Typical	60/64	A, B, X	A70. 1	235	P-2811
Main control valve body assy. -(Basic 7A100)-Typical	60/64	A, B, X	A70. 1	236	P-2815
Parking pawl, throttle and manual control linkage-Typical	60/64	A, B, X	A70. 1	236	P-2814
Servo and band assy. -Front-Typical	60/64	A, B, X	A70. 1	237	P-2812
Rear-Typical	60/64	A, B, X	A70. 1	237	P-2813
C/M TYPE - FM,FX,MX MODELS					
Case, converter assy., extension, pumps and related parts-Typical	60/	A, S	A70. 2	238	P-1871
Clutches, gears, shafts and related parts-FX, MX model-Typical	60/	A, S	A70. 2	239	P-2554
Clutches, gears, shafts and related parts-FM model-Typical	60	A	A70. 2	240	P-1886
Main control valve body assy. -(Basic 7A100)-Typical	60/	A, S	A70. 2	241	P-2583
Oil pressure regulator and related parts-(Basic 7A139)-Typical	60/	A, S	A70. 2	242	P-1725
Parking pawl, throttle and manual control linkage-Typical	60/	A, S	A70. 2	241	P-5206
Servo and band-Front-Typical	60/	A, S	A70. 2	243	P-2561
Rear-Typical	60/	A, S	A70. 2	243	P-6547
Transmission dash panel insulator and bracket	62	S	A70. 2	242	P-3743

INDEX

TITLE	YEAR	MODEL	SECTION	PAGE	ILLUS. NO.
AUTOMATIC TRANSMISSION ASSEMBLIES - continued					
C4 TYPE					
Case, converter assy., extension, pump and related parts-Typical	64/	A, B	A70.4	244	P-4326
Clutches, gears, shafts, rear support and related parts-Typical	64/	A, B	A70.4	245	P-4327
Main control valve body assy. -(Basic 7A100)-Typical	64/	A, B	A70.4	246	P-4507
Parking pawl, throttle and manual control linkage-Typical	64/	A, B	A70.4	246	P-4330
Servo and band-Front-Typical	64/	A, B	A70.4	247	P-4328
Rear-Typical			A70.4	247	P-4329
TRANSMISSION VACUUM THROTTLE & OIL COOLING SYSTEMS					
Vacuum throttle valve, lines and fittings - Typical	61/	A, B, S, X	A71	248	P-3627
Transmission miscellaneous bushings			A71	249	P-4862
Oil cooling system - Typical	60/63	A	A71	250	P-3183
Oil cooling system	64	A	A71	251	P-4244
Oil cooling system - Typical	62/	B, X	A71	252	P-4148
Oil cooling system - Typical	62/	S	A71	253	P-4145
STEERING COLUMN & SHIFT CONTROL SELECTOR MECHANISMS					
Steering column and shift control selector mechanism - Typical	60	A	A72	254	P-3070
	61/62	A	A72	255	P-3504
Fixed steering column and shift control selector mechanism - Typical	63/64	A	A72	256	P-4248
Movable steering column and shift control selector mechanism - Typical	63	A	A72	257	P-4061
	64	A	A72	258	P-4582
Steering column and shift control selector mechanism - Typical	62/	B	A72	259	P-3713
Steering column and shift control selector mechanism - Typical	60	S	A72	260	P-2688
Fixed steering column and shift control selector mechanism - Typical	61/	S	A72	261	P-3284
Movable steering column and shift control selector mechanism - Typical	61/63	S	A72	262	P-3285
	64/	S	A72	263	P-4224
Steering column and shift control selector mechanism - Typical	60/63	X	A72	264	P-3127
	64/	X	A72	265	P-4601
SHIFT CONTROL SELECTOR MECHANISM - CONSOLE MOUNTED					
Shift control selector mechanism	62/64	A	A72.1	266	P-3896

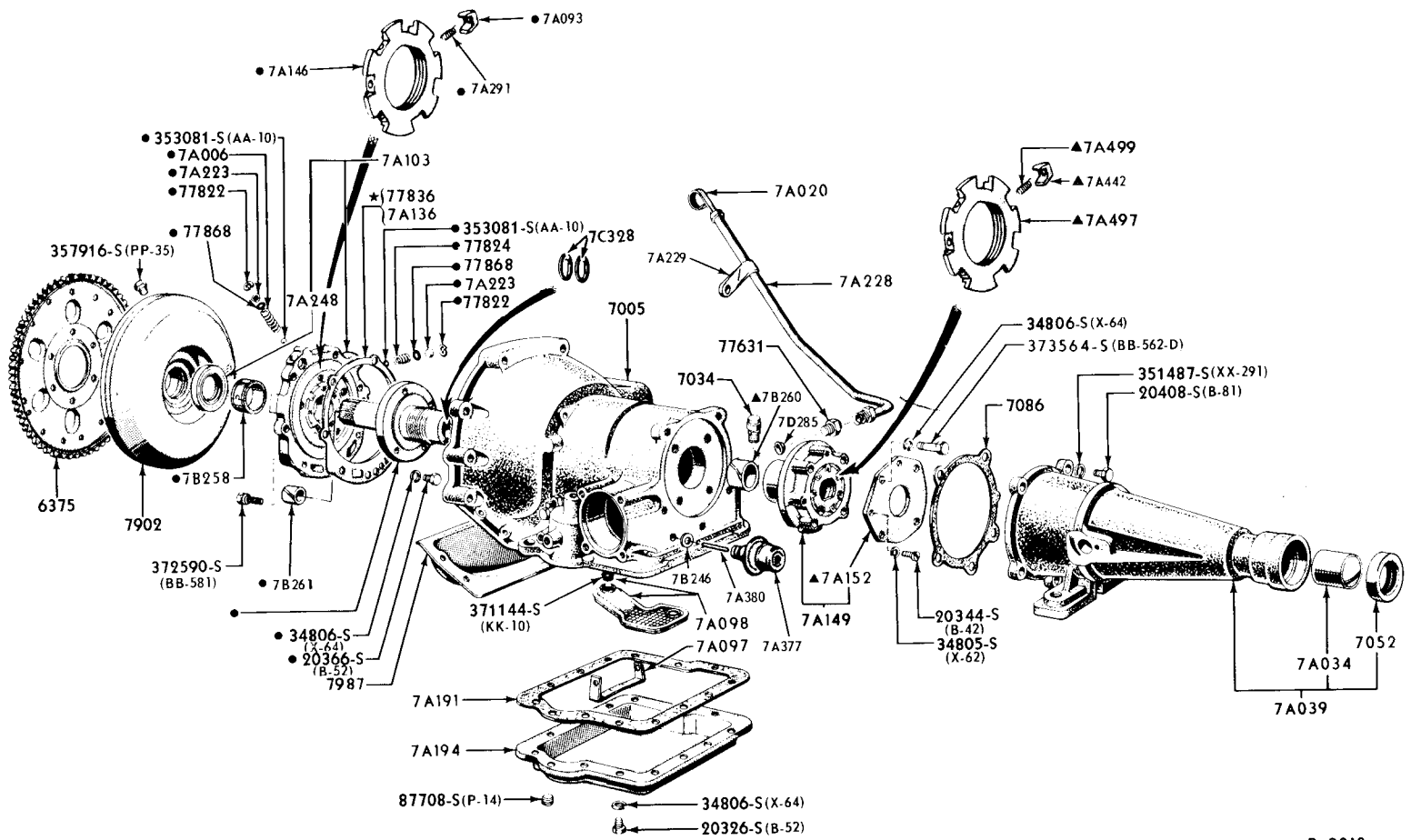

● ALSO SUPPLIED IN 7A103 FRONT OIL PUMP ASSEMBLY
▲ ALSO SUPPLIED IN 7A149 REAR OIL PUMP ASSEMBLY

P-2810

1960/64 CASE, CONVERTER ASSY., EXTENSION, PUMPS & RELATED PARTS-FORD-TYPICAL

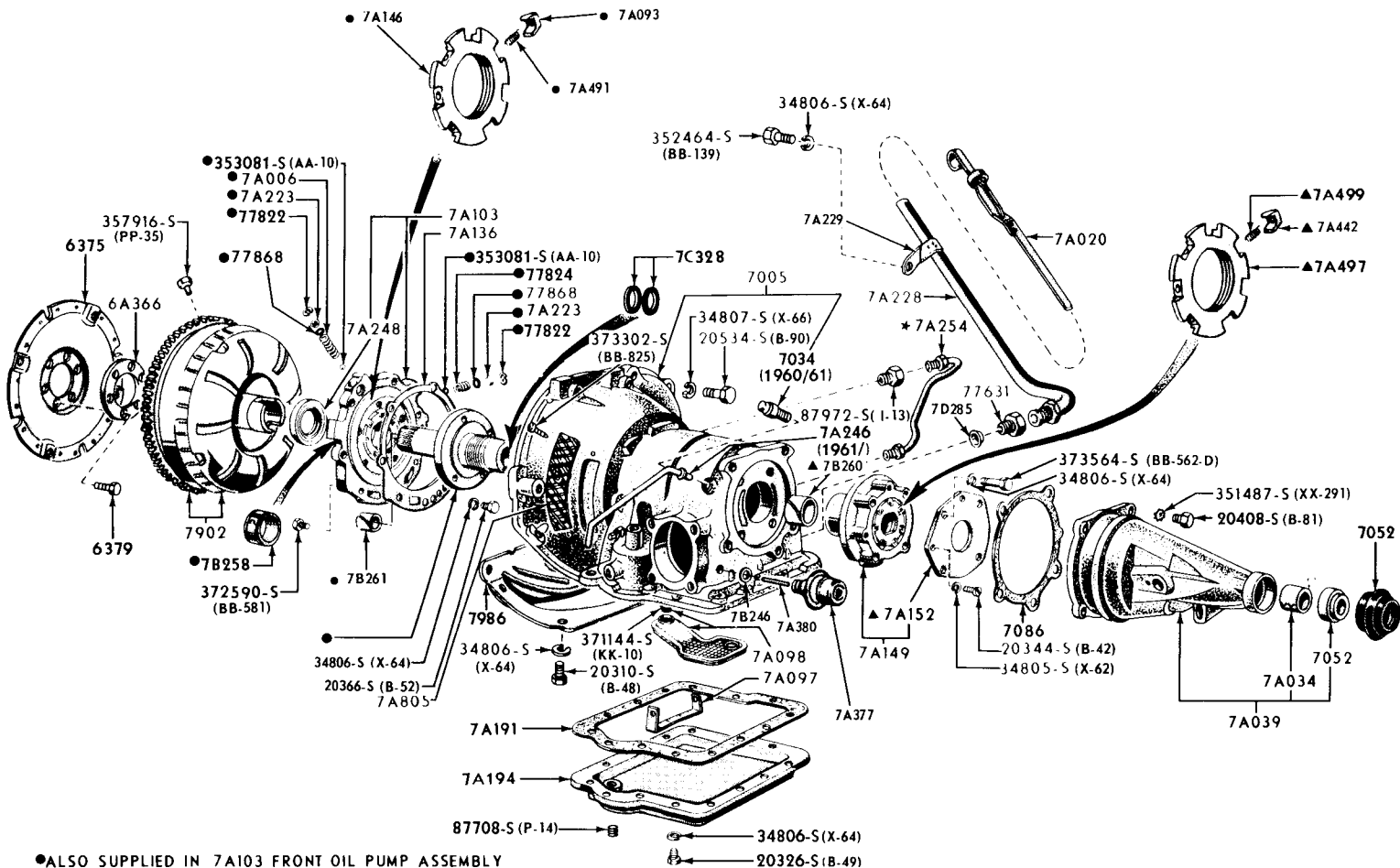

● ALSO SUPPLIED IN 7A103 FRONT OIL PUMP ASSEMBLY
 ▲ ALSO SUPPLIED IN 7A149 REAR OIL PUMP ASSEMBLY

1960/64 CASE, CONVERTER ASSY., EXTENSION, PUMPS & RELATED PARTS-FAIRLANE, FALCON-TYPICAL

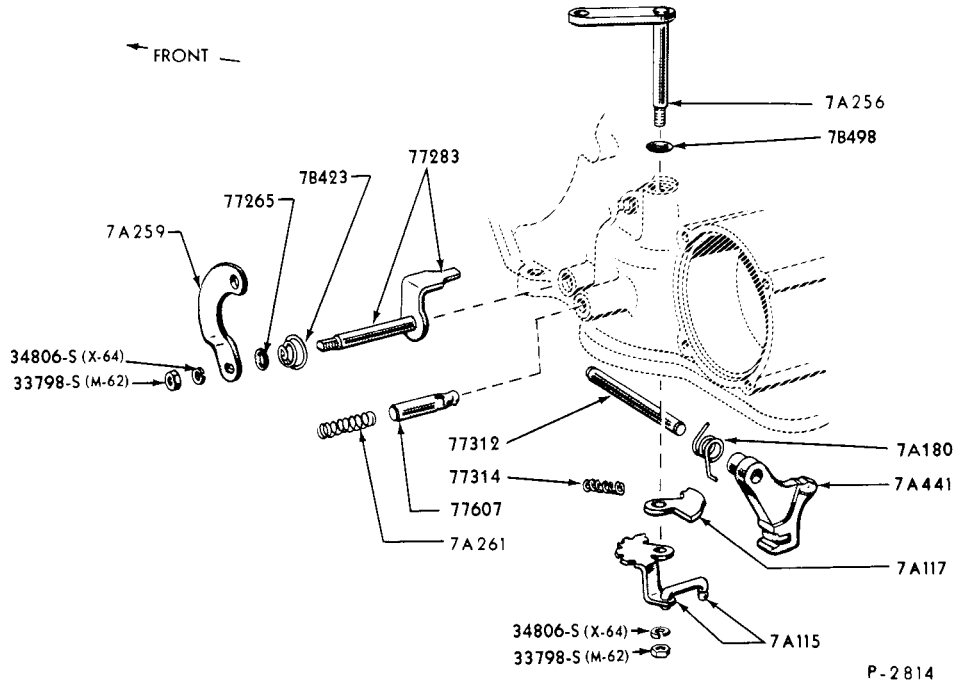

1960/64 PARKING PAWL, THROTTLE & MANUAL CONTROL LINKAGE-FORD, FAIRLANE, FALCON-TYPICAL

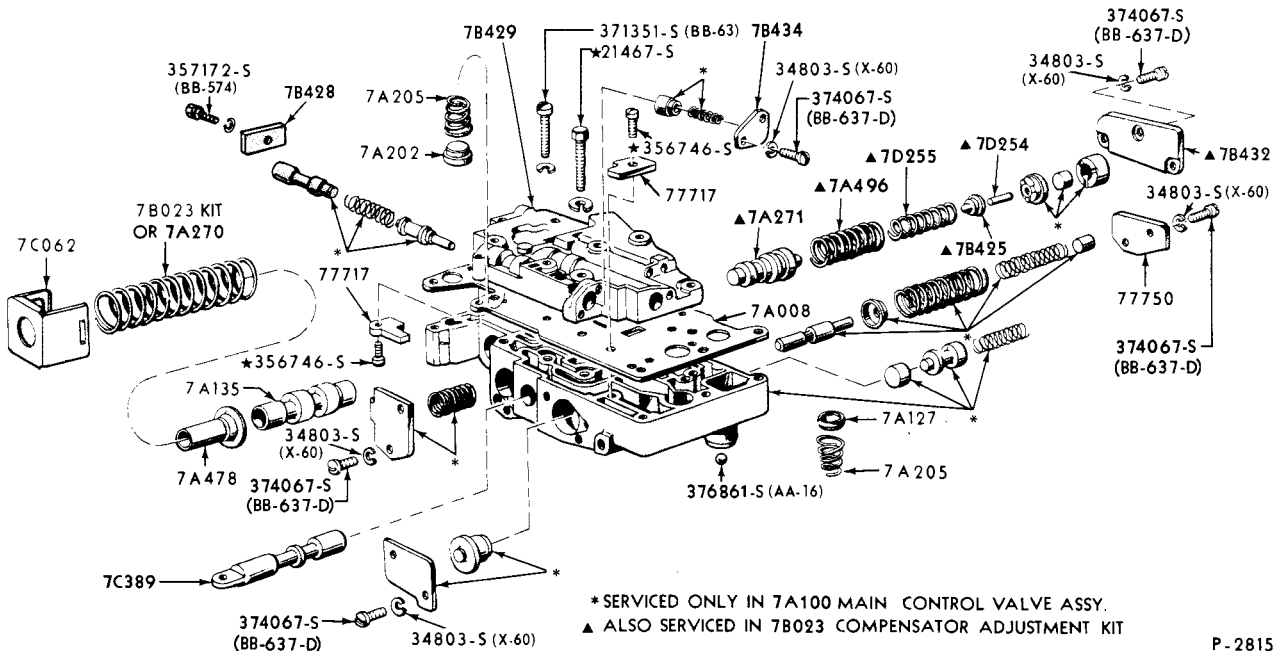

* SERVICED ONLY IN 7A100 MAIN CONTROL VALVE ASSY.
 ▲ ALSO SERVICED IN 7B023 COMPENSATOR ADJUSTMENT KIT

1960/64 MAIN CONTROL VALVE BODY ASSY. -(BASIC 7A100)-FORD, FAIRLANE, FALCON-TYPICAL

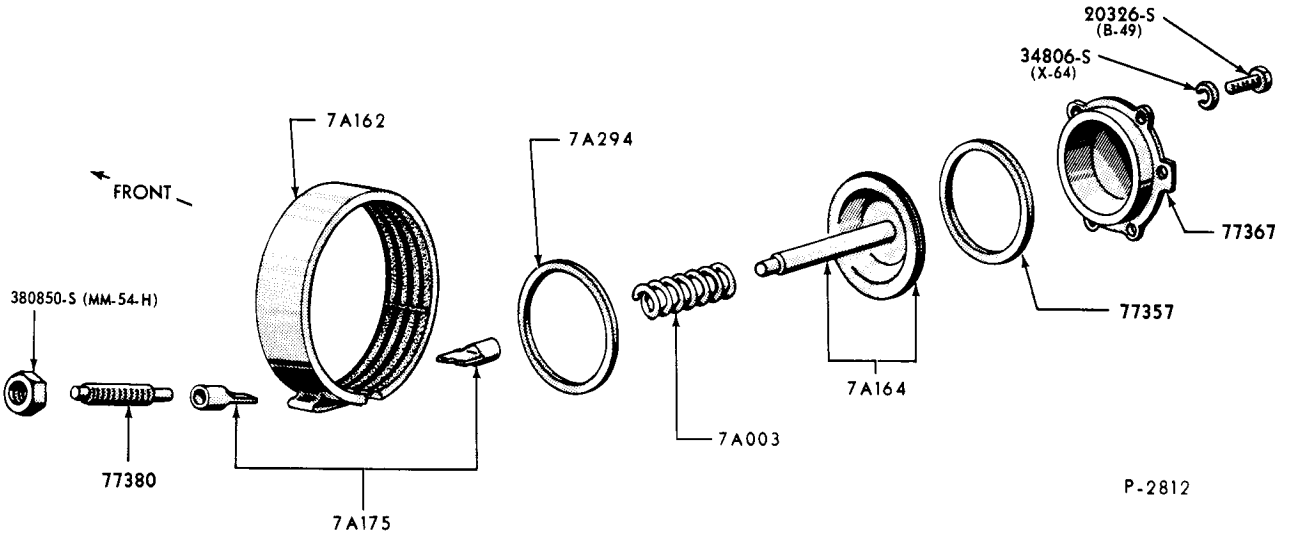

1960/64 REAR SERVO & BAND-FORD, FAIRLANE, FALCON-TYPICAL

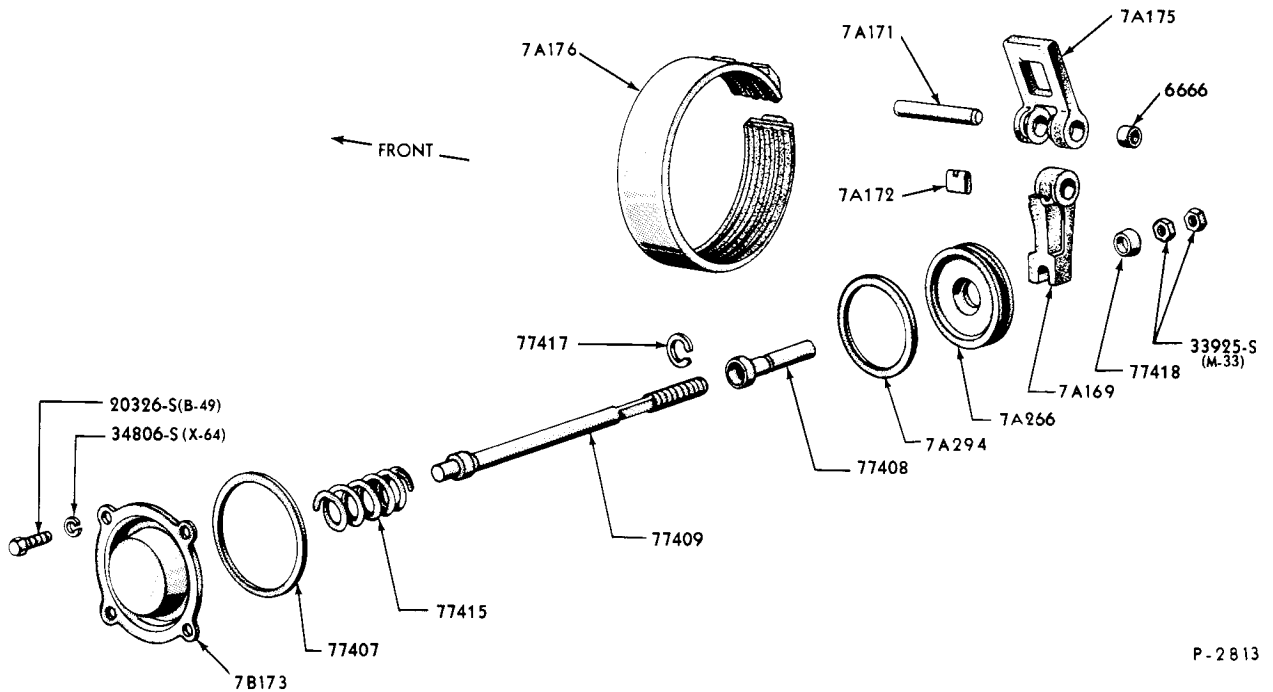

1960/64 FRONT SERVO & BAND-FORD, FAIRLANE, FALCON-TYPICAL

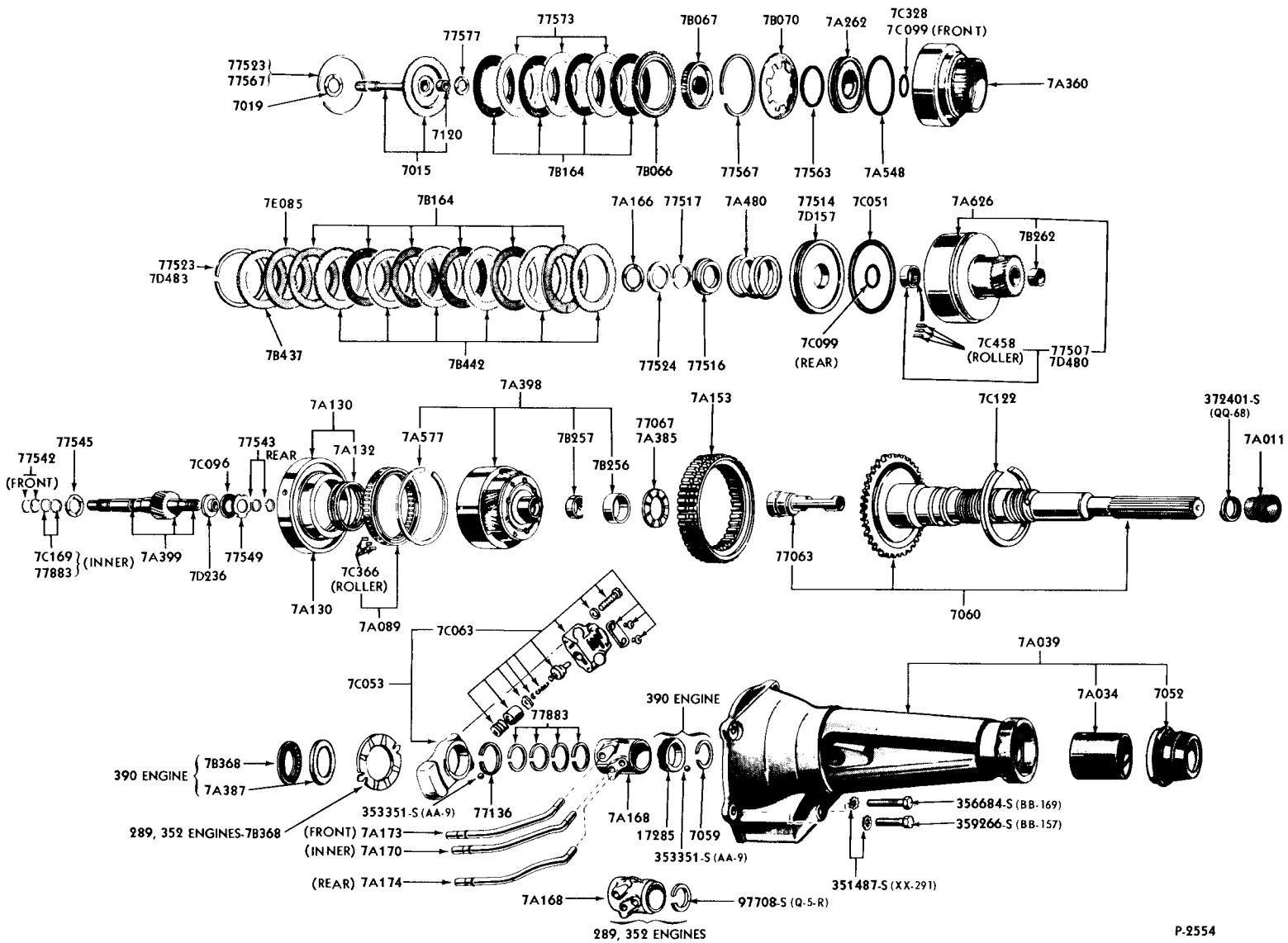

1960 / FX, MX MODELS CLUTCHES, GEARS, SHAFTS & RELATED PARTS-FORD, THUNDERBIRD-TYPICAL

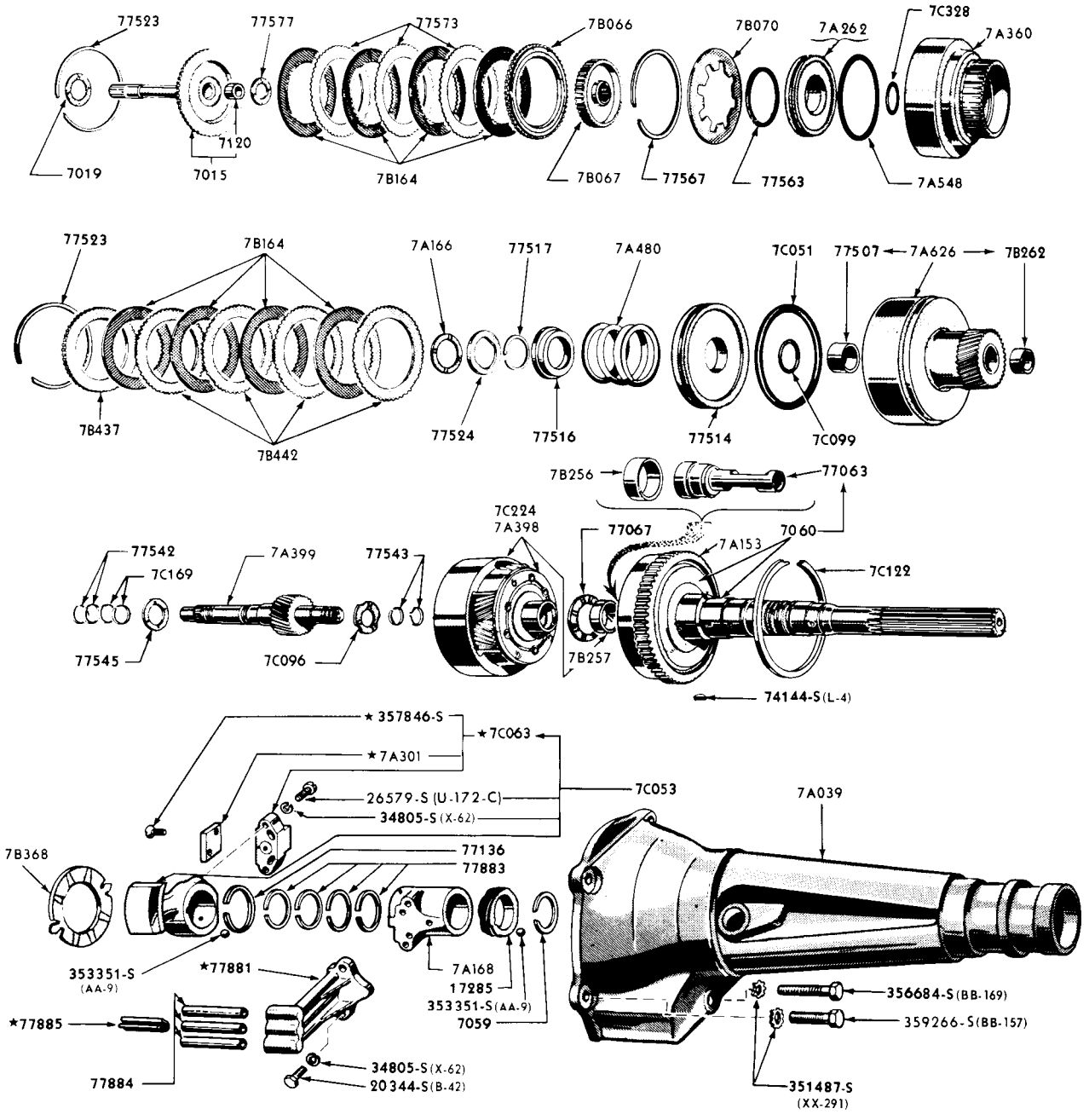

P-1886

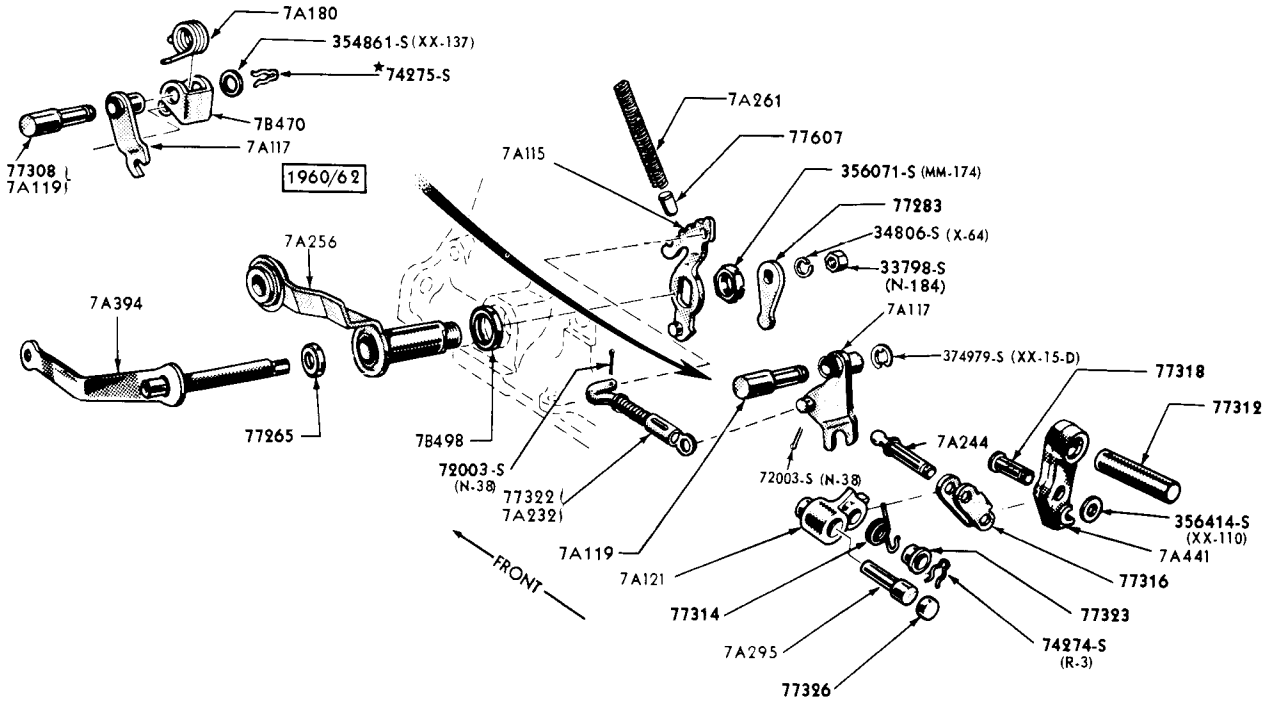

P5206

1960/ PARKING PAWL, THROTTLE & MANUAL CONTROL LINKAGE-FORD, THUNDERBIRD-TYPICAL

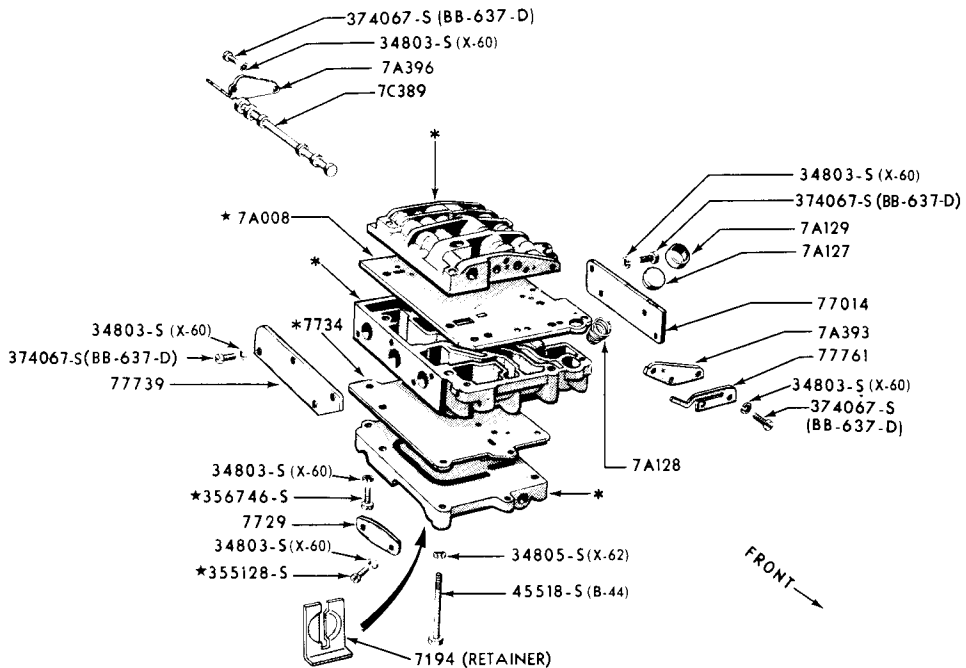

* SUPPLIED IN 7A100 CONTROL VALVE ASSY.

P-2583

1960/ MAIN CONTROL VALVE BODY ASSY. -(BASIC 7A100)-FORD, THUNDERBIRD-TYPICAL

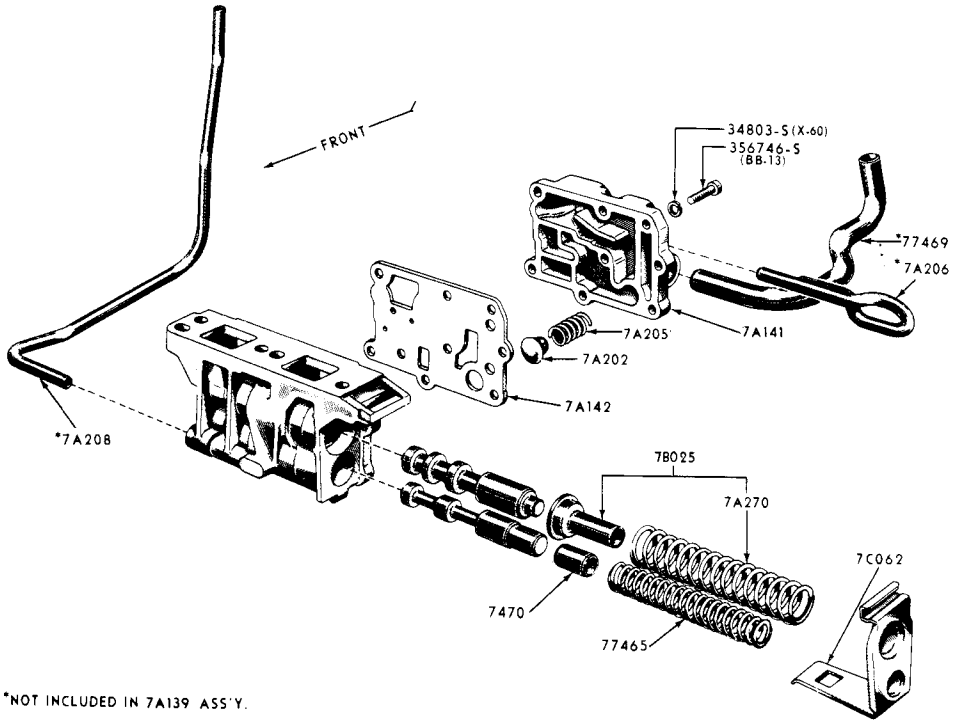

P-1725

1960/ OIL PRESSURE REGULATOR & RELATED PARTS-(BASIC 7A139)-FORD, THUNDERBIRD-TYPICAL

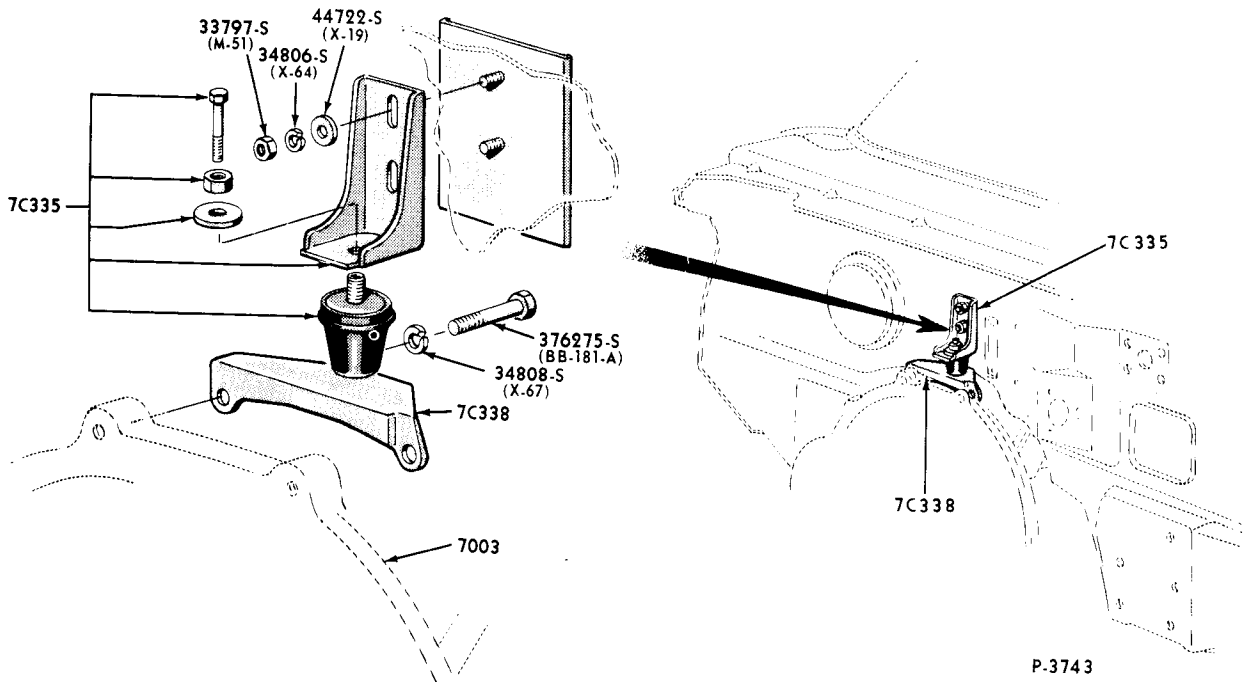

P-3743

1962 C/M TRANSMISSION DASH PANEL INSULATOR & BRACKET TO TRANSMISSION-THUNDERBIRD-TYPICAL

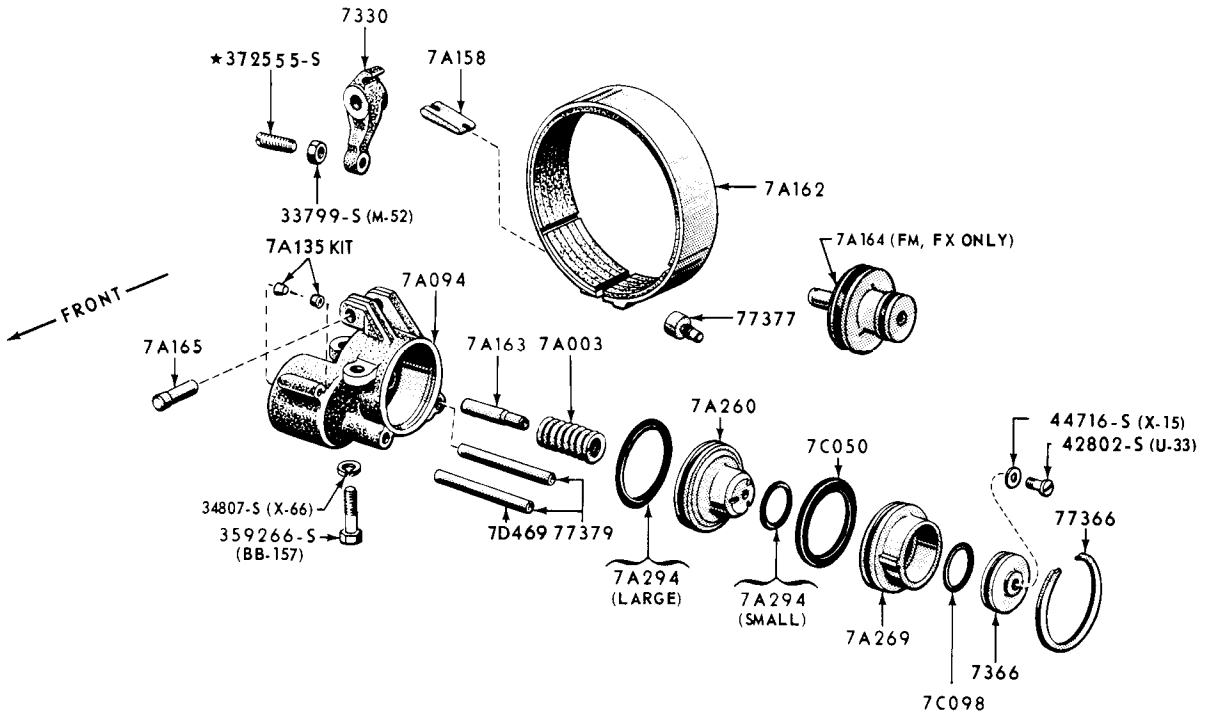

P-2561

1960/ FRONT SERVO & BAND-FORD, THUNDERBIRD-TYPICAL

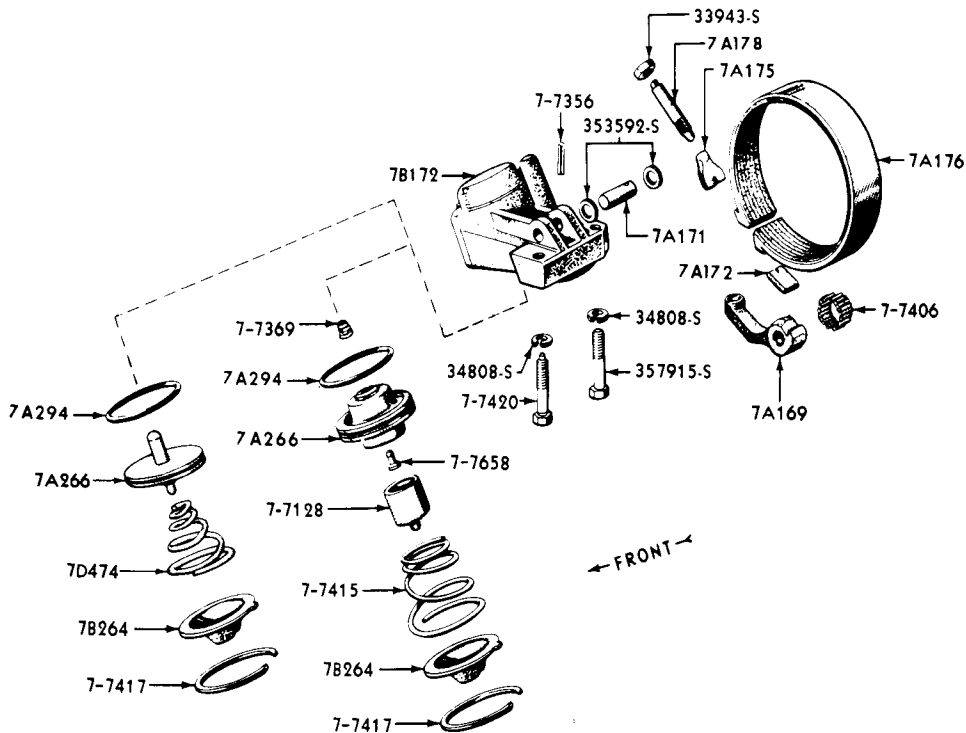

P-6547

1960/ REAR SERVO & BAND-FORD, THUNDERBIRD-TYPICAL

1964/ CASE, CONVERTER ASSY., EXTENSION, PUMP & RELATED PARTS-FORD, FAIRLANE-TYPICAL

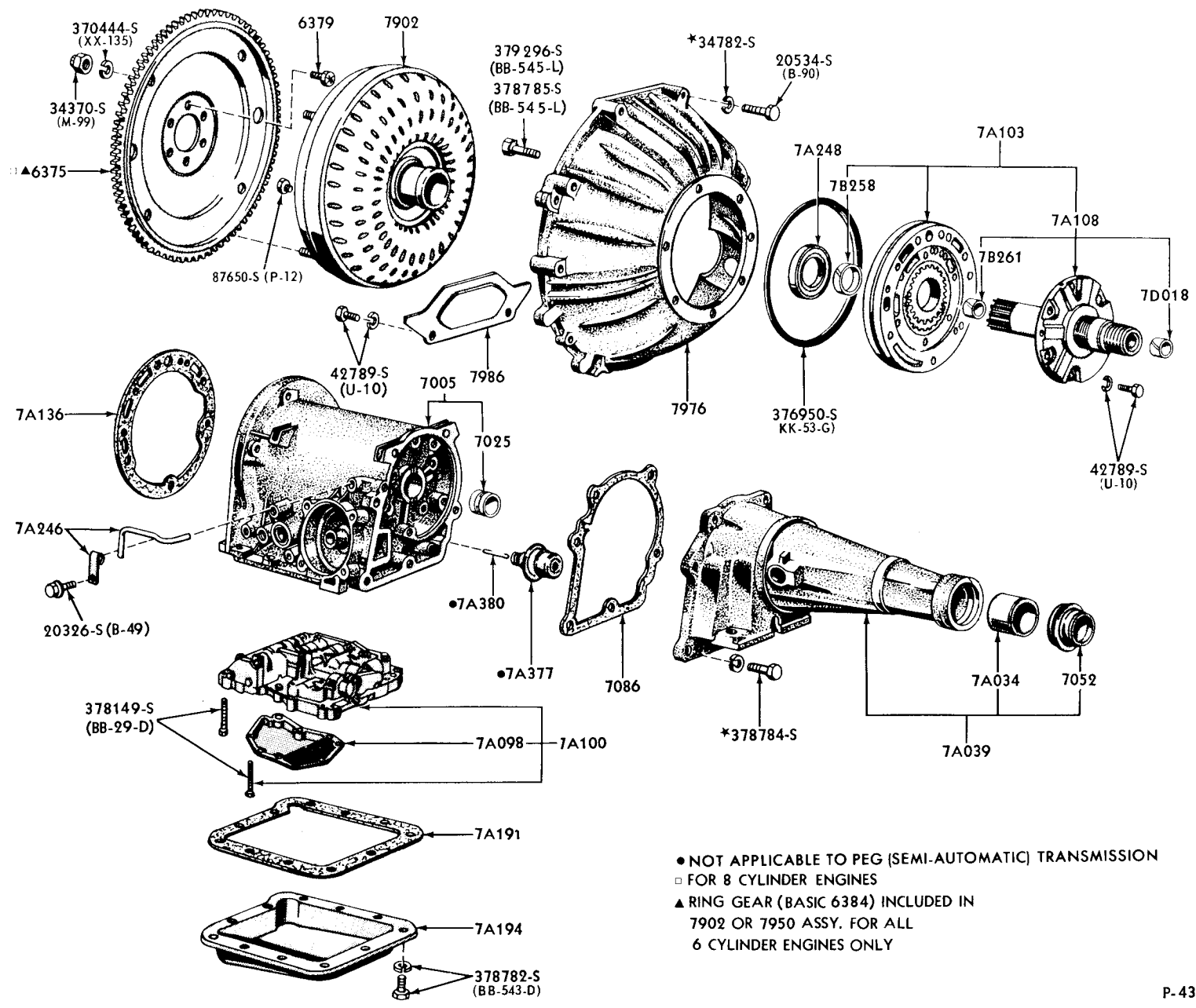

- NOT APPLICABLE TO PEG (SEMI-AUTOMATIC) TRANSMISSION
- FOR 8 CYLINDER ENGINES
- ▲ RING GEAR (BASIC 6384) INCLUDED IN 7902 OR 7950 ASSY. FOR ALL 6 CYLINDER ENGINES ONLY

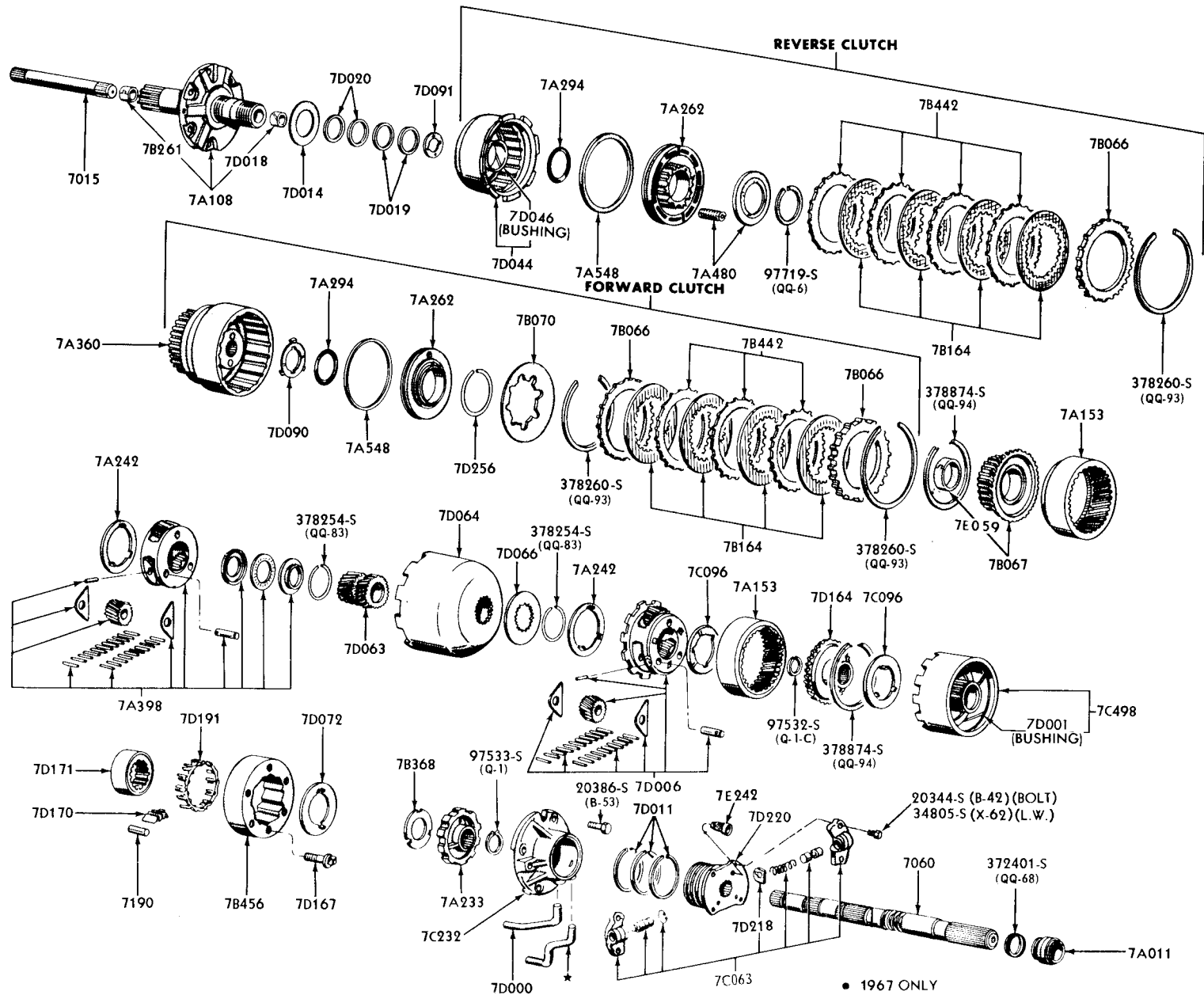

1964/ CLUTCHES, GEARS, SHAFTS, REAR SUPPORT & RELATED PARTS-FORD, FAIRLANE-TYPICAL

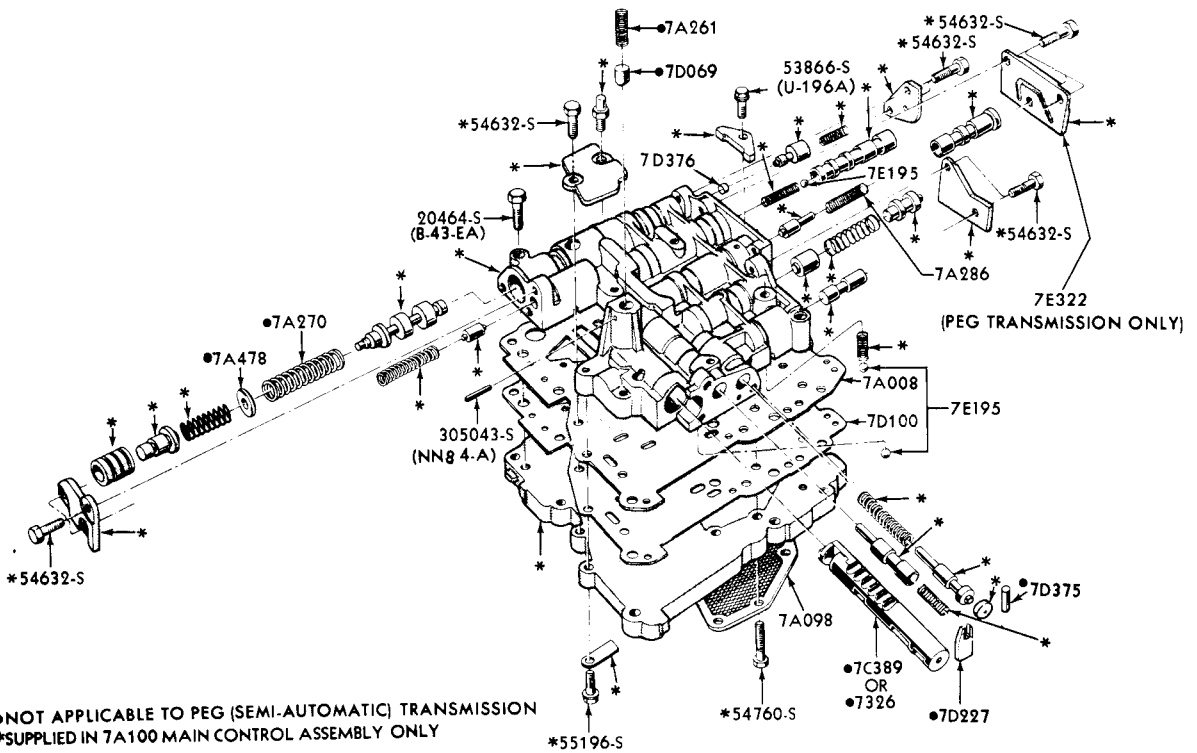

1964/ MAIN CONTROL VALVE BODY-(BASIC 7A100)-FORD, FAIRLANE-TYPICAL

P-4507

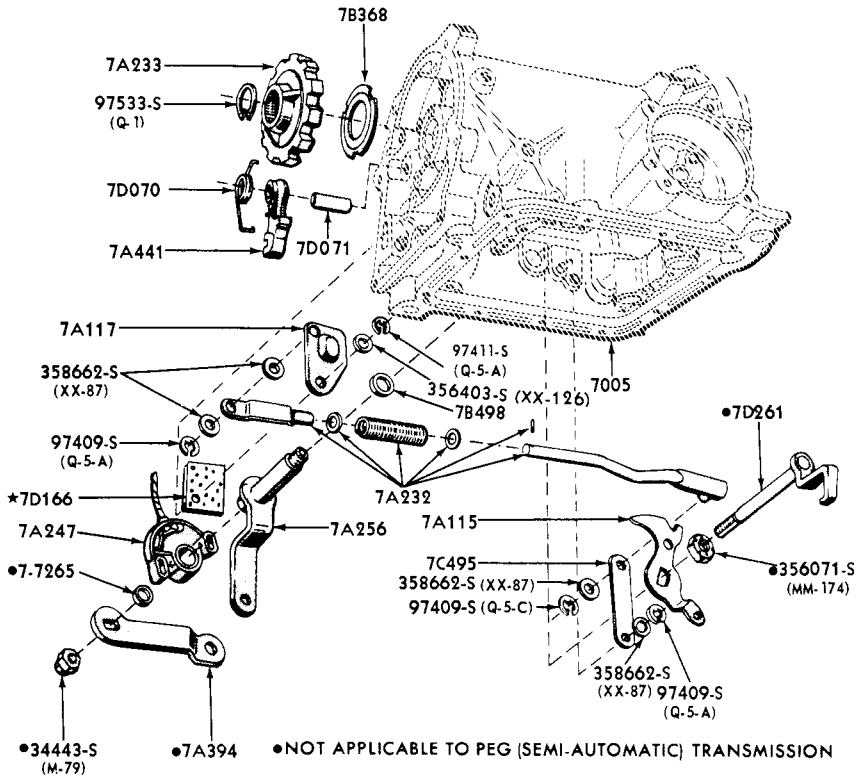

P-4330

1964/ PARKING PAWL, THROTTLE & MANUAL CONTROL LINKAGE-FORD, FAIRLANE-TYPICAL

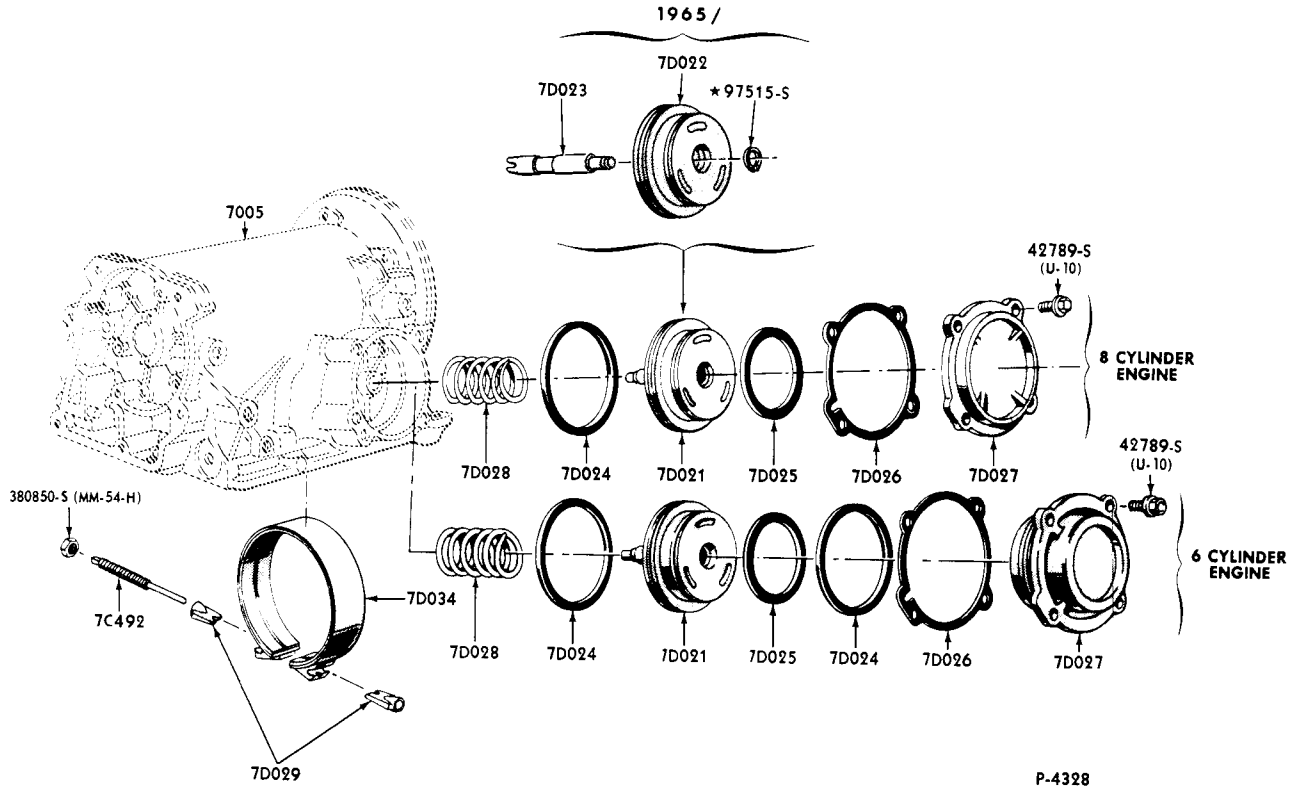

1964/ FRONT SERVO & BAND-FORD, FAIRLANE-TYPICAL

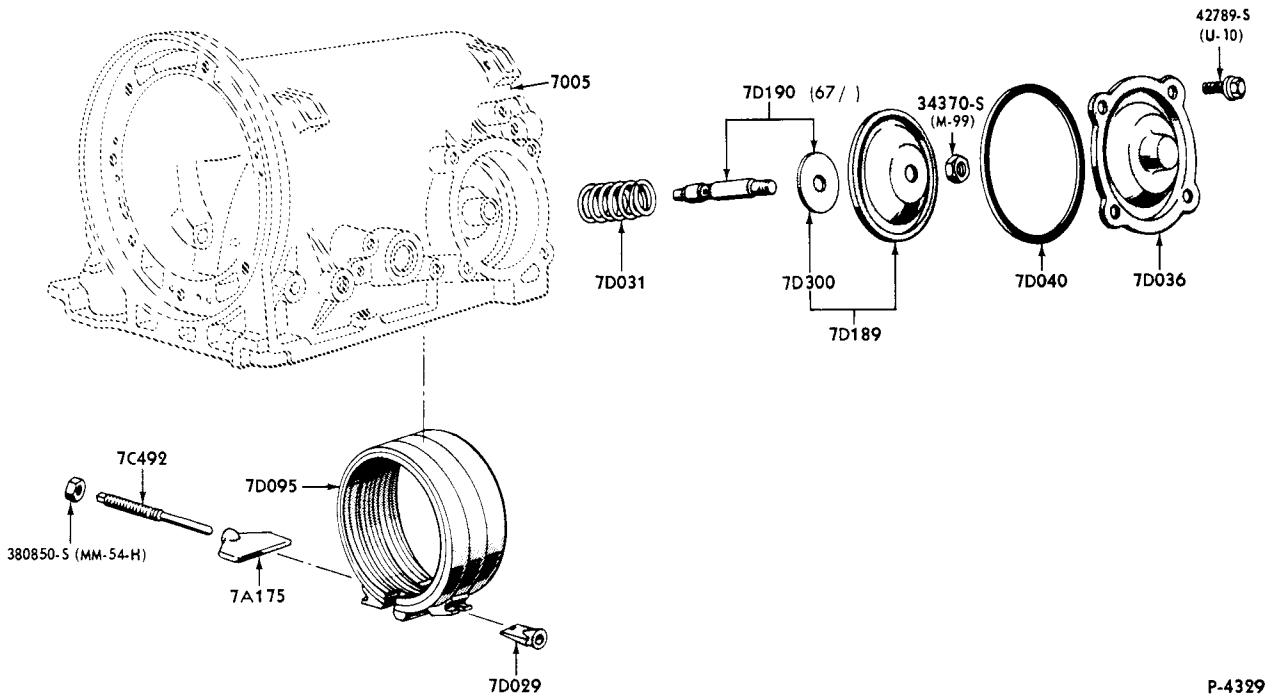

1964/ REAR SERVO & BAND-FORD, FAIRLANE-TYPICAL

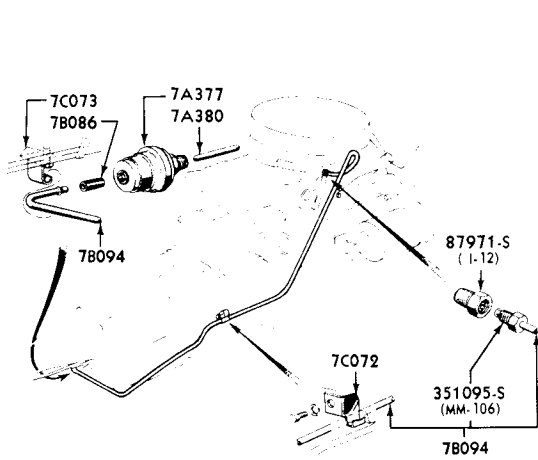

6 CYLINDER 144, 170 & 200 ENGINES

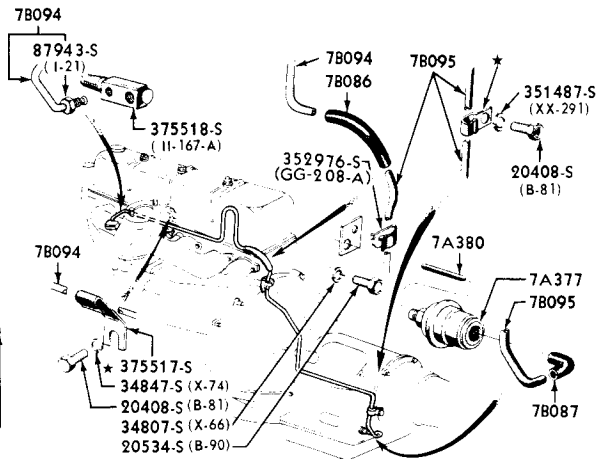

6 CYLINDER 223 & 240 ENGINES

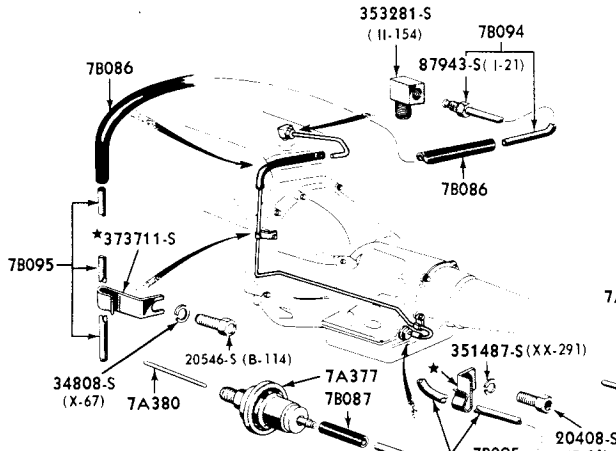

**8 CYLINDER 352, 390, 428 & 430 ENGINES
WITH C/M & C6 TRANSMISSIONS**

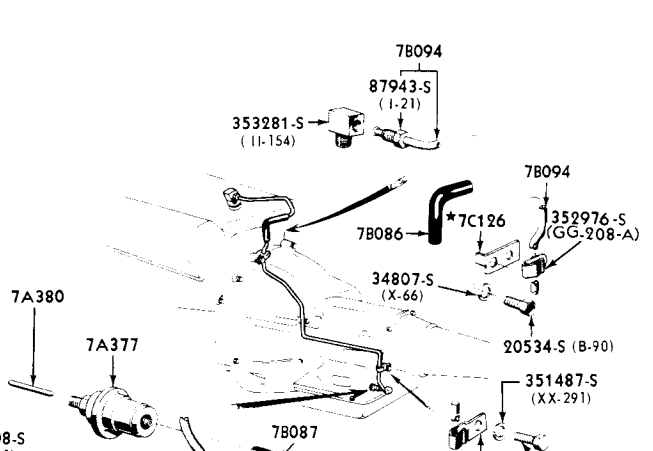

8 CYLINDER 352 ENGINE WITH F/M/2 TRANSMISSION

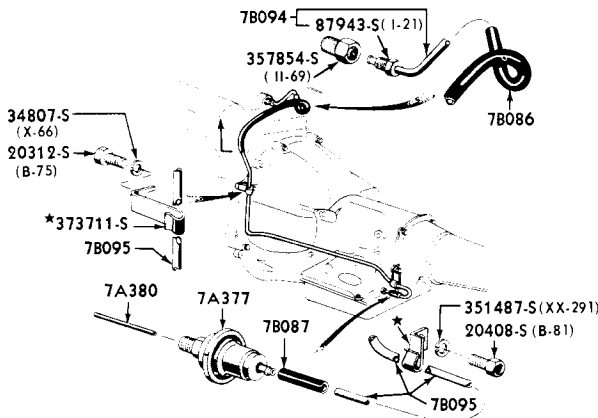

**8 CYLINDER 260, 289, 292 & 302 ENGINES
WITH C/M & C4 TRANSMISSIONS**

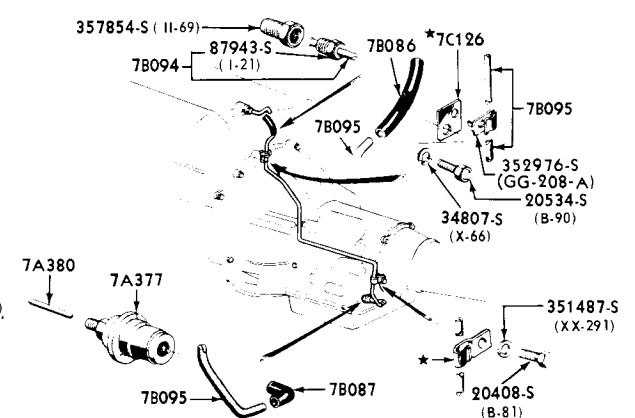

8 CYLINDER 292 ENGINE WITH F/M/2 TRANSMISSION

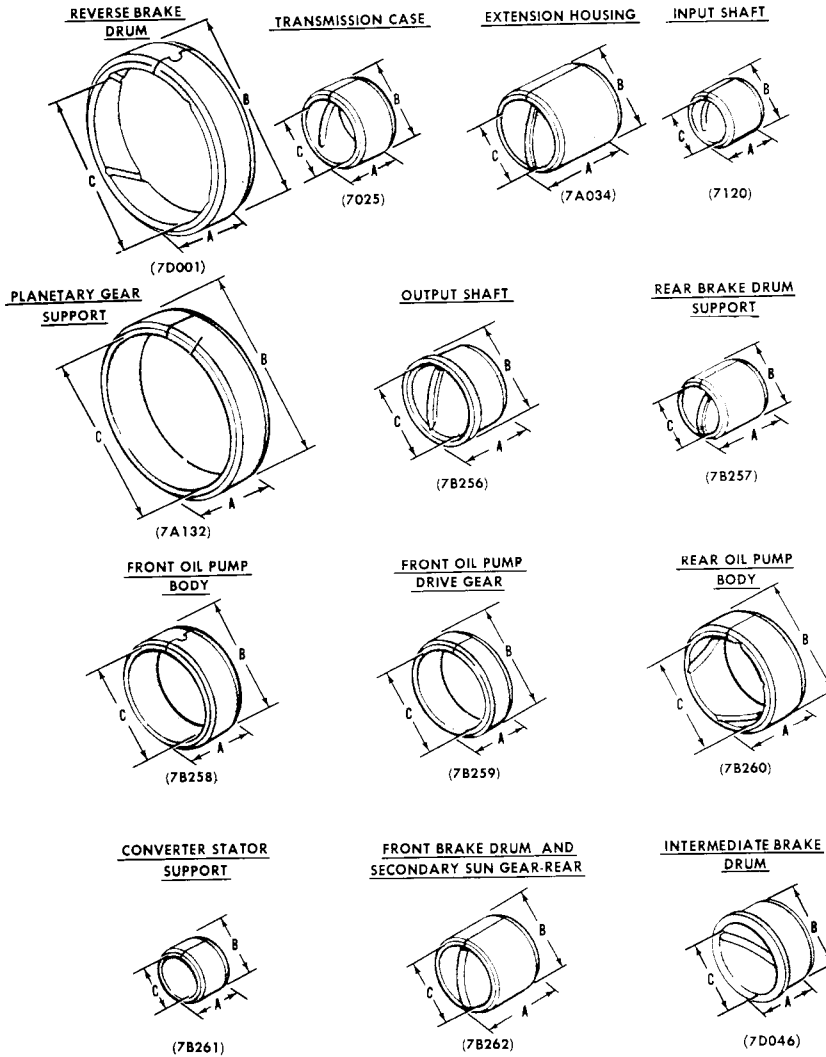

P.4862

BUSHINGS - AUTOMATIC TRANSMISSION MISCELLANEOUS

A	B	C	PART NUMBER	A	B	C	PART NUMBER
3/4"	1 1/2"	1 3/8"	• B1A 7025-A	1"	1 3/4"	1 5/8"	★COMP 7B256-A
3/4"	1 1/2"	1 3/8"	• B1A 7025-B	3/4"	1 1/8"	1"	B1AZ 7B257-B
7/8"	1 1/2"	1 3/8"	B5A 7025-A	1"	1 1/8"	1"	B5AZ 7B257-A
7/8"	1 5/8"	1 1/2"	COMP 7025-A	29/32"	2 1/2"	2 3/8"	C0AP 7B257-A
1 1/2"	1 5/8"	1 1/2"	B3TZ 7A034-A	15/16"	1 1/4"	1 1/8"	★COMP 7B257-A
2 1/8"	1 13/16"	1 11/16"	B5AZ 7A034-A	33/64"	2 1/8"	2"	C0AP 7B258-A
1 3/8"	1 1/2"	1 3/8"	C0DP 7A034-B	37/64"	2 1/16"	1 15/16"	C1AZ 7B258-A
3/4"	1"	7/8"	B1AZ 7120-A	7/16"	1 15/16"	1 13/16"	COMP 7B259-A
27/32"	1"	7/8"	★B5A 7120-B	3/8"	1 15/16"	1 13/16"	C1AZ 7B259-A
27/32"	1 1/8"	1"	★COMP 7120-A	3/4"	2 3/16"	2 1/16"	B5AZ 7B260-A
27/32"	1"	7/8"	C3AZ 7120-B	7/8"	2"	1 7/8"	C0AP 7B260-A
5/8"	3 3/8"	3 3/16"	B1AZ 7A132-A	13/16"	2 5/16"	2 3/16"	C3SZ 7B260-B
11/16"	3 5/16"	3 5/32"	B9AP 7A132-A	3/4"	1 1/32"	29/32"	★B1AZ 7B261-A
23/32"	3 27/32"	3 11/16"	B9MP 7A132-A	9/16"	1"	1 5/16"	B5AZ 7B261-A
11/16"	3 5/16"	3 5/32"	•C3AZ 7A132-A	1"	1 3/16"	1 3/4"	C0AP 7B261-A
11/16"	3 5/16"	3 5/32"	•C4AZ 7A132-A	9/16"	1 1/16"	1"	★COMP 7B261-A
7/8"	1 5/8"	1 1/2"	B5AZ 7B256-A	1 1/16"	1 7/16"	1 5/16"	B5AZ 7B262-A
3/8"	1 1/8"	1"	C0AP 7B256-A	1 1/8"	1 11/16"	1 9/16"	COMP 7B262-A

• RECONDITIONERS ONLY

• DEALER INSTALLATION

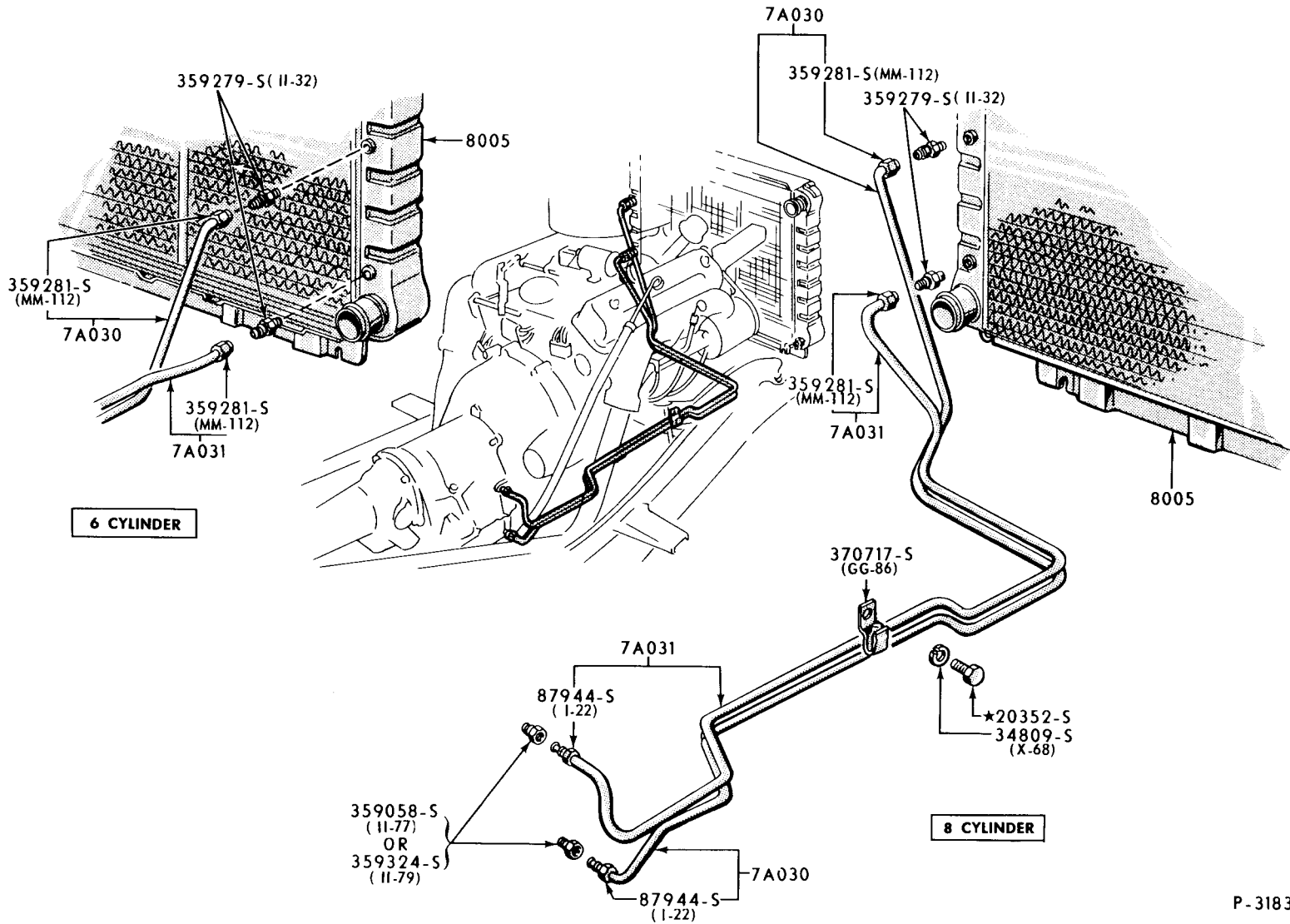

1960/63 TRANSMISSION OIL COOLING SYSTEM-FORD-TYPICAL

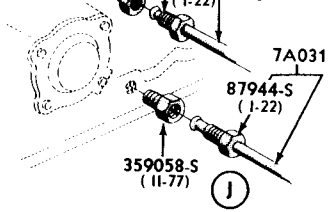
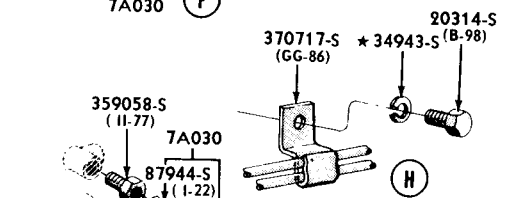
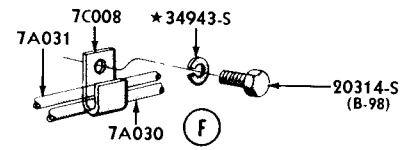
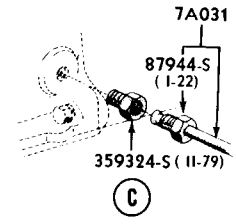
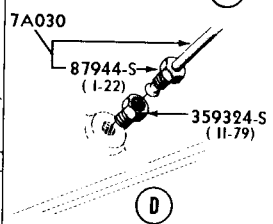
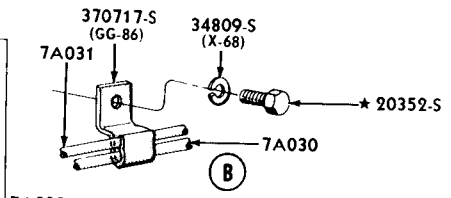
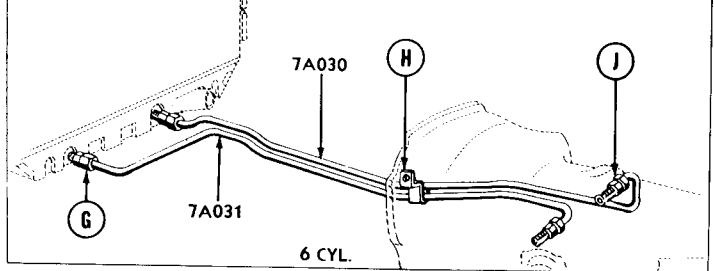
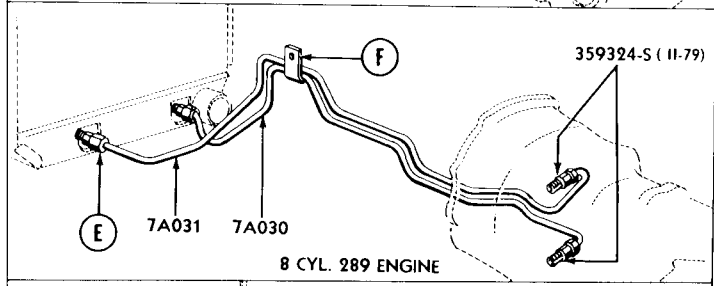
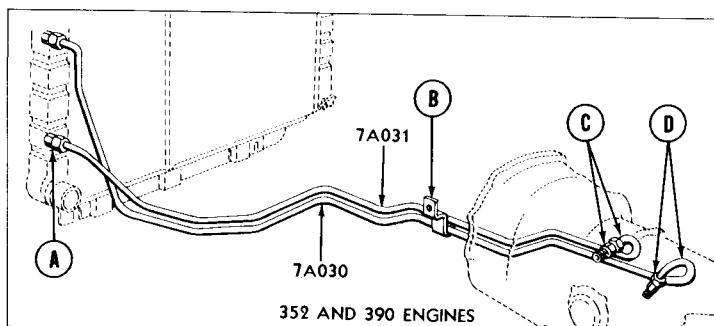
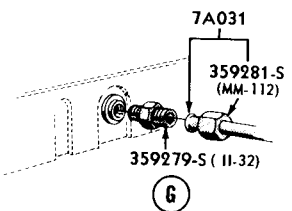
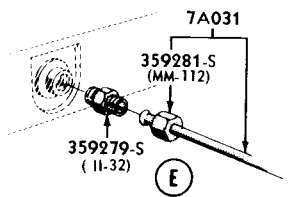
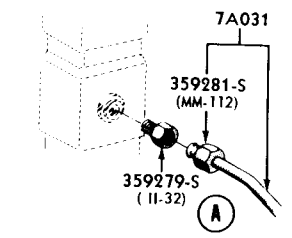

P-4244

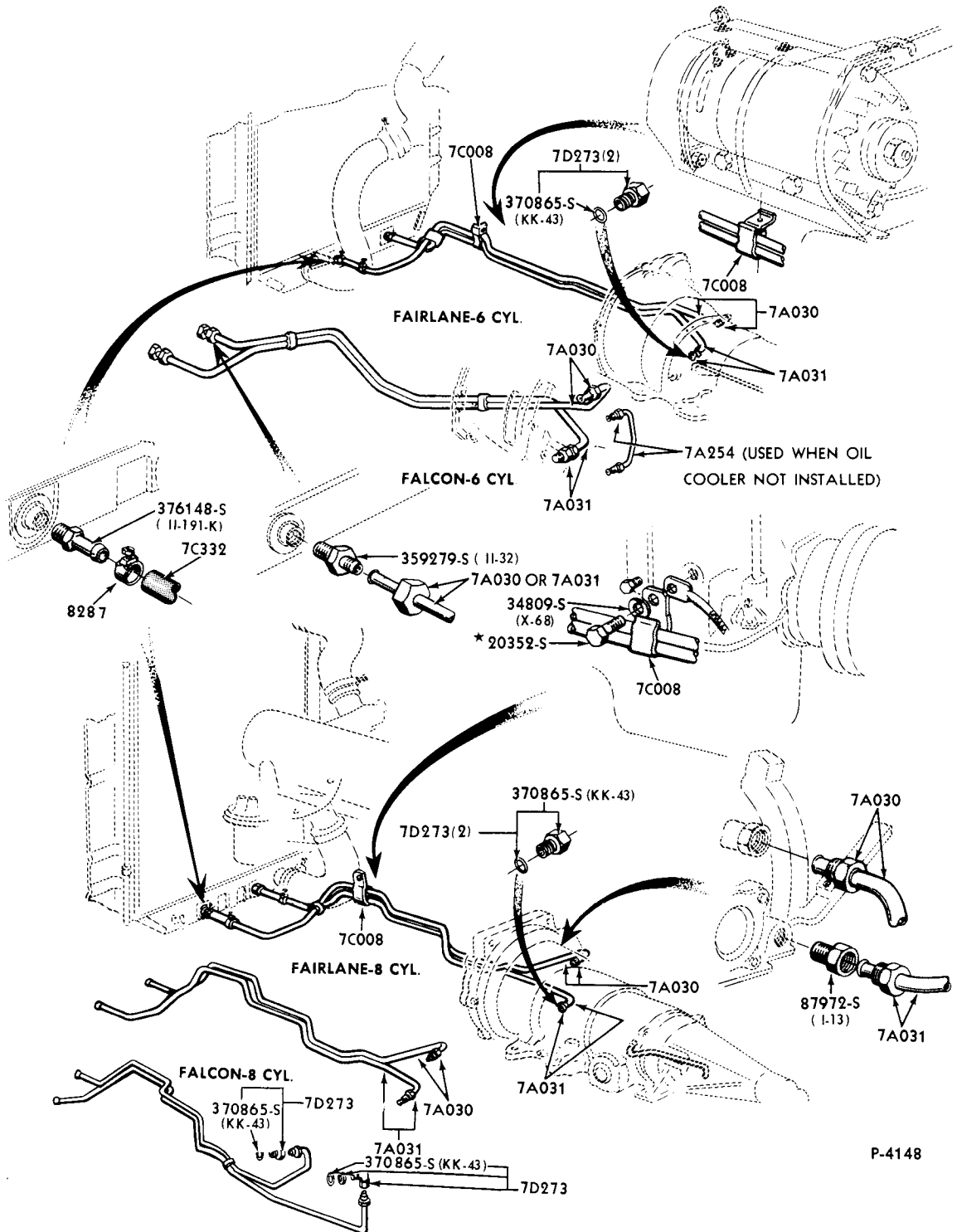

FALCON - 8 CYL., MUSTANG - 6 & 8 CYL. WITH C-4 DUAL RANGE TRANS.

P-4148

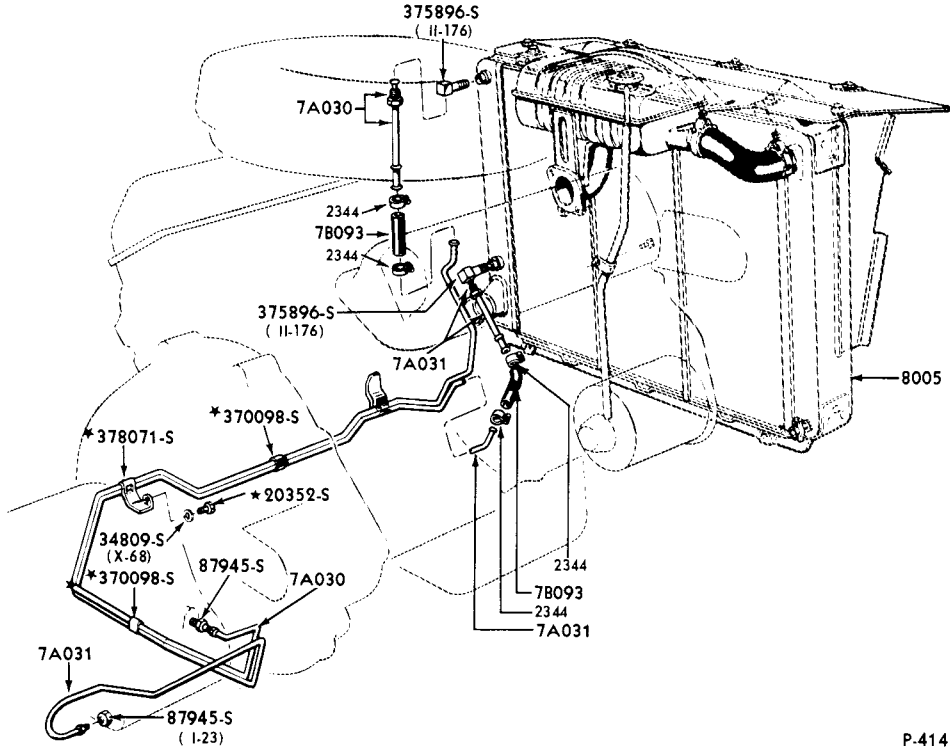

P.4145

1962/ TRANSMISSION OIL COOLING SYSTEM-THUNDERBIRD WITH MX TRANSMISSION-TYPICAL

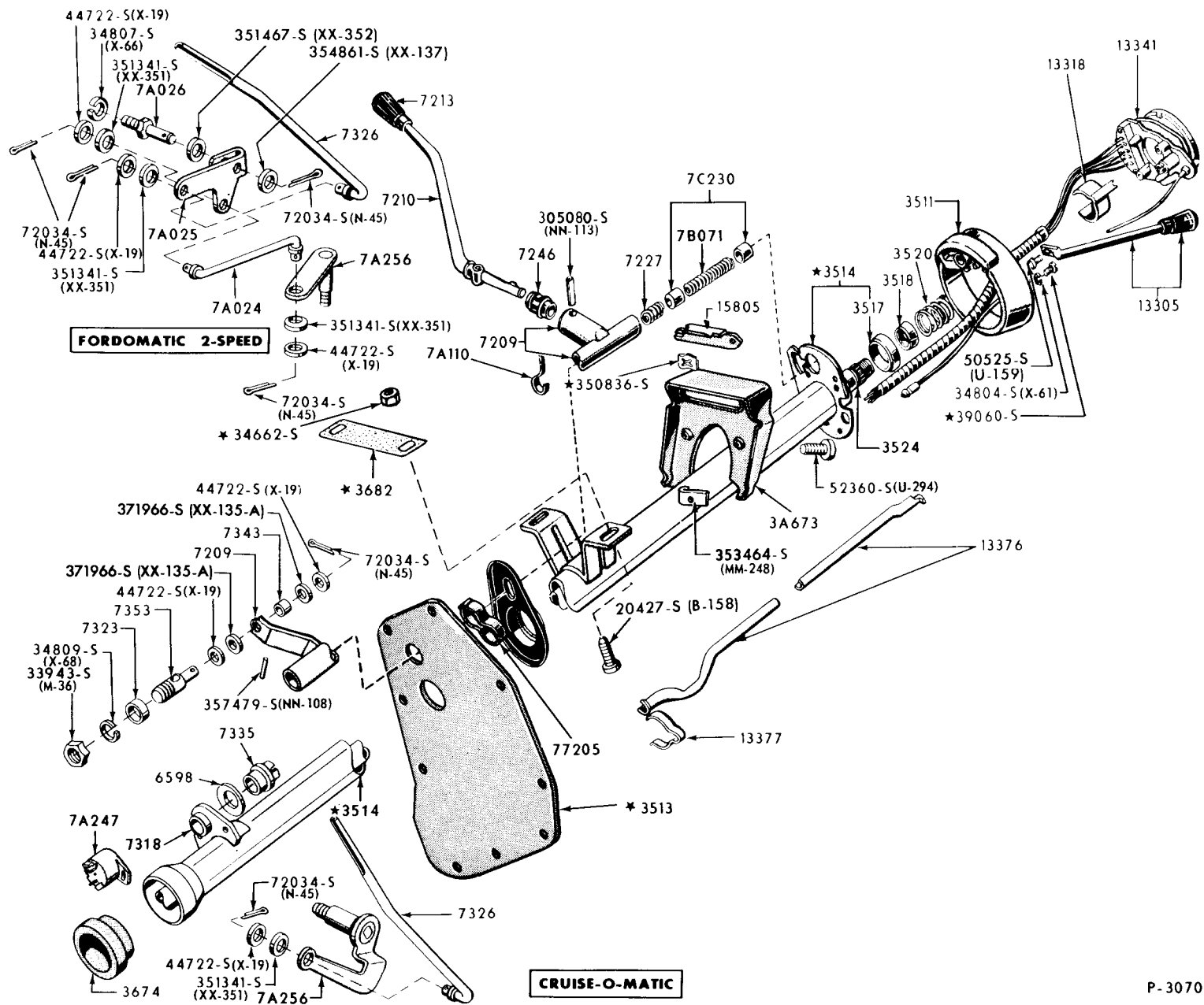

FORDOMATIC 2-SPEED

CRUISE-O-MATIC

1960 STEERING COLUMN & SHIFT CONTROL SELECTOR MECHANISM-FORD-TYPICAL

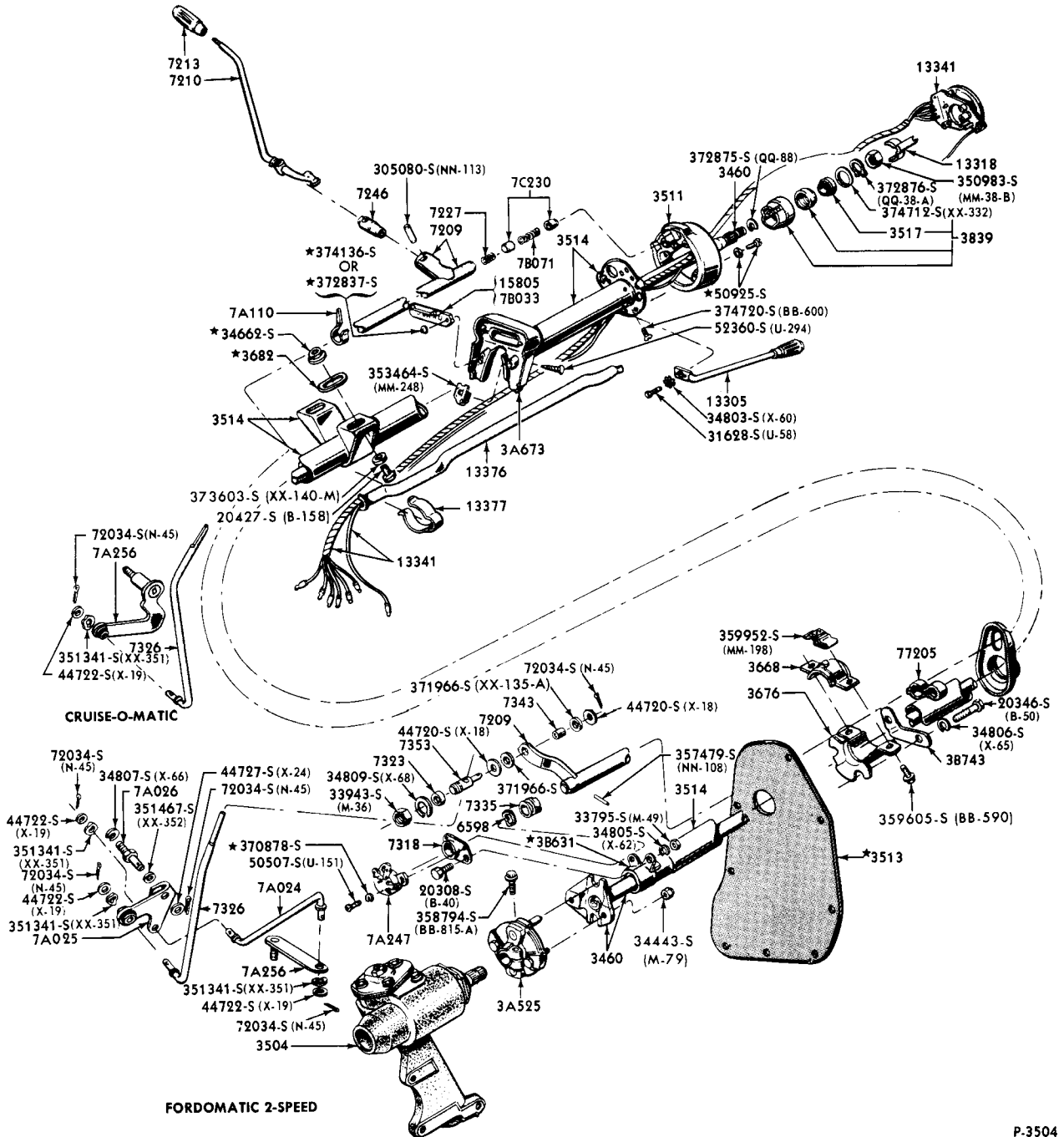

P-3504

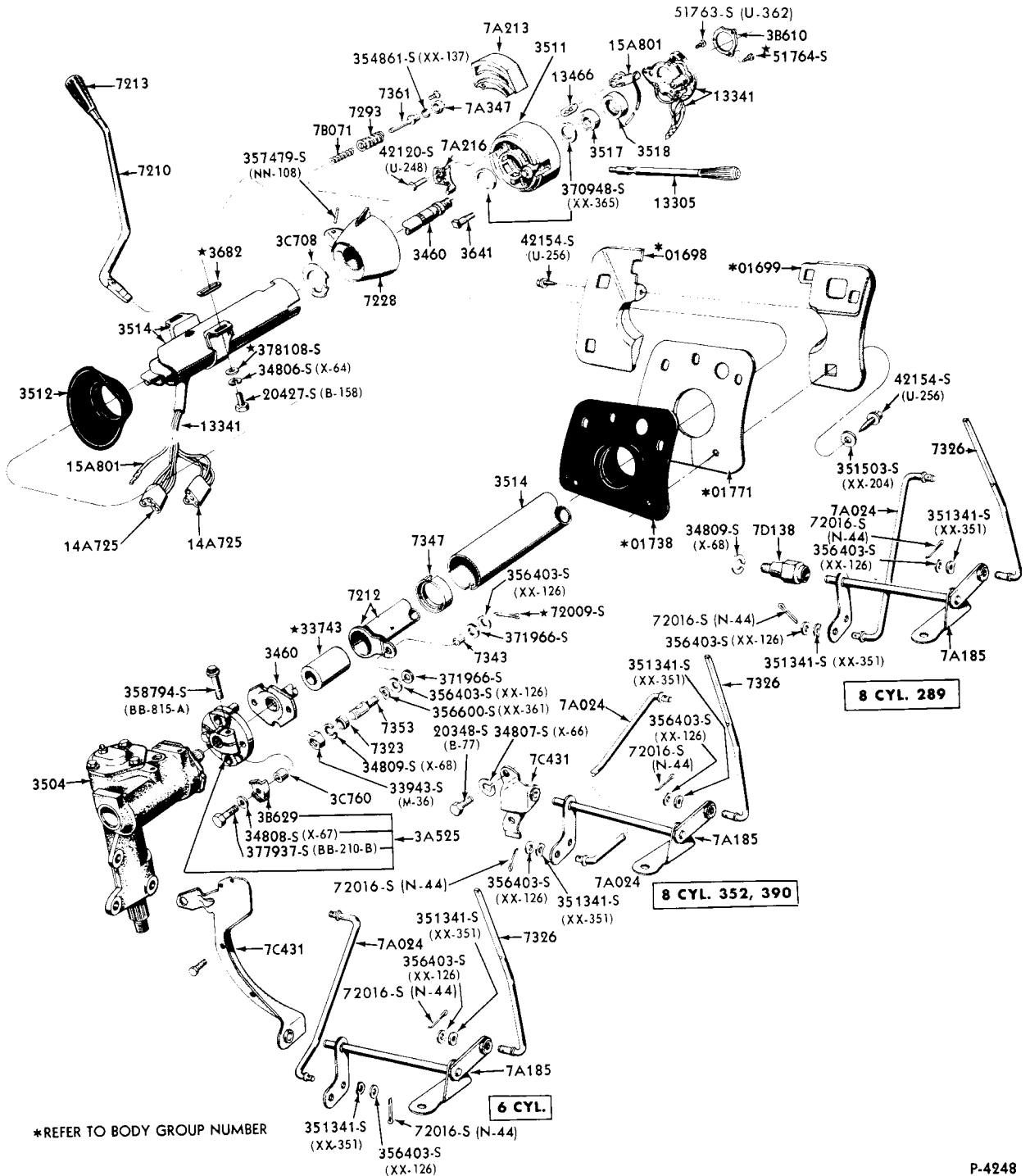

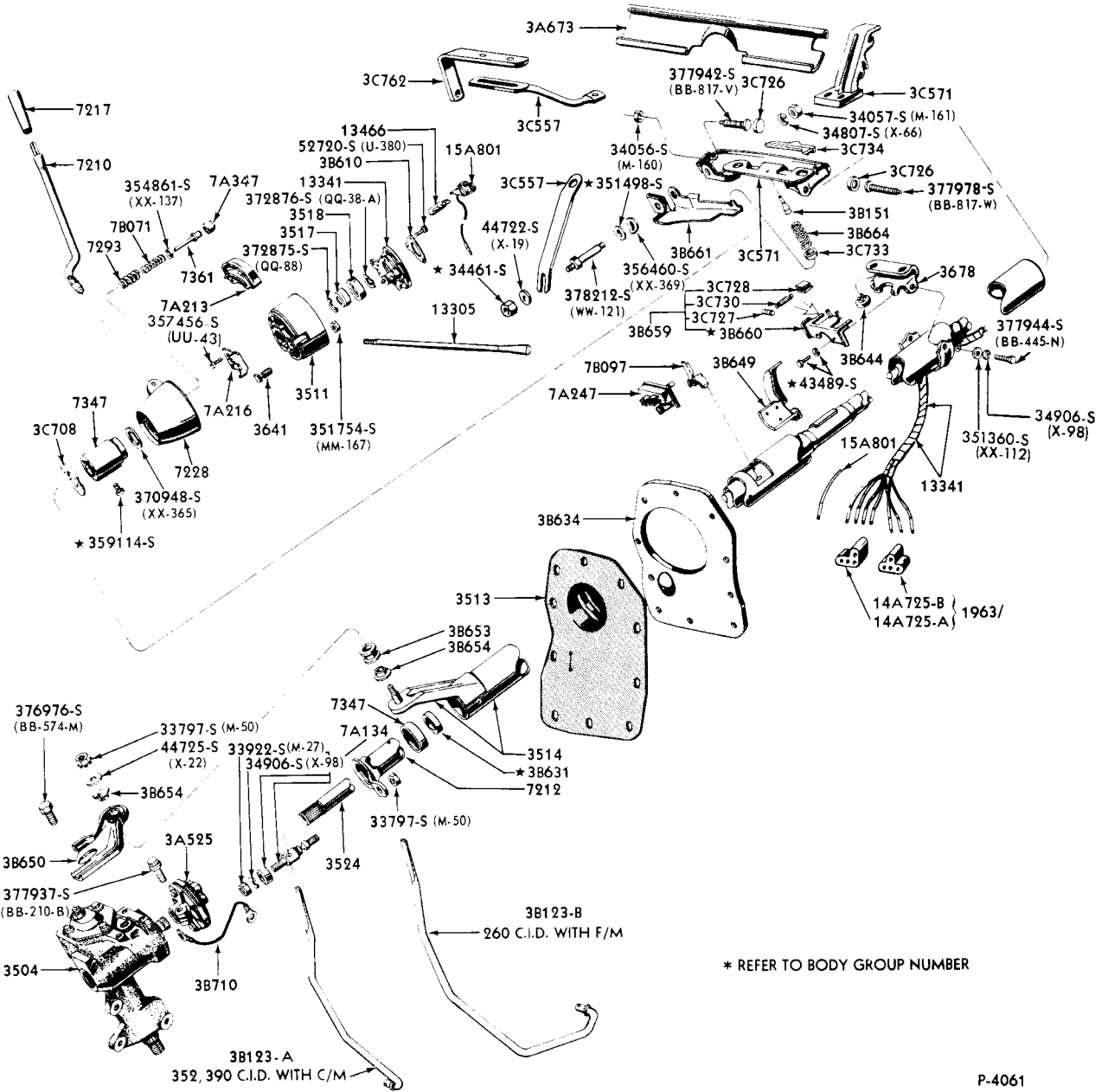

P-4061

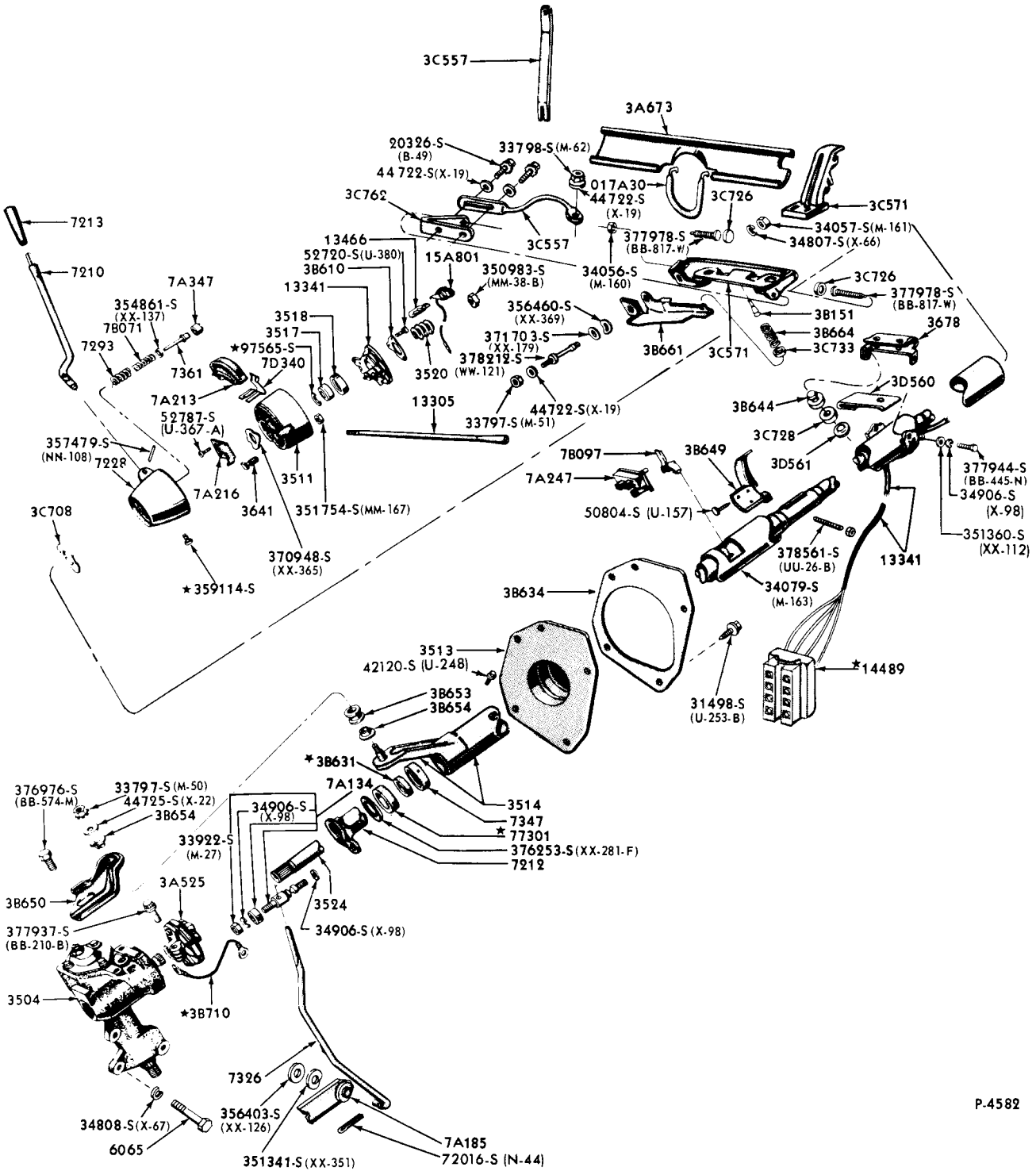

1964 MOVABLE STEERING COLUMN & SHIFT CONTROL SELECTOR MECHANISM-FORD-TYPICAL

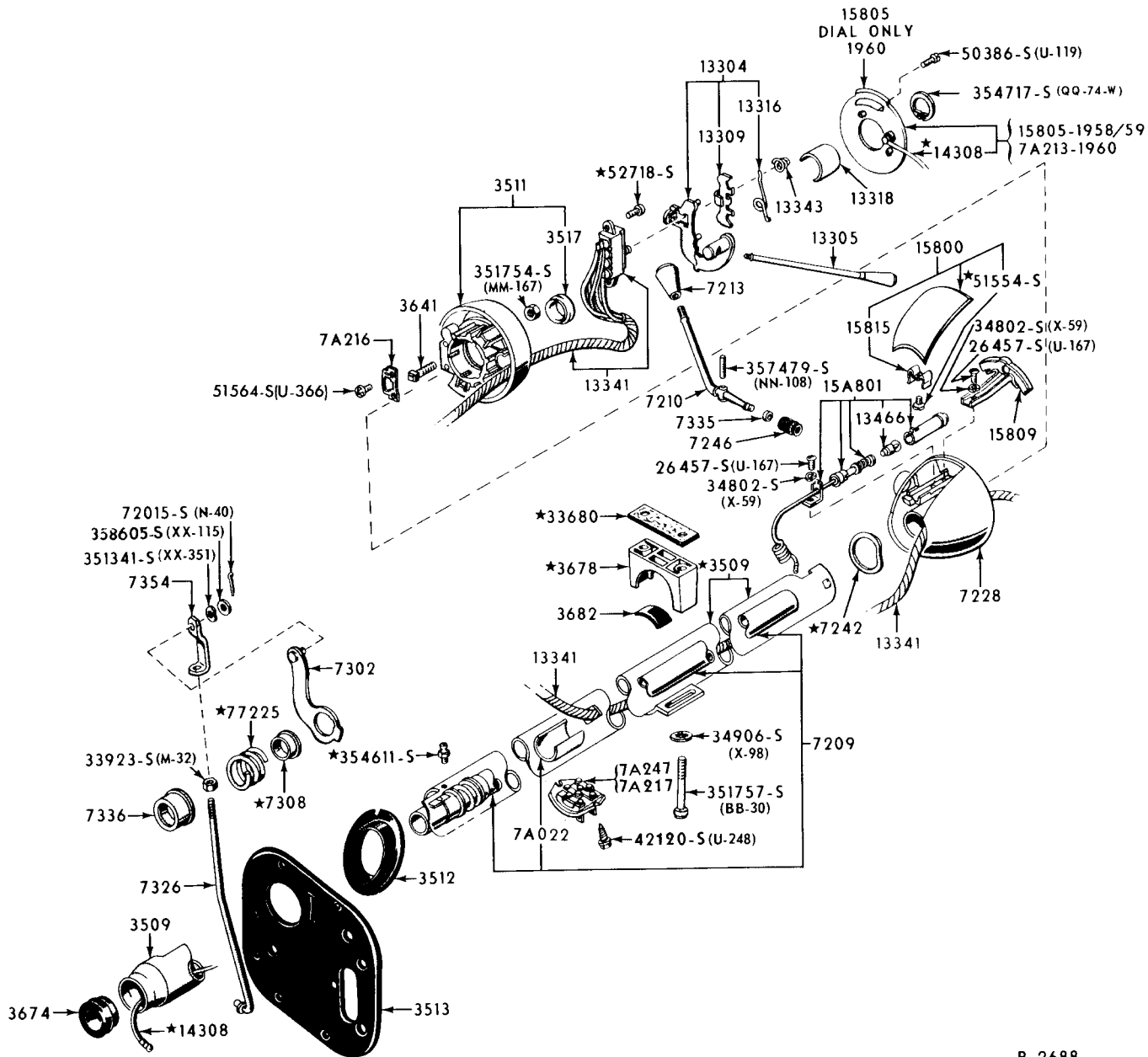

1964 / MOVABLE STEERING COLUMN & SHIFT CONTROL SELECTOR MECHANISM-THUNDERBIRD-TYPICAL

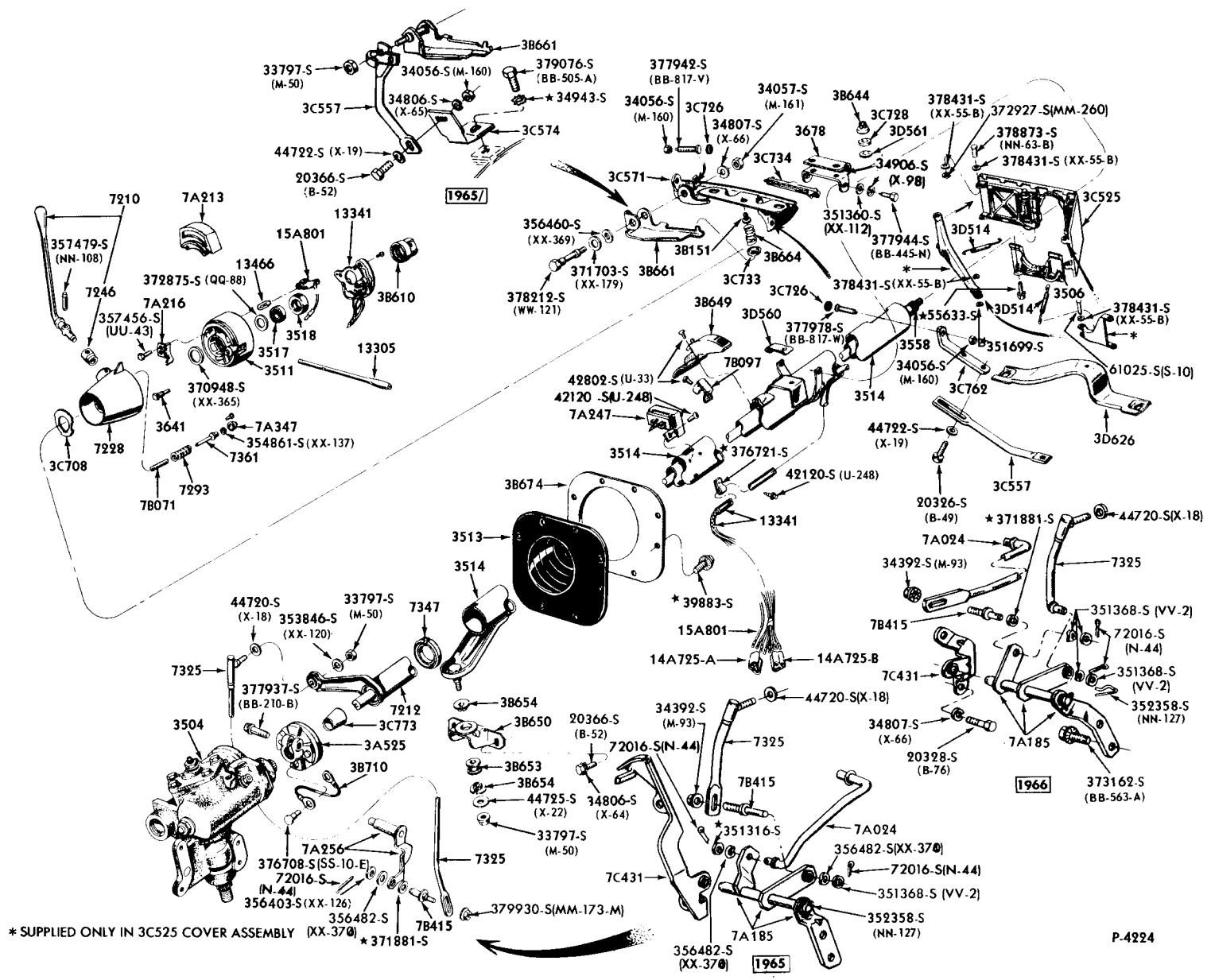

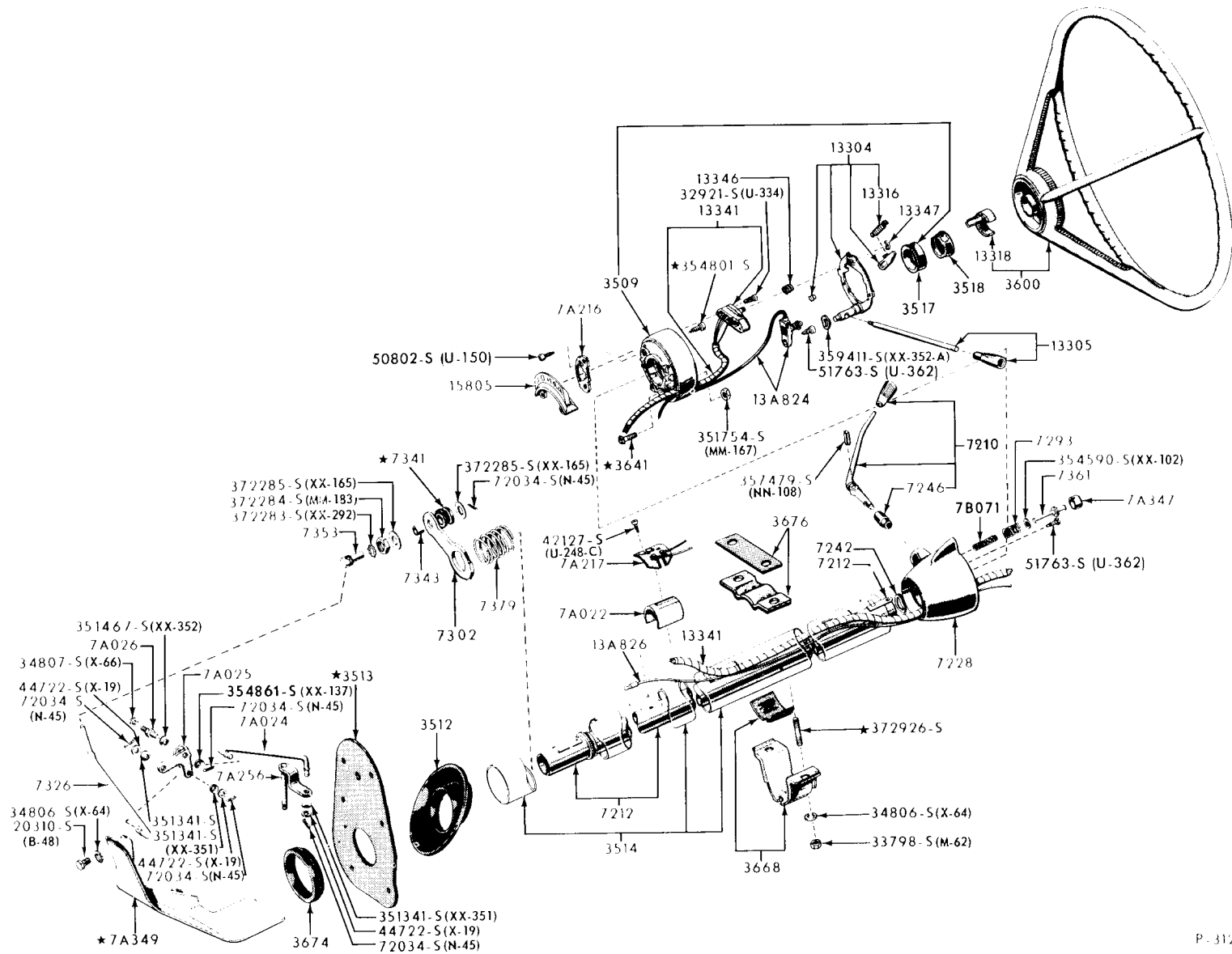

1960/63 STEERING COLUMN & SHIFT CONTROL SELECTOR MECHANISM-FALCON-TYPICAL

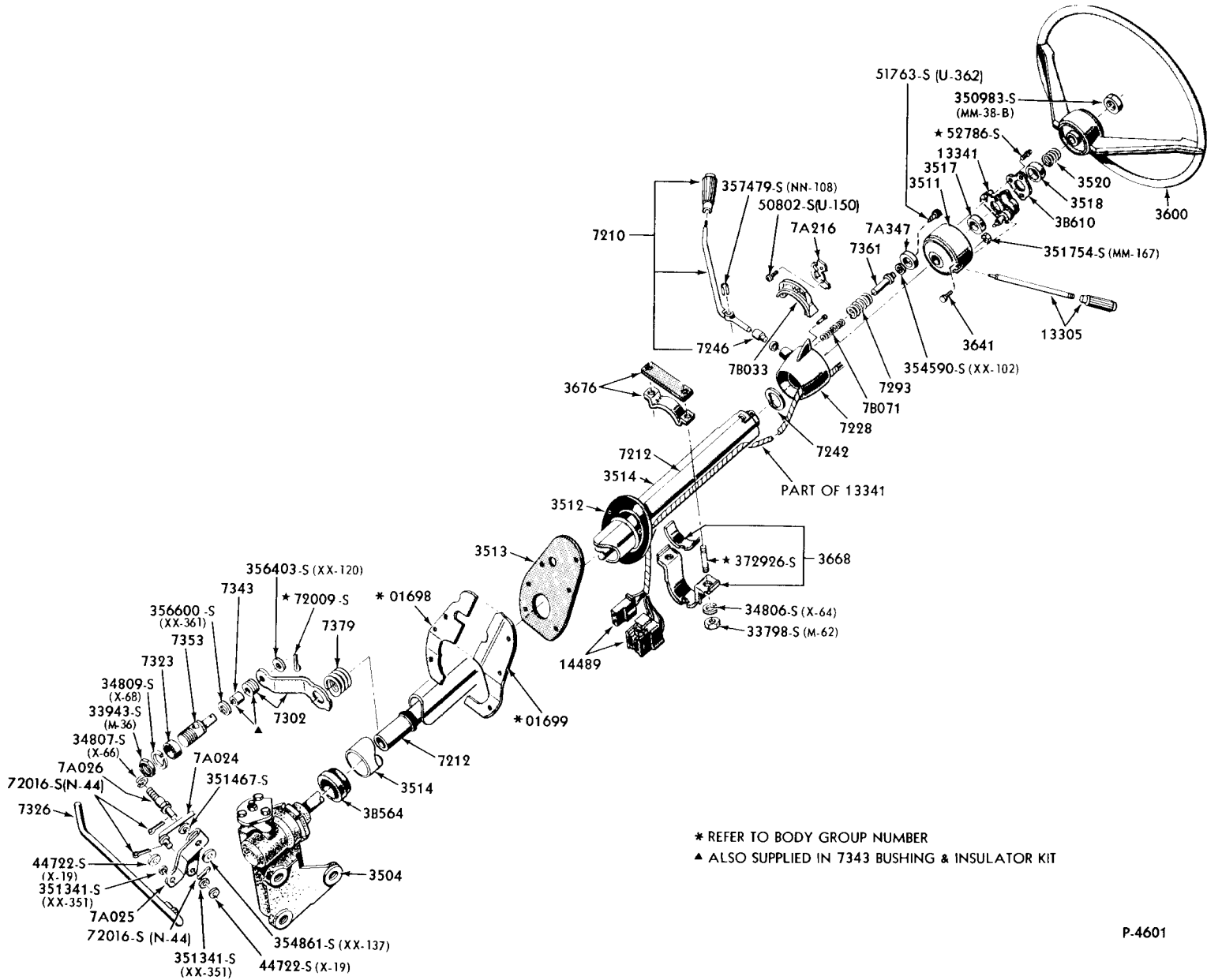

P-4601

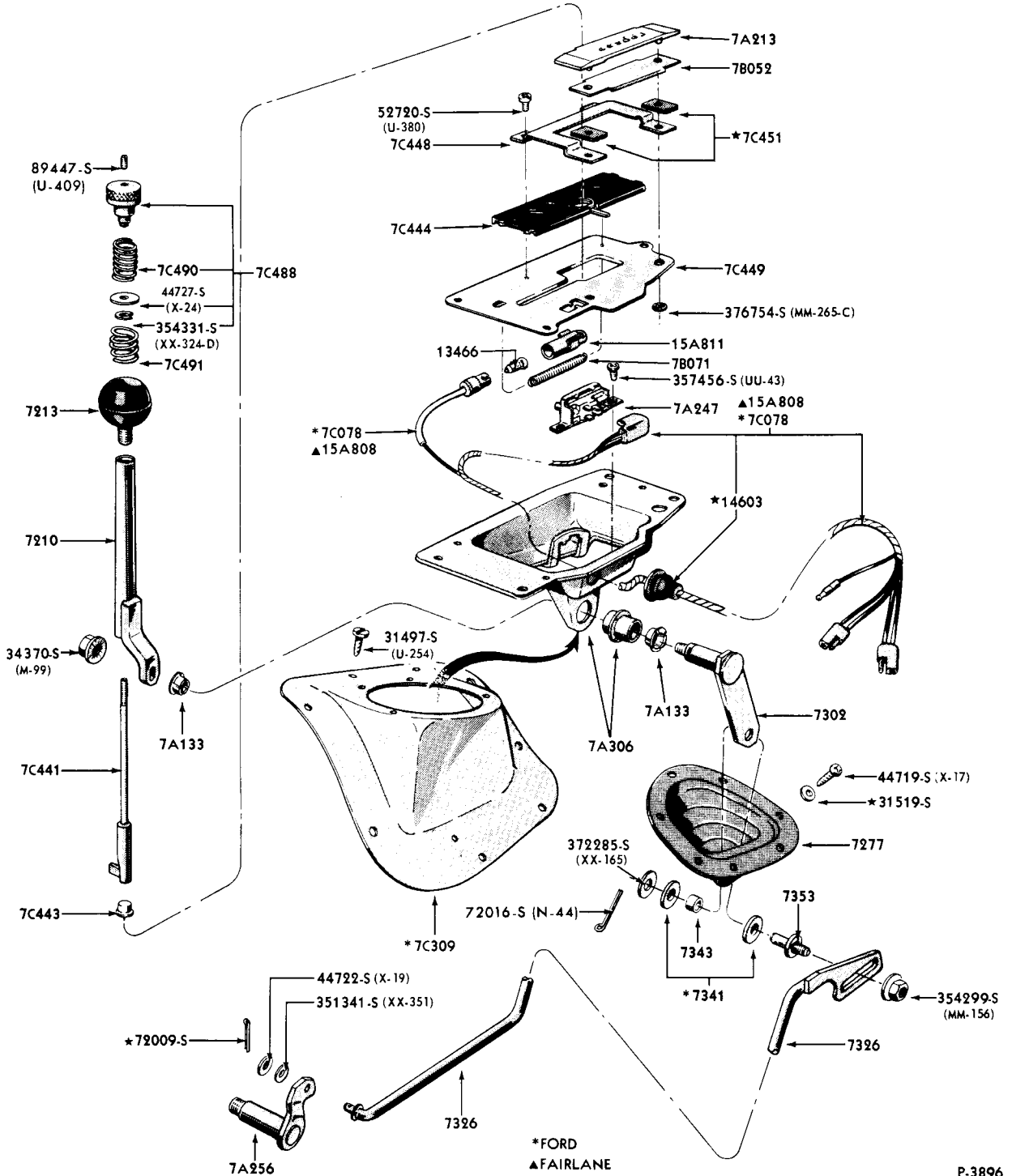

P-3896

SHIFT CONTROL SELECTOR MECHANISM-CONSOLE MOUNTED-TYPICAL
1962/64 FORD