

INDEX

INCLUDED IN THIS INDEX ARE THE FOLLOWING MAJOR GROUPS IN THE ORDER SHOWN BELOW:

CLUTCH and CLUTCH PEDAL
OVERDRIVE
SHIFT HOUSING, LEVERS, FORKS, etc.
STANDARD TRANSMISSION
GEAR SHIFT MECHANISM- CONSOLE OR FLOOR MOUNTED
STEERING COLUMN and SHIFT MECHANISM - STANDARD & OVERDRIVE

YEAR	TITLE	ILLUS. NO.	SECTION	PAGE
CLUTCH and CLUTCH PEDAL				
- A -				
1960/62	Clutch, Clutch Pedal, etc. (6 & 8 Cylinder Engines)-Ford-Typical	P-2975	75	227
1960	Clutch & Brake Pedals & Related Parts-Ford	P-2972	24	62
1963/64	Clutch & Brake Pedals & Related Parts-Ford	P-4174	24	63
- B -				
1962/	Clutch, Clutch Pedal, etc. -Fairlane-Typical	P-3738	75	228
1962/	Clutch & Brake Pedals & Related Parts-Fairlane	P-3674	24	64
- S -				
1960	Clutch, Clutch Pedal, etc. -Thunderbird-Typical	P-3080	75	229
1960	Clutch & Brake Pedals & Related Parts-Thunderbird	P-3079	24	64
- X -				
1960/	Clutch, Clutch Pedal, etc. (6 Cylinder 144,170,200 Engines)-Falcon-Typical	P-3141	75	230
1960/	Clutch & Brake Pedals & Related Parts-Falcon	P-3130	24	65
OVERDRIVE				
1960	Transmission Overdrive Wiring and Controls	P-3182	140	448
1960/	3 Speed Overdrive Transmission-Less Housing (6 & 8 Cylinder 223,289, 292 Engines)-Ford, Fairlane-Typical	P-1914	70	201
1960/	3 Speed Overdrive Transmission Housing & Related Parts (6 & 8 Cylinder 223, 289, 292 Engines)-Ford-Typical	P-2228	70	202
1960/	3 Speed Overdrive Transmission Housing & Related Parts (8 Cyl.352,390 Engines)-Ford-Typical	P-2144	70	203
1960	3 Speed Overdrive Transmission Housing & Related Parts (8 Cylinder 352 Engine)-Thunderbird-Typical	P-2144	70	203
SHIFT HOUSING, LEVERS, FORKS etc.				
- A -				
1960/62	Gear Shift Housing, Levers, Forks, etc. (Standard Transmission)-Ford-Typical	P-2648	72	211
1960/	Gear Shift Housing, Levers, Forks, etc.-Overdrive Trans. (6 & 8 Cylinder)-Ford - Typical	P-2478	72	212
1961	Interlock Linkage-Standard Transmission (6 & 8 Cylinder Engines)-Ford-Typical	P-3605	72	213
1962/	Interlock Linkage-Overdrive Transmission (6 & 8 Cylinder Engines)-Ford-Typical	P-3917	72	214
- B -				
1962/63	Interlock Linkage-Standard & Overdrive Transmission (Fairlane)	P-3919	72	215
- S -				
1960	Gear Shift Housing, Levers, Forks, etc. -Standard & Overdrive Transmissions (8 Cylinder 352 Engine)- Thunderbird	P-2478	72	212
- X -				
1962/64	Gear Shift Levers, Extension Housing, Forks, Controls & Linkage (4 Speed Transmission-Dagenham)-Falcon	P-3904	72	216

INDEX

YEAR	TITLE	ILLUS. NO.	SECTION	PAGE
STANDARD TRANSMISSION				
1960/62	3 Speed Standard Transmission - 2 15/16 Type - Ford-Fairlane-Typical	P-2227	70	204
1963/	3 Speed Standard Transmission & Extension (303 Synchro)-Ford, Fairlane, Falcon-Typical	P-4012	70	205
1960/	3 Speed Standard Transmission & Extension - 2.77 Type-Fairlane, Falcon-Typical	P-2966	70	206
1960	3 Speed Standard Transmission - 2 15/16 Type - Thunderbird	P-2475	70	207
1960/	4 Speed Standard Transmission Housing, Extension & Gear Train (Warner Gear Design)	P-3744	70	208
1962/	4 Speed Standard Transmission Housing, Extension & Gear Train (Dagenham Design)	P-3903	70	209
1964/	4 Speed Standard Transmission Housing, Extension & Gear Train (Ford Design)	P-4424	70	210
GEAR SHIFT MECHANISM - CONSOLE OR FLOOR MOUNTED				
1960/	Gear Shift Lever, Fork & Control (Warner Design 4-Speed Transmission-Floor & Console Mounted) - Typical	P-3745	72	217
1964/	Gear Shift Mechanism - Console or Floor Mounted (Ford Design 4-Speed Transmission)-Ford - Typical	P-5809	72	218
1964/	Gear Shift Mechanism - Console or Floor Mounted (Ford Design 4-Speed Transmission)-Fairlane, Falcon - Typical	P-5810	72	219
STEERING COLUMN and SHIFT MECHANISM - STANDARD & OVERDRIVE				
- A -				
1960	Steering Column & Shift Mechanism (Standard & Overdrive Transmissions-6 & 8 Cylinder Engines)-Ford-Typical	P-3069	72	220
1961/62	Steering Column & Shift Mechanism (Standard & Overdrive Transmissions-6 & 8 Cylinder Engines)-Ford-Typical	P-3503	72	221
1963/64	Steering Column & Shift Mechanism (Standard & Overdrive Transmission -6 & 8 Cylinder Engines)-Ford-Typical	P-4249	72	222
- B -				
1962/	Steering Column & Shift Mechanism (Standard & Overdrive Transmissions)-Fairlane	P-3712	72	223
- S -				
1960	Steering Column & Shift Mechanism (Standard & Overdrive Transmissions)-Thunderbird-Typical	P-2703	72	224
- X -				
1960	Steering Column & Shift Mechanism (Standard Transmission-6 Cylinder 144 Engine)-Falcon-Typical	P-3126	72	225
1964/	Steering Column & Shift Mechanism (Standard & Overdrive Transmission)-Falcon	P-4600	72	226

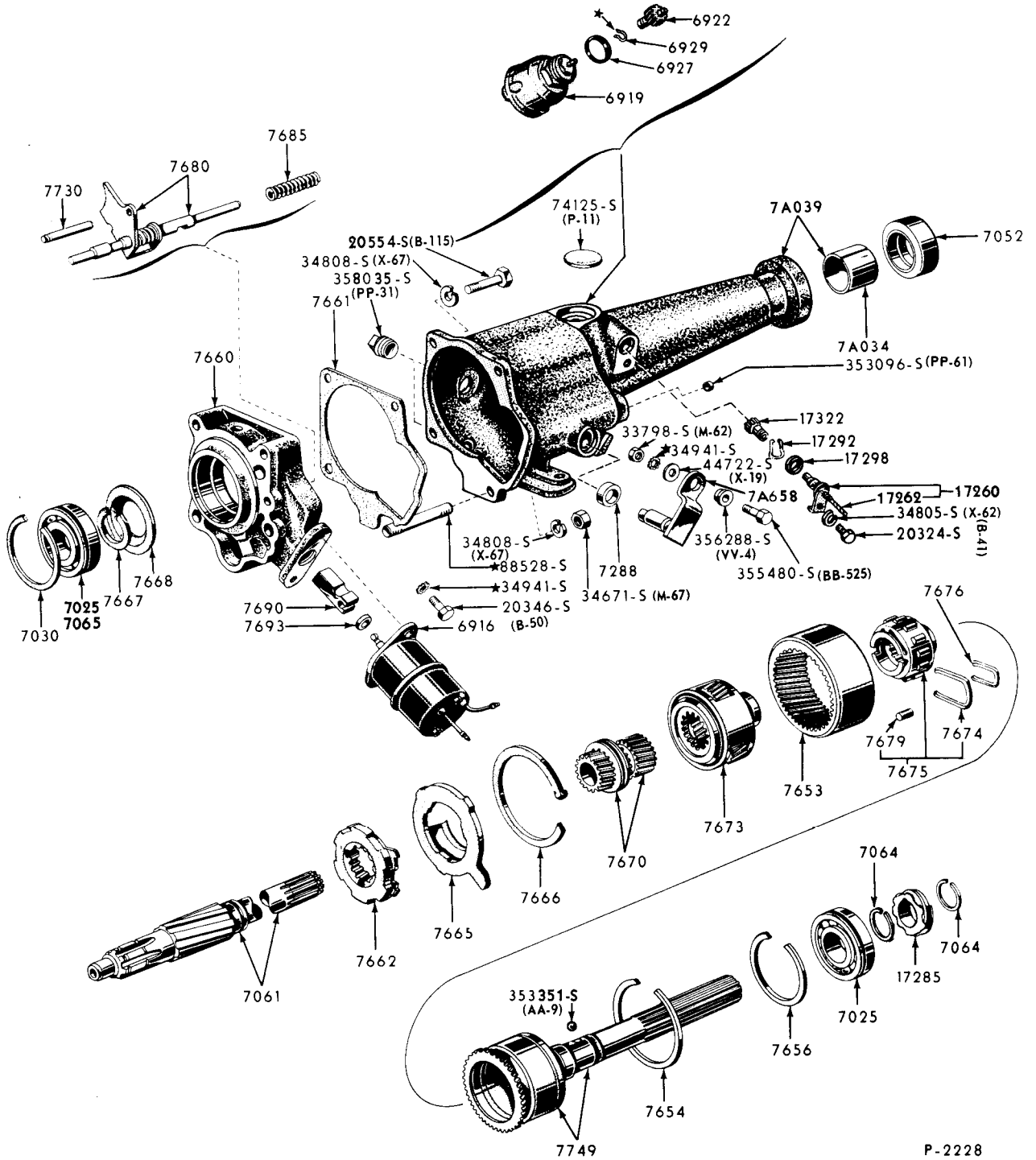

P-2228

1960/ 3 SPEED OVERDRIVE TRANSMISSION HOUSING & RELATED PARTS
(6 & 8 CYLINDER 223, 289, 292 ENGINES)-FORD-TYPICAL

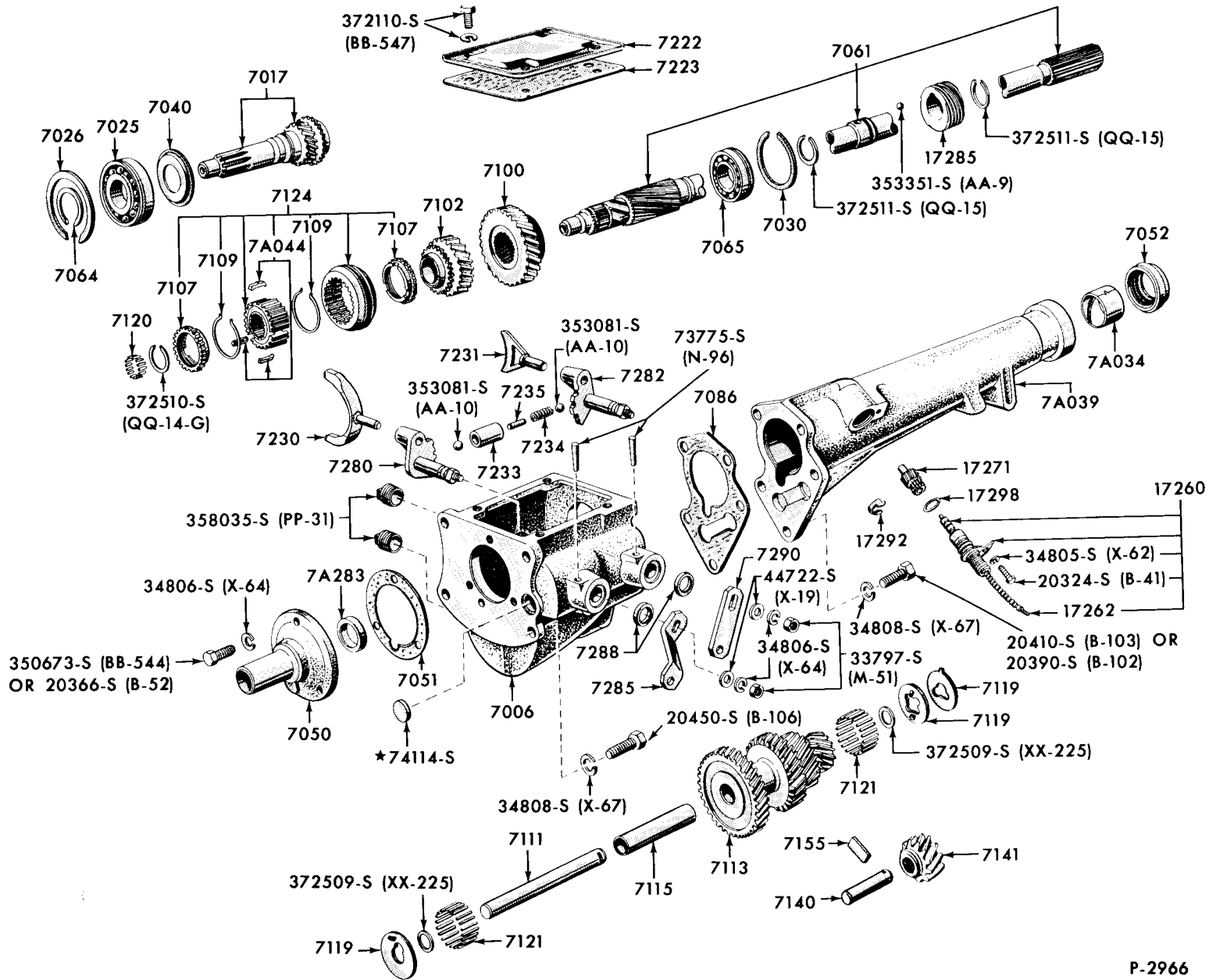

1960 / 3 SPEED STANDARD TRANSMISSION - 2.77 TYPE - FAIRLANE, FALCON-TYPICAL

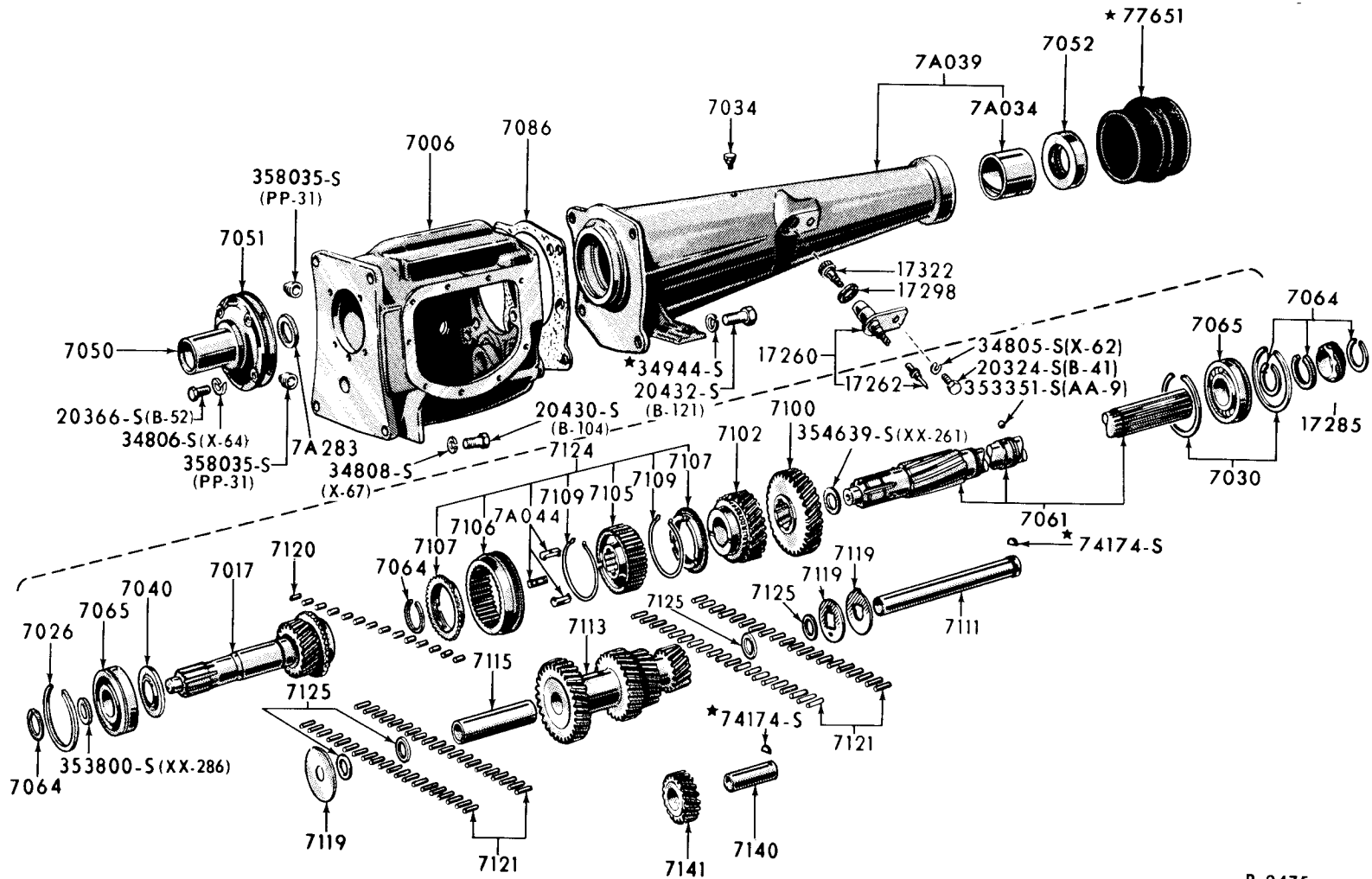

FORD CAR PARTS

ILLUSTRATION SECTION 70

P-2475

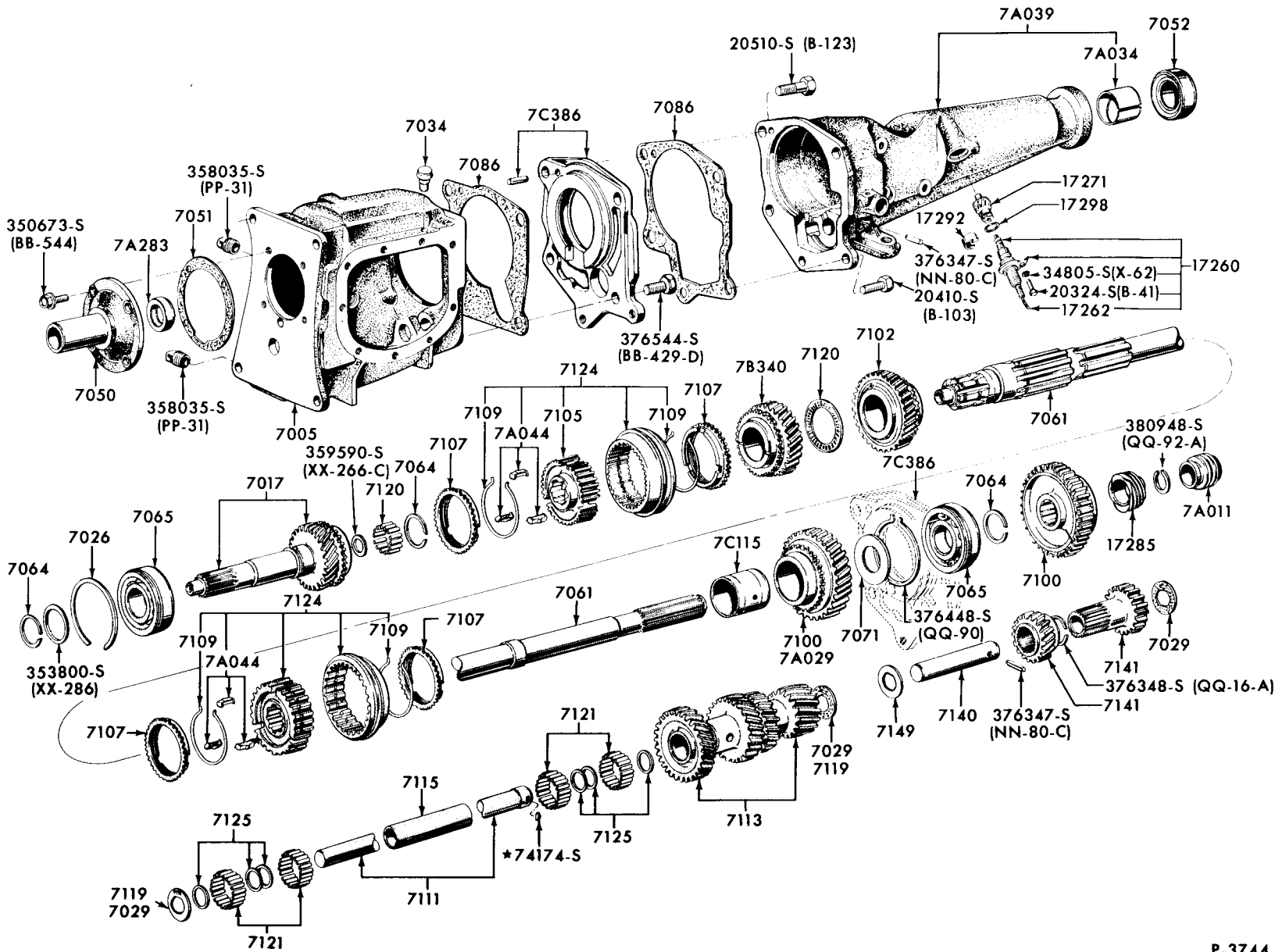

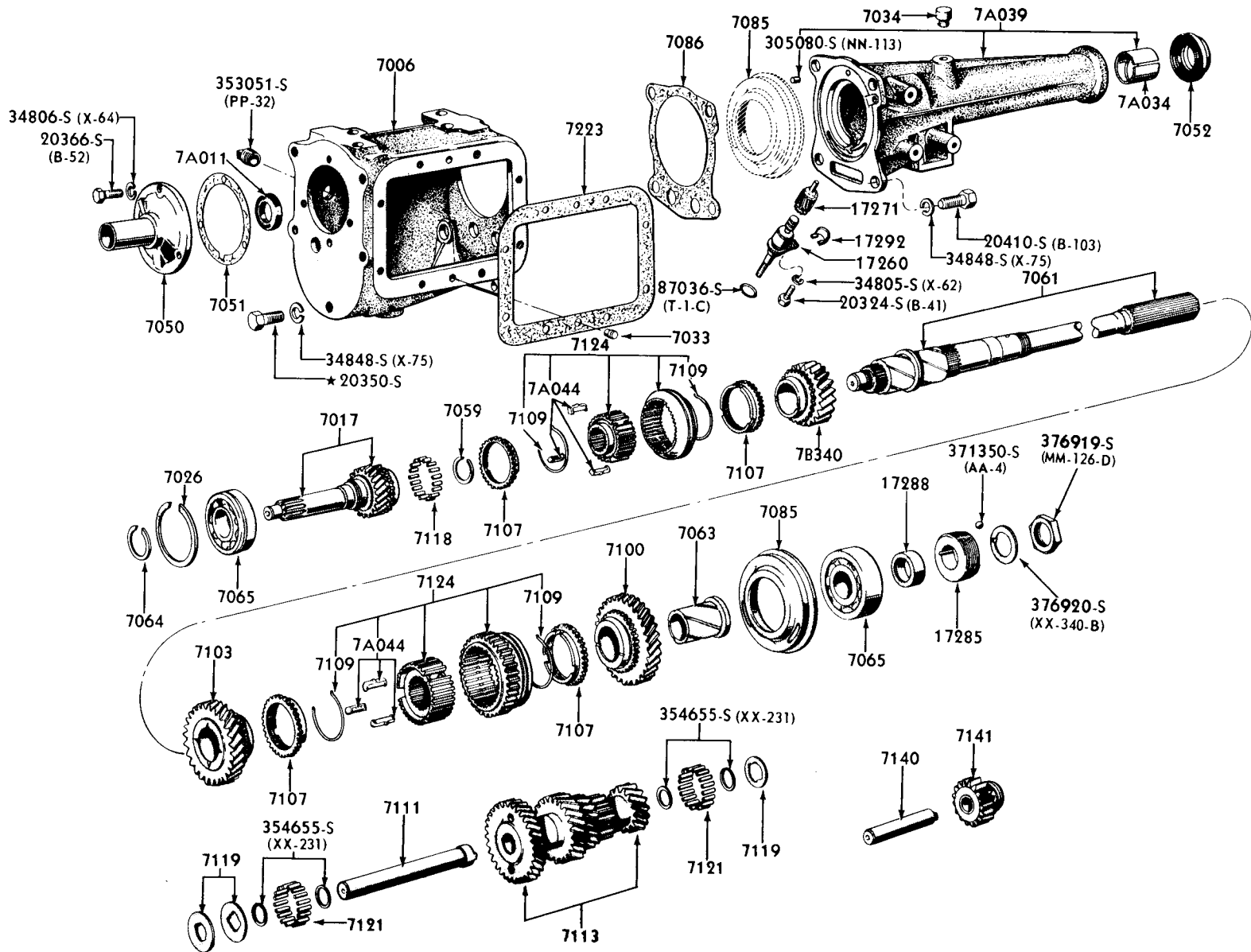

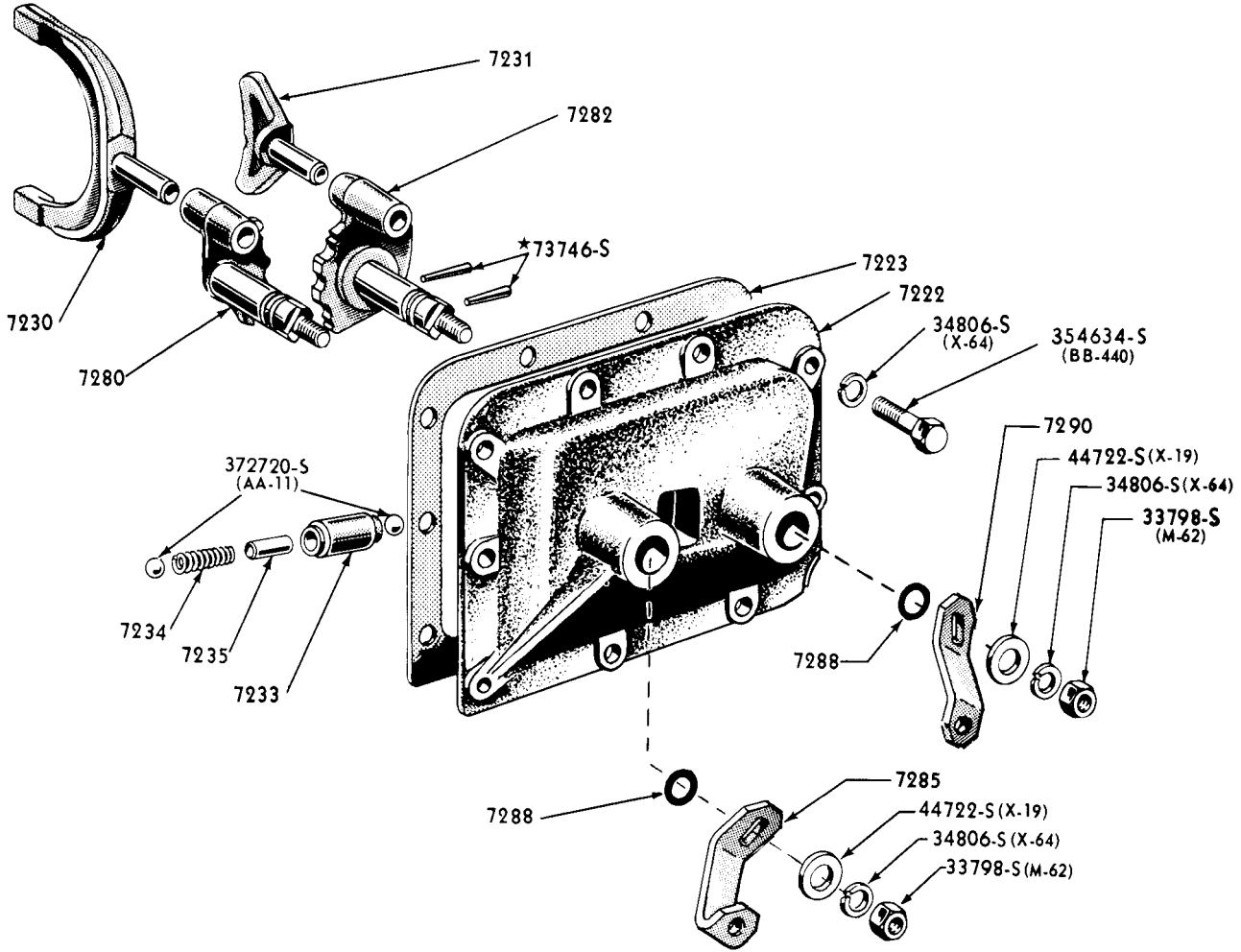

P-2648

1960/62 GEAR SHIFT HOUSING, LEVERS, FORKS, ETC. (STANDARD TRANSMISSION)-FORD - TYPICAL

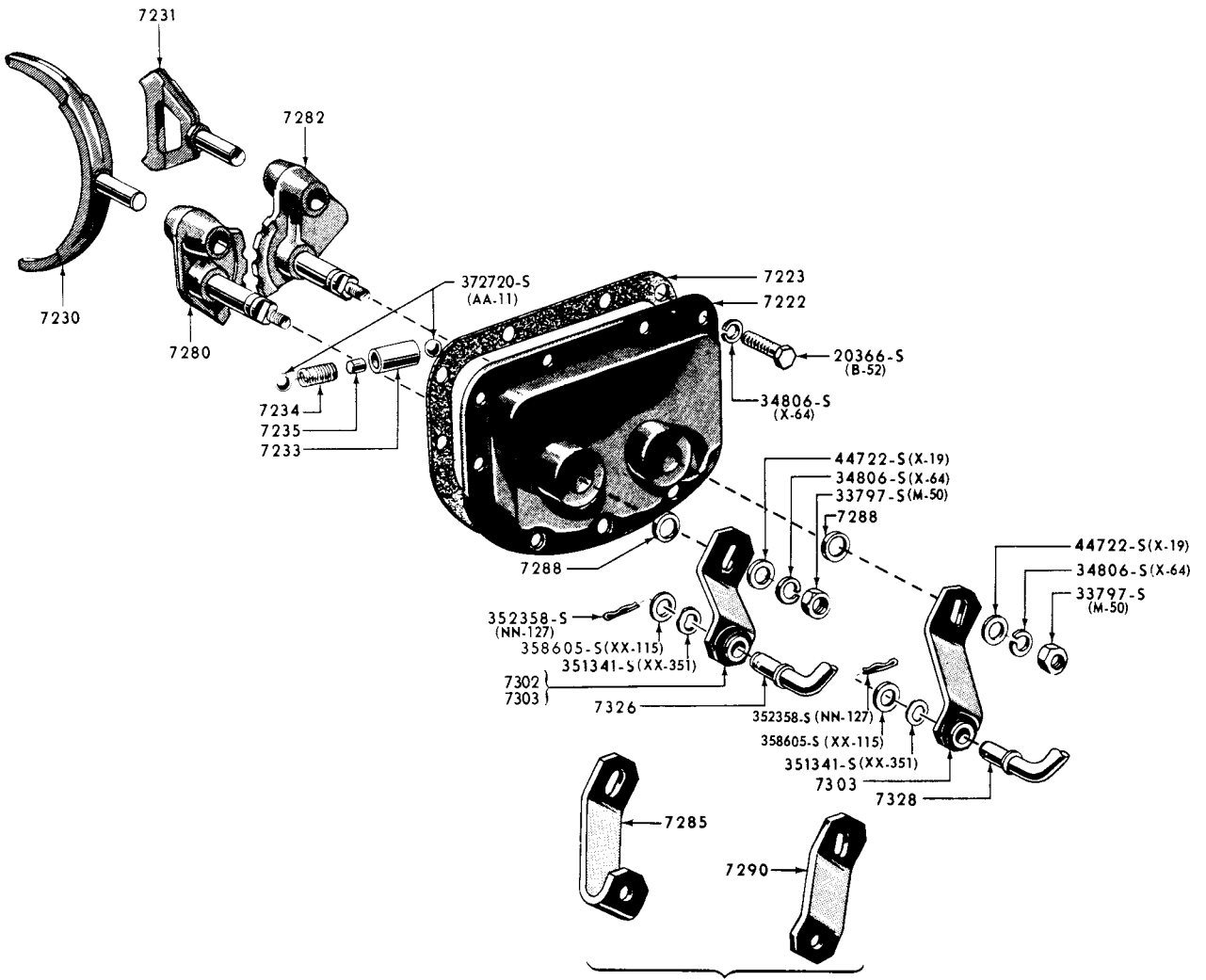

OVERDRIVE TRANSMISSION

P-2478

GEAR SHIFT HOUSING, LEVERS, FORKS, ETC.
1960/ OVERDRIVE TRANSMISSION (6 & 8 CYLINDER)- FORD-TYPICAL
1960 STANDARD & OVERDRIVE TRANSMISSIONS (8 CYLINDER 352 ENGINE)- THUNDERBIRD

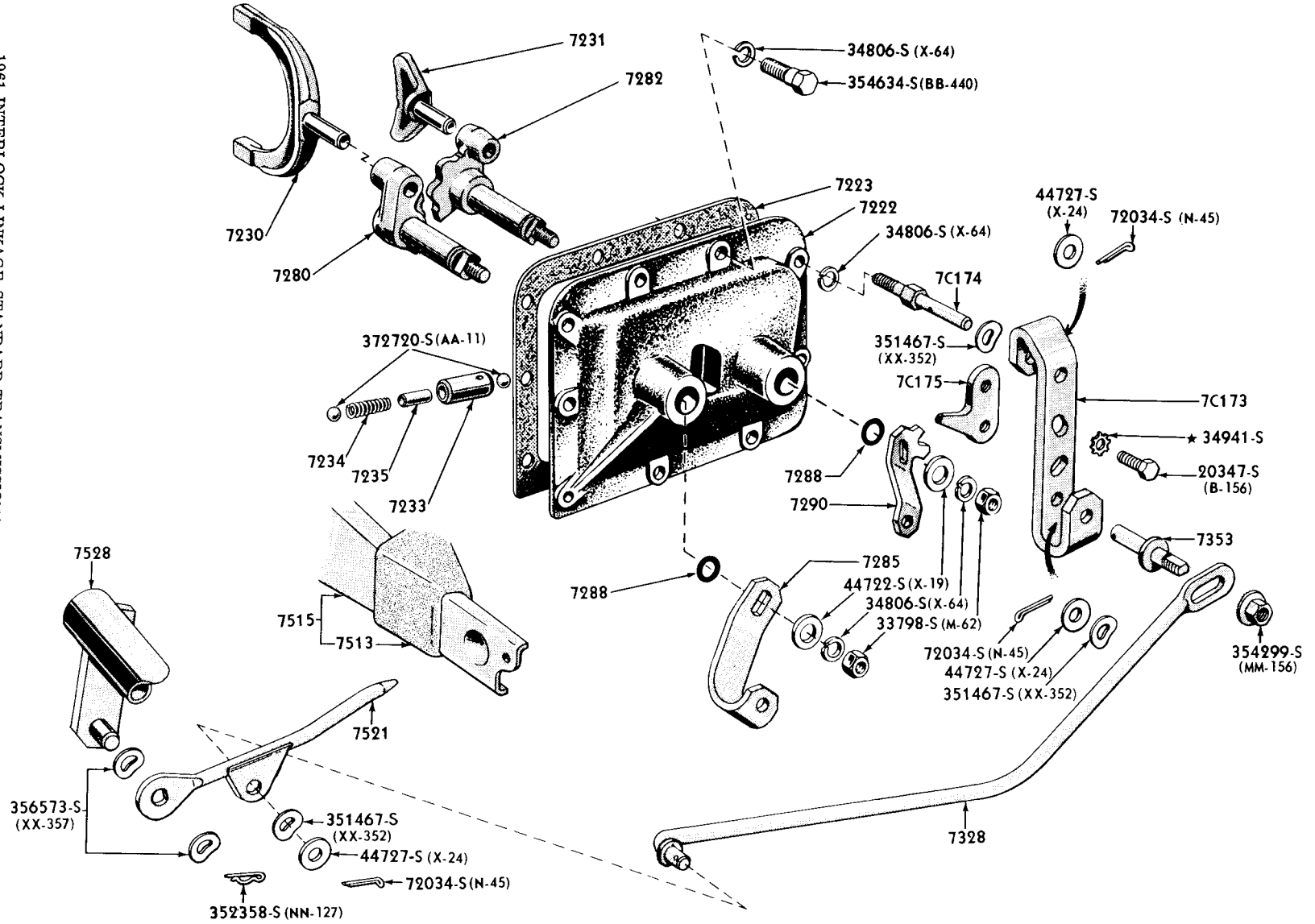

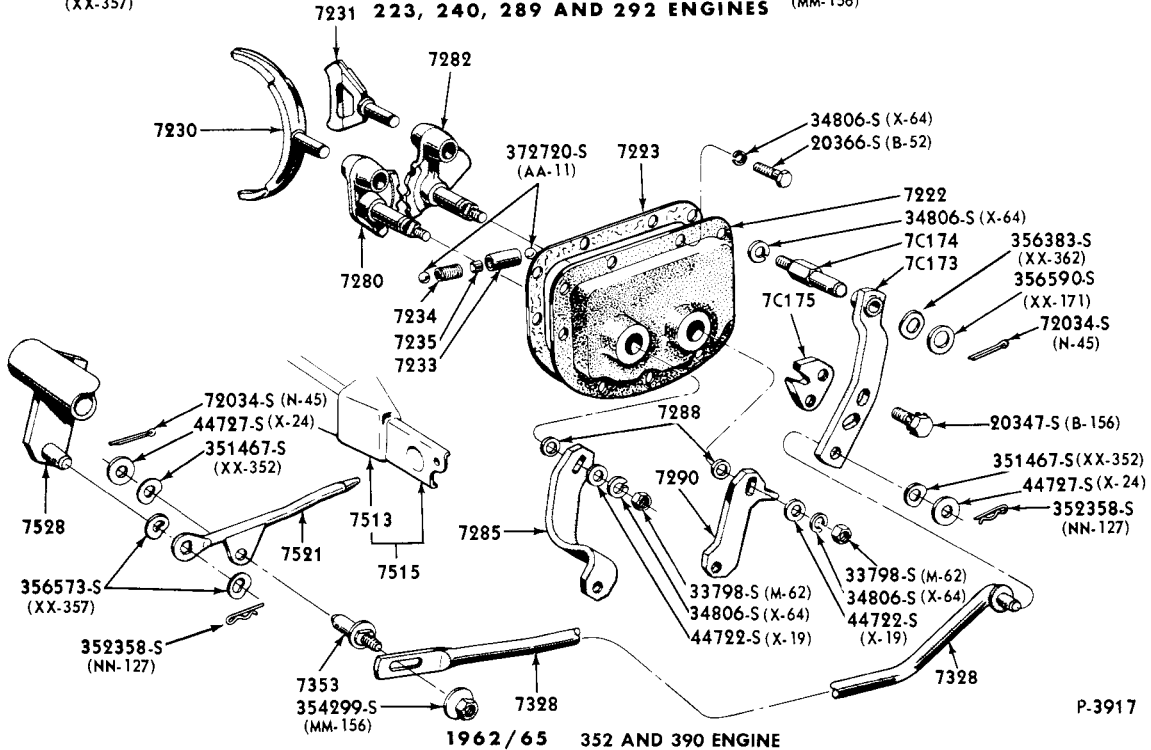
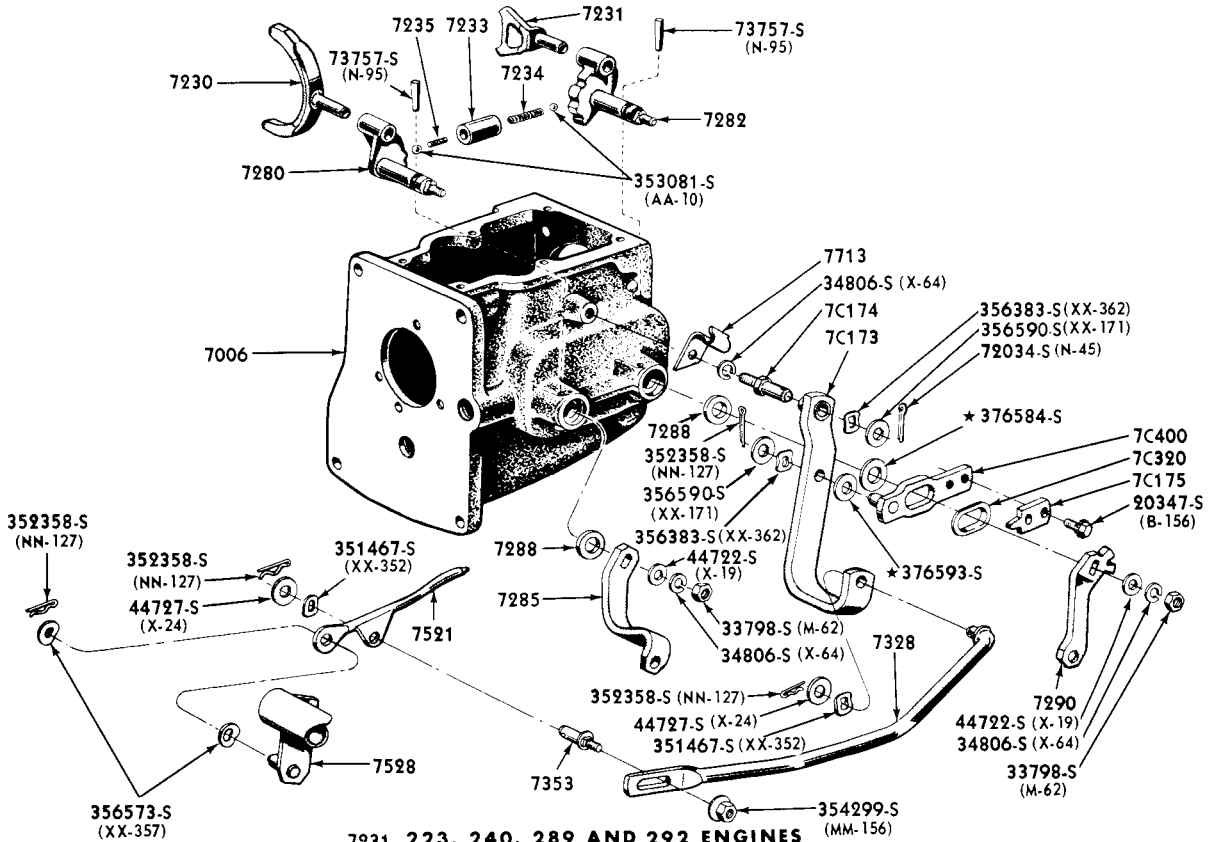

P-3917

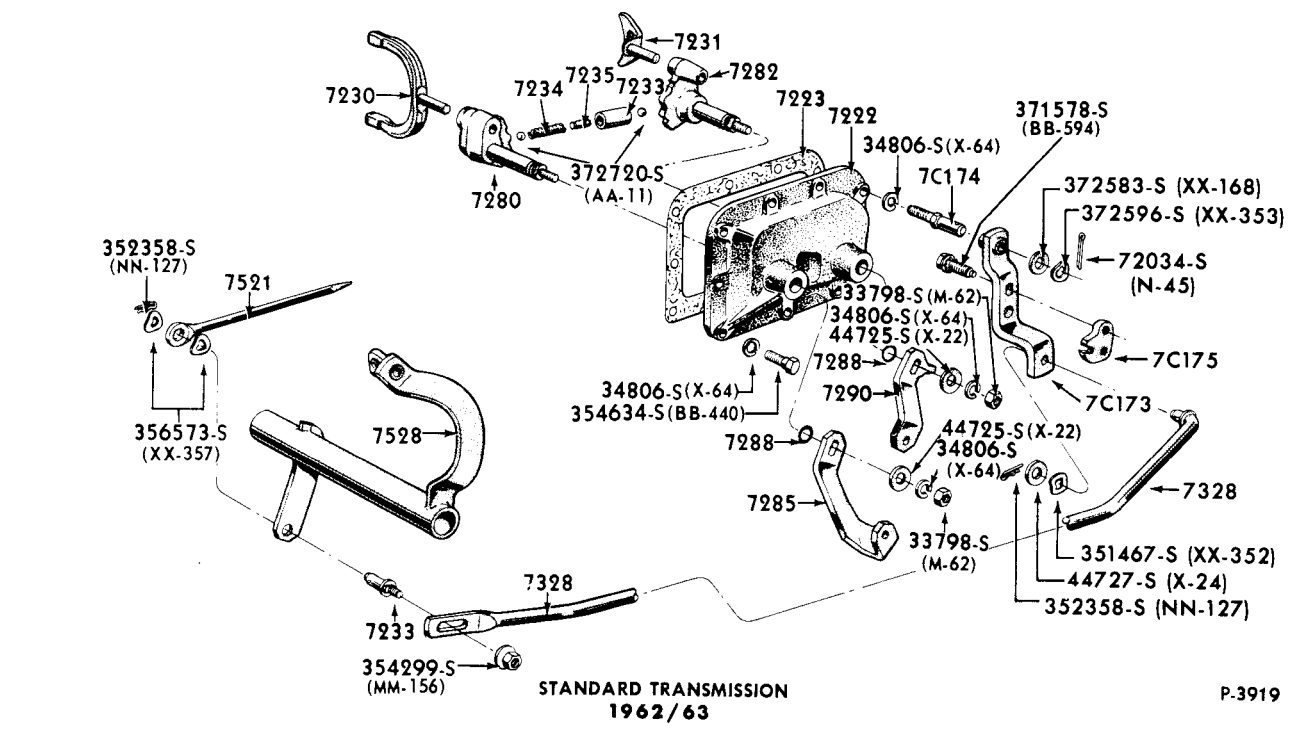
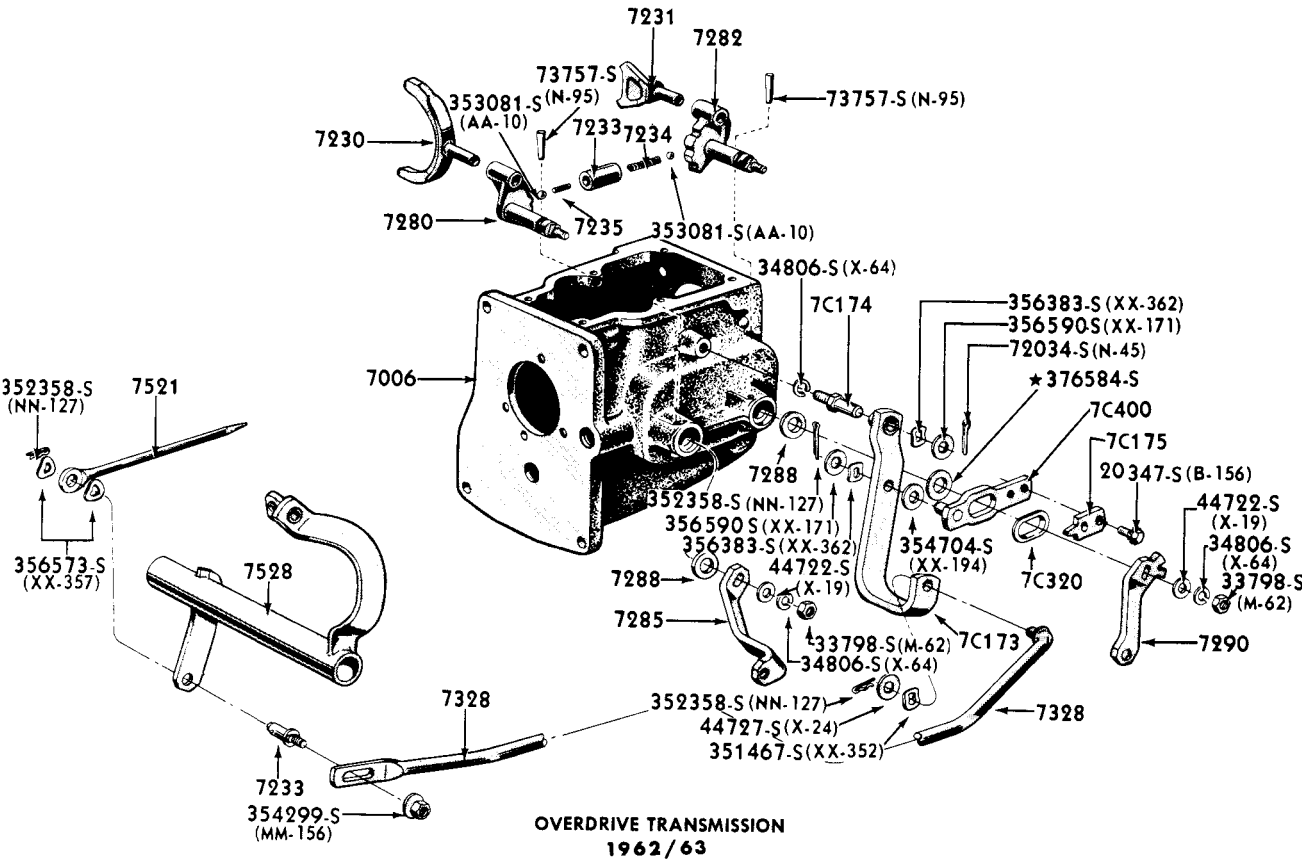

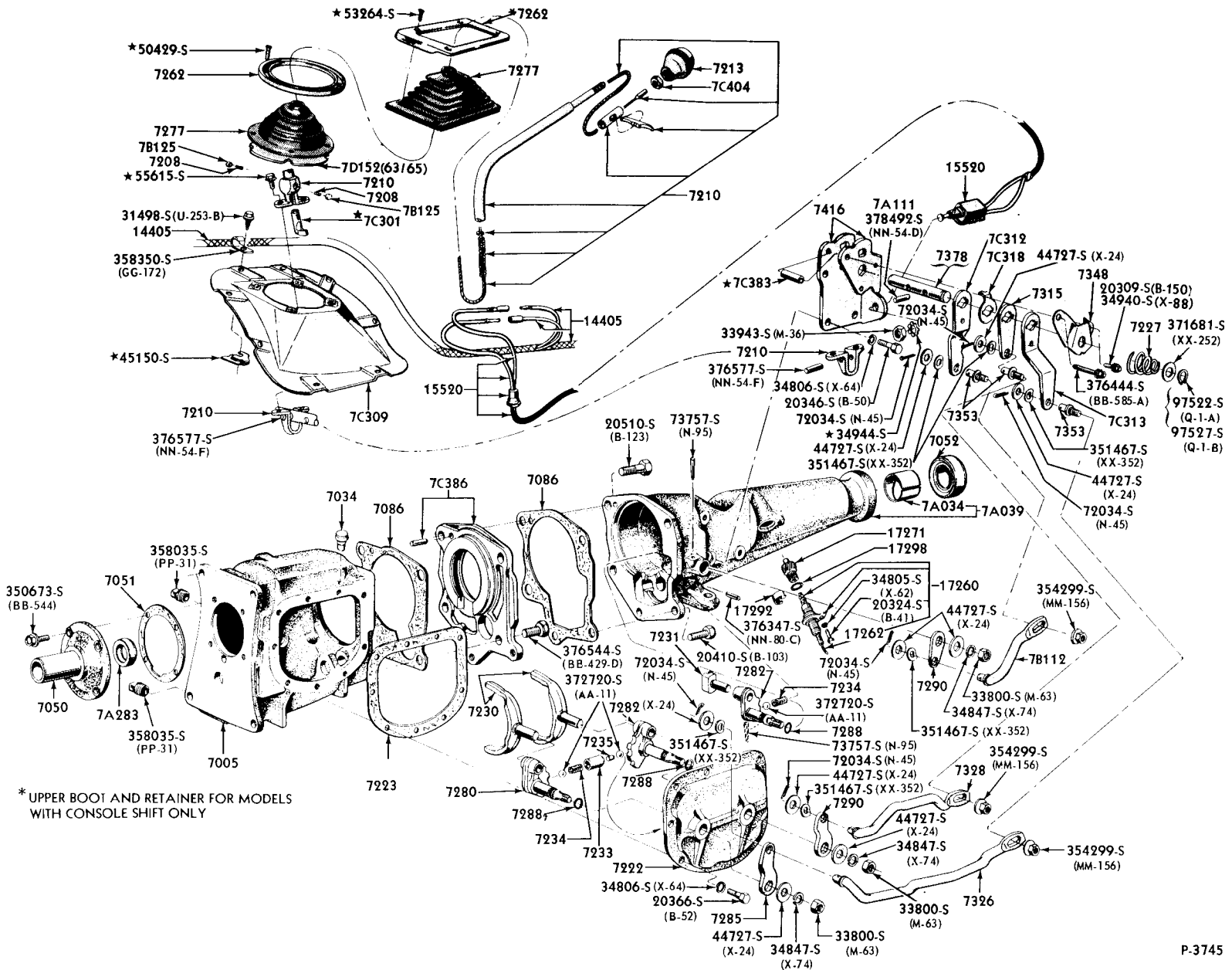

* UPPER BOOT AND RETAINER FOR MODELS WITH CONSOLE SHIFT ONLY

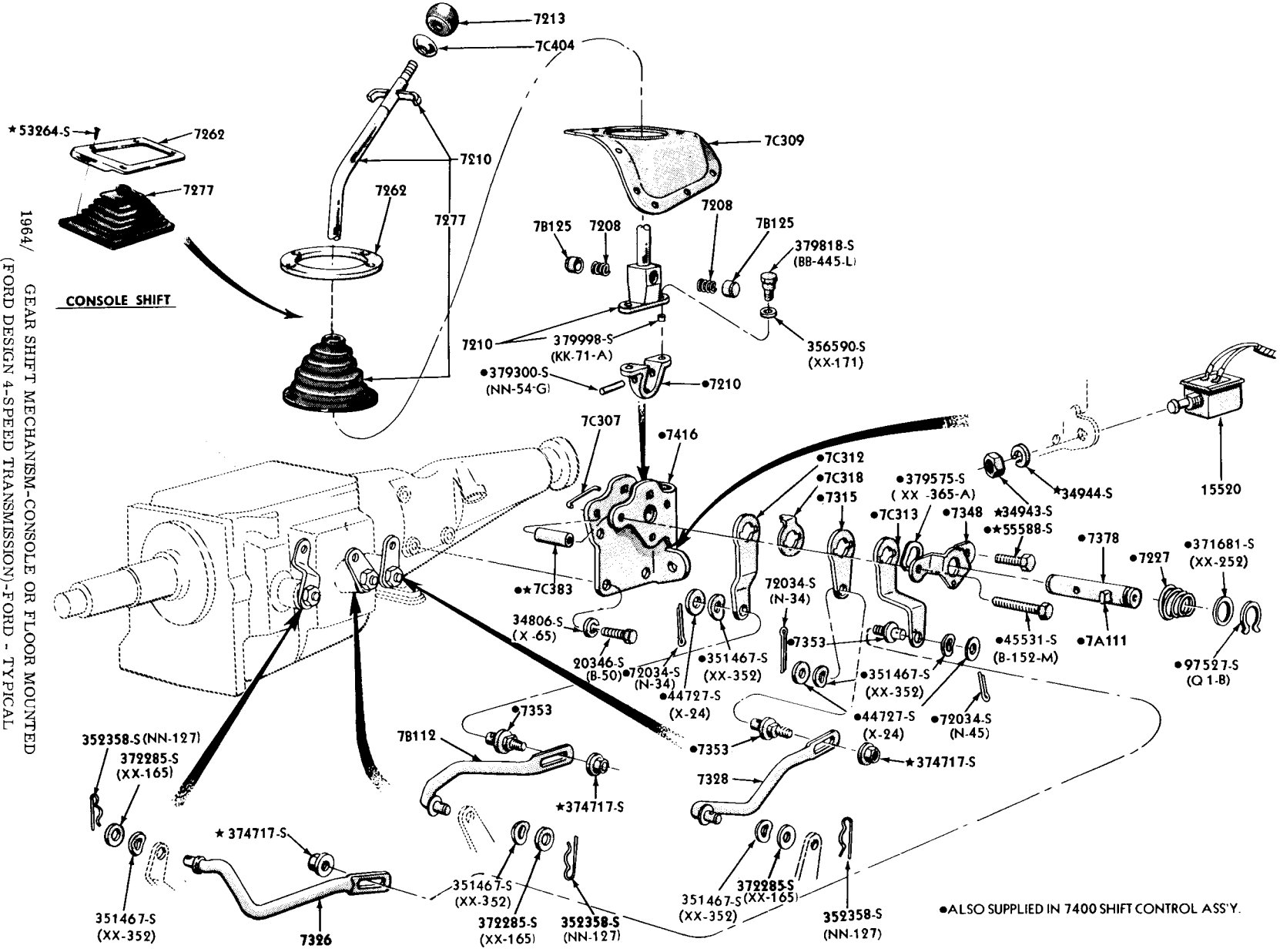

1964/ GEAR SHIFT MECHANISM-CONSOLE OR FLOOR MOUNTED (FORD DESIGN 4-SPEED TRANSMISSION-FORD - TYPICAL

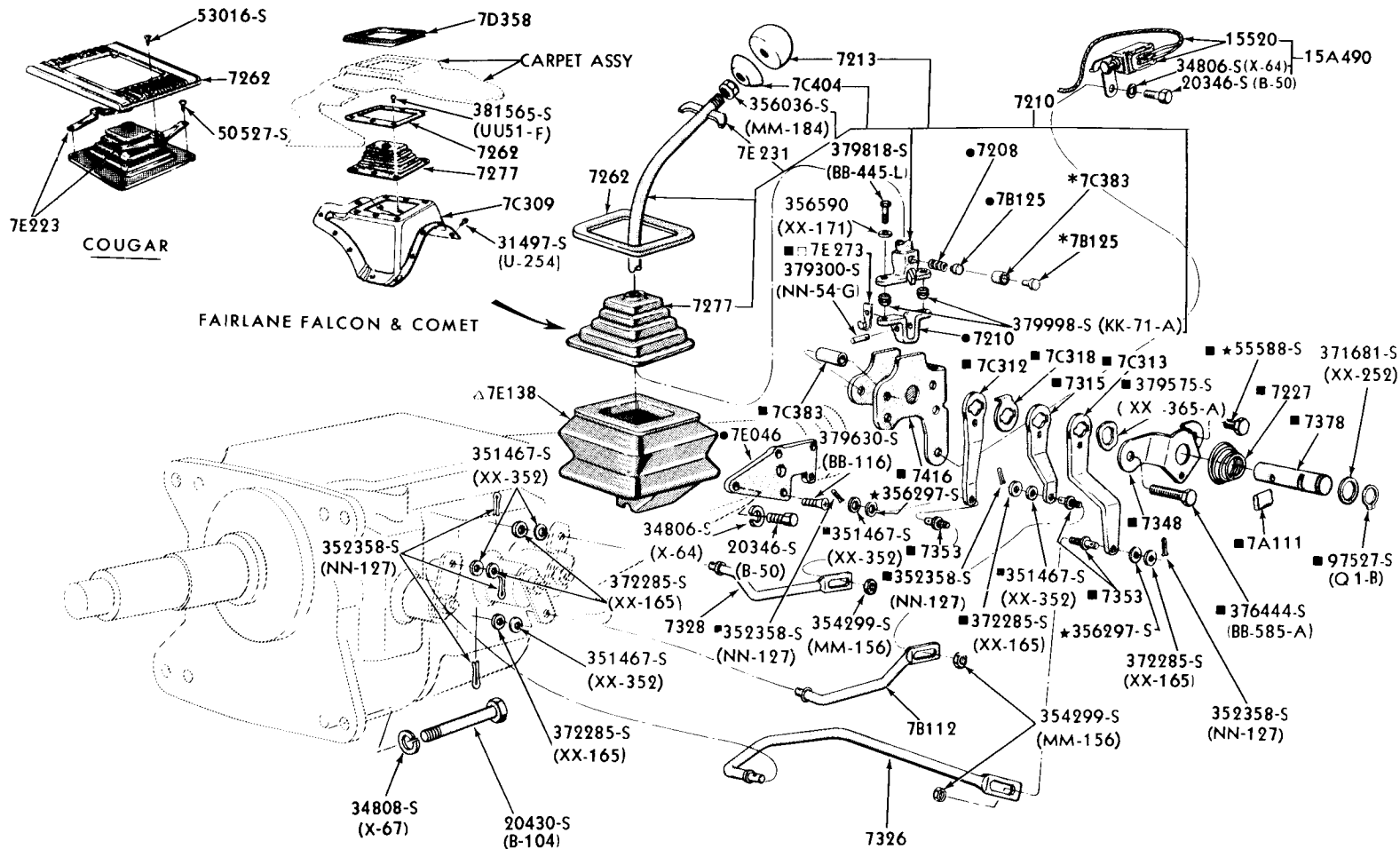

- MUSTANG, COUGAR
- * FAIRLANE, FALCON & COMET
- △ 1966/ MODELS ONLY
- ALSO SUPPLIED IN 7400 SHIFT CONTROL ASS'Y.
- 1968 ONLY

1964 / GEAR SHIFT MECHANISM-CONSOLE OR FLOOR MOUNTED
 (FORD DESIGN 4-SPEED TRANSMISSION - FAIRLANE, FALCON - TYPICAL)

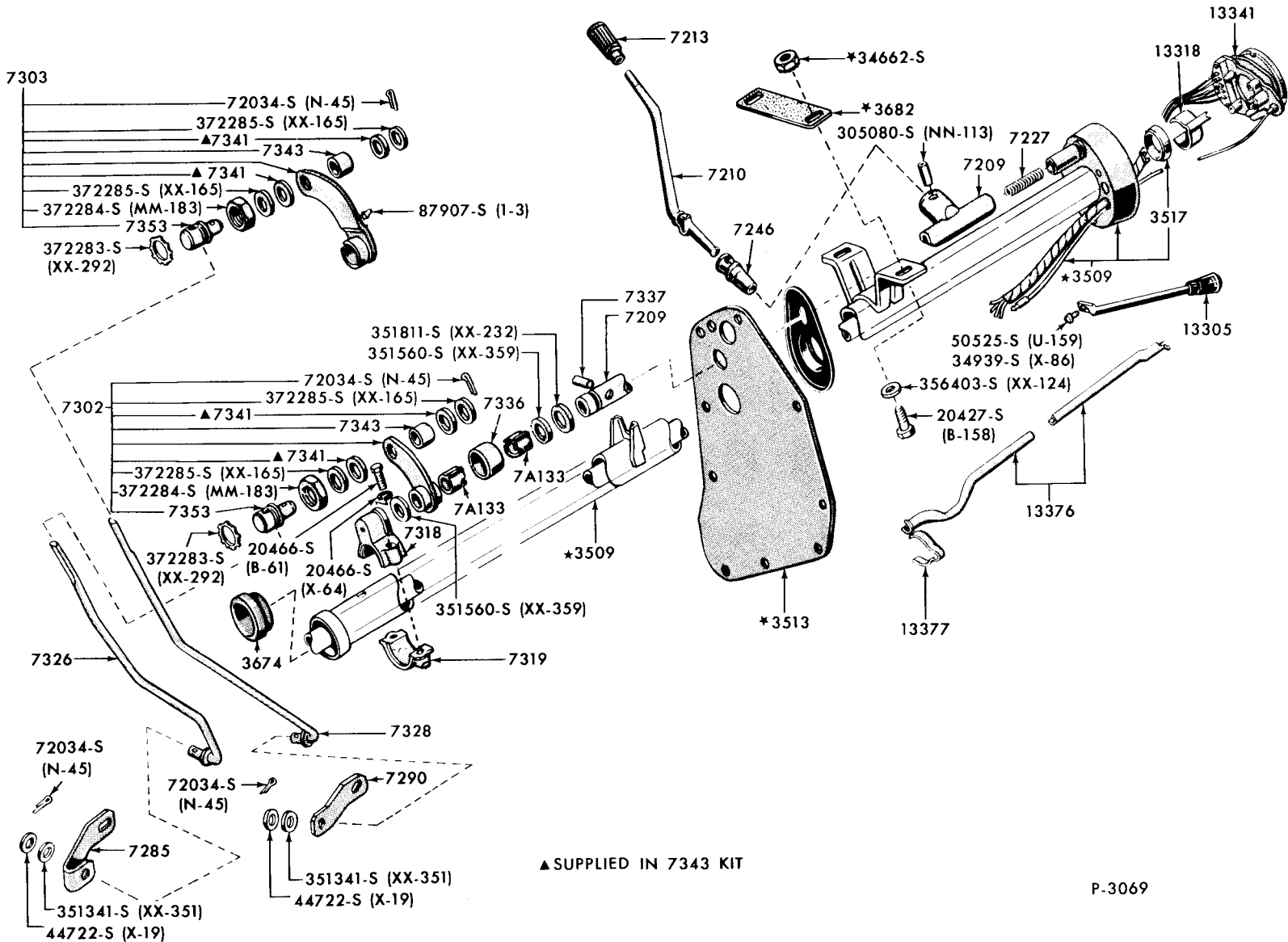

P-3069

1960 STEERING COLUMN & SHIFT MECHANISM (STANDARD & OVERDRIVE TRANSMISSIONS-6 & 8 CYLINDER ENGINES)-FORD-TYPICAL

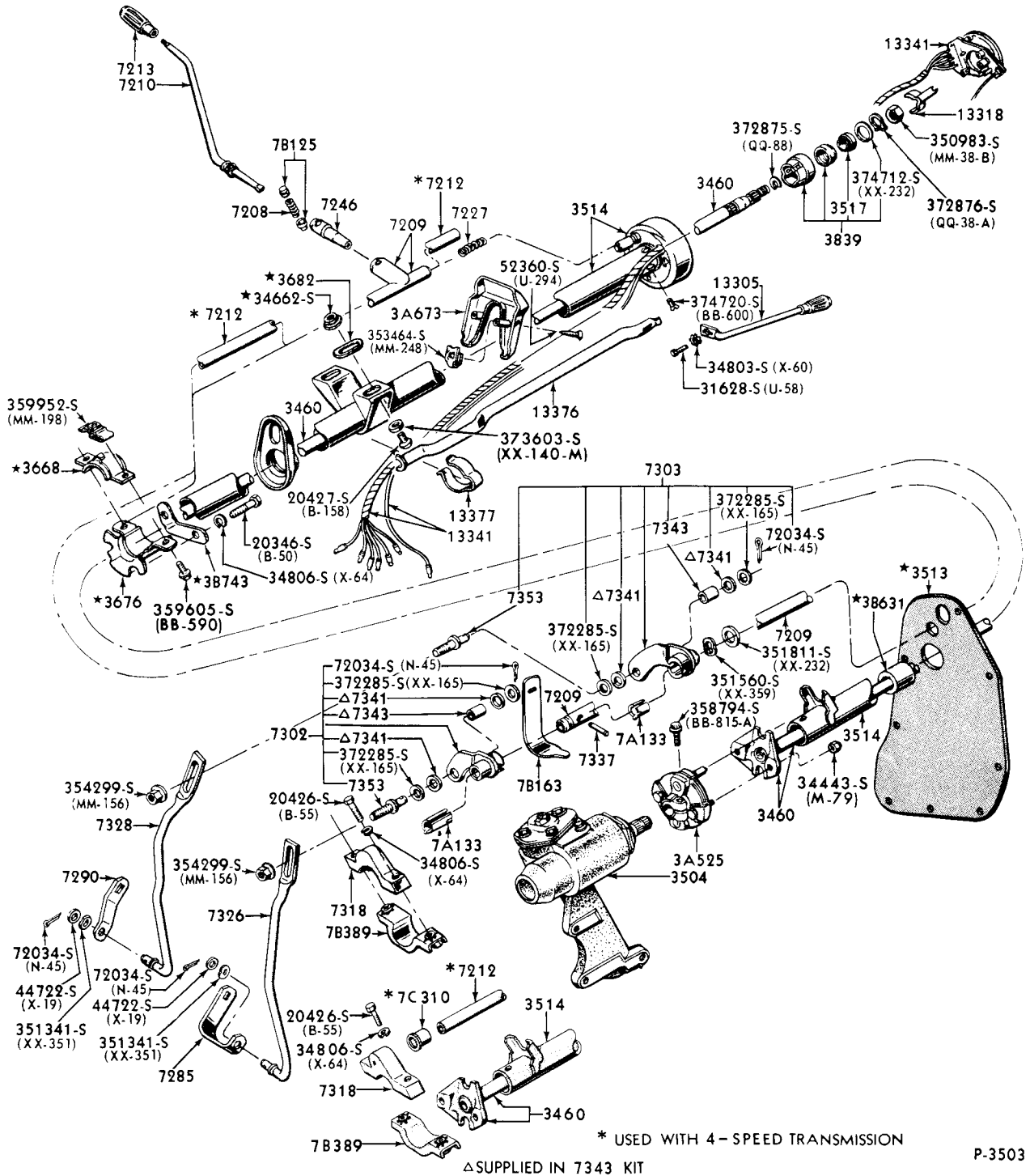

1961/62 STEERING COLUMN & SHIFT MECHANISM (STANDARD & OVERDRIVE TRANSMISSIONS- 6 & 8 CYLINDER ENGINES)-FORD-TYPICAL

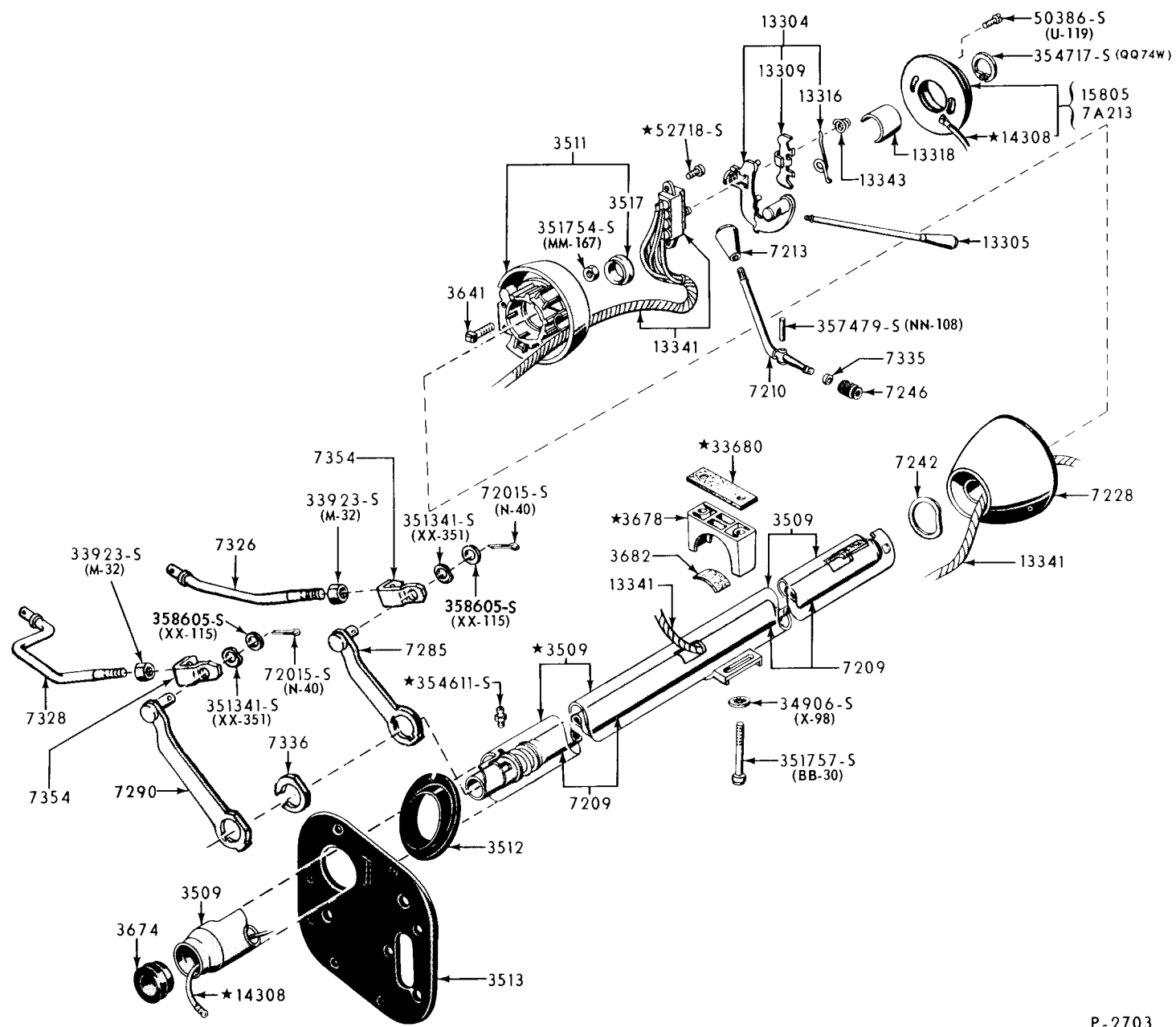

1960 STEERING COLUMN & SHIFT MECHANISM (STANDARD & OVERDRIVE TRANSMISSIONS) - THUNDERBIRD - TYPICAL

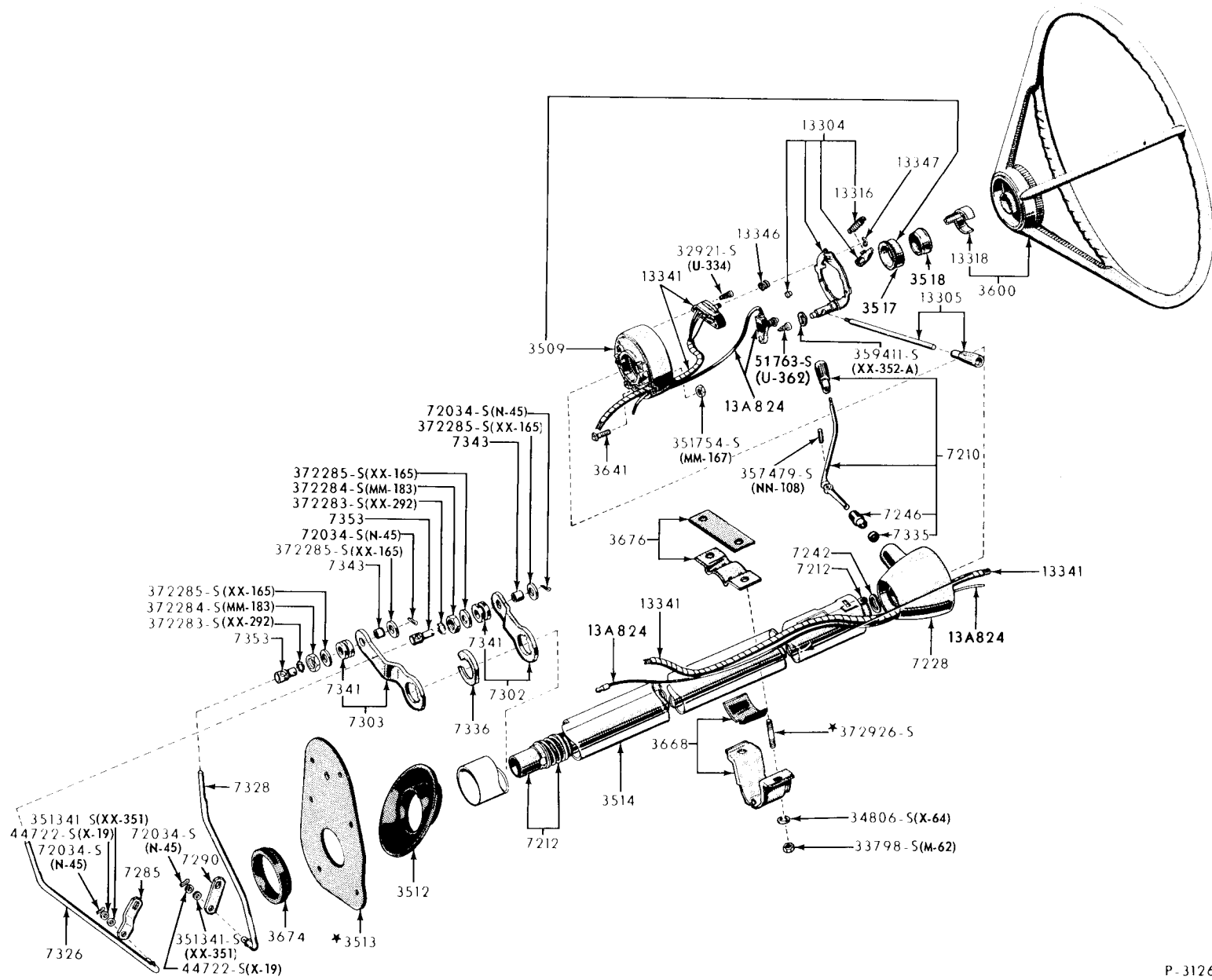

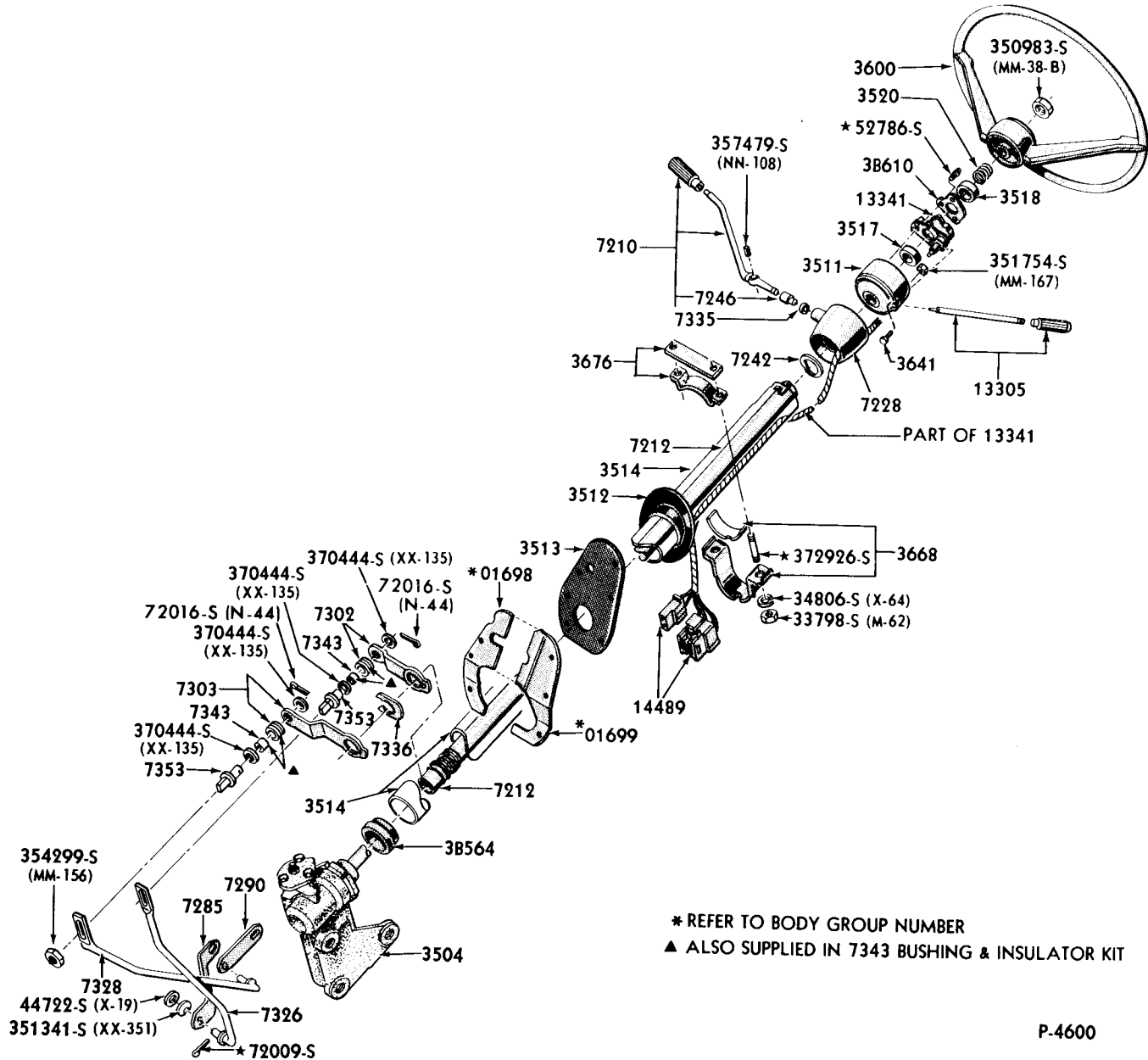

* REFER TO BODY GROUP NUMBER
 ▲ ALSO SUPPLIED IN 7343 BUSHING & INSULATOR KIT

1964/ STEERING COLUMN & SHIFT MECHANISM (STANDARD & OVERDRIVE TRANSMISSION)-FALCON

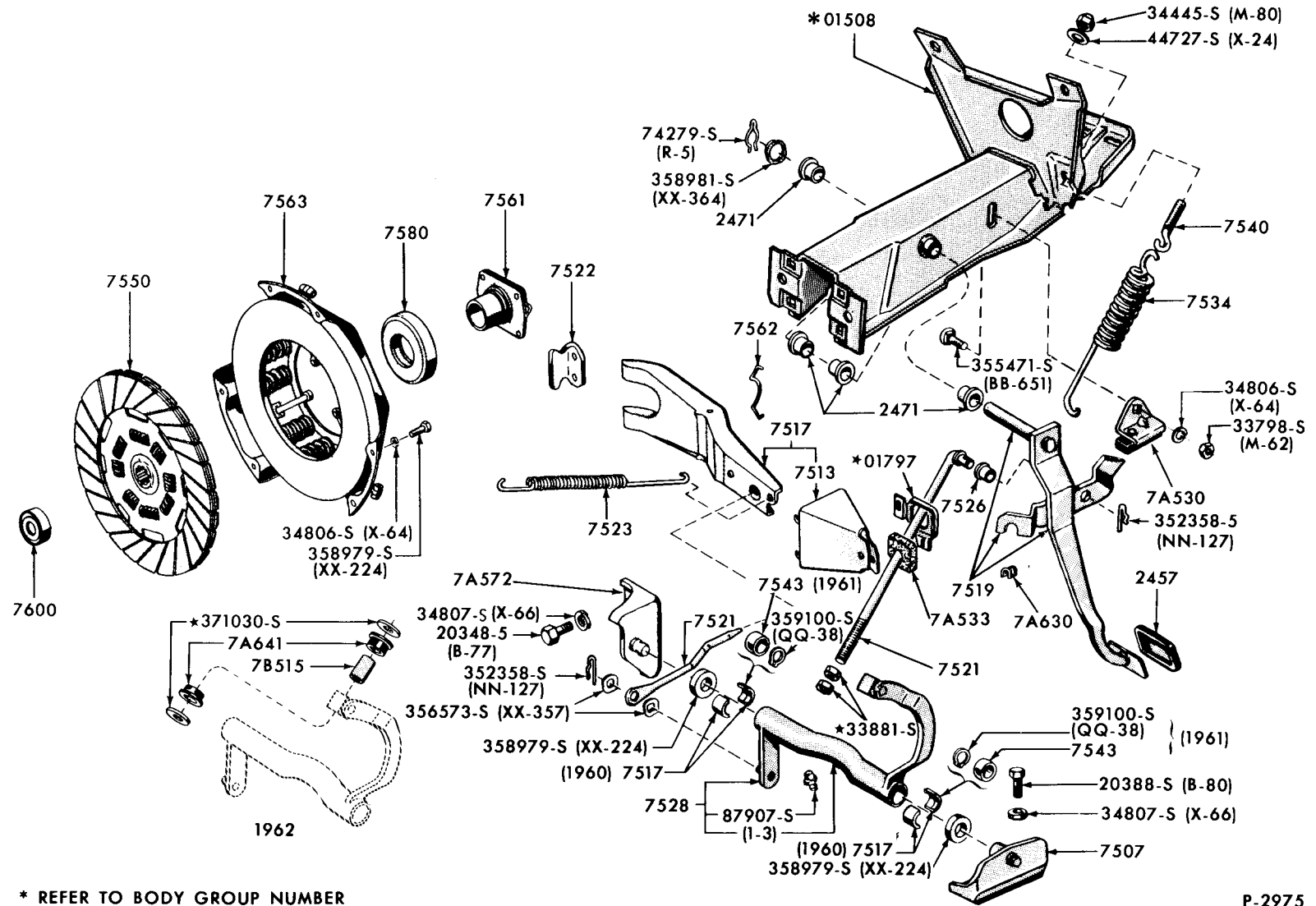

* REFER TO BODY GROUP NUMBER

P-2975

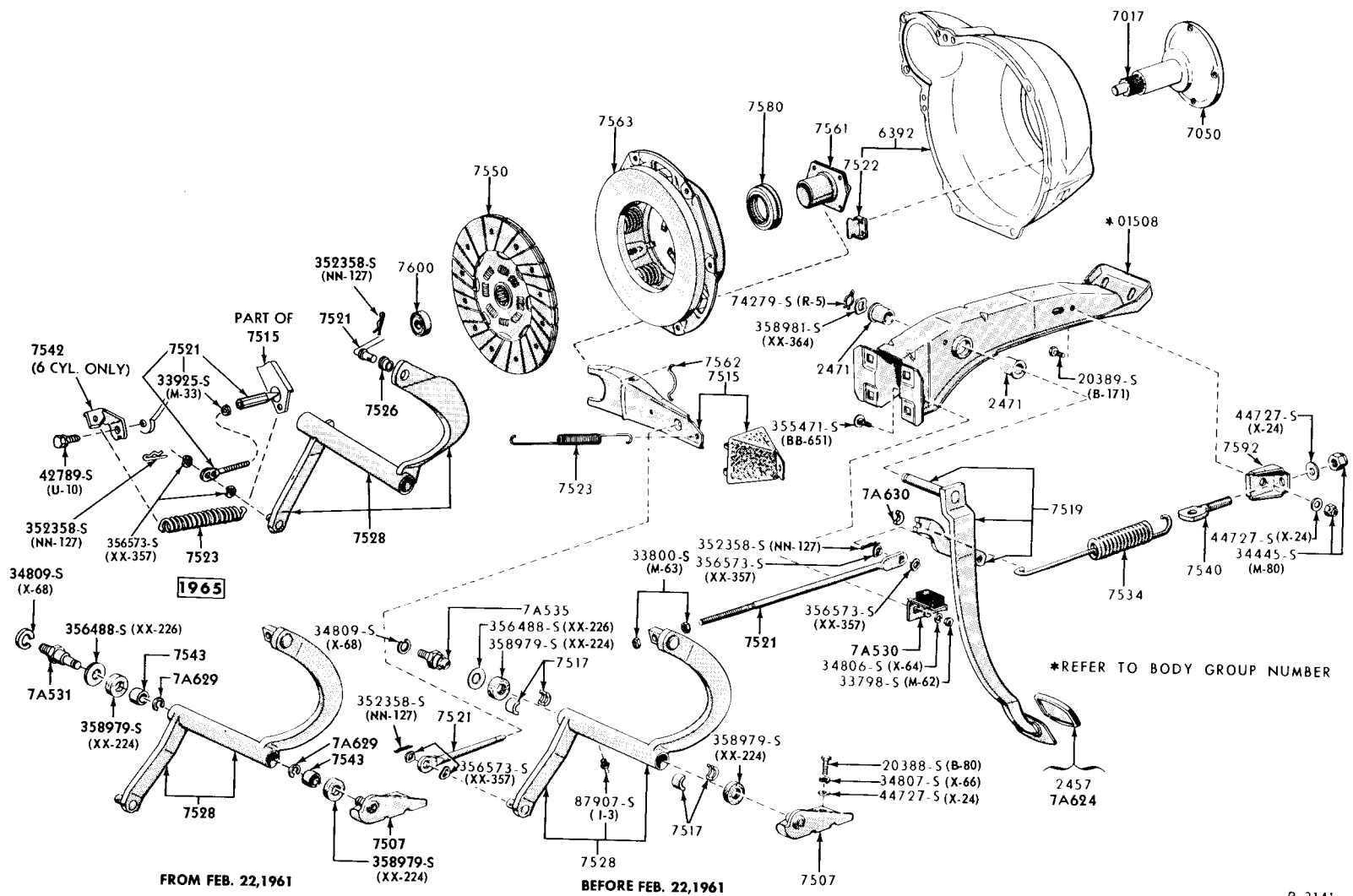

1960/ CLUTCH, CLUTCH PEDAL, ETC. (6 CYLINDER 144,170,200 ENGINES)-FALCON-TYPICAL