

INDEX

INCLUDED IN THIS INDEX ARE THE FOLLOWING MAJOR GROUPS IN THE ORDER SHOWN BELOW.

FRONT SUSPENSION
POWER STEERING SYSTEM

POWER STEERING PUMP
POWER STEERING VALVE & CYLINDER

STEERING GEAR
STEERING LINKAGE

STEERING COLUMN & SHIFT MECHANISM - AUTOMATIC
STEERING COLUMN & SHIFT MECHANISM - STANDARD & OVERDRIVE

STEERING COLUMN FOR FLOOR SHIFT
STEERING WHEEL & HORN RING

YEAR	TITLE	ILLUS. NO.	SECTION	PAGE
FRONT SUSPENSION				
1960/64	Front Suspension (Ford)	P-2983	30	68
1962/	Front Suspension (Fairlane)	P-3675	30	69
1961/62	Front Suspension (Thunderbird)	P-3274	30	70
1963/	Front Suspension (Thunderbird)	P-4400	30	71
1960/	Front Suspension (Falcon)	P-3120	30	72
POWER STEERING SYSTEM				
1960	Power Steering System (Ford-6 Cylinder)	P-2916	35	73
1960	Power Steering System (Ford-8 Cylinder)	P-2891	35	74
1961/64	Power Steering System (Ford)	P-3492	35	75
1962/	Power Steering System (Fairlane)	P-3773	35	76
1961/64	Power Steering System (Thunderbird)	P-3286	35	77
1963/64	Power Steering System (Falcon-6 & 8 cylinder)	P-4139	35	78
POWER STEERING PUMP				
1960	Power Steering Pump and Related Parts (Ford-6 cylinder)-Typical	P-2289	35	79
1960	Power Steering Pump and Related Parts (Ford-8 cylinder)	P-2203	35	80
1960/64	Power Steering Pump and Related Parts (Roll Type) (Ford, Fairlane, Falcon, Thunderbird)	P-3211	35	81
POWER STEERING VALVE and CYLINDER				
1960	Power Steering Valve and Cylinder (Ford, Thunderbird)	P-2380	35	82
1961/64	Power Steering Control Valve (Ford)-Typical	P-4179	35	83
1961/64	Power Steering Cylinder & Related Parts (Ford)-Typical	P-4180	35	83
1962/	Power Steering Control Valve (Fairlane)-Typical	P-4179	35	83
1962/	Power Steering Cylinder & Related Parts (Fairlane)-Typical	P-4180	35	83
1963/	Power Steering Control Valve (Falcon)-Typical	P-4179	35	83
1963/	Power Steering Cylinder & Related Parts (Falcon)-Typical	P-4180	35	83

INDEX

YEAR	TITLE	ILLUS. NO.	SECTION	PAGE
STEERING GEAR				
1960	Manual Steering Gear (Ford)	P-2853	35	84
1961/64	Manual Steering Gear (Ford)	P-3497	35	85
1962/	Manual Steering Gear (Fairlane)	P-3724	35	86
1960	Manual Steering Gear (Thunderbird)	P-2687	35	87
1961/64	Power Steering Gear (Thunderbird)	P-3300	35	88
1960/	Manual Steering Gear (Falcon)	P-3122	35	89
STEERING LINKAGE				
1960	Manual Steering Linkage (Ford)	P-2198	35	90
1961/64	Manual Steering Linkage (Ford)	P-3254	35	91
1960	Power Steering Linkage (Ford)	P-2202	35	92
1961/64	Power Steering Linkage (Ford)	P-3492	35	75
1962/	Manual Steering Linkage (Fairlane)-6 & 8 cylinder	P-3669	35	93
1962/	Power Steering Linkage (Fairlane)	P-3773	35	76
1960	Manual Steering Linkage (Thunderbird)	P-1593	35	94
1960	Power Steering Linkage (Thunderbird)	P-2201	35	95
1961/64	Power Steering Linkage (Thunderbird)	P-3286	35	77
1960/	Manual Steering Linkage (Falcon)-6 cylinder	P-3121	35	96
1963/64	Manual Steering Linkage (Falcon)-8 cylinder	P-4258	35	97
STEERING COLUMN and SHIFT MECHANISM - AUTOMATIC				
REFER TO ILLUSTRATION SECTION A72				
STEERING COLUMN and SHIFT MECHANISM - STANDARD & OVERDRIVE				
REFER TO ILLUSTRATION SECTION 72				
STEERING COLUMN FOR FLOOR SHIFT				
1962	Steering Column for all Transmissions with Floor Shift (Ford-Galaxie 500-XL)	P-3893	35	98
1963/64	Steering Column for all Transmissions with Floor Shift (Ford-Galaxie 500-XL)	P-4237	35	99
1962/	Steering Column for Floor Shift (Fairlane)	P-3724	35	86
1962/64	Steering Column for Floor Shift (Falcon)	P-3898	35	100
STEERING WHEEL and HORN RING				
1960	Steering Wheel & Horn Ring (Ford)	P-2986	35	101
1961/64	Steering Wheel & Horn Ring (Ford)-Typical	P-3299	35	102
1962/64	Steering Wheel & Horn Ring (Ford-Galaxie 500-XL)	P-3816	35	103
1962/64	Steering Wheel & Horn Ring (Fairlane)	P-3714	35	104
1960	Steering Wheel & Horn Ring (Thunderbird)	P-2686	35	105
1961/63	Steering Wheel & Horn Ring (Thunderbird) - Typical	P-3365	35	105
1964	Steering Wheel & Horn Ring (Thunderbird)	P-4544	35	106
1960/63	Steering Wheel & Horn Ring (Falcon)	P-3117	35	107
1964	Steering Wheel & Horn Ring (Falcon)	P-4515	35	108

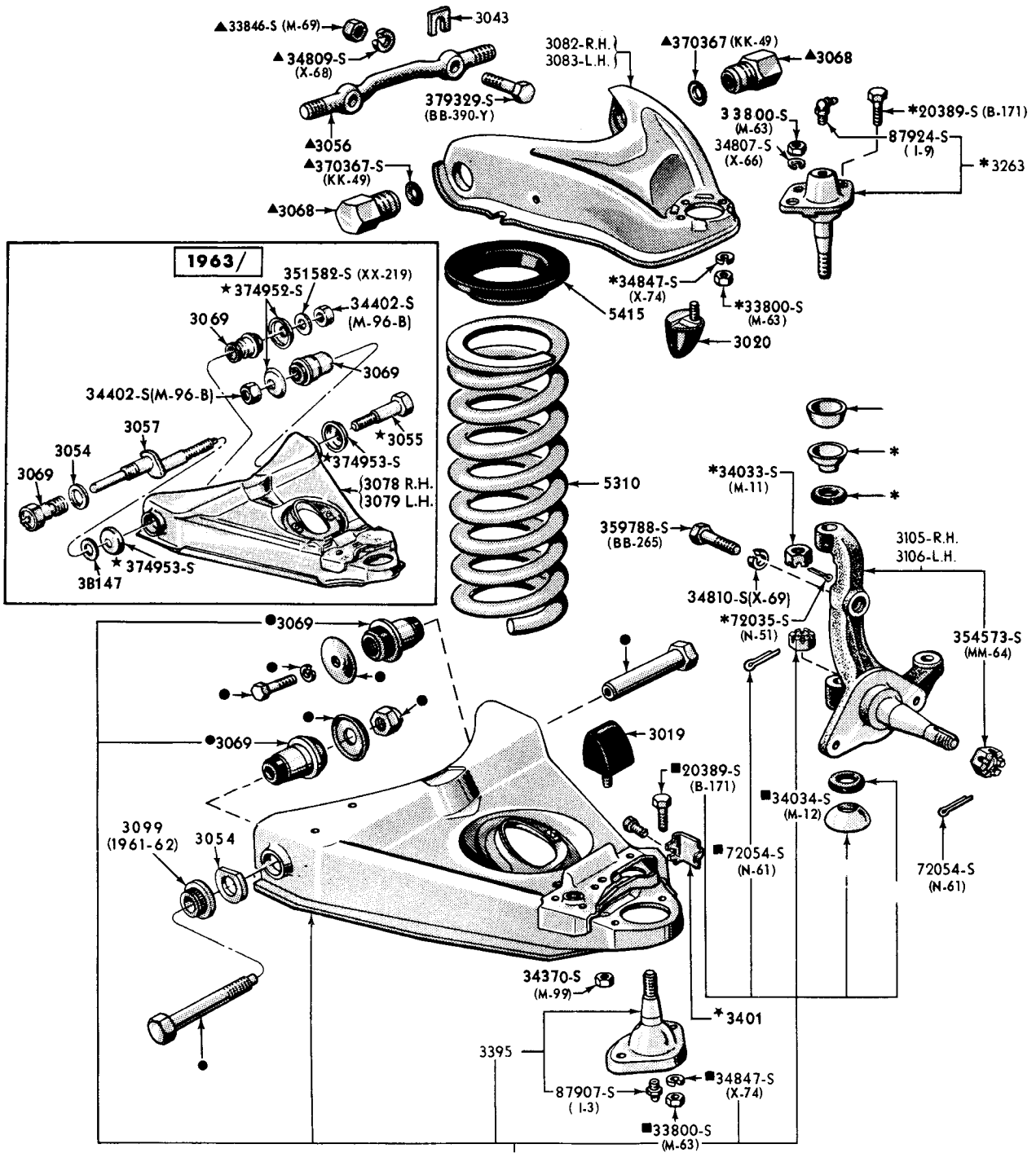

- ▲ SUPPLIED IN 3047 UPPER SHAFT KIT
- SUPPLIED IN 3048 LOWER SHAFT KIT
- * SUPPLIED IN 3049 UPPER SPINDLE SUPPORT KIT
- SUPPLIED IN 3050 LOWER SPINDLE SUPPORT KIT
- ◆ SUPPLIED IN 3078 R.H. & 3079 L.H. ARM ASS'Y.

3078-R.H.
3079-L.H.

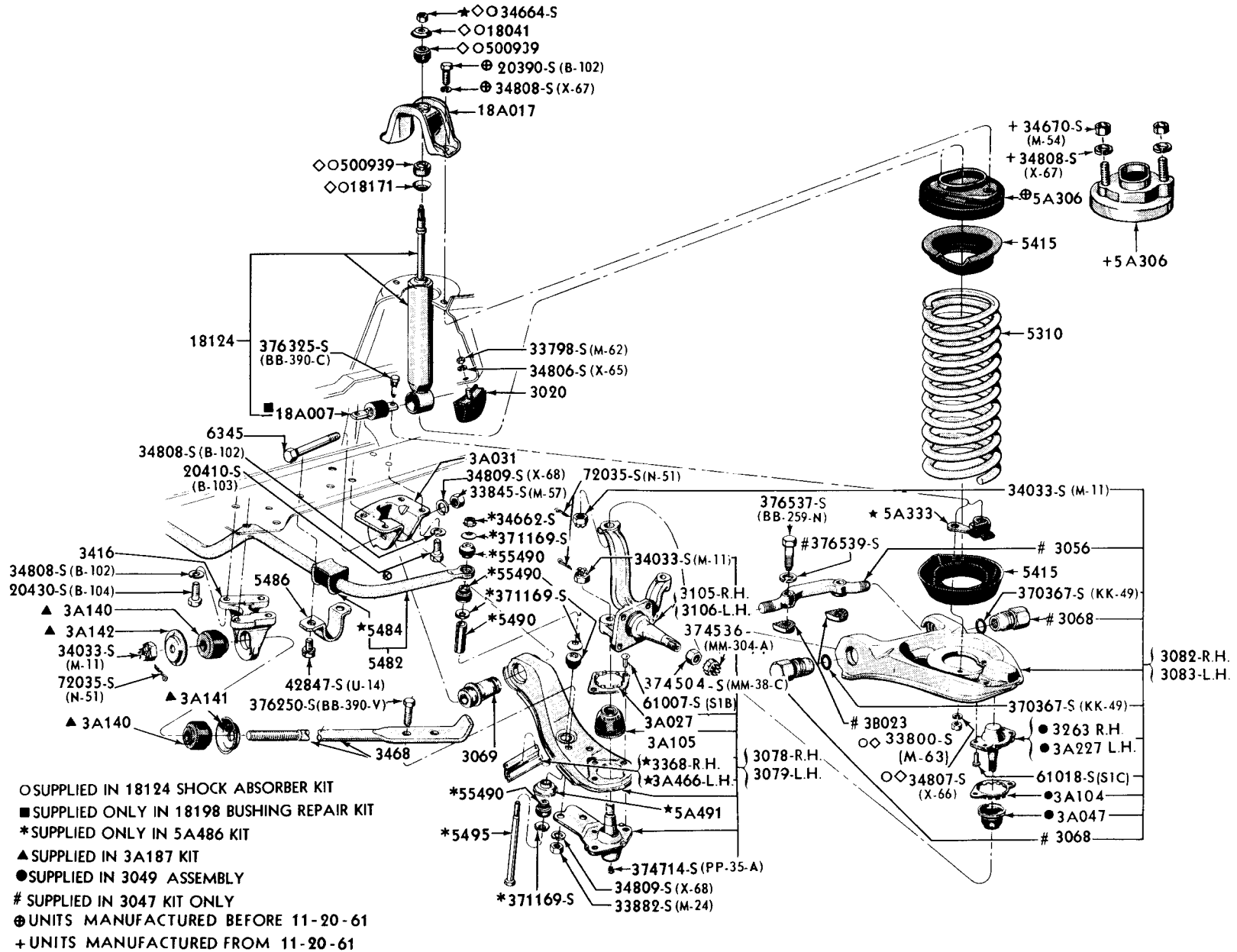

- SUPPLIED IN 18124 SHOCK ABSORBER KIT
- SUPPLIED ONLY IN 18198 BUSHING REPAIR KIT
- * SUPPLIED ONLY IN 5A486 KIT
- ▲ SUPPLIED IN 3A187 KIT
- SUPPLIED IN 3049 ASSEMBLY
- # SUPPLIED IN 3047 KIT ONLY
- ⊕ UNITS MANUFACTURED BEFORE 11-20-61
- + UNITS MANUFACTURED FROM 11-20-61

ILLUSTRATION SECTION 30

FORD CAR PARTS

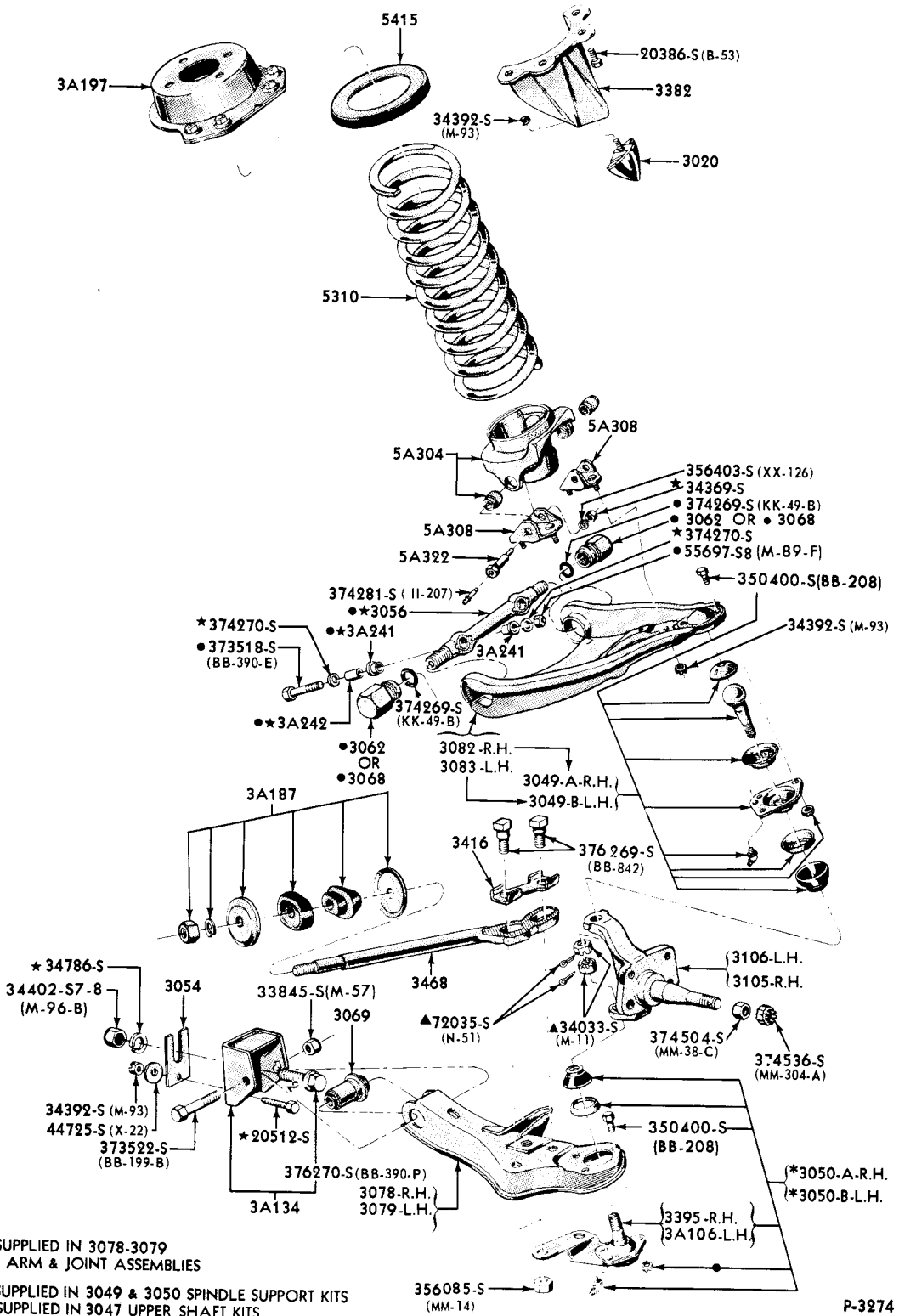

* ALSO SUPPLIED IN 3078-3079 LOWER ARM & JOINT ASSEMBLIES

▲ ALSO SUPPLIED IN 3049 & 3050 SPINDLE SUPPORT KITS

● ALSO SUPPLIED IN 3047 UPPER SHAFT KITS

■ ALSO SUPPLIED IN 3049 UPPER ARM BALL JOINT ASSEMBLY

△ ALSO SUPPLIED IN 3082 & 3083 UPPER ARM AND JOINT ASSEMBLIES

P-3274

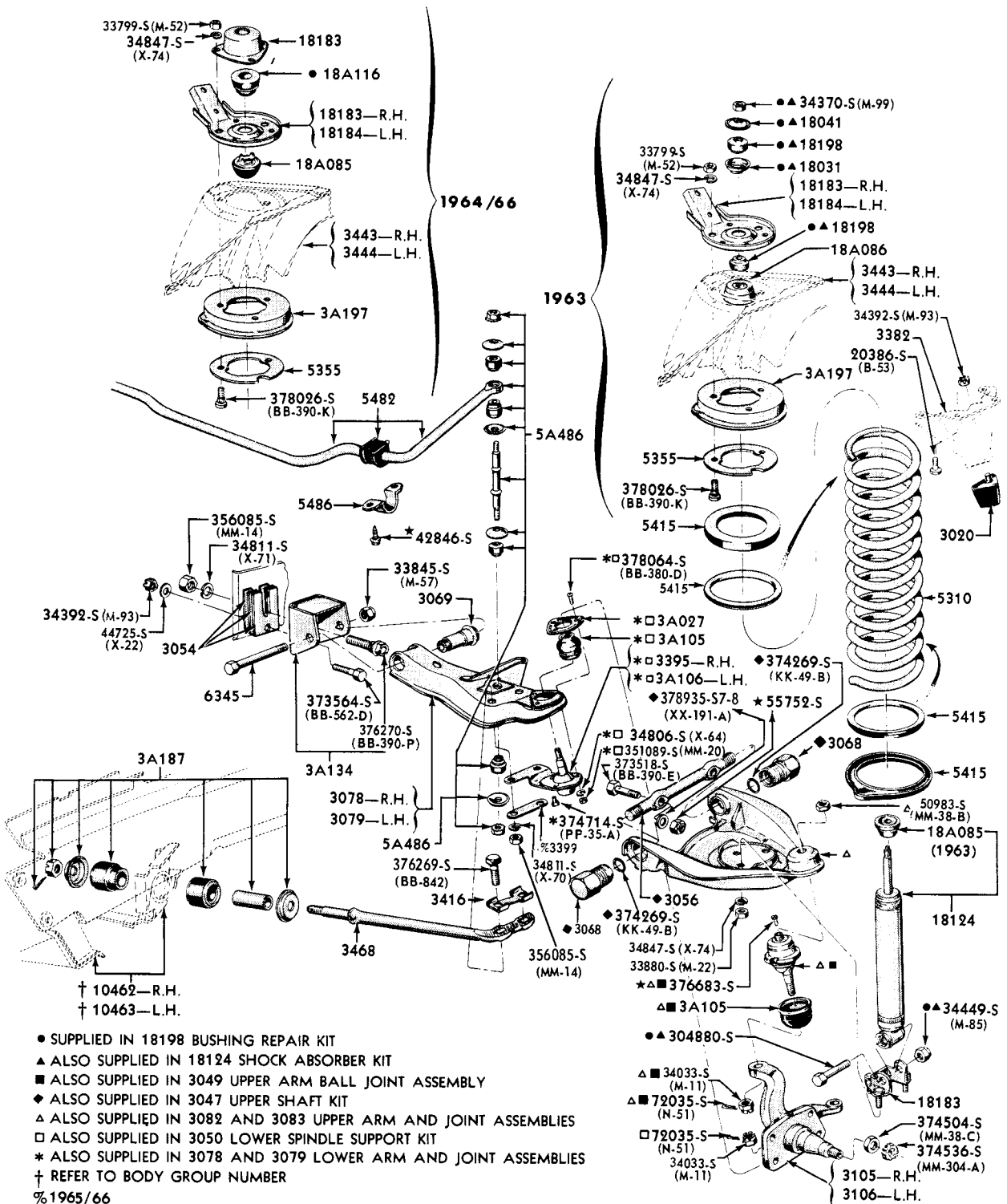

P.4400

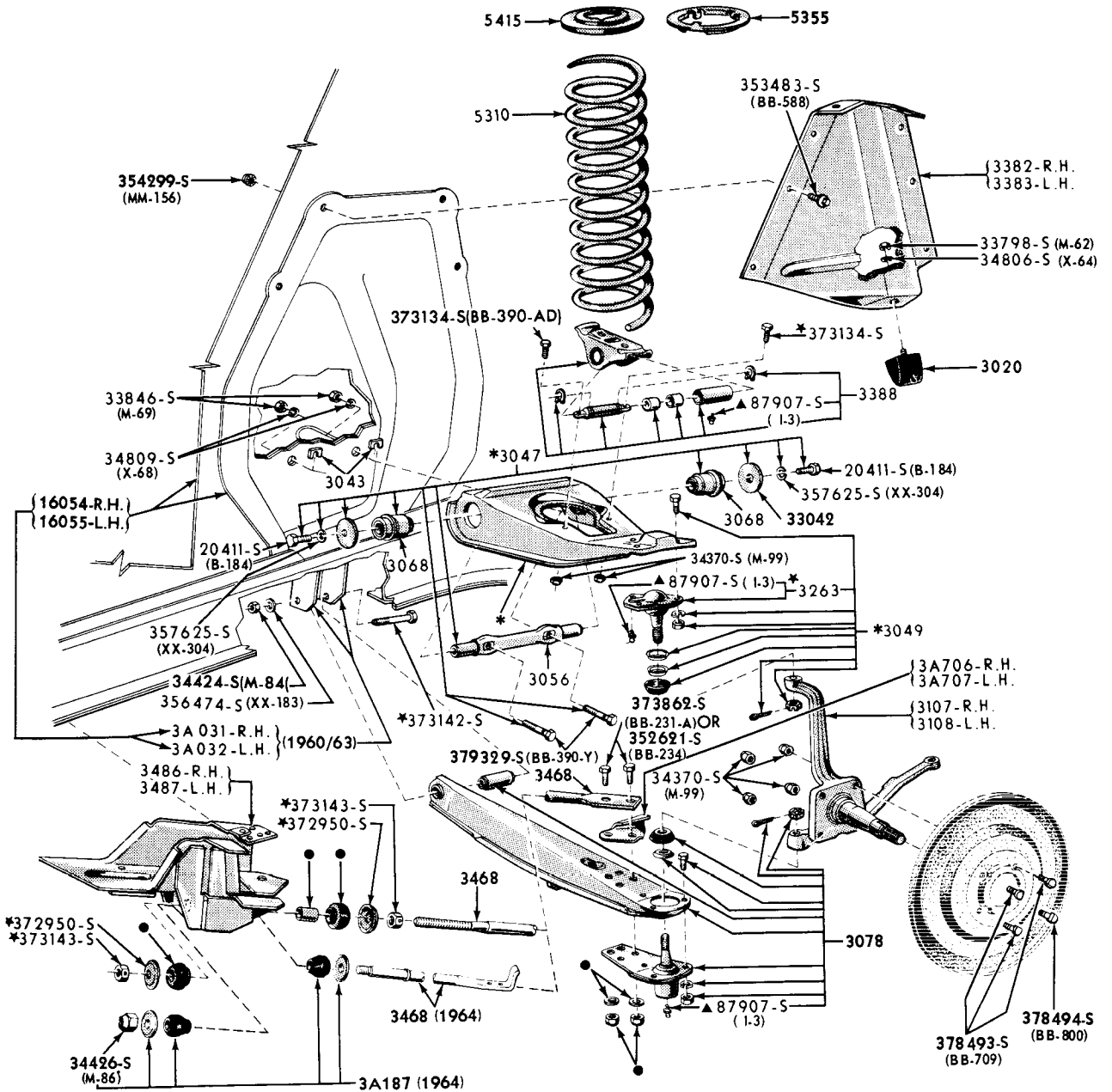

*ALSO SUPPLIED IN 3082 UPPER ARM, SHAFT & JOINT ASSEMBLY
 ● SUPPLIED IN 3468 LOWER ARM STRUT REPAIR KIT
 ▲ 1963/ REPLACED BY 374714.S (PP.35-A) PLUG

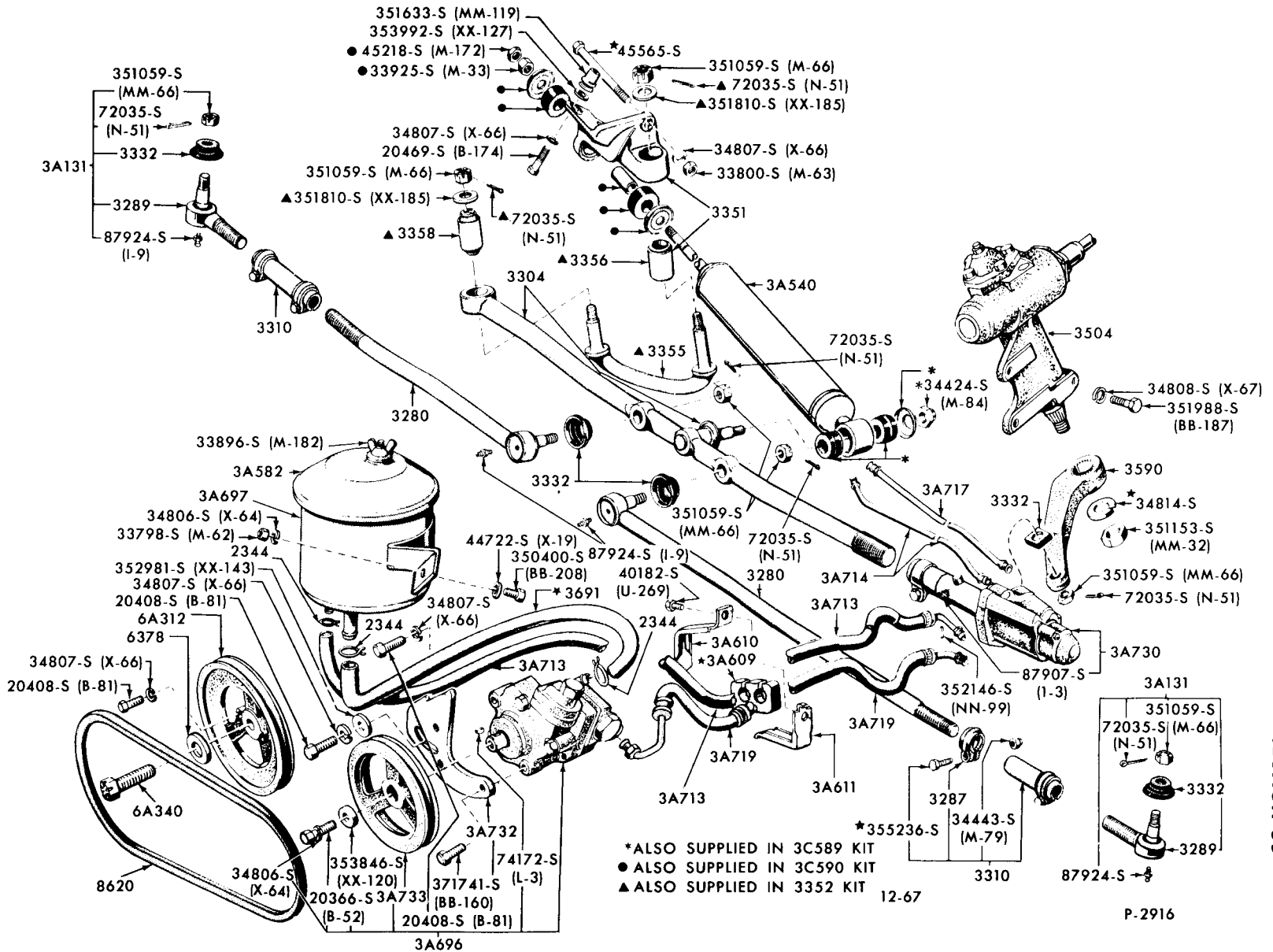

■ SUPPLIED IN 3C651 BOOT & INSULATOR KIT
 ▲ ALSO SUPPLIED IN 3A691 PUMP ASSEMBLY
 * SUPPLIED ONLY IN 3A730 VALVE ASSEMBLY
 ▲ ALSO SUPPLIED IN 3C651 BOOT & INSULATOR KIT

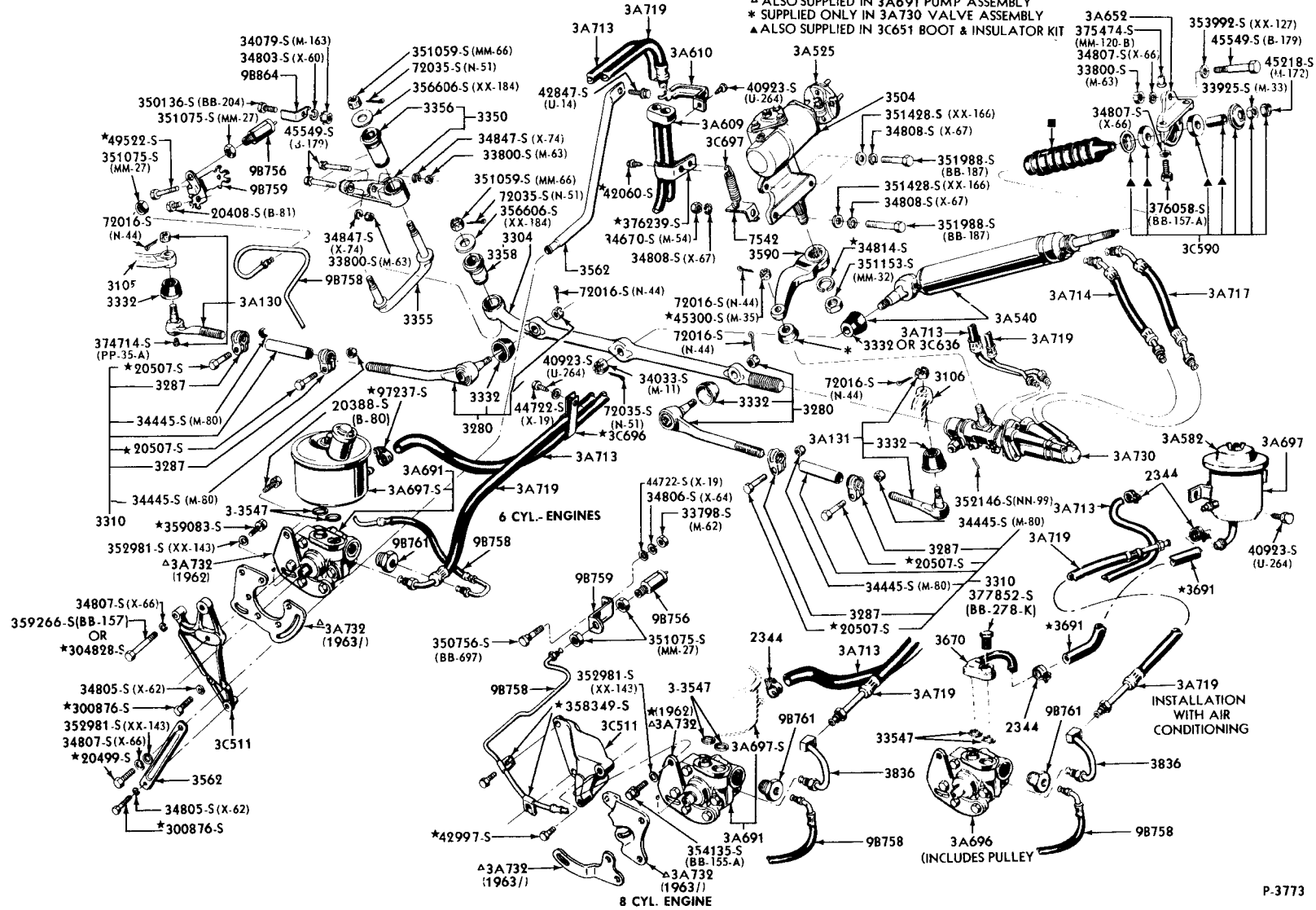

1932 / POWER STEERING SYSTEM (FAIRLANE)

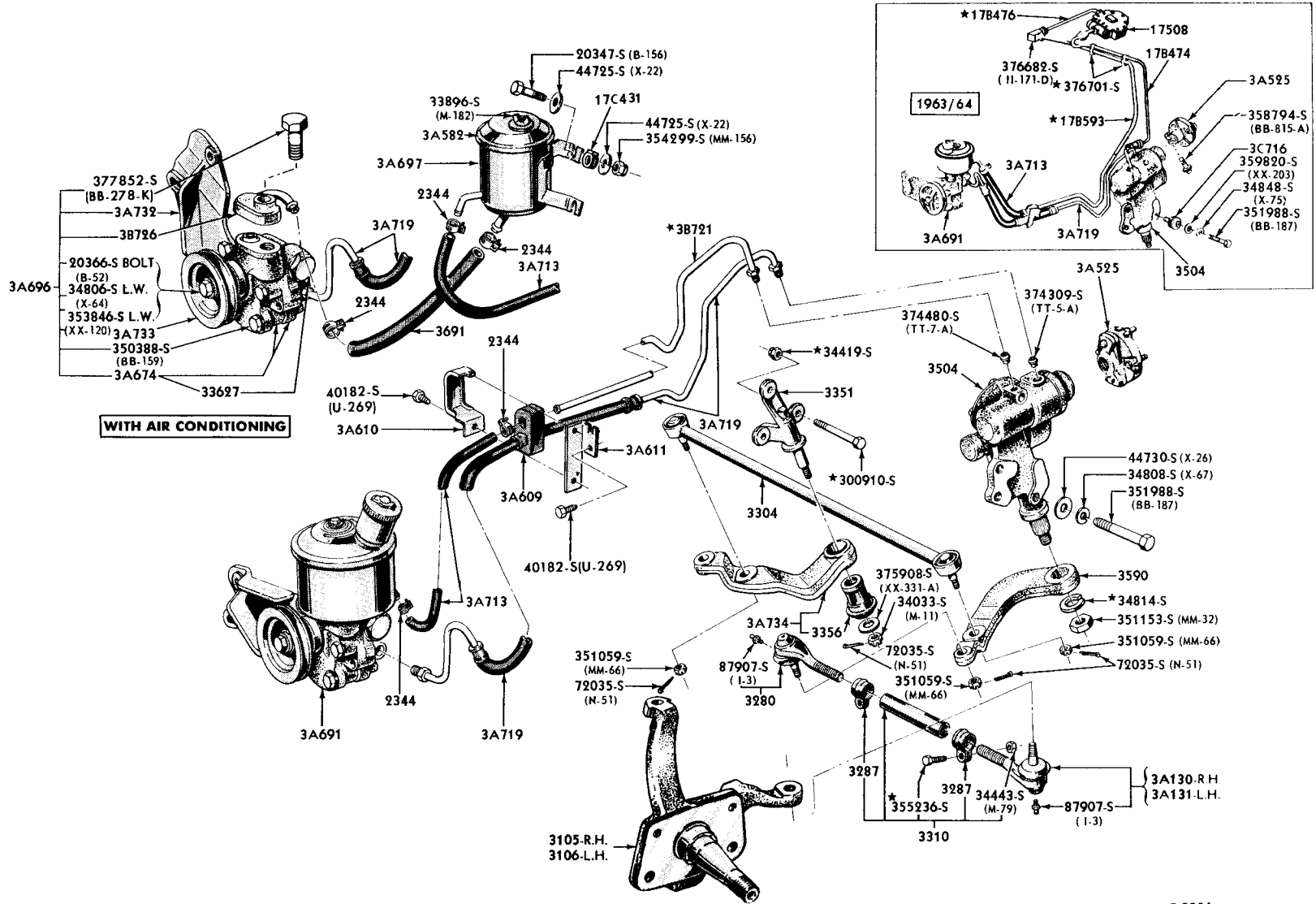

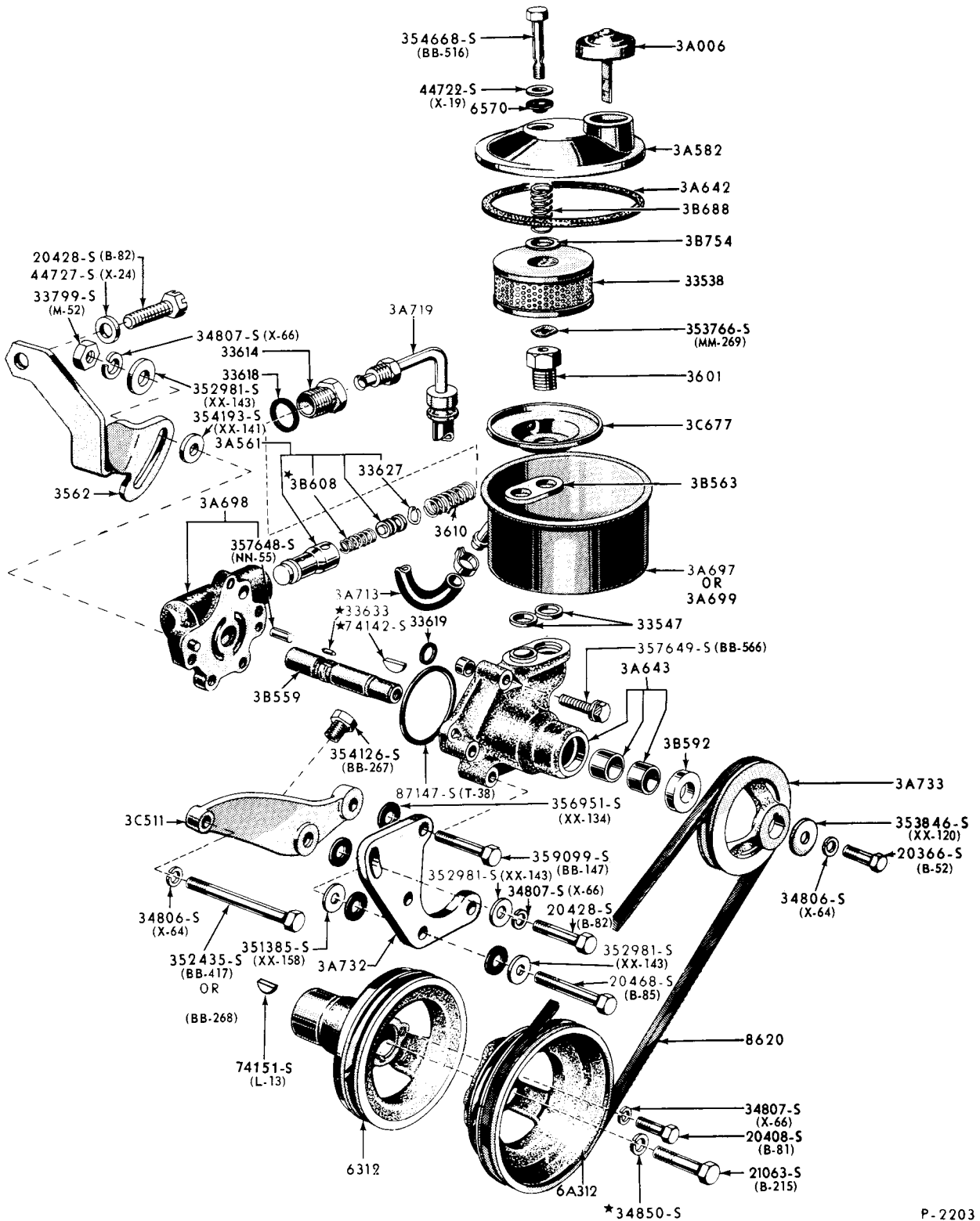

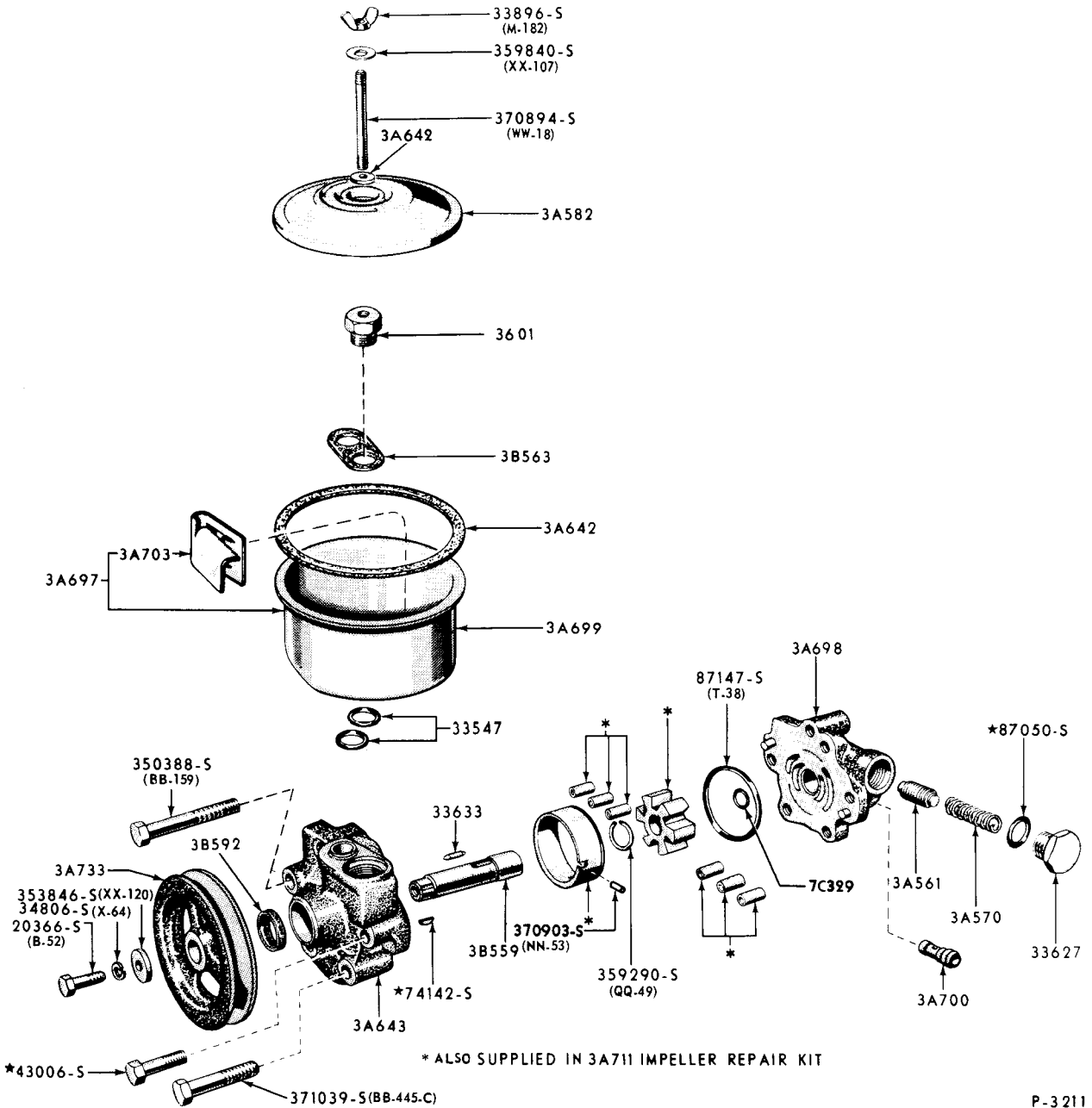

P-3211

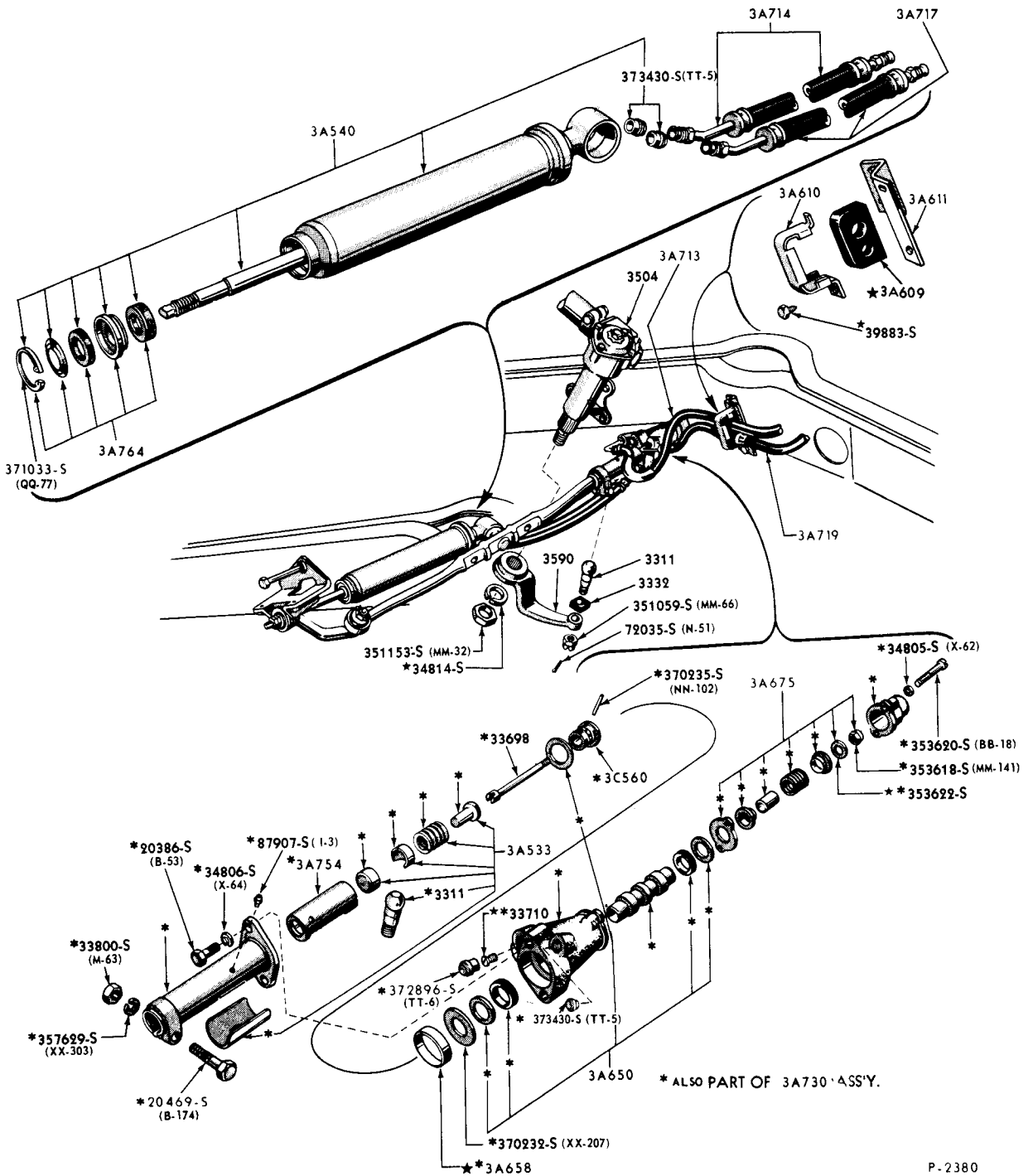
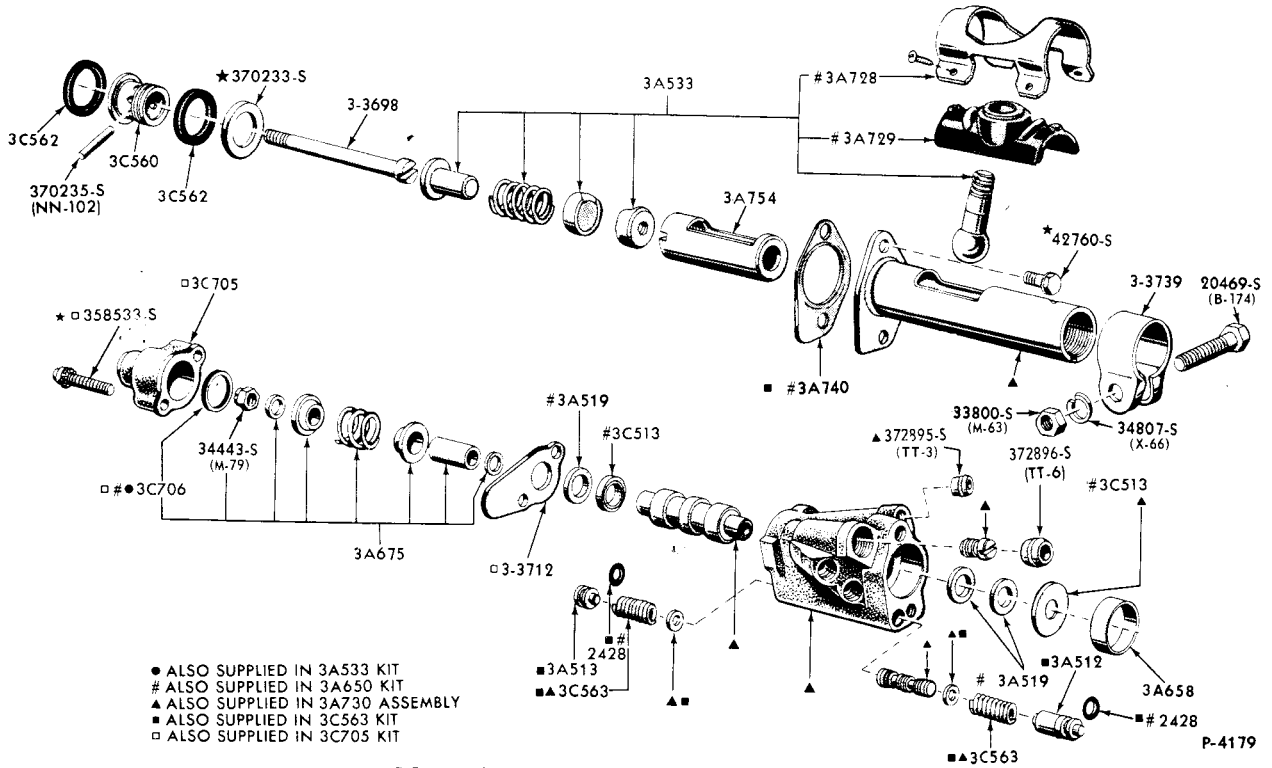
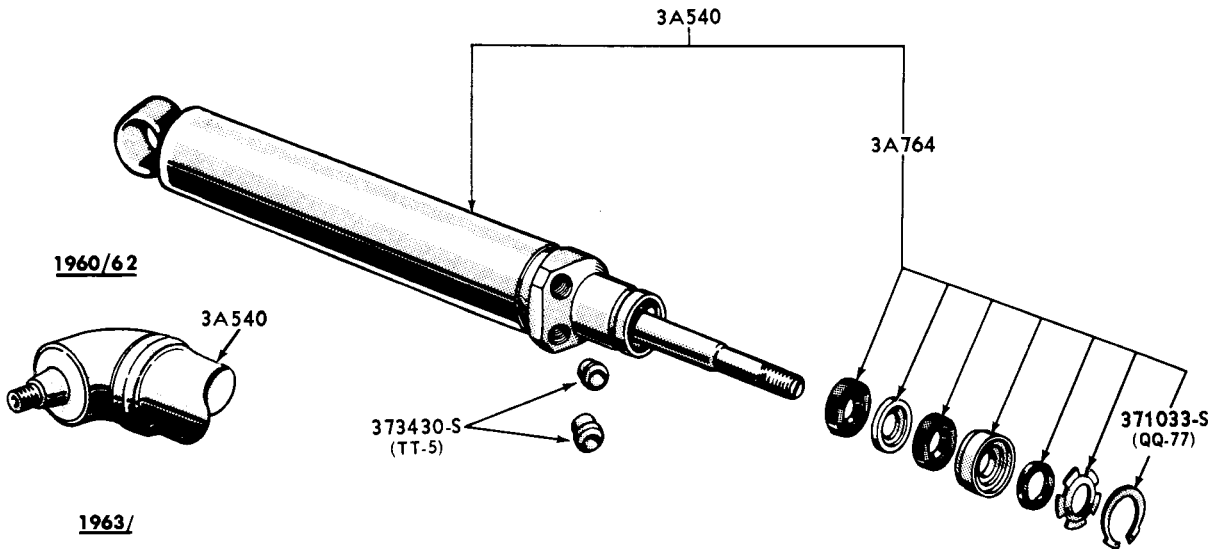

ILLUSTRATION SECTION 35



POWER STEERING CONTROL VALVE - TYPICAL

1961/64 FORD 1962/ FAIRLANE 1963/ FALCON



POWER STEERING CYLINDER and RELATED PARTS - TYPICAL

1961/64 FORD 1962/ FAIRLANE 1963/ FALCON

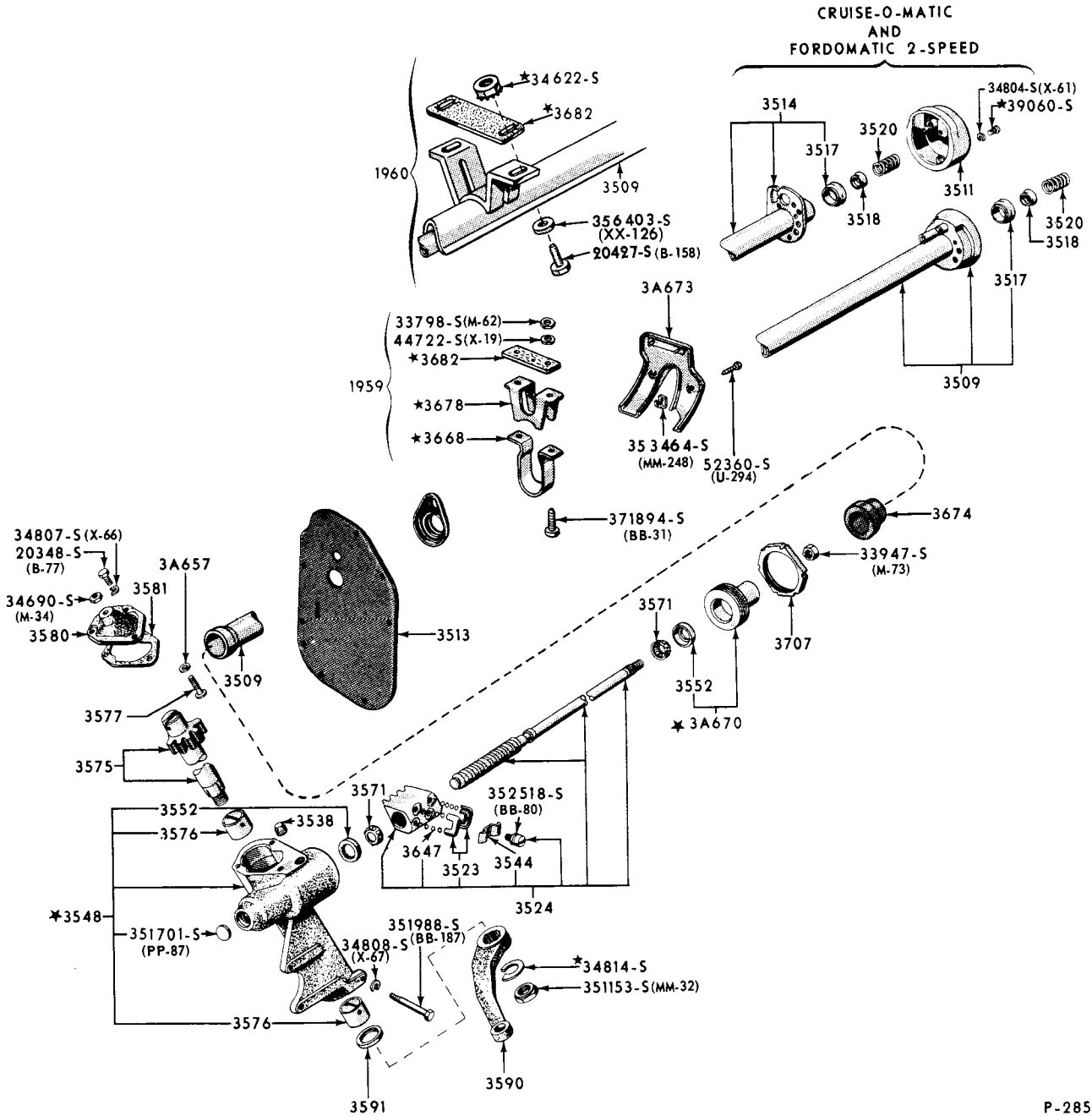

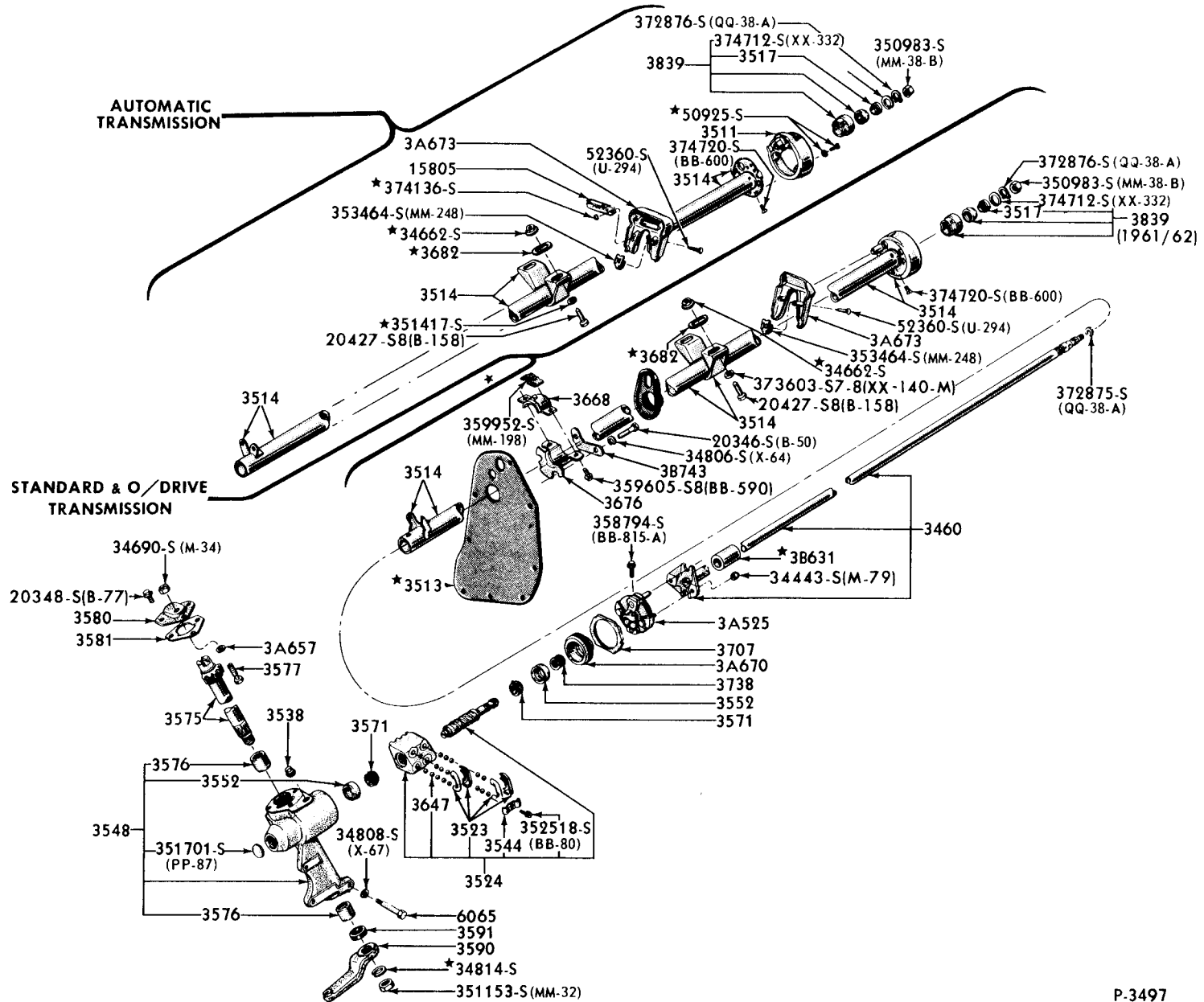

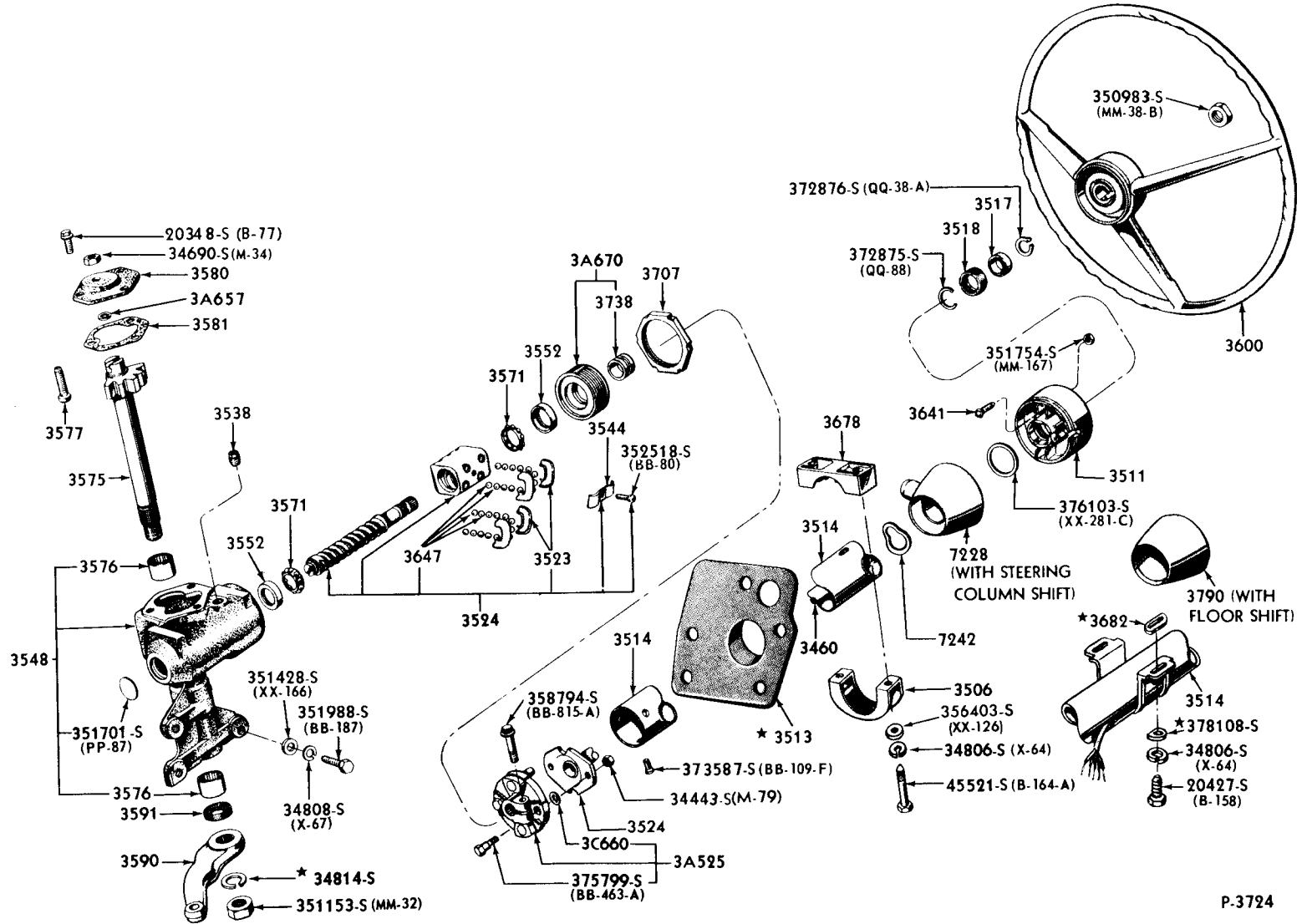

P-3724

1962 / 1962 / MANUAL STEERING GEAR (FAIRLANE)
STEERING COLUMN FOR FLOOR SHIFT (FAIRLANE)

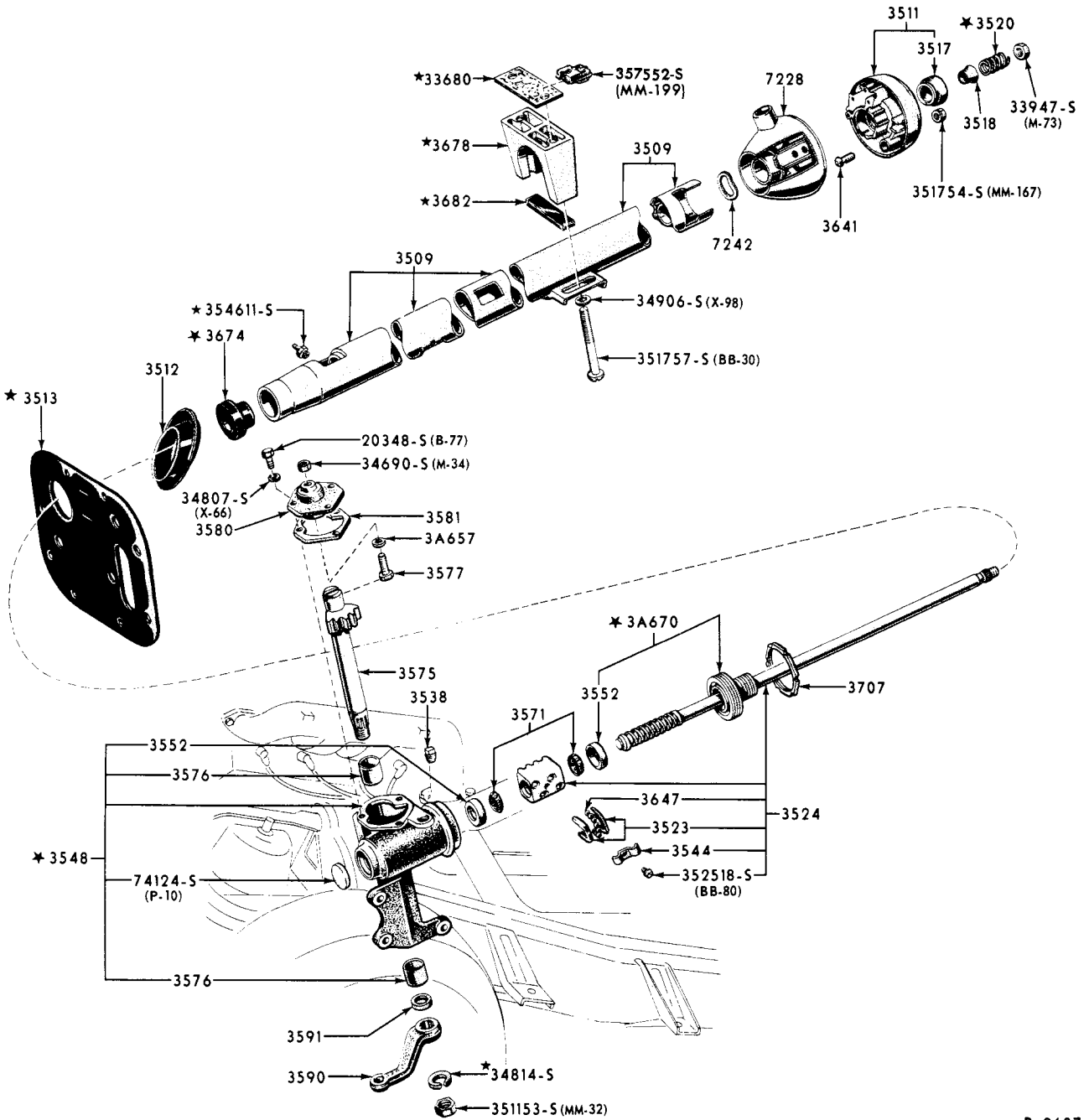

1961/64 POWER STEERING GEAR (THUNDERBIRD)

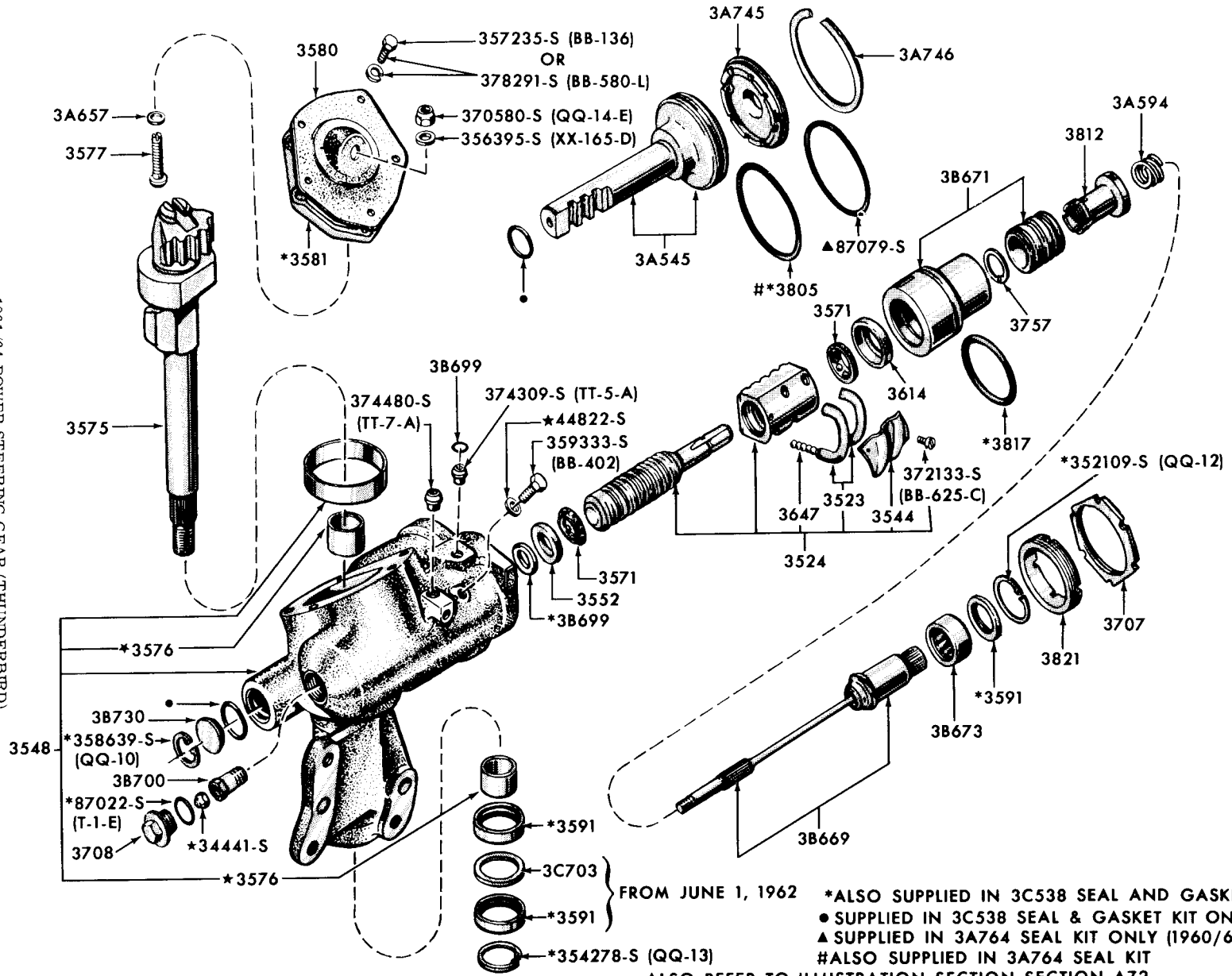

FROM JUNE 1, 1962

- *ALSO SUPPLIED IN 3C538 SEAL AND GASKET KIT
- SUPPLIED IN 3C538 SEAL & GASKET KIT ONLY
- ▲ SUPPLIED IN 3A764 SEAL KIT ONLY (1960/61)
- #ALSO SUPPLIED IN 3A764 SEAL KIT

ALSO REFER TO ILLUSTRATION SECTION SECTION A72

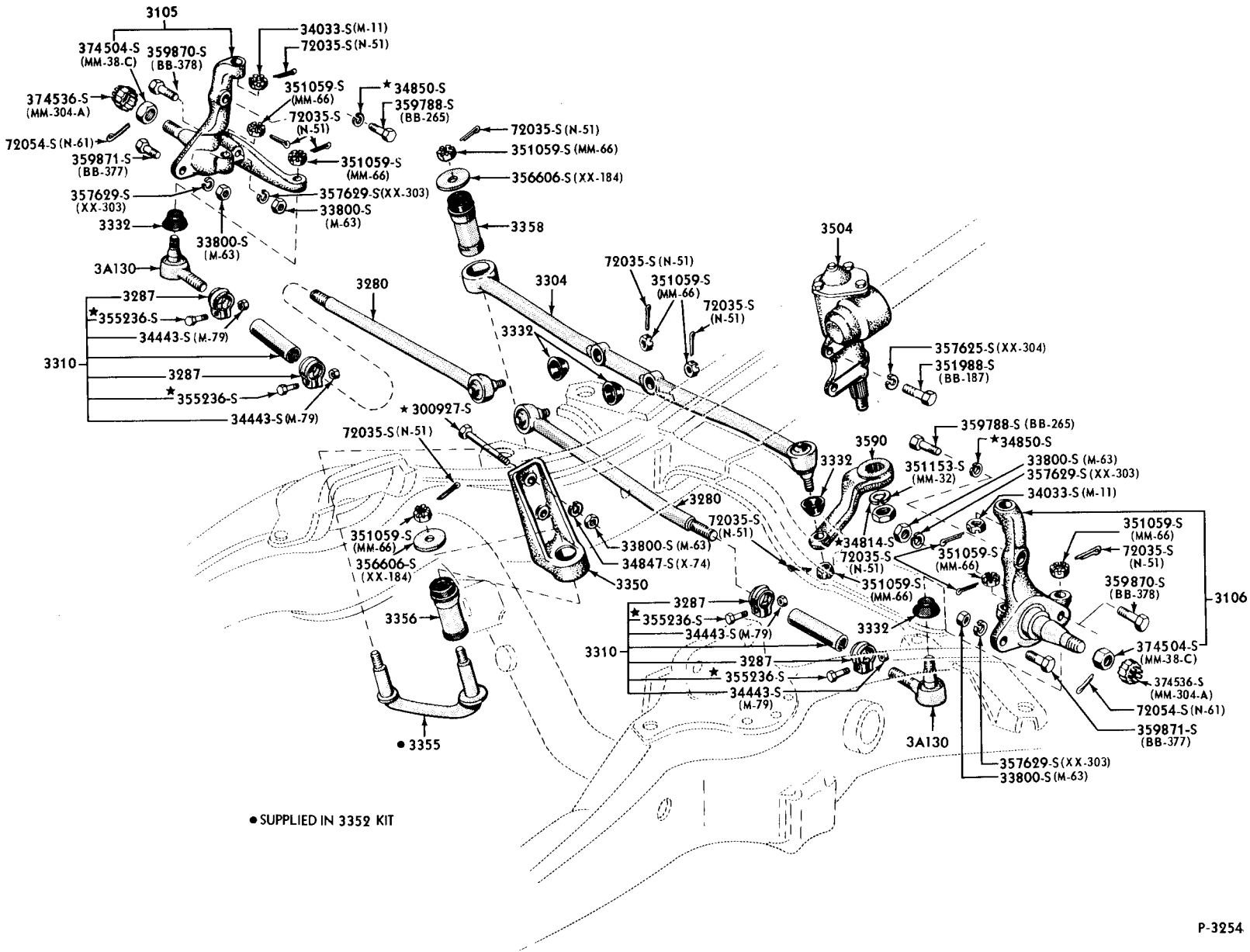

● SUPPLIED IN 3352 KIT

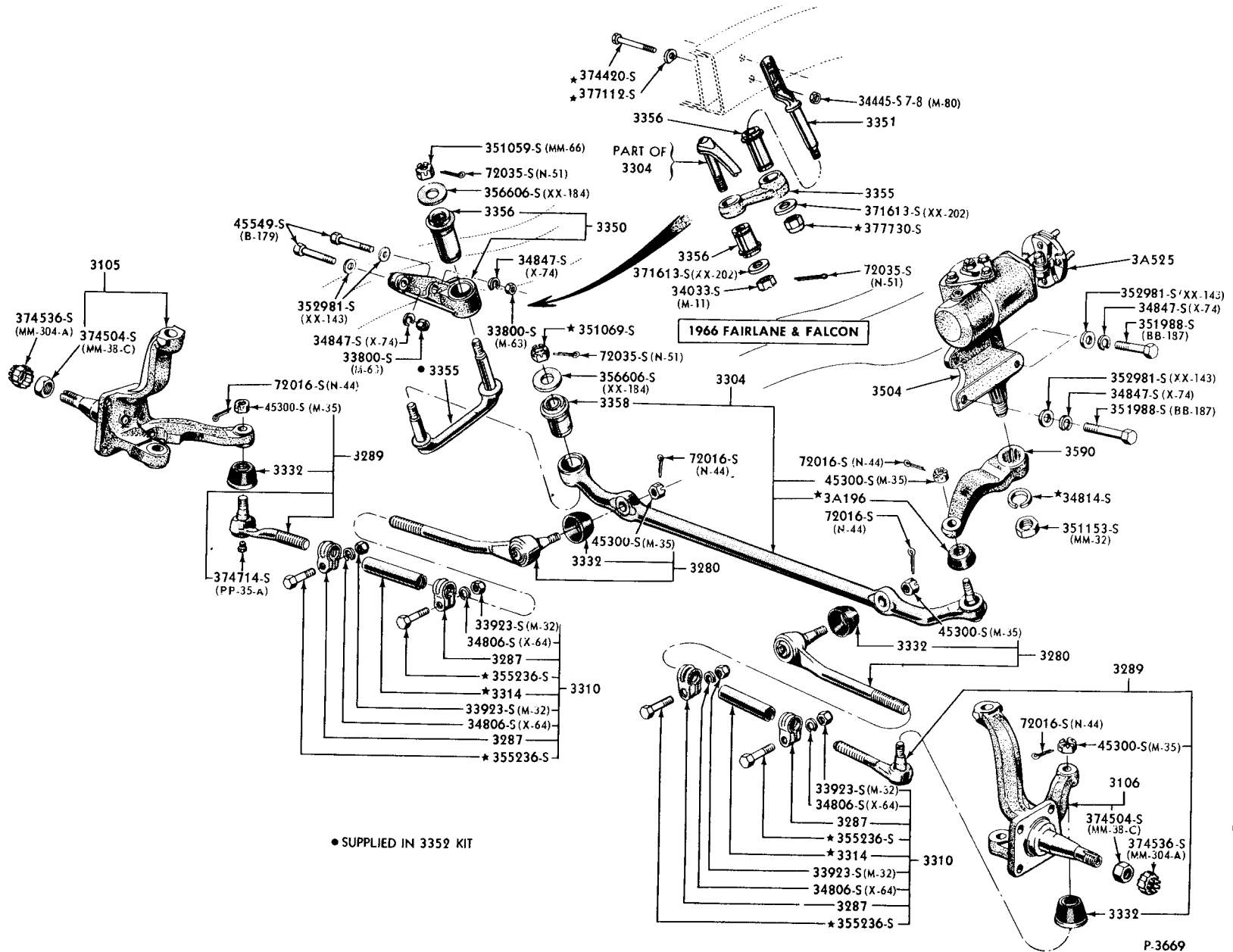

1960 MANUAL STEERING LINKAGE (THUNDERBIRD)

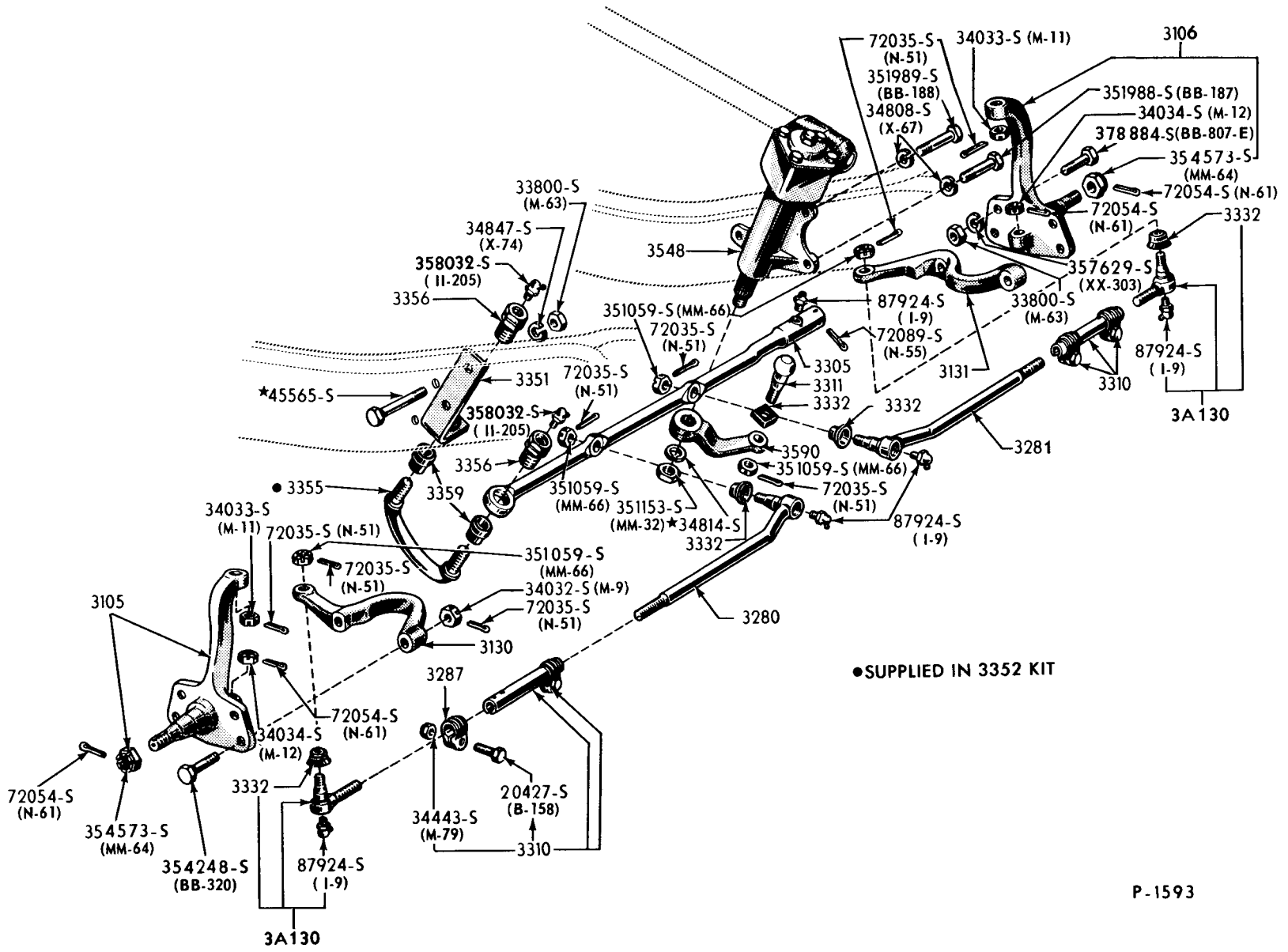

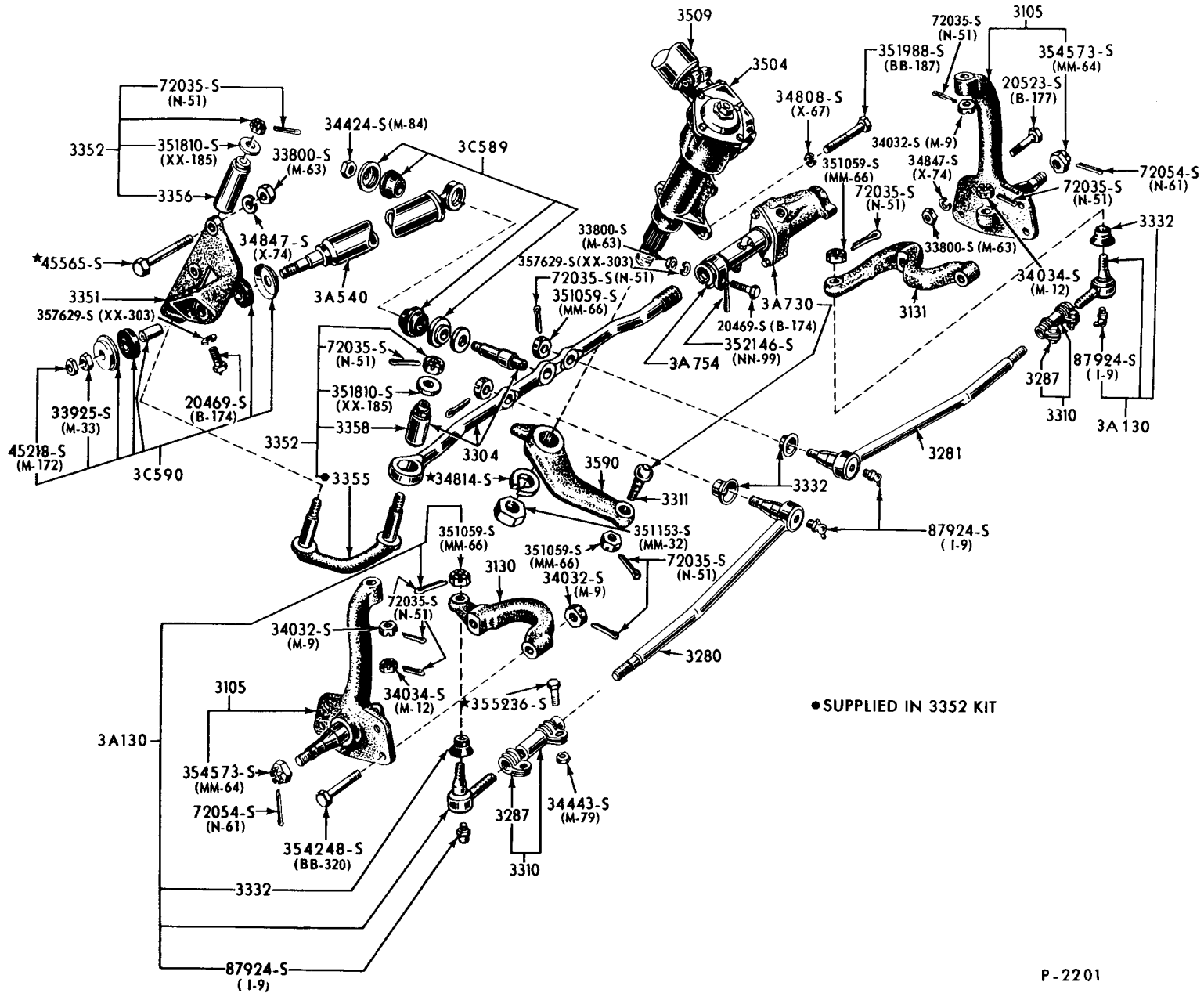

1960 / MANUAL STEERING LINKAGE (FALCON-6 CYLINDER)

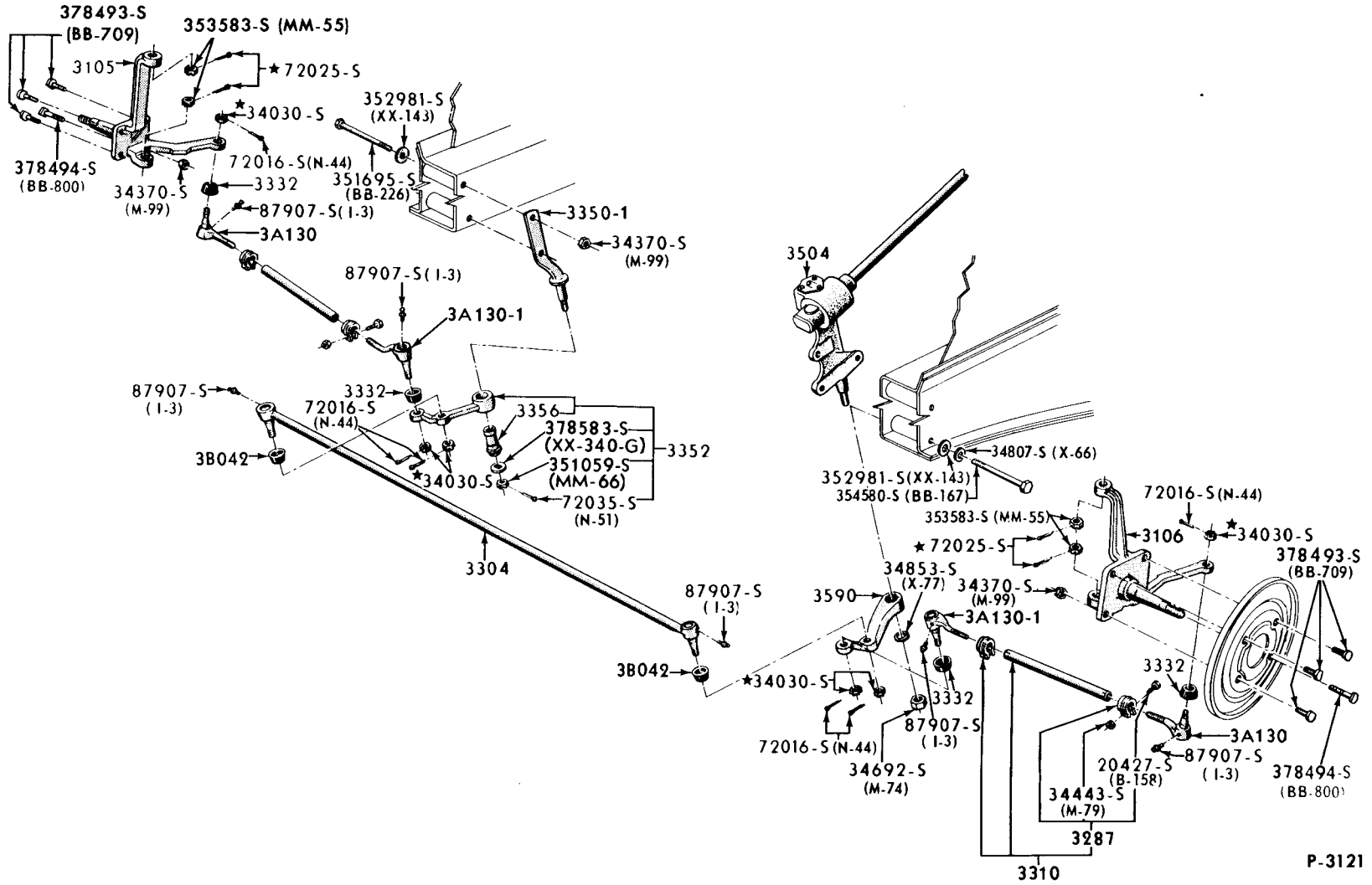

P-3121

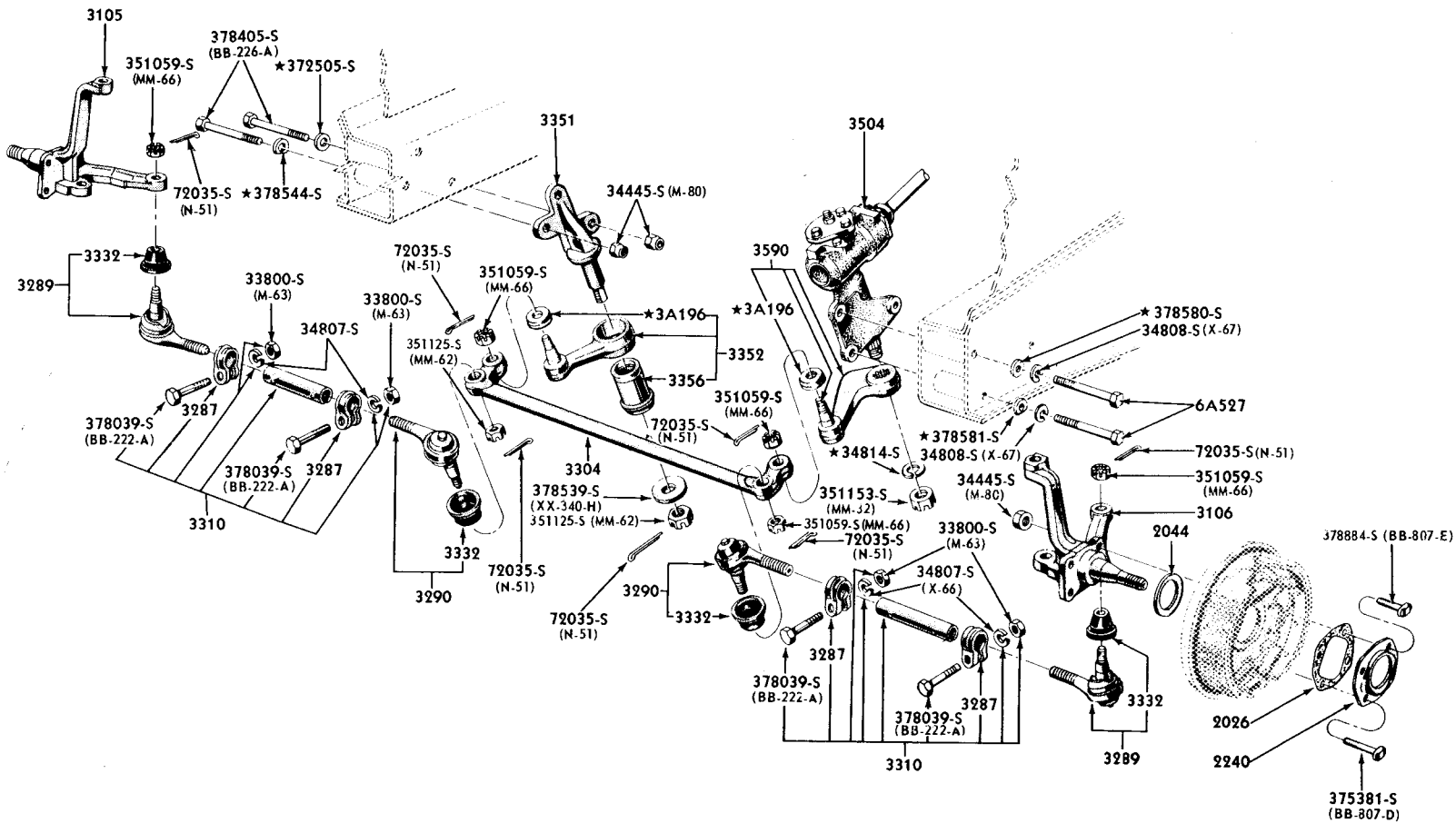

P-4258

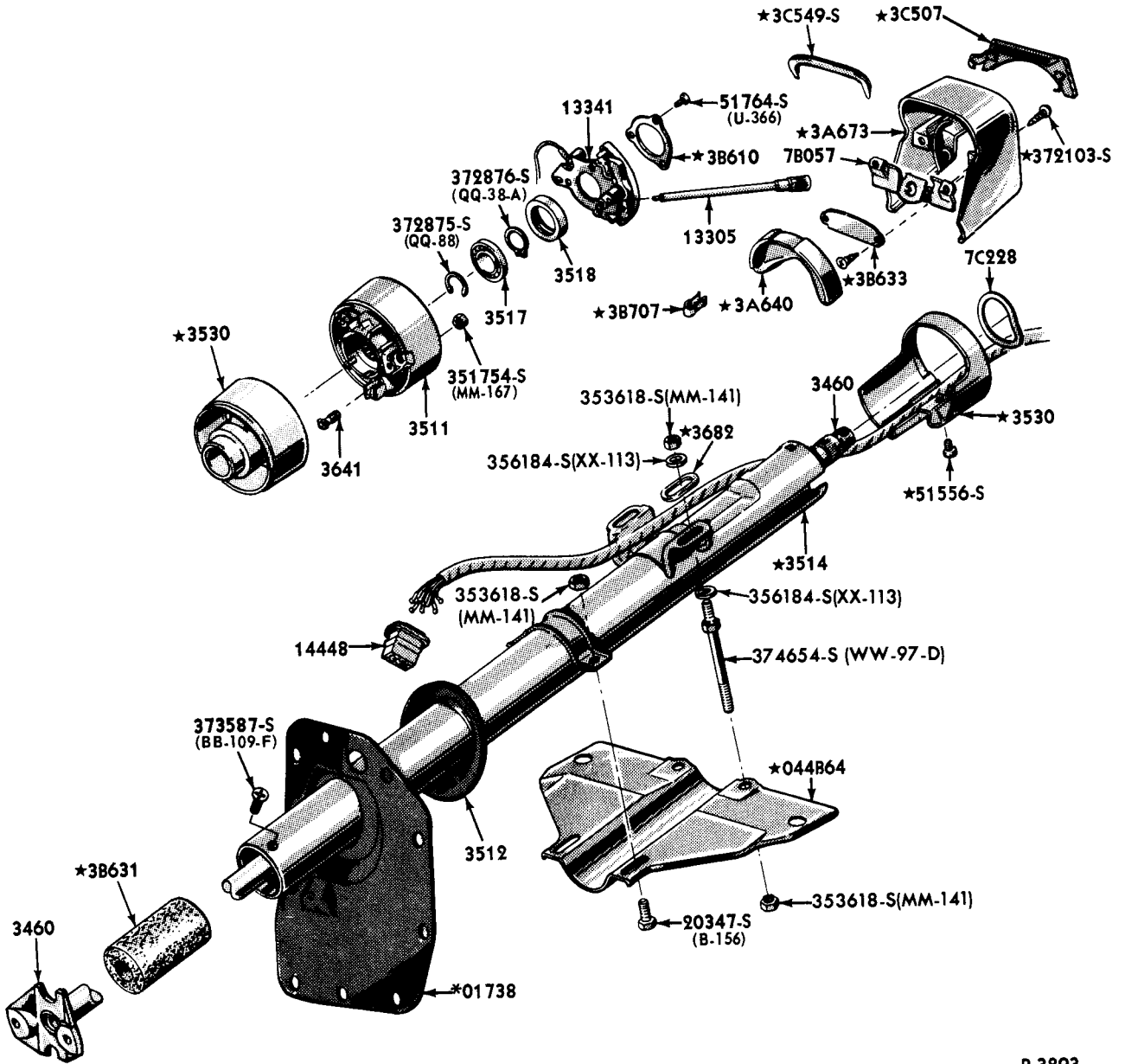

*REFER TO BODY GROUP NUMBER

P-3893

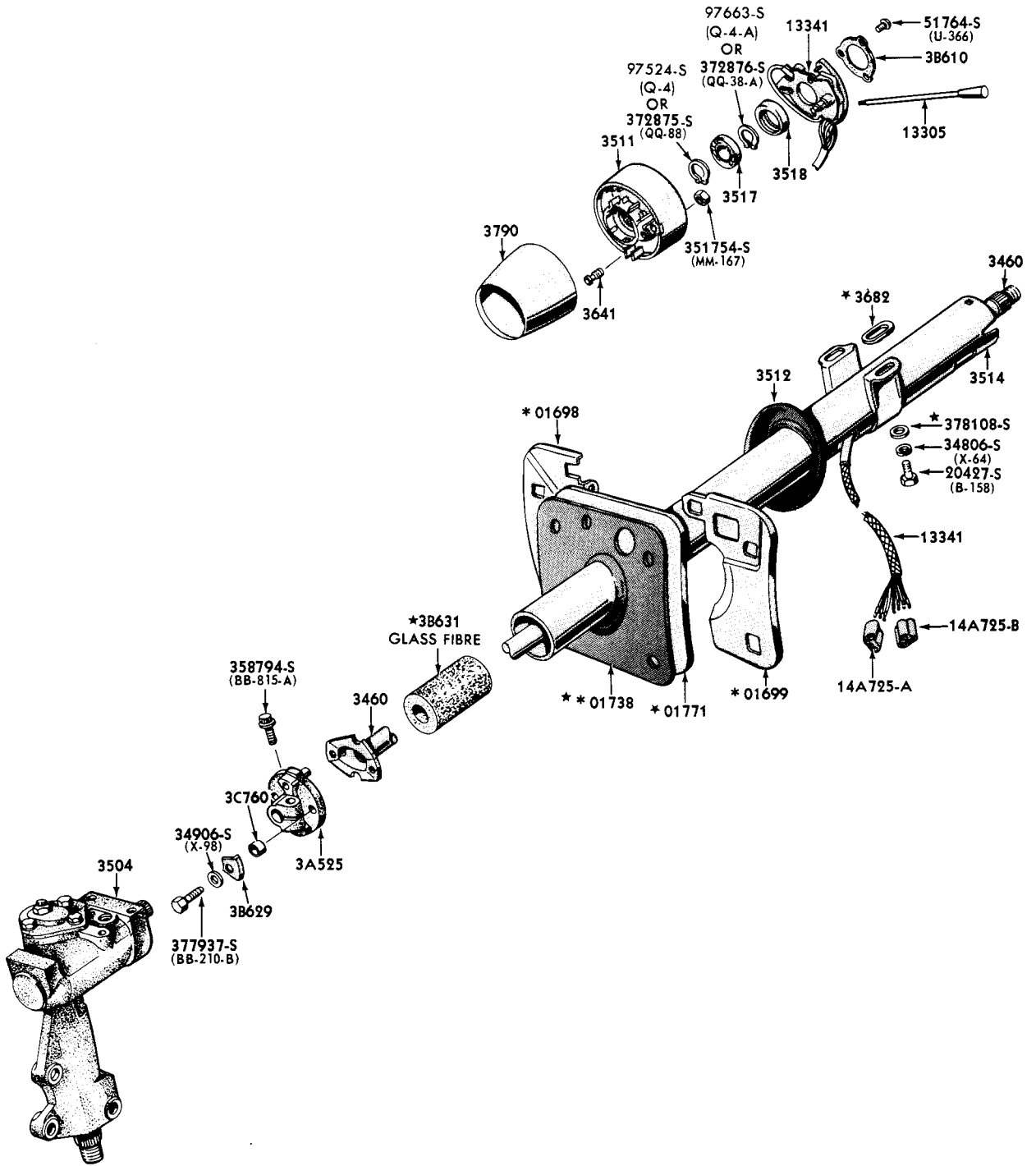

*REFER TO BODY GROUP NUMBER

P-4237

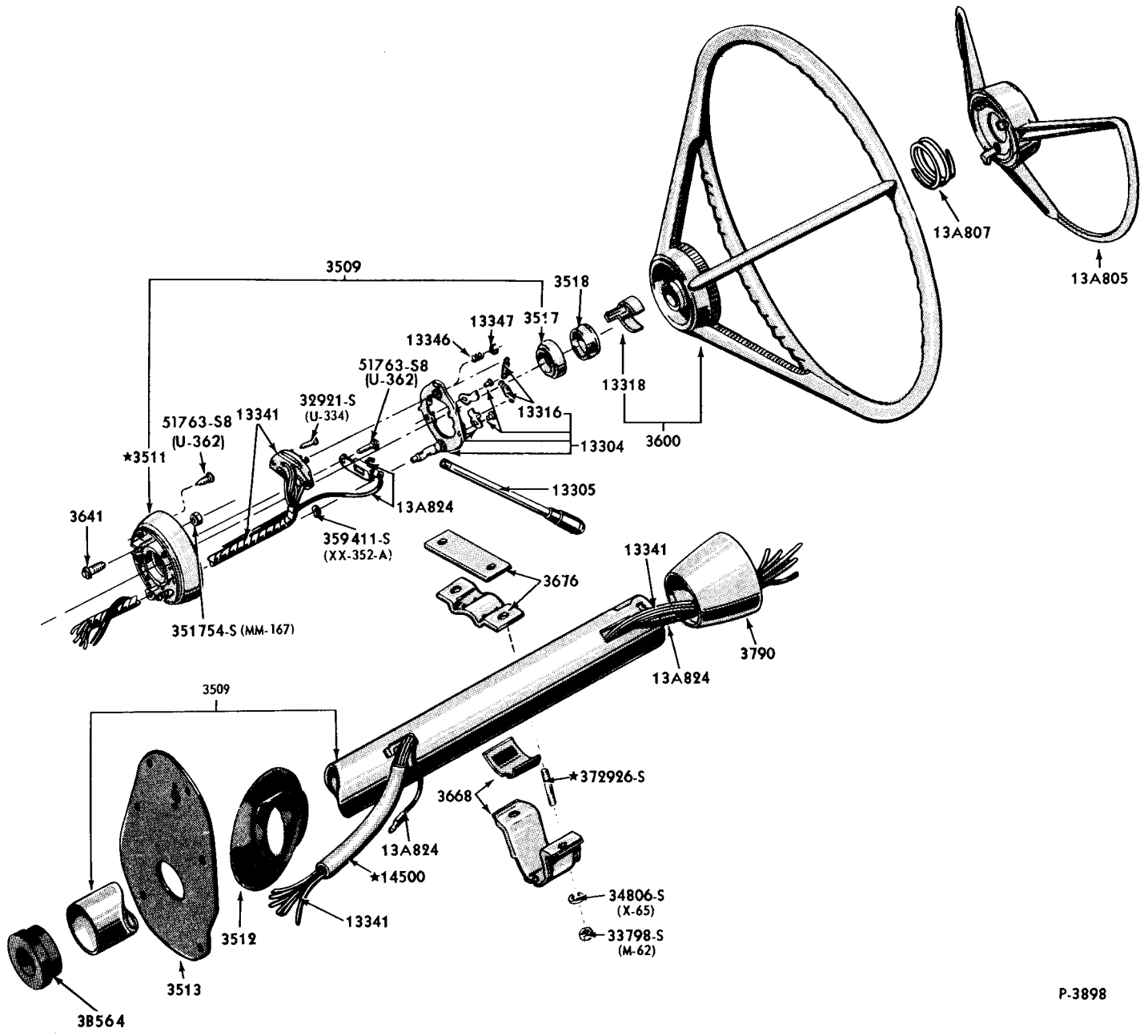

STEERING COLUMN FOR FLOOR SHIFT
1962/64 FALCON

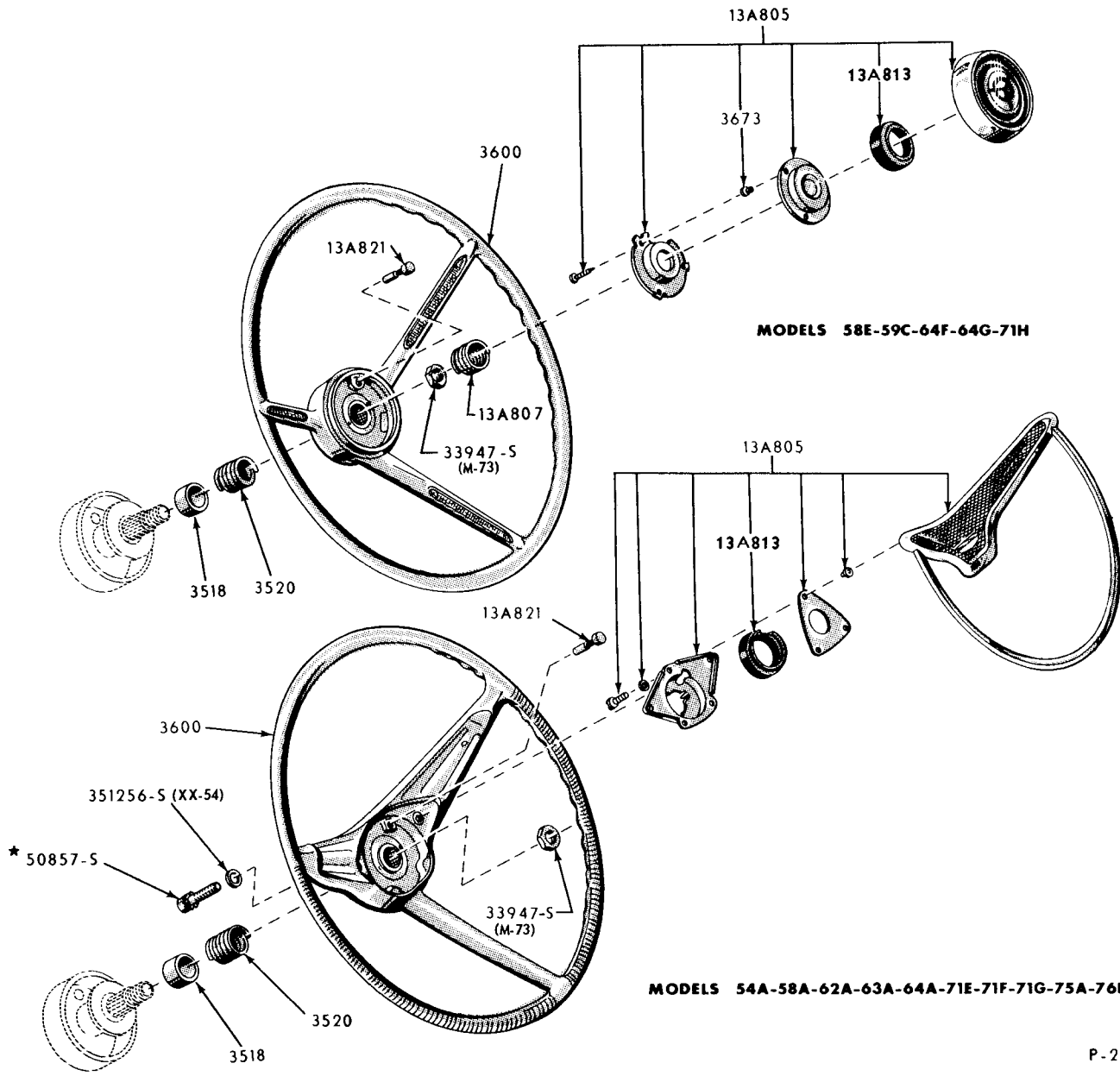

MODELS 58E-59C-64F-64G-71H

MODELS 54A-58A-62A-63A-64A-71E-71F-71G-75A-76B

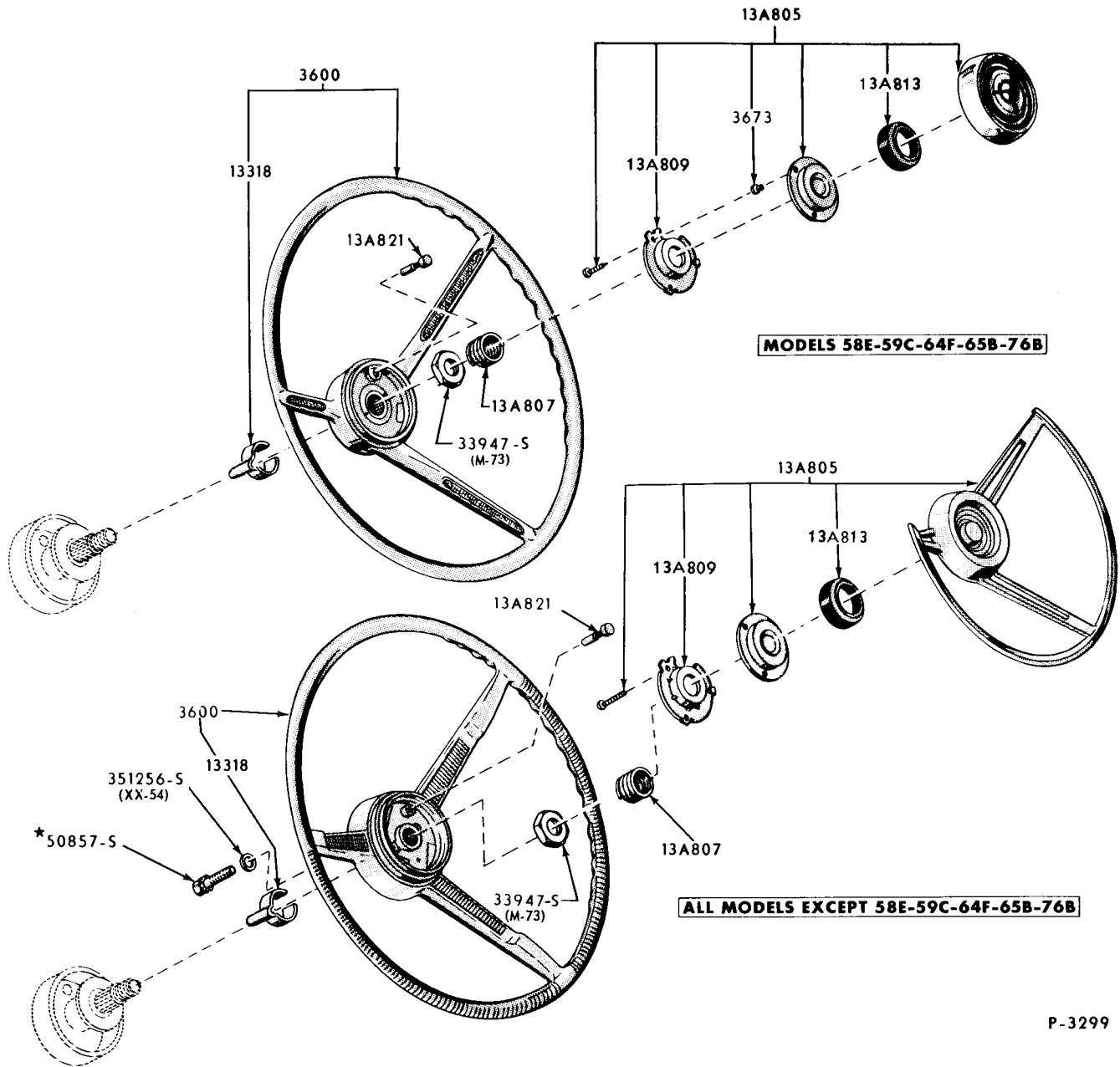

1961/64 STEERING WHEEL & HORN RING (FORD)-TYPICAL

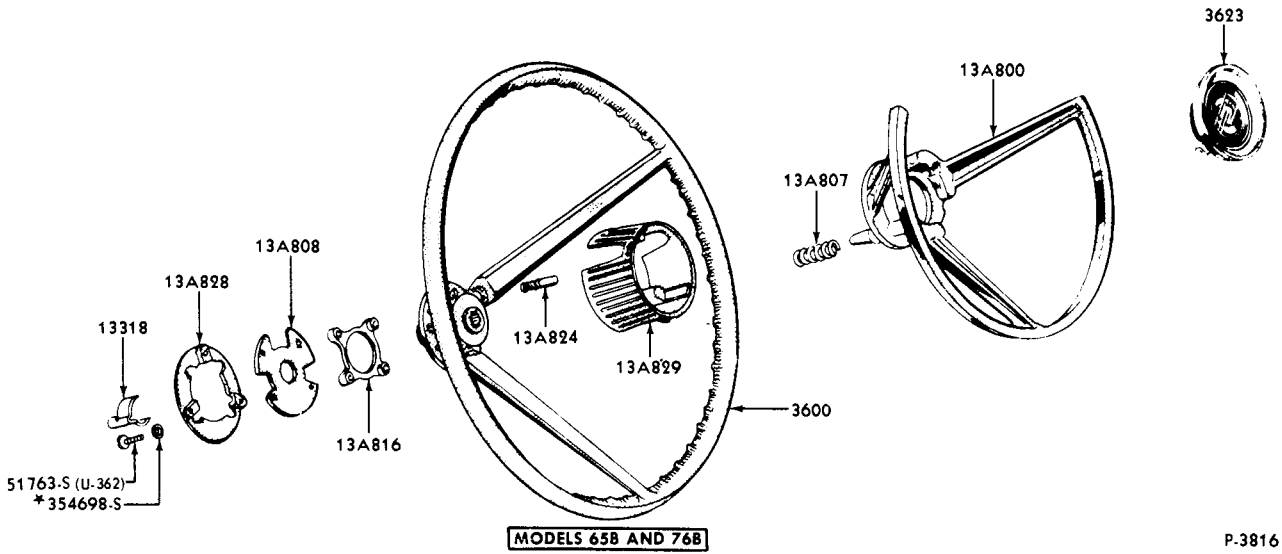

1962/64 STEERING WHEEL & HORN RING (FORD-GALAXIE 500-XL)

1962/64 STEERING WHEEL & HORN RING (FAIRLANE)

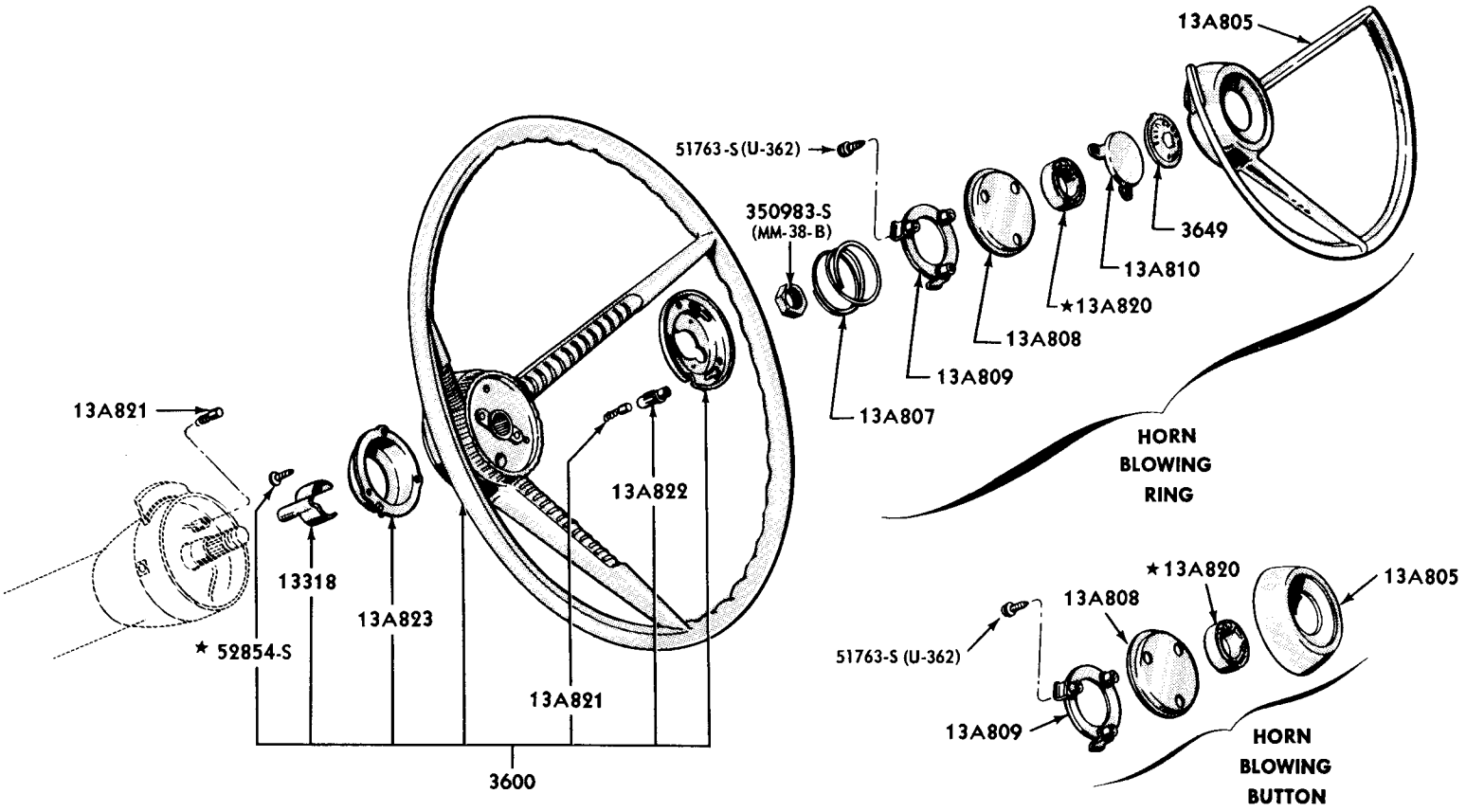

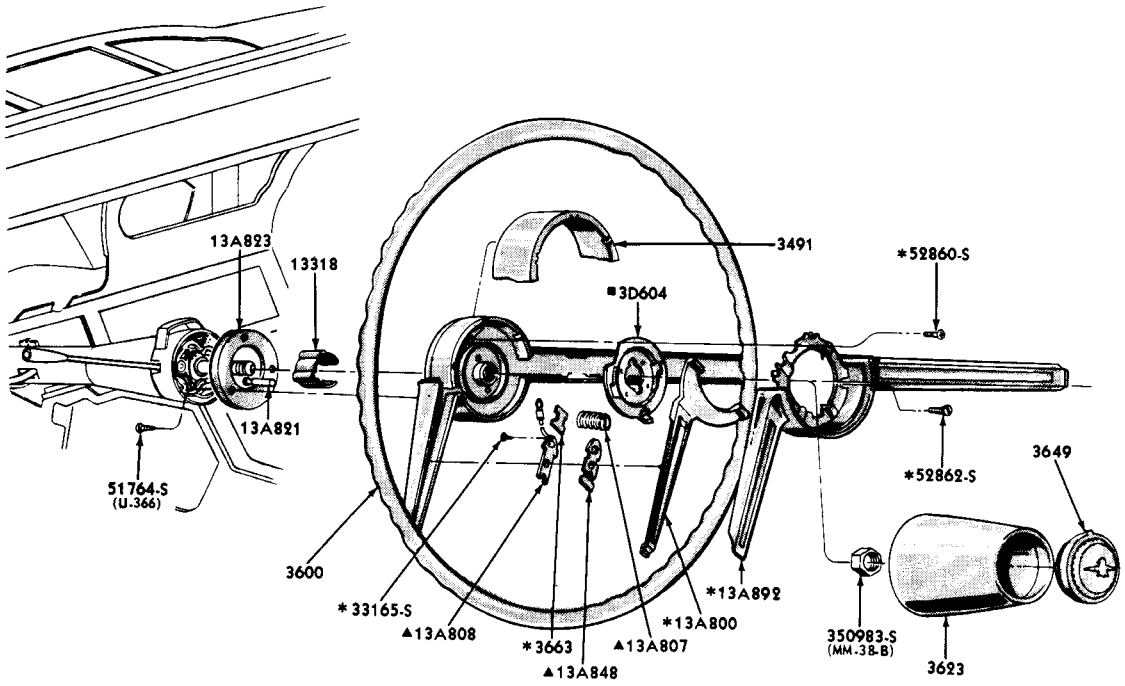

1964

- * SUPPLIED ONLY IN 13A805 HORN BUTTON ASSEMBLY
- ▲ ALSO SUPPLIED IN 13A805 HORN BUTTON ASSEMBLY
- SUPPLIED ONLY IN 3600 WHEEL ASSEMBLY

P.4544

1964 STEERING WHEEL & HORN RING (THUNDERBIRD)

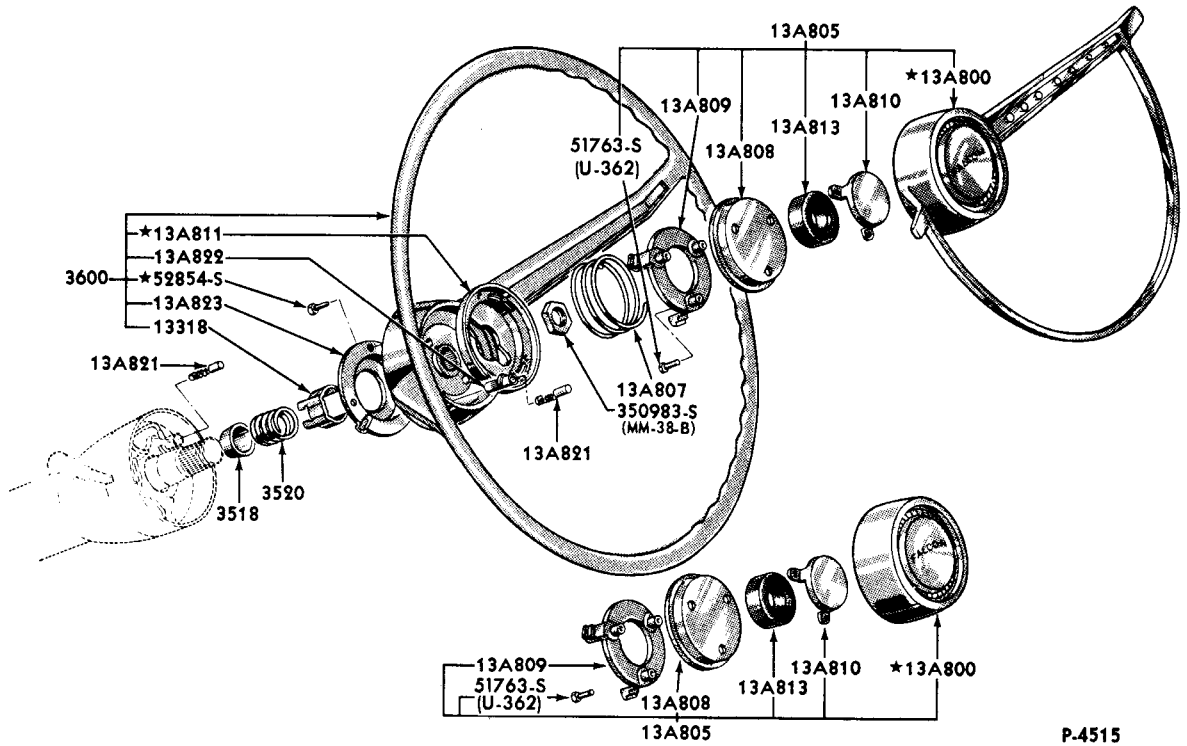

P-4515

1964 STEERING WHEEL & HORN RING (FALCON)